

T37S R5W Northwest Quarter Section 18

Northwest corner Section 18

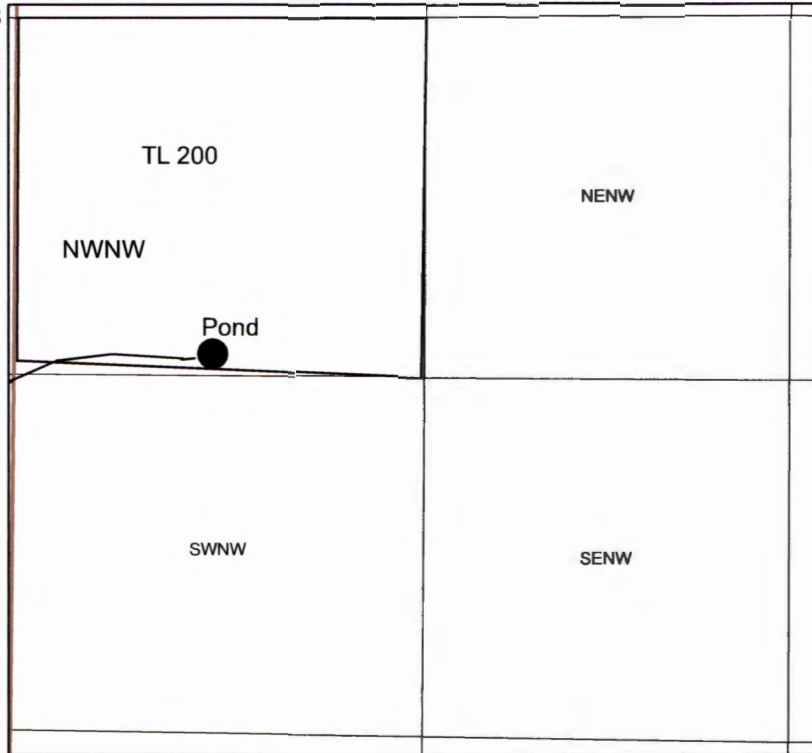

1 inch = 660 feet

The pond is located 740 ft east and 1233 ft south from the northwest corner of Section 18.

RECEIVED BY OWRD

MAY 05 2017

SALEM, OR

R-88405

088405



NWVW

SWSW

NWSE

SWSW

37 S 5 W

NENE

SENE

NESE

SESE

NWNE

SWNE

NWSE

SWSE

18

RECEIVED BY OWRD

MAY 05 2017

SALEM, OR

NENW

SENW

NESW

SESW

NWVW

SWVW

NWVW

SWSW

37 S 6 W

NENE

SENE

NESE

SESE