

P:\MAD (City of Madras)\MAD-02 (Engineer of Record)\MAD02-DWG\SHEETS\MAD02-FIG S1-4 WW FAC LOC MAP.dwg

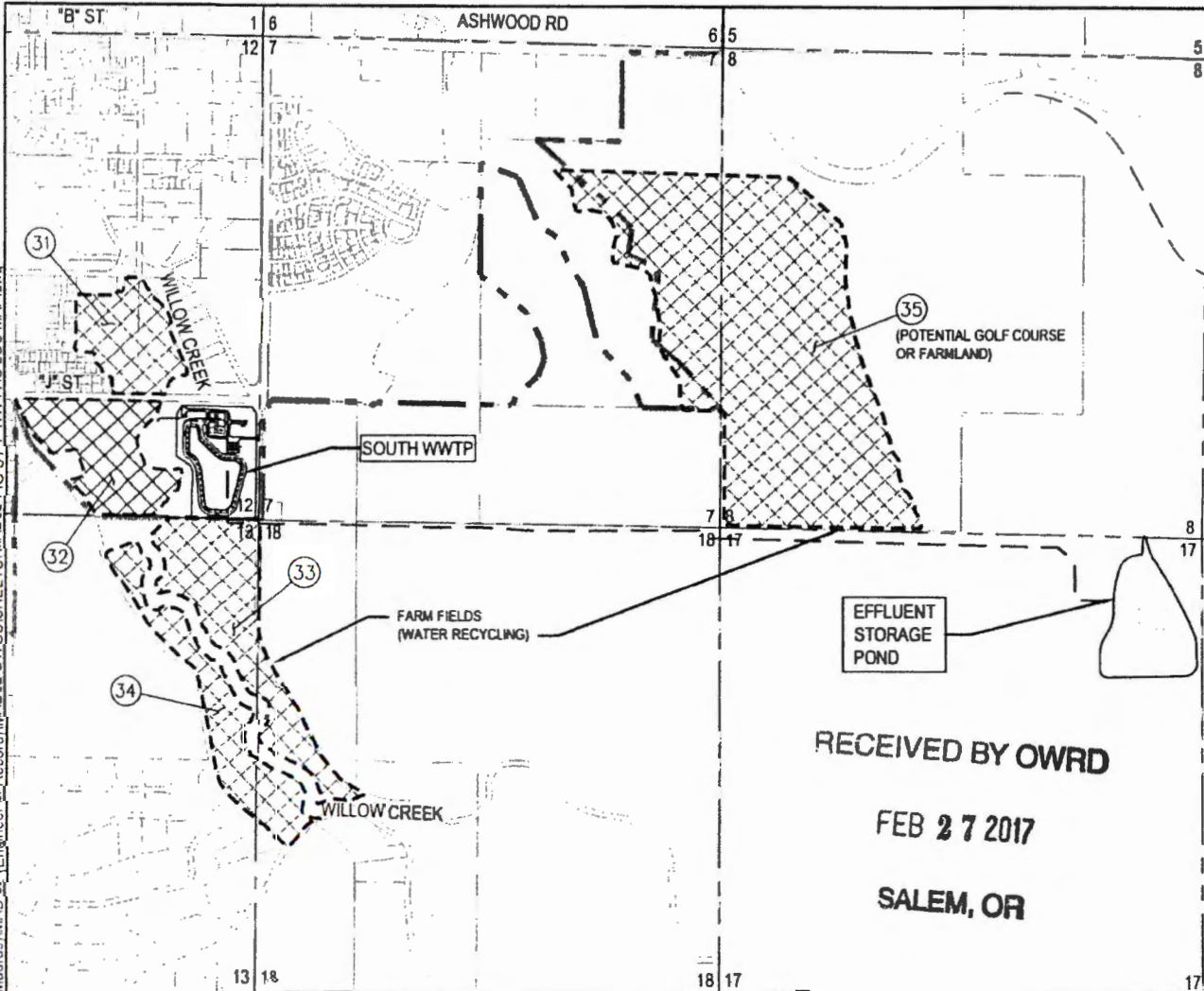

LEGEND

- UGB
- IRRIGATION CANAL
- WWTP SITE & EFFLUENT STORAGE POND
- IRRIGATION SITE - DESHUTES BASIN FARMS

DESCHUTES BASIN FARMS RECYCLED WATER USE SITES

#	FIELD	AC	LOCATION
32	27		SW 1/4 OF SE 1/4 SEC 12, T11S R13E
	8		SE 1/4 OF SE 1/4 SEC 12, T11S R13E
TOTAL #			35

RECEIVED BY OWRD

APR 24 2017

SALEM, OR

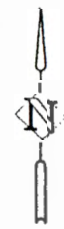

SCALE: 1" = 1200'

RECEIVED BY OWRD

FEB 27 2017

SALEM, OR

DATE	BY	REVISIONS

HPH Harper Houf Peterson Righellis Inc.

DESCHUTES BASIN FARMS
CITY OF MADRAS, OREGON

S2
MAD 02



**Oregon Water Resources Department
Water Rights Mapping Tool**

[Main](#) [Help](#) **OWRD Only**
[Return](#) [Contact Us](#)

Search

Identify Non-Water Right Features

Distance: 1 Feet

General **Rules** **Hydrography**

TRSQQ: WM11.00S13.00E12NESE
 DLC:
 Latitude: 44.6283070971
 Longitude: -121.1119253957
 Buffer (ft): 1
 Elevation (ft): 2300
 Basin Name: Deschutes
 Basin Plan: 2-Middle Deschutes
 County: Jefferson
 WM District: 11
 WM Region: SOUTH CENTRAL
 ODFW Region, District: High Desert, Mid-Columbia District
 Irrigation District AOI: [NORTH UNIT IRRIGATION DISTRICT](#)
 Irrigation District, Other:
 Dams (Permit):
 Water Rights: [Platcard for WM11.00S13.00E12](#)
 Well Logs: [Logs for...](#)

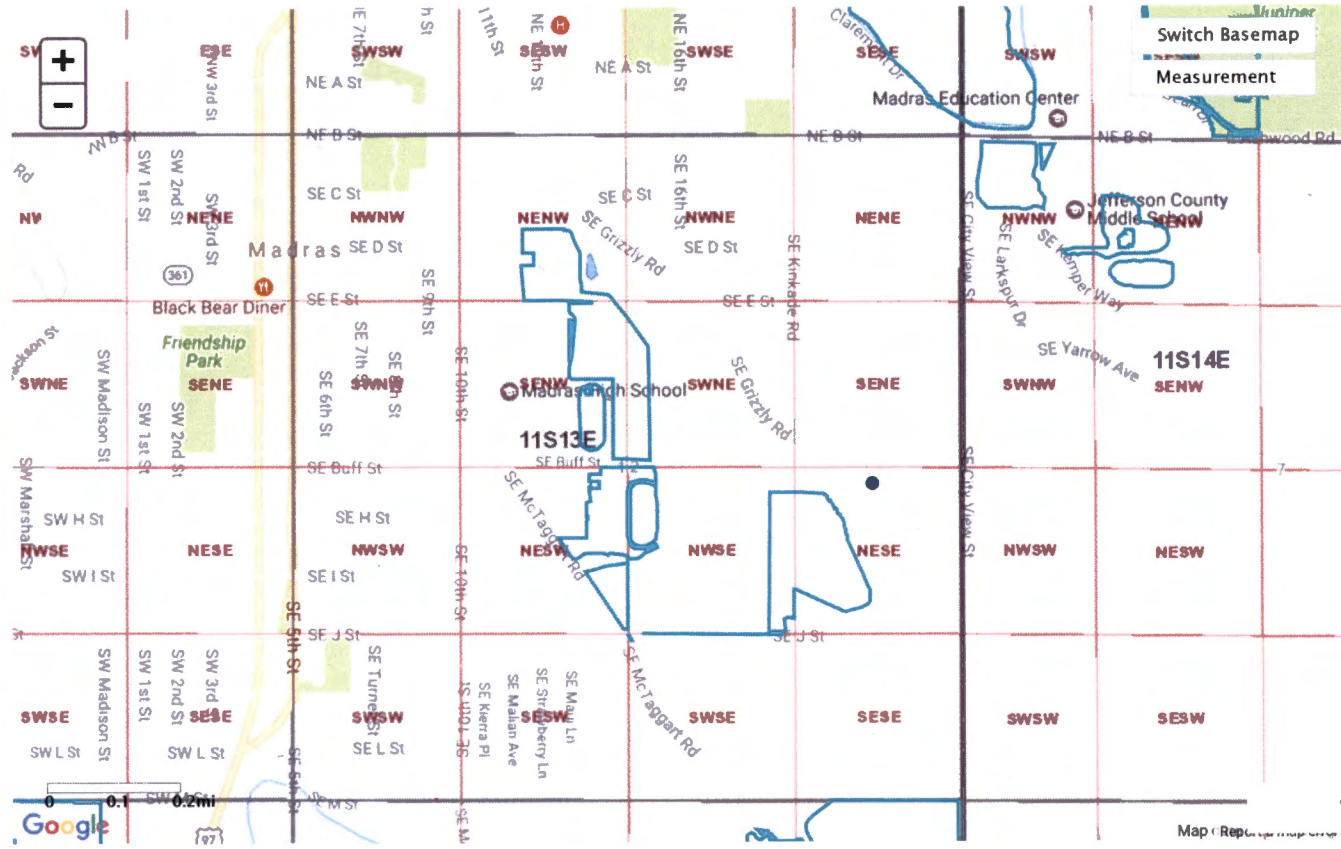

- Tax Lots
- Tools
- Layers
- Bookmarks

[POD](#) [POU](#) [Irrigation Districts AOI](#) [WR By Time](#)

#	ID (select)	WRIS	Zoom	Water Right	Water Type	First Name	Last Name	Company	Use Desc.	Priority Date	Supp. Duty	Rate cfs	Rate
1	149515	(Details)	Map WR	Cert:72279 CF * IR	SW			NORTH UNIT IRRIG...	IRRIGATION	02/28/1913 -	5.25	367	
2	149516	(Details)	Map WR	Cert:72279 CF * IR	SW			NORTH UNIT IRRIG...	IRRIGATION	02/28/1913 -	5.25	367	

Search took 0 sec