

P:\MAD (City of Madras)\MAD-02 (Engineer of Record)\MAD02.DWG\SS\SHEETS\MAD02-N1-3 WW FAC LOC MAP.dwg

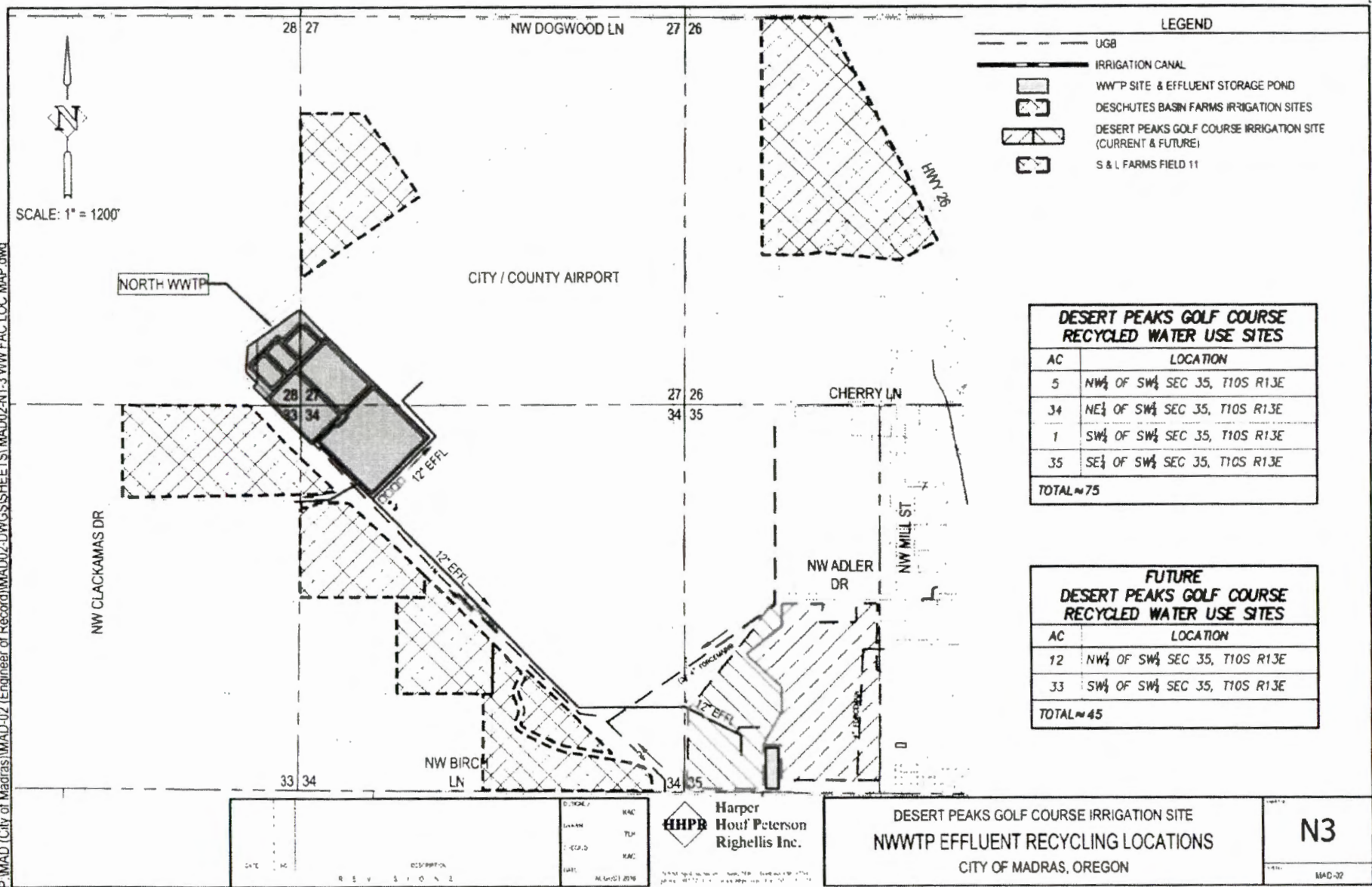

SCALE: 1" = 1200'

LEGEND

- UGB
- IRRIGATION CANAL
- WWTP SITE & EFFLUENT STORAGE POND
- ▨ DESCHUTES BASIN FARMS IRRIGATION SITES
- ▧ DESERT PEAKS GOLF COURSE IRRIGATION SITE (CURRENT & FUTURE)
- S & L FARMS FIELD 11

DESERT PEAKS GOLF COURSE RECYCLED WATER USE SITES	
AC	LOCATION
5	NW¼ OF SW¼ SEC 35, T10S R13E
34	NE¼ OF SW¼ SEC 35, T10S R13E
1	SW¼ OF SW¼ SEC 35, T10S R13E
35	SE¼ OF SW¼ SEC 35, T10S R13E
TOTAL = 75	

FUTURE DESERT PEAKS GOLF COURSE RECYCLED WATER USE SITES	
AC	LOCATION
12	NW¼ OF SW¼ SEC 35, T10S R13E
33	SW¼ OF SW¼ SEC 35, T10S R13E
TOTAL = 45	

DESERT PEAKS GOLF COURSE IRRIGATION SITE
 NWWTP EFFLUENT RECYCLING LOCATIONS
 CITY OF MADRAS, OREGON

N3
 MAD-02

RECEIVED BY OWRD RECEIVED BY OWRD

MAR 02 2017

APR 24 2017

SALEM, OR

SALEM, OR



**Oregon Water Resources Department
Water Rights Mapping Tool**

- Main
- Help
- Return
- Contact Us

725 Summer St NE, Sale

Search

Identify Non-Water Right Features

Distance: 1 Feet

General	Rules	Hydrography
TRSQQ:	WM11.00513.00E12NESE	
DLC:	-	
Latitude:	44.6283070971	
Longitude:	-121.1119253957	
Buffer (ft):	1	
Elevation (ft):	2300	
Basin Name:	Deschutes	
Basin Plan:	2-Middle Deschutes	
County:	Jefferson	
WM District:	11	
WM Region:	SOUTH CENTRAL	
ODFW Region, District:	High Desert, Mid-Columbia District	
Irrigation District AOI:	NORTH UNIT IRRIGATION DISTRICT	
Irrigation District, Other:		
Dams (Permit):		
Water Rights:	Platcard for WM11.00513.00E12	
Well Logs:	Logs for...	

Tax Lots

Tools

Layers

Bookmarks

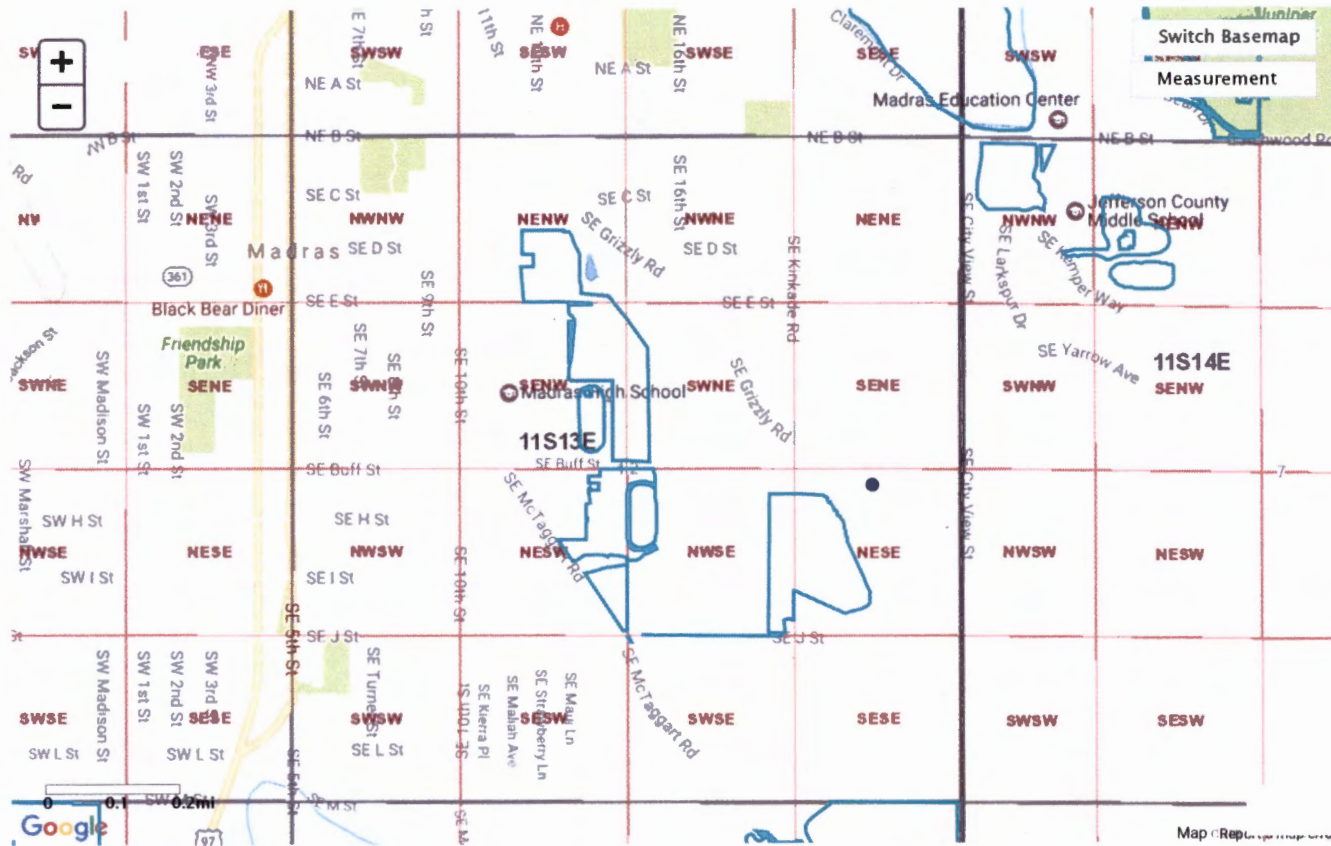

POD POU Irrigation Districts AOI WR By Time

All Fields Search...

#	ID (select)	WRIS	Zoom	Water Right	Water Type	First Name	Last Name	Company	Use Desc.	Priority Date	Supp. Duty	Rate cfs	Rate
1	149515	(Details)	Map WR	Cert:72279 CF * IR	SW			NORTH UNIT IRRIG...	IRRIGATION	02/28/1913	- 5.25	367	
2	149516	(Details)	Map WR	Cert:72279 CF * IR	SW			NORTH UNIT IRRIG...	IRRIGATION	02/28/1913	- 5.25	367	

Search took 0 sec