

Application for a Permit to Store Water in the Name of Sarbanand Enterprises Township 4 South, Range 4 West (W.M.)

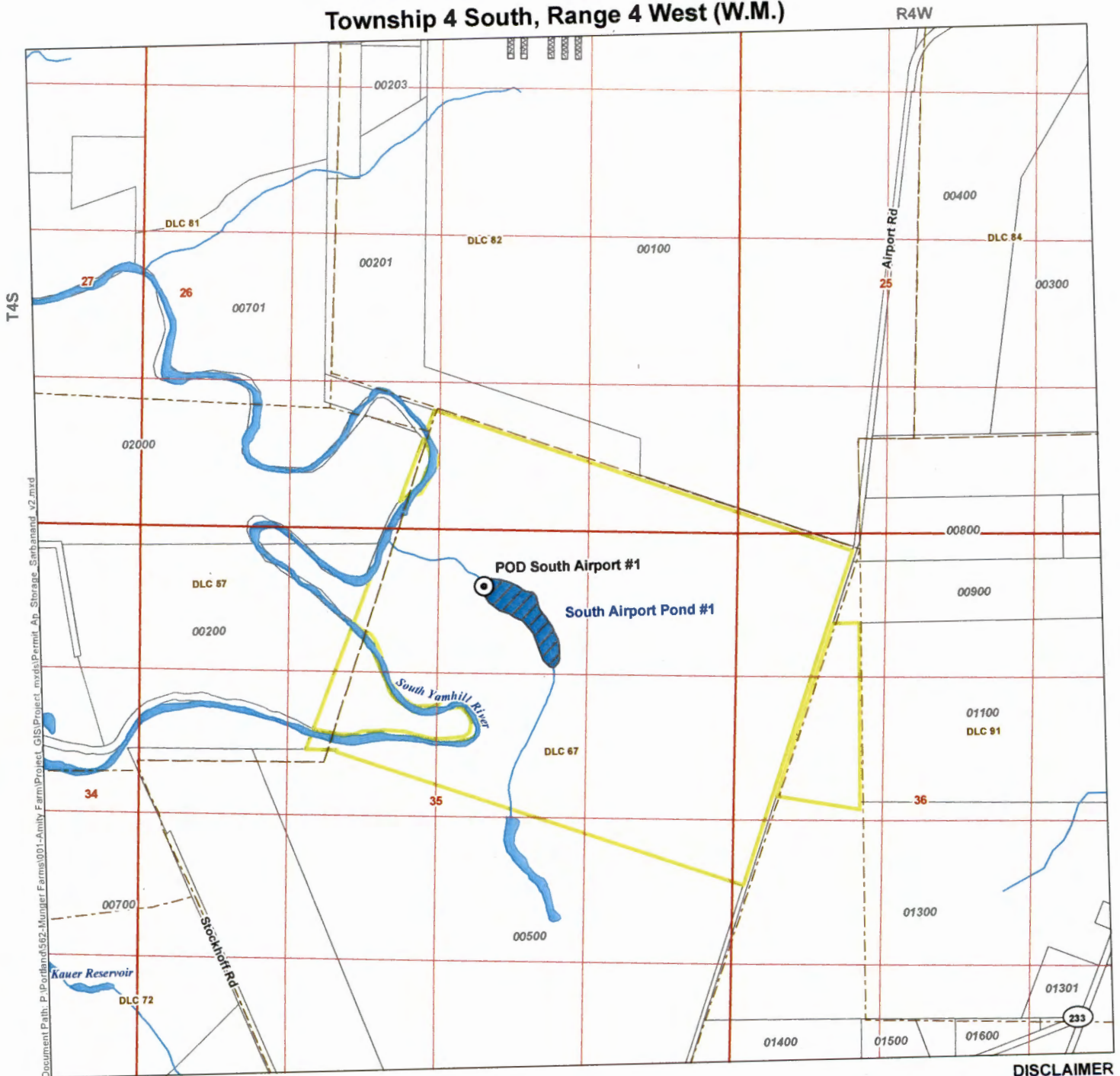

LEGEND

- Point of Diversion (POD)
- South Airport Pond #2
- Property Boundary
- Tax Lot
- Donation Land Claim (DLC)
- Watercourse
- Waterbody

POD LOCATION DESCRIPTION

POD South Airport Pond #1
Located 510 feet South and 2280 feet East from the NW corner
of Section 35, Township 4 South, Range 4 West (W.M.)

R-88417

DISCLAIMER

This map was prepared for the purpose of identifying the location of a water right only and it is not intended to provide legal dimensions or location of property ownership lines.

MAP NOTES

Date: November 1, 2016
Data Sources: BLM, ESRI, USGS, Yamhill Co.

RECEIVED BY OWRD

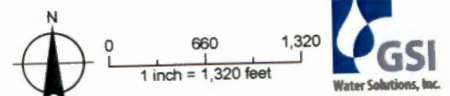

JUN 14 2017

SALEM, OR

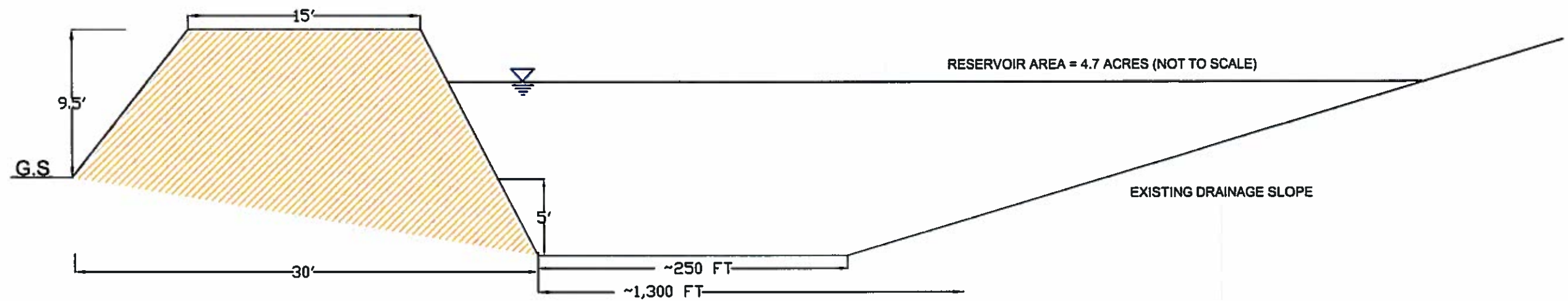



LEGEND

-  IMPOUNDED SURFACE RUNOFF
-  RESERVOIR BERM
- G.S.** EXISTING GROUND SURFACE

DISCLAIMER:
THIS DRAWING IS INTENDED AS A CONCEPTUAL DRAWING FOR THE SOLE
PURPOSE OF APPLYING FOR A WATER RIGHT. THIS IS NOT A DESIGN DRAWING.

RECEIVED BY OWRD

JUN 14 2017

SALEM, OR



NOT FOR CONSTRUCTION

CLIENT:	SARBANAND ENTERPRISES	DWN BY: SK	PROJECT
		CHKD BY:	SOUTH AIRPORT POND #1 0562.001
		DATUM:	TITLE
		PROJECTION:	PROPOSED RESERVOIR CROSS SECTIONS
	NOVEMBER 2016	SCALE: AS SHOWN	

