

# T.4S. R.3W. Section 18, W.M.

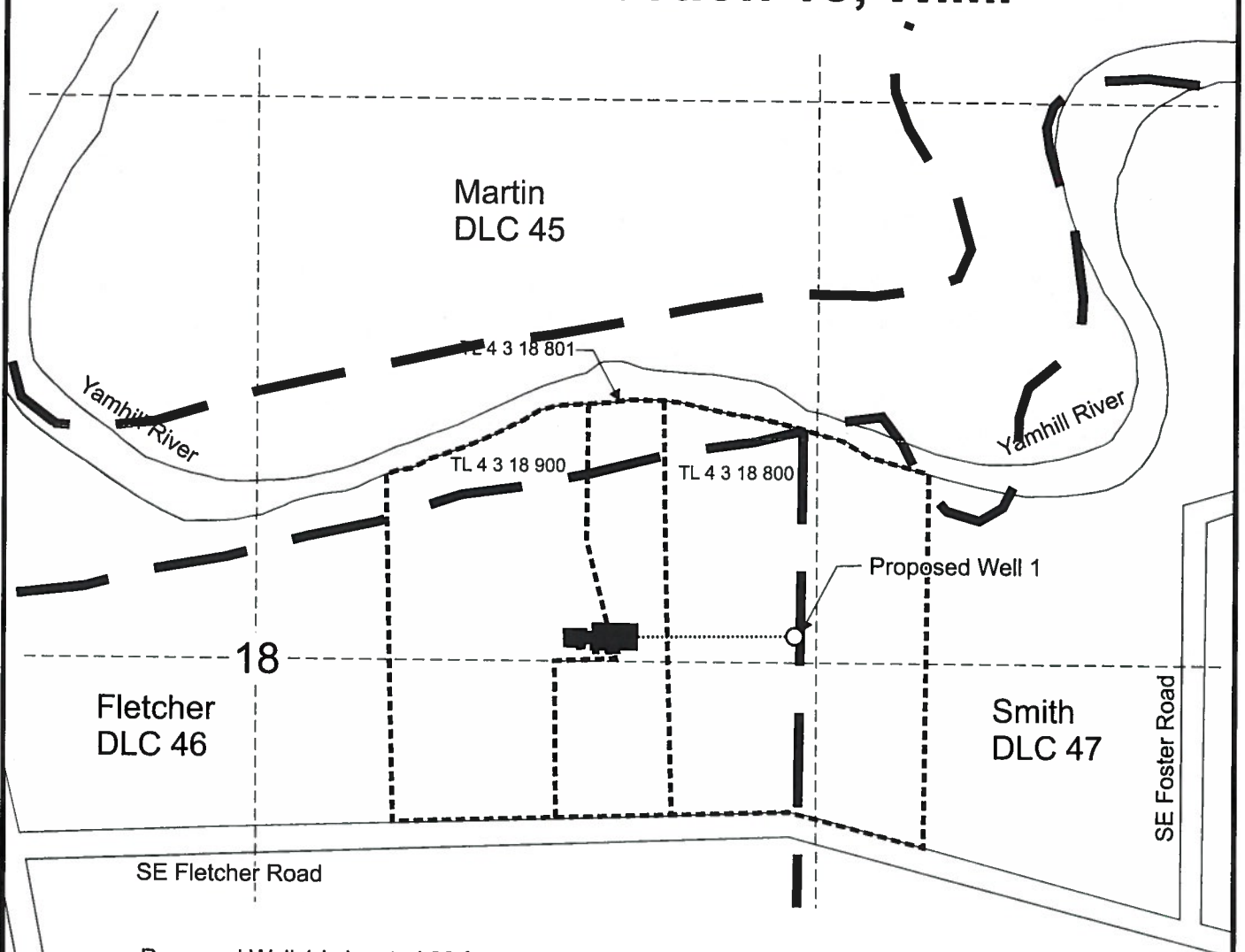

Proposed Well 1 is located 60 feet north and 1,270 feet east from the center, Section 18.

- Place of proposed commercial use (all in SW1/4 NE 1/4, Section 18).
- Tax lot boundary
- Donation Land Claim boundaries from 4/13/1861 survey
- Irrigation main line buried

RECEIVED

JAN 5 2018

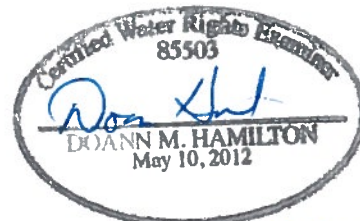

OWRD

Scale: 1" = 400'

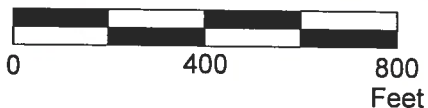

This map was prepared for the purpose of identifying the location of a water right only and is not intended to provide legal dimensions or location of property ownership lines.



## Water Right Application Map

Pacific Hydro-Geology Inc.

01/2017  
Rev. 12/2017

Dayton Natural Meats, LLC  
T.4S. R.3W. Section 18, W.M.