

# T.4S. R.3W. Sec. 29 & 30, W.M.

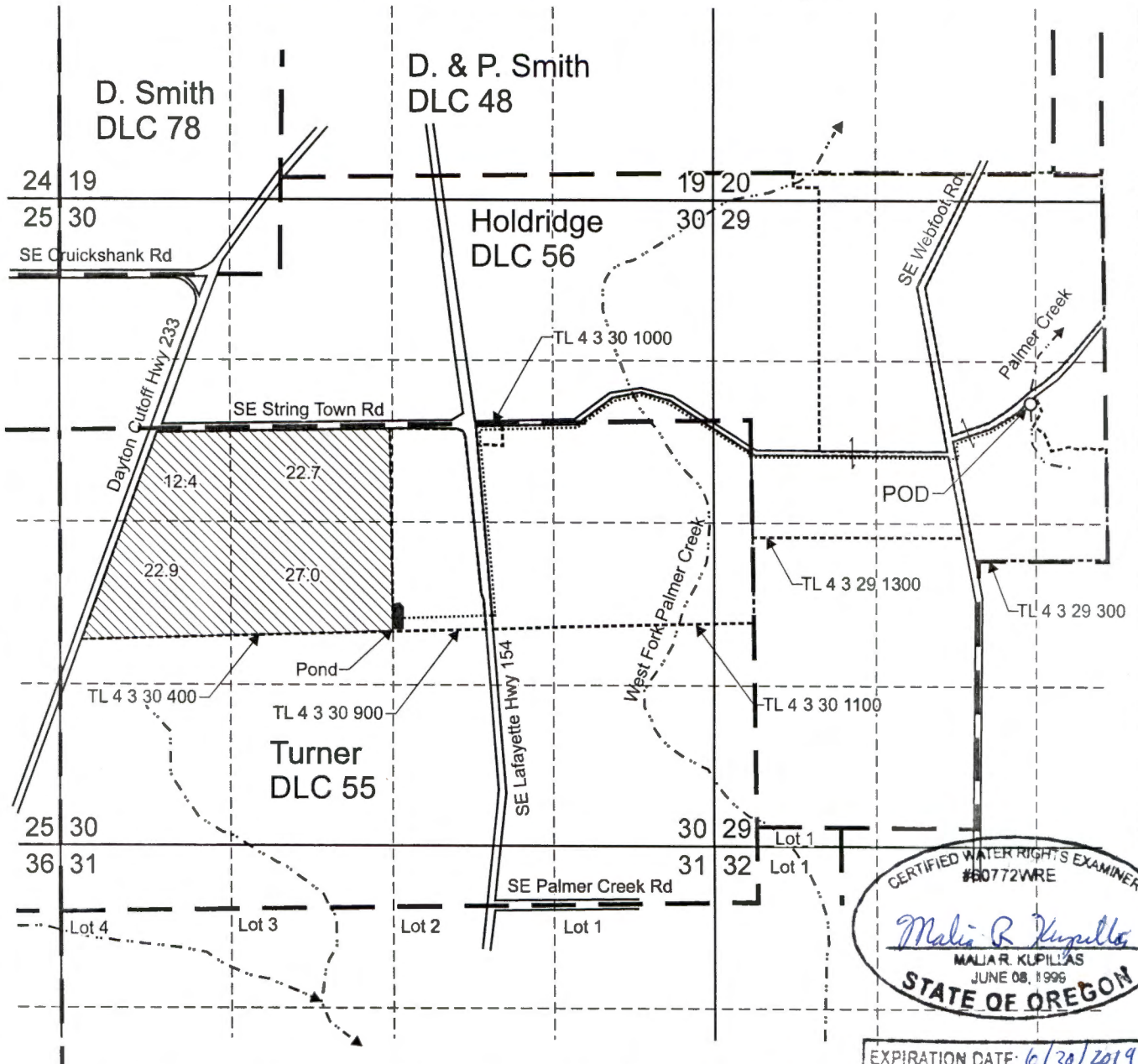

CERTIFIED WATER RIGHTS EXAMINER  
 #80772WRE  
*Malia R. Kupillas*  
 MALIA R. KUPILLAS  
 JUNE 08, 1996  
 STATE OF OREGON

EXPIRATION DATE: 6/30/2019

Proposed POD is located 1,655 feet south and 2,600 feet east from the NW corner, Section 29.

- Area (85.0 Acres) to be irrigated.
- Tax lot boundary
- Donation Land Claim boundary
- Mainline

Scale: 1" = 1,320'

**RECEIVED**

**AUG 31 2017**

**OWRD**

This map was prepared for the purpose of identifying the location of a water right only and is not intended to provide legal dimensions or location of property ownership lines.



## Water Right Application Map

Palmer Creek Water District  
 Improvement Company  
 T.4S. R.3W. Sec. 29 & 30, W.M.

Pacific Hydro-Geology Inc.

08/2017

KCKSWAppMap.cdr

S-894674

# T.6S. R.3W. Sec. 4, W.M.

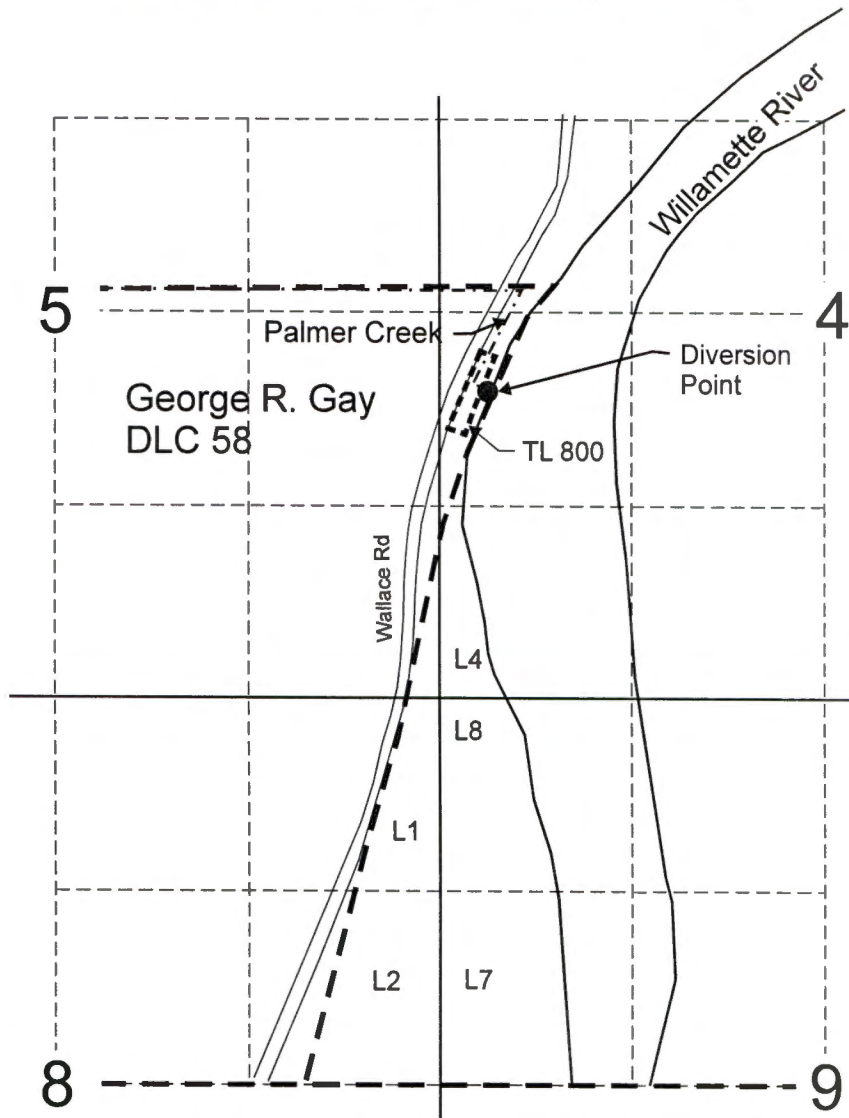

POD is located 690 feet south and 110 feet west from the NE corner of Gay DLC 58.

- - - - - Main Canal
- - - - - Tax lot boundary

**RECEIVED**

**AUG 31 2017**

**OWRD**

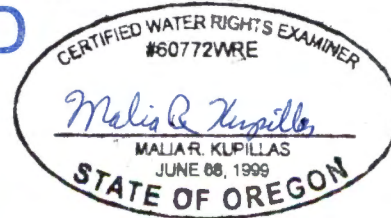

EXPIRATION DATE: 6/30/19

Scale: 1" = 1,320'



This map was prepared for the purpose of identifying the location of a water right only and is not intended to provide legal dimensions or location of property ownership lines.



**PCWDIC Diversion Point**

Palmer Creek Water District Improvement Company  
T.6S. R.3W. Sec. 4, W.M.

Pacific Hydro-Geology Inc.

08/2017

POD.cdr

C-22454