

SEC 20

38.2 SESE

SEC 21

12.2 SESW

15.2 SWSW

T. 5 S. R. 2 W. W. M.

SEC 28

5.8 NENW

2.7 NW NW

SEC 29

10.5 NENE

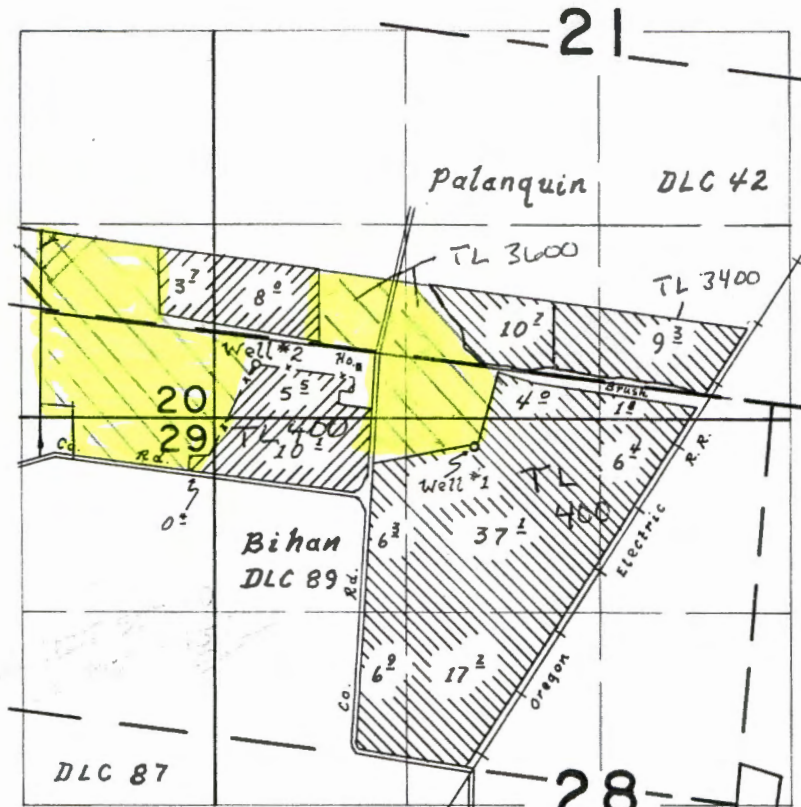

Well #1 loc. 300'S. & 2060'W. from N.E. cor. Bihan DLC 89
 Well #2 loc. 260'N. & 3540'W. from N.E. Cor. Bihan DLC 89

From Well #1 Cert 39792
 From Well #2 Cert 39792

FINAL PROOF SURVEY
 UNDER

Application No. G-3921 Permit No. G-3682
 IN NAME OF

Carl F. Werner

Surveyed 13 OCT 1972 by D. O'Reilly

RECEIVED
OCT 26 2017
OWRD