

807-988-5

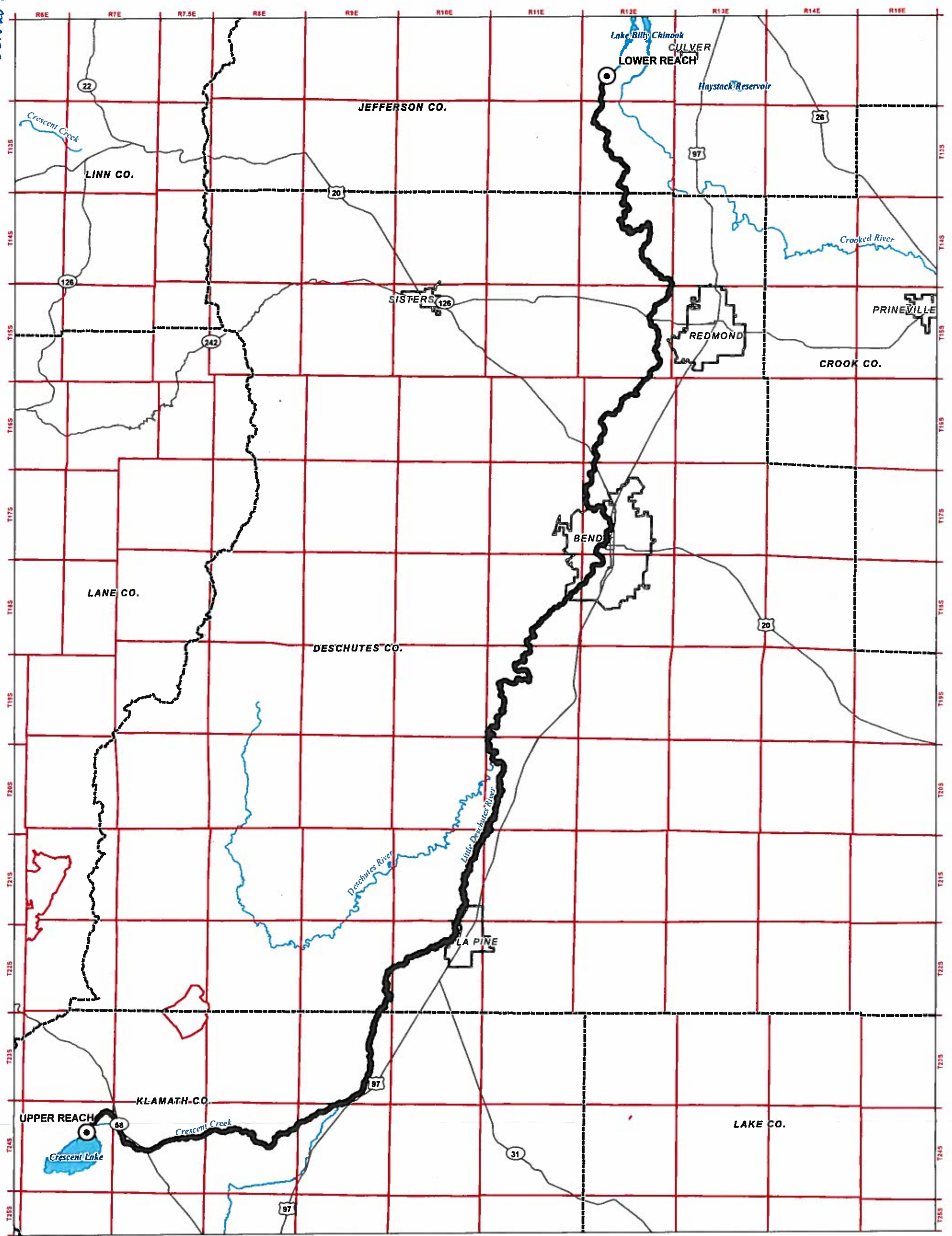

**LEGEND**

- Place of Use (POU)
- County
- City
- Highway
- River
- Lake or Reservoir

**REACH DESCRIPTIONS**  
 (Identical to Instream Certificate 91923)  
**Upper Reach:** 24 South, 6 East, Section 11, SESW  
**Lower Reach:** 12 South, 12 East, Section 29, NWSW (Deschutes River mile 120)

**DISCLAIMER**  
 This map was prepared for the purpose of identifying the location of a water right only and it is not intended to provide legal dimensions or location of property ownership lines.

Date: September 26, 2017  
 Data Sources: Data Sources: Crook Co. GIS, USGS, OGIC

**RECEIVED**  
 NOV 29 2017  
**OWRPD**

**Application for Secondary Instream  
 Water Right Permit in the Name of  
 Tumalo Irrigation District**  
**Place of Use Map**  
 Deschutes, Jefferson, and Klamath Counties, Oregon

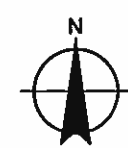

# Application for Secondary Water Right Permit Tumalo Irrigation District

Crescent Lake Dam Location  
Klamath County, Oregon  
Township 24 South, Range 6 East (W.M.)



Document Path: P:\Portland\666-Tumalo Irrigation District\Project\_GIS\Project\_mxd\Secondary Application\_Instream\_Dam\_Outlet.mxd

## LEGEND

- Dam Outlet
- Government Lot (GL)
- Tax Lot
- Railroad
- Major Road
- Watercourse
- Waterbody

## OUTLET LOCATION DESCRIPTION

**Dam Outlet**  
Located 450 feet North and 2,380 feet East from the SW corner of Section 11, Township 24 South, Range 6 East (W.M.)

## DISCLAIMER

This map was prepared for the purpose of identifying the location of a water right only and it is not intended to provide legal dimensions or location of property ownership lines.

## MAP NOTES

Date: September 8, 2017  
Data Sources: BLM, ESRI, Klamath Co., USGS

**RECEIVED**

NOV 29 2017

**OWRD**

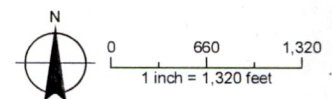

S-88478

# Application for Secondary Water Right Permit Tumalo Irrigation District

Crescent Lake Dam Location  
Klamath County, Oregon  
Township 24 South, Range 6 East (W.M.)

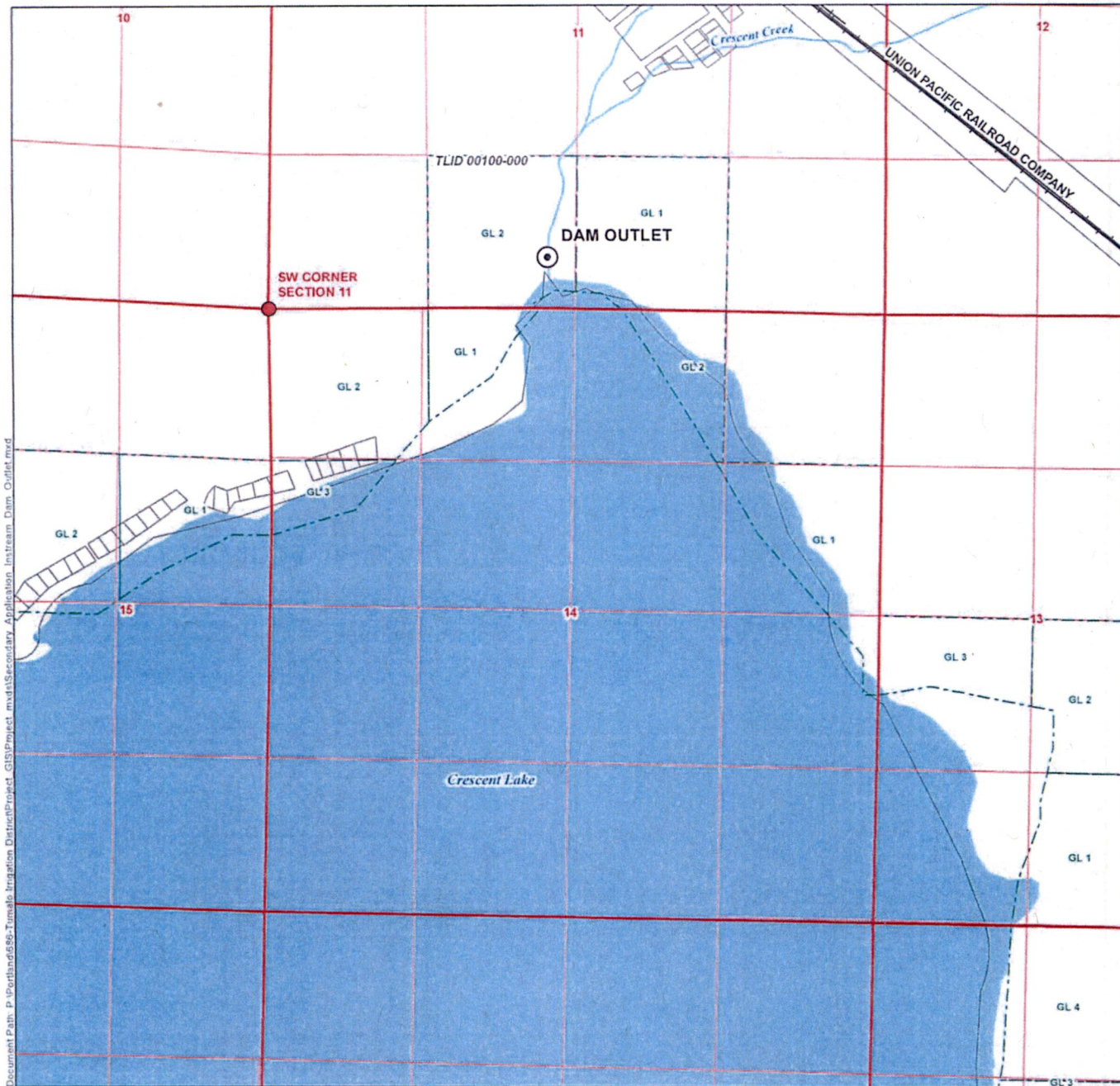

Document Path: P:\up\hand\589-Tumalo Irrigation District\Project\_GIS\Project\_mxd\Secondary Application\_Instream\_Dam\_Outlet.mxd

**LEGEND**

- Dam Outlet
- Government Lot (GL)
- Tax Lot
- Railroad
- Major Road
- Watercourse
- Waterbody

**OUTLET LOCATION DESCRIPTION**

**Dam Outlet**  
Located 450 feet North and 2,380 feet East from the SW corner of Section 11, Township 24 South, Range 6 East (W.M.)

**DISCLAIMER**

This map was prepared for the purpose of identifying the location of a water right only and it is not intended to provide legal dimensions or location of property ownership lines.

**MAP NOTES**

Date: September 8, 2017  
Data Sources: BLM, ESRI, Klamath Co., USGS

**RECEIVED**

NOV 29 2017

**OWRD**

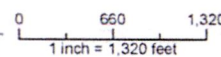

5-00478

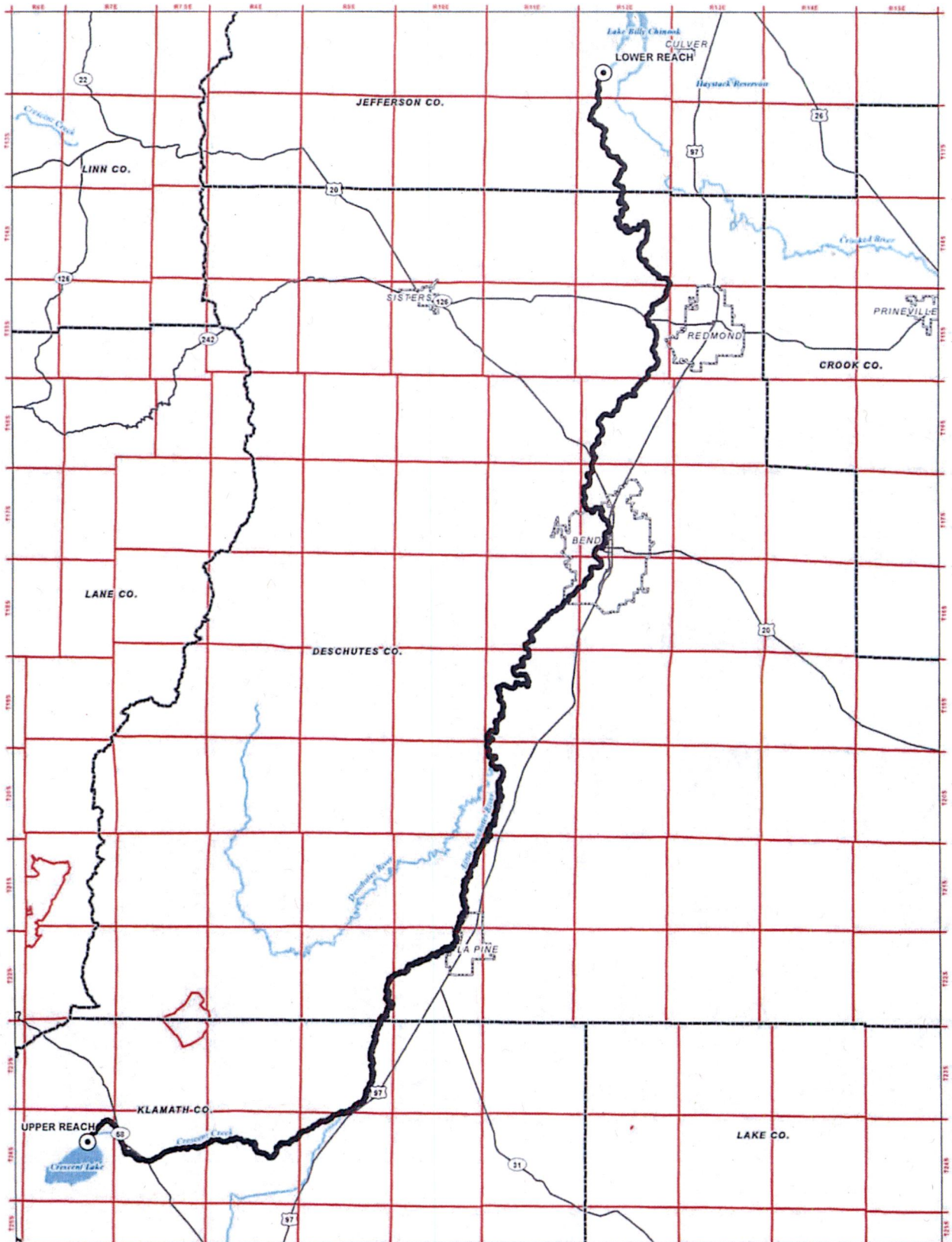

**LEGEND**

- Place of Use (POU)
- Highway
- County
- River
- City
- Lake or Reservoir

**REACH DESCRIPTIONS**

(Identical to Instream Certificate 91923)

**Upper Reach:** 24 South, 6 East, Section 11, SESW

**Lower Reach:** 12 South, 12 East, Section 29, NWSW (Deschutes River mile 100)

**DISCLAIMER**

This map was prepared for the purpose of identifying the location of a water right only and it is not intended to provide legal dimensions or location of property ownership lines.

Date: September 26, 2017  
 Data Sources: Creek Co. GIS, USGS, OGIIC

**RECEIVED**

NOV 29 2017

**OWRD**

**Application for Secondary Instream Water Right Permit in the Name of Tumalo Irrigation District**

**Place of Use Map**

Deschutes, Jefferson, and Klamath Counties, Oregon

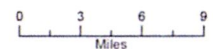

# Application for Secondary Water Right Permit Tumalo Irrigation District

**RECEIVED**

NOV 29 2017

Crescent Lake Dam Location  
Klamath County, Oregon  
Township 24 South, Range 6 East (W.M.)

**OWRD**

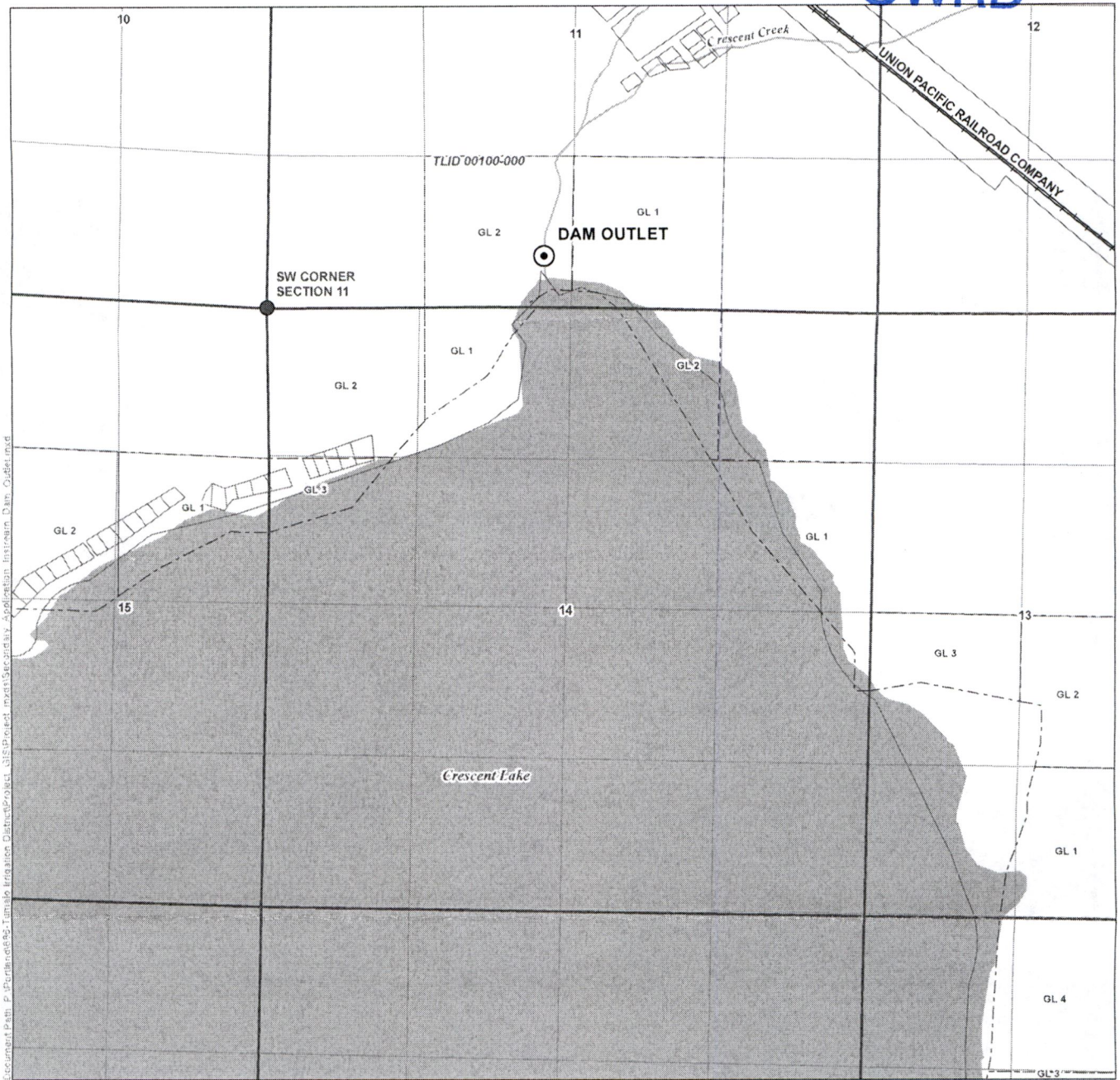

E:\Documents\Path\_P\Projects\ref\Tumalo\_Irrigation\_District\Project\_315\Project\_mxd\Secondary\_Application\Tumalo\_Dam\_Outlet.mxd

**LEGEND**

- Dam Outlet
- Government Lot (GL)
- Tax Lot
- Railroad
- Major Road
- Watercourse
- Waterbody

**OUTLET LOCATION DESCRIPTION**

**Dam Outlet**  
Located 450 feet North and 2,380 feet East from the SW corner of Section 11, Township 24 South, Range 6 East (W.M.)

**DISCLAIMER**

This map was prepared for the purpose of identifying the location of a water right only and it is not intended to provide legal dimensions or location of property ownership lines.

**MAP NOTES**

Date: September 8, 2017  
Data Sources: BLM, ESRI, Klamath Co., USGS

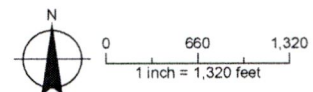

3-880479

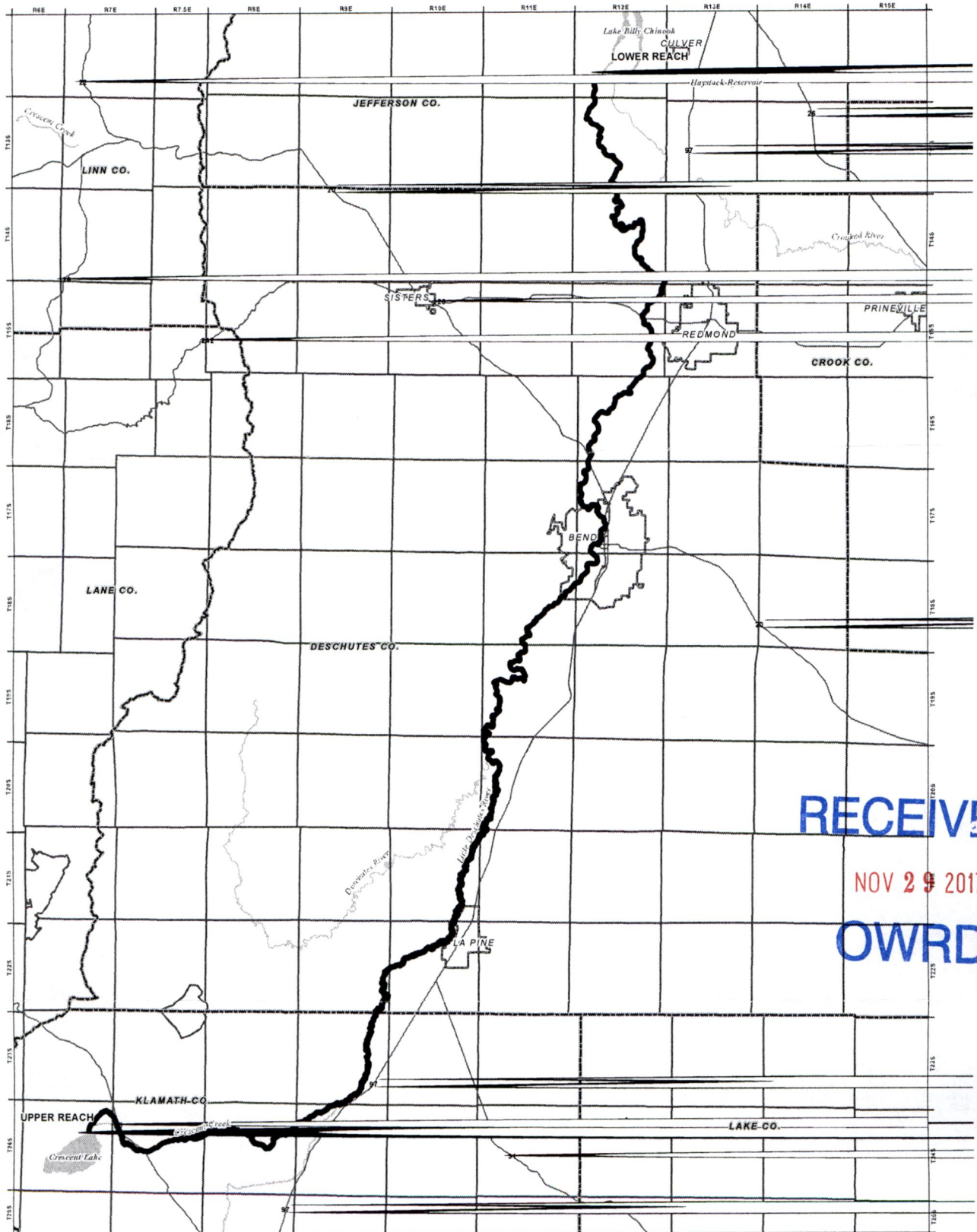

RECEIVED

NOV 29 2017

OWRD

- Place of Use (POU)
- County
- City
- Highway
- River
- Lake or Reservoir

**REACH DESCRIPTIONS**  
 (Identical to Instream Certificate 91923)  
 Upper Reach: 24 South, 6 East, Section 11, SESW  
 Lower Reach: 12 South, 12 East, Section 29, NWSW (Deschutes River mile 120)

This map was prepared for the purpose of identifying the location of a water right only and it is not intended to provide legal dimensions or location of property ownership lines.

Date: September 26, 2017  
 Data Sources: Data Sources: Crook Co. GIS, USGS, OGIC

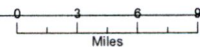

2-88478

# Application for Secondary Water Right Permit Tumalo Irrigation District

Crescent Lake Dam Location  
Klamath County, Oregon  
Township 24 South, Range 6 East (W.M.)

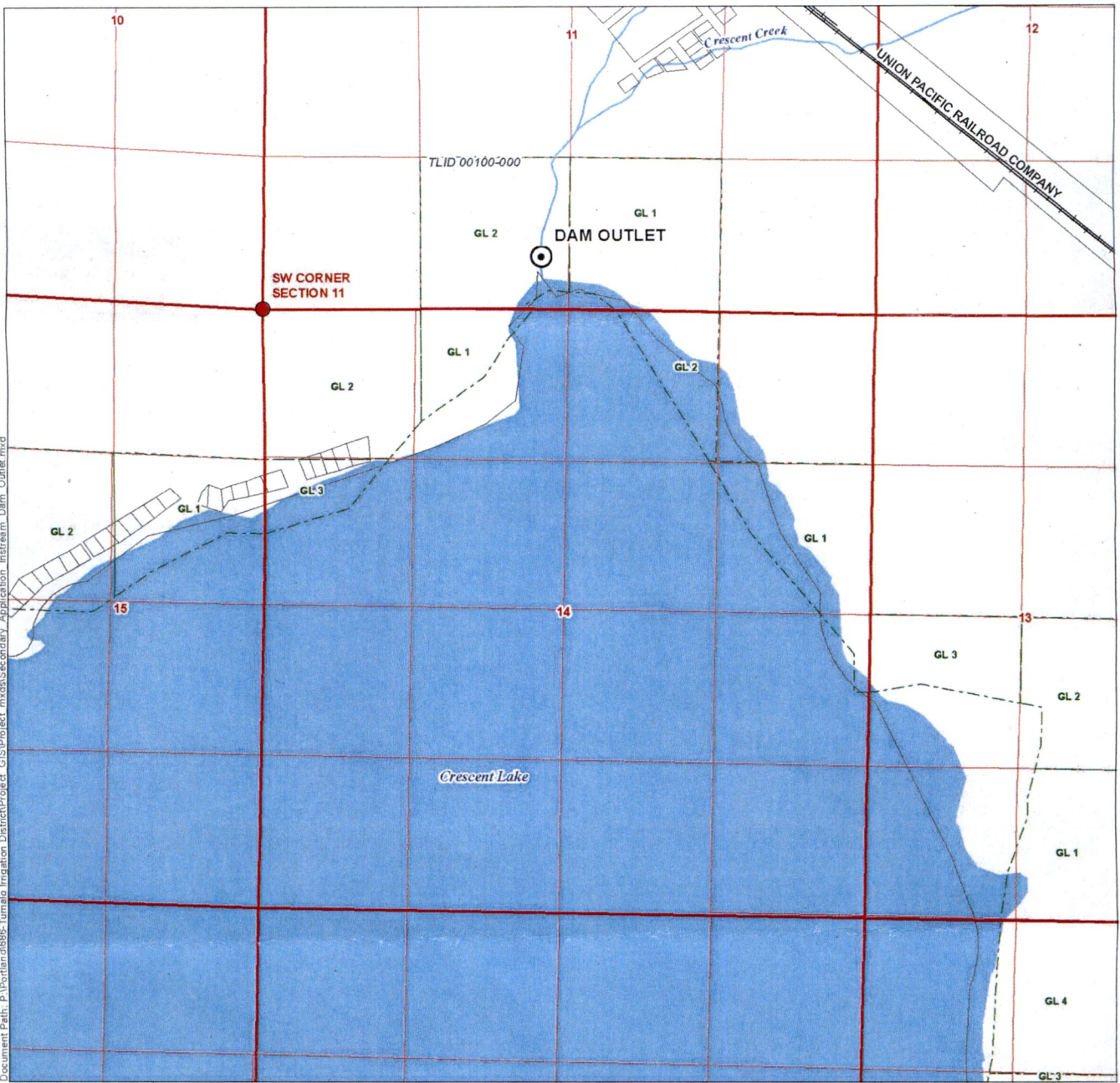

Document Path: P:\Portland\0696-Tumalo Irrigation District\Project\_GIS\Project.mxd\Secondary Application\_Instream\_Dam\_Outlet.mxd

**LEGEND**

- Dam Outlet
- Government Lot (GL)
- Tax Lot
- Railroad
- Major Road
- Watercourse
- Waterbody

**OUTLET LOCATION DESCRIPTION**

**Dam Outlet**  
Located 450 feet North and 2,380 feet East from the SW corner of Section 11, Township 24 South, Range 6 East (W.M.)

S-88478

**DISCLAIMER**

This map was prepared for the purpose of identifying the location of a water right only and it is not intended to provide legal dimensions or location of property ownership lines.

**MAP NOTES**

Date: September 8, 2017  
Data Sources: BLM, ESRI, Klamath Co., USGS

**RECEIVED**

NOV 29 2017

**OWRD**

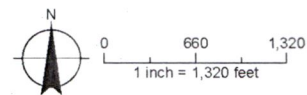

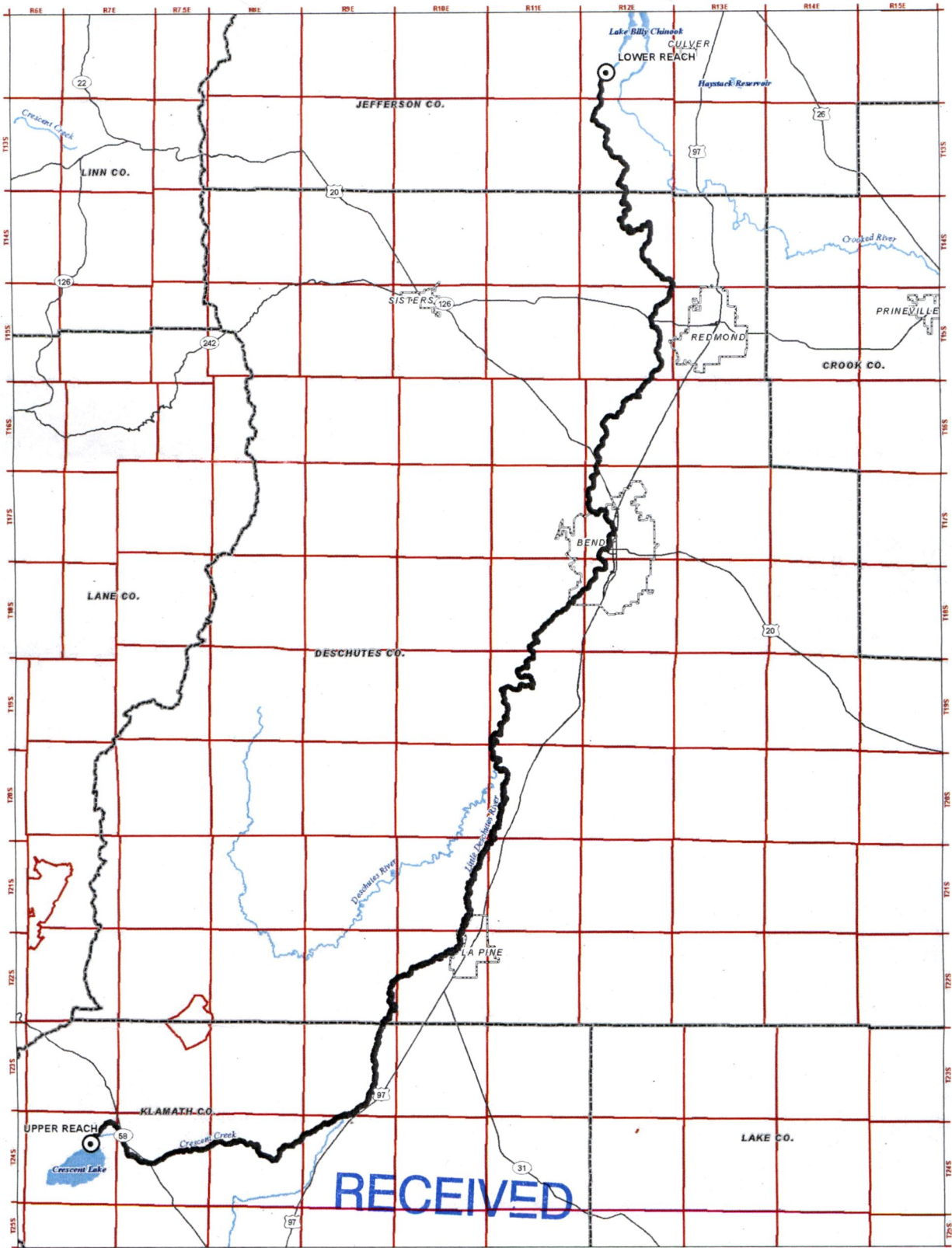

NOV 29 2017

RECEIVED

**LEGEND**

- Place of Use (POU)
- County
- City
- Highway
- River
- Lake or Reservoir

**REACH DESCRIPTIONS**

(Identical to Instream Certificate 91923)  
 Upper Reach: 24 South, 6 East, Section 11, SESW  
 Lower Reach: 12 South, 12 East, Section 29, NWSW (Deschutes River mile 120)

**DISCLAIMER**

This map was prepared for the purpose of identifying the location of a water right only and it is not intended to provide legal dimensions or location of property ownership lines.

Date: September 26, 2017  
 Data Sources: Data Sources: Crook Co. GIS, USGS, OGI

**OWRD**

**Application for Secondary Instream Water Right Permit in the Name of Tumalo Irrigation District**

**Place of Use Map**

Deschutes, Jefferson, and Klamath Counties, Oregon



S-00470

Project Path: P:\Portals\9325-Tumalo Irrigation District\Project\_GIS\Project\_mxd\Secondary\_Instream\_Water\_Right\_POU.mxd



# Application for Secondary Water Right Permit Tumalo Irrigation District

Crescent Lake Dam Location  
Klamath County, Oregon  
Township 24 South, Range 6 East (W.M.)

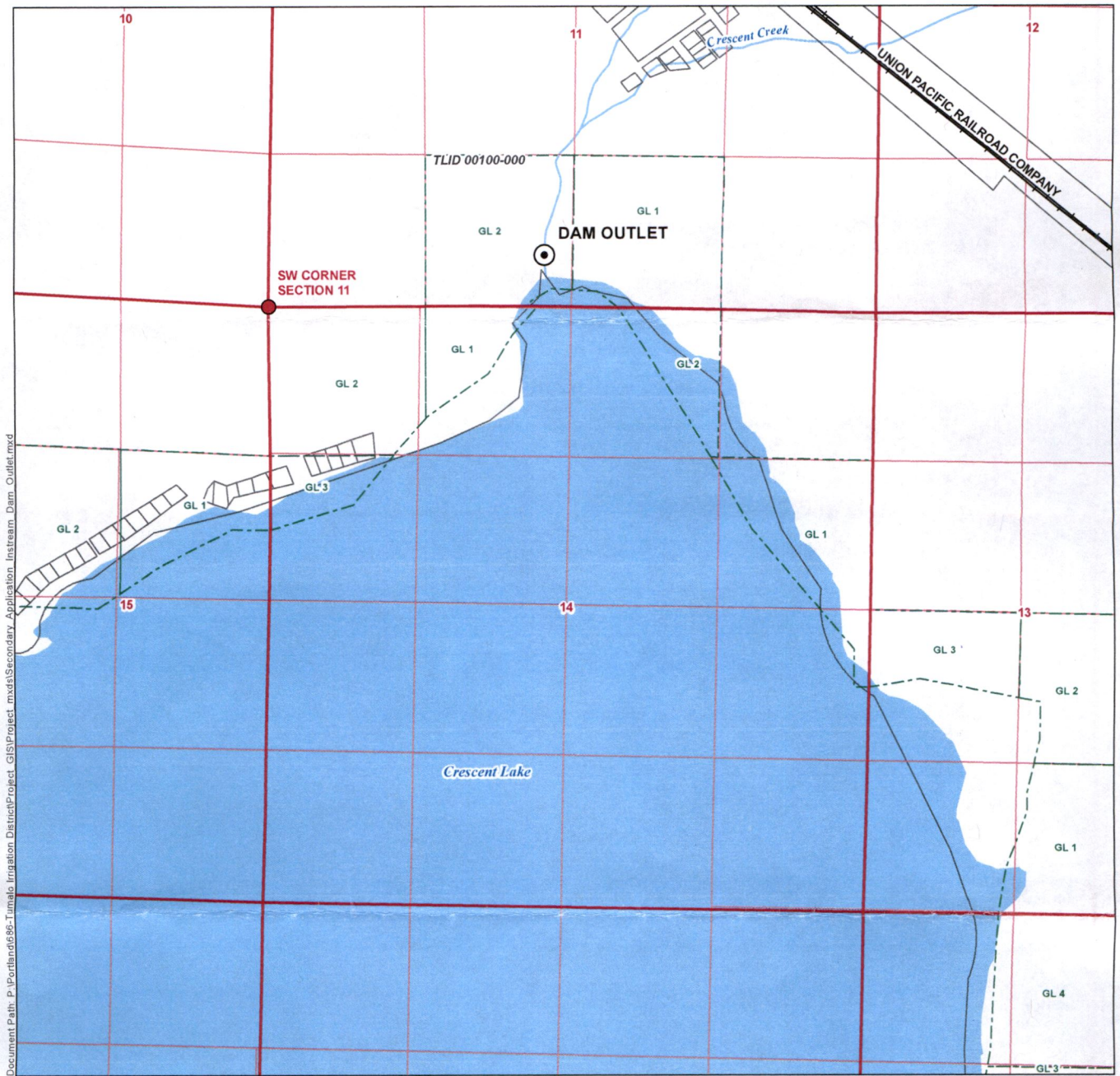

Document Path: P:\Fourband\696-Tumalo Irrigation District\Project\_GIS\Project\_mxd\Secondary Application\_Instream\_Dam\_Outlet.mxd

### LEGEND

- Dam Outlet
- Government Lot (GL)
- Tax Lot
- Railroad
- Major Road
- Watercourse
- Waterbody

### OUTLET LOCATION DESCRIPTION

**Dam Outlet**  
Located 450 feet North and 2,380 feet East from the SW corner of Section 11, Township 24 South, Range 6 East (W.M.)

### DISCLAIMER

This map was prepared for the purpose of identifying the location of a water right only and it is not intended to provide legal dimensions or location of property ownership lines.

### MAP NOTES

Date: September 8, 2017  
Data Sources: BLM, ESRI, Klamath Co., USGS

**RECEIVED**

NOV 29 2017

**OWRD**

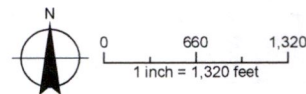

S-88478

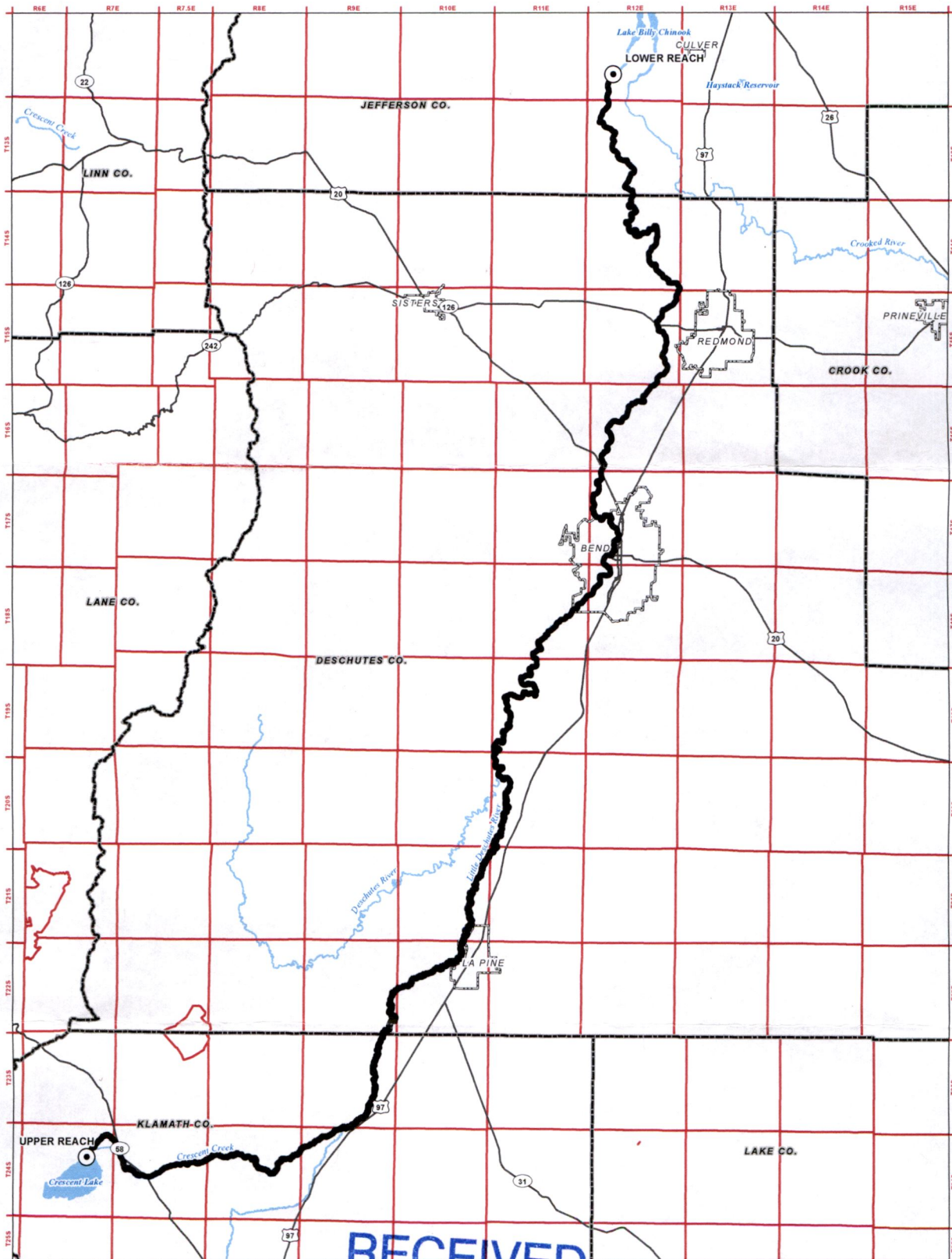

RECEIVED

**LEGEND**

- Place of Use (POU)
- County
- City
- Highway
- River
- Lake or Reservoir

**REACH DESCRIPTIONS**

(Identical to Instream Certificate 91923)  
**Upper Reach:** 24 South, 6 East, Section 11, SESW  
**Lower Reach:** 12 South, 12 East, Section 29, NWSW (Deschutes River mile 120)

**DISCLAIMER**

This map was prepared for the purpose of identifying the location of a water right only and it is not intended to provide legal dimensions or location of property ownership lines.

Date: September 26, 2017  
 Data Sources: Data Sources: Crook Co. GIS, USGS, OGIIC

Document Path: P:\Portland\686-Tumalo Irrigation District\Project\_GIS\Project\_mxd\Secondary\_instream\_VR\_App\_POU.mxd

NOV 29 2017

OWRD

**Application for Secondary Instream  
 Water Right Permit in the Name of  
 Tumalo Irrigation District**

**Place of Use Map**

Deschutes, Jefferson, and Klamath Counties, Oregon

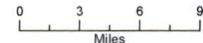

P-88479

# Application for Secondary Water Right Permit Tumalo Irrigation District

Crescent Lake Dam Location  
Klamath County, Oregon  
Township 24 South, Range 6 East (W.M.)

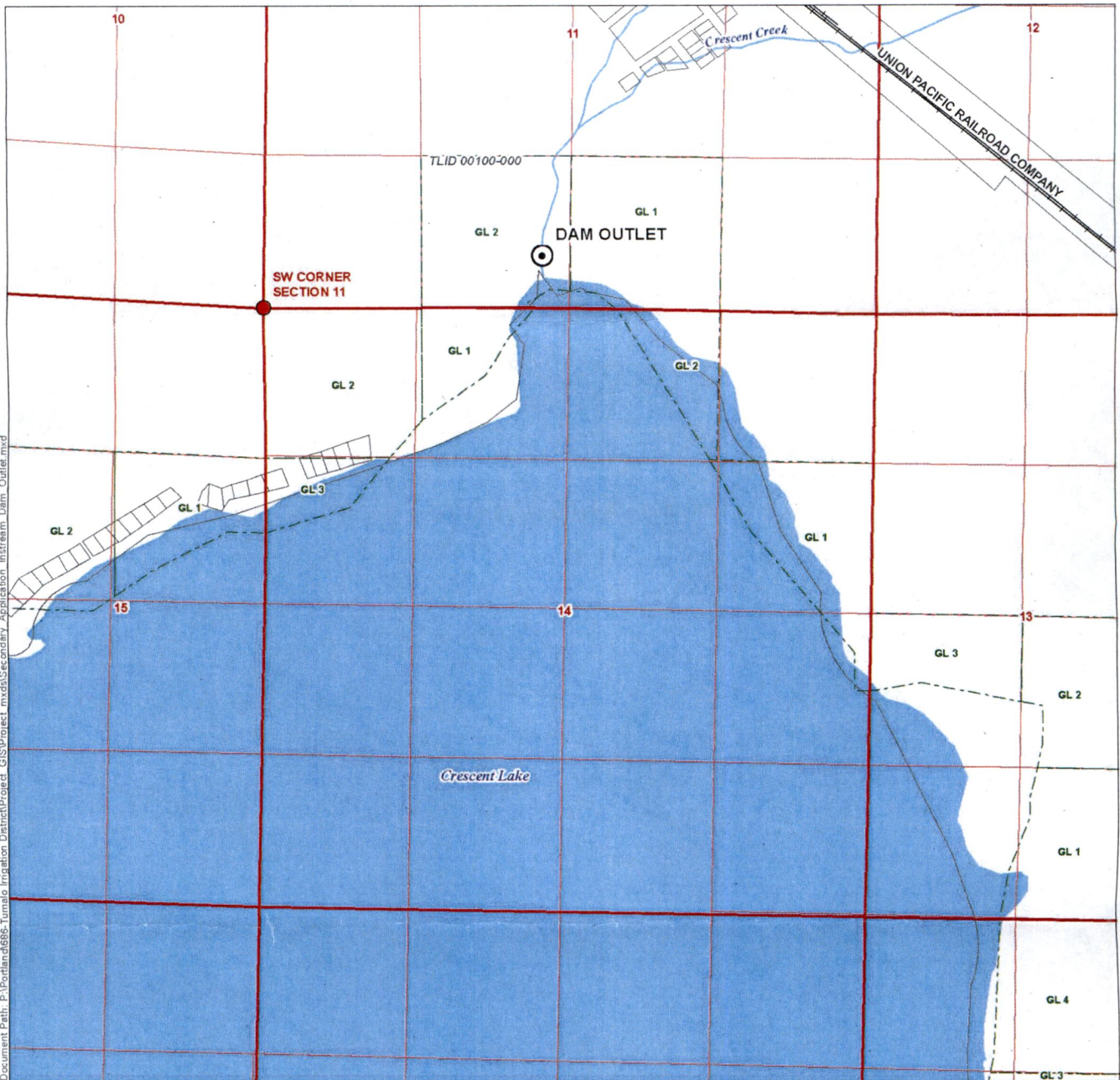

Document Path: P:\Portland\666-Tumalo Irrigation District\Project\_GIS\Project\_mxd\Secondary Application\_Instream\_Dam\_Outlet.mxd

## LEGEND

-  Dam Outlet
-  Government Lot (GL)
-  Tax Lot
-  Railroad
-  Major Road
-  Watercourse
-  Waterbody

## OUTLET LOCATION DESCRIPTION

**Dam Outlet**  
Located 450 feet North and 2,380 feet East from the SW corner of Section 11, Township 24 South, Range 6 East (W.M.)

## DISCLAIMER

This map was prepared for the purpose of identifying the location of a water right only and it is not intended to provide legal dimensions or location of property ownership lines.

## MAP NOTES

Date: September 8, 2017  
Data Sources: BLM, ESRI, Klamath Co., USGS

**RECEIVED**

NOV 29 2017

**OWRD**



0 660 1,320  
1 inch = 1,320 feet



S-88478

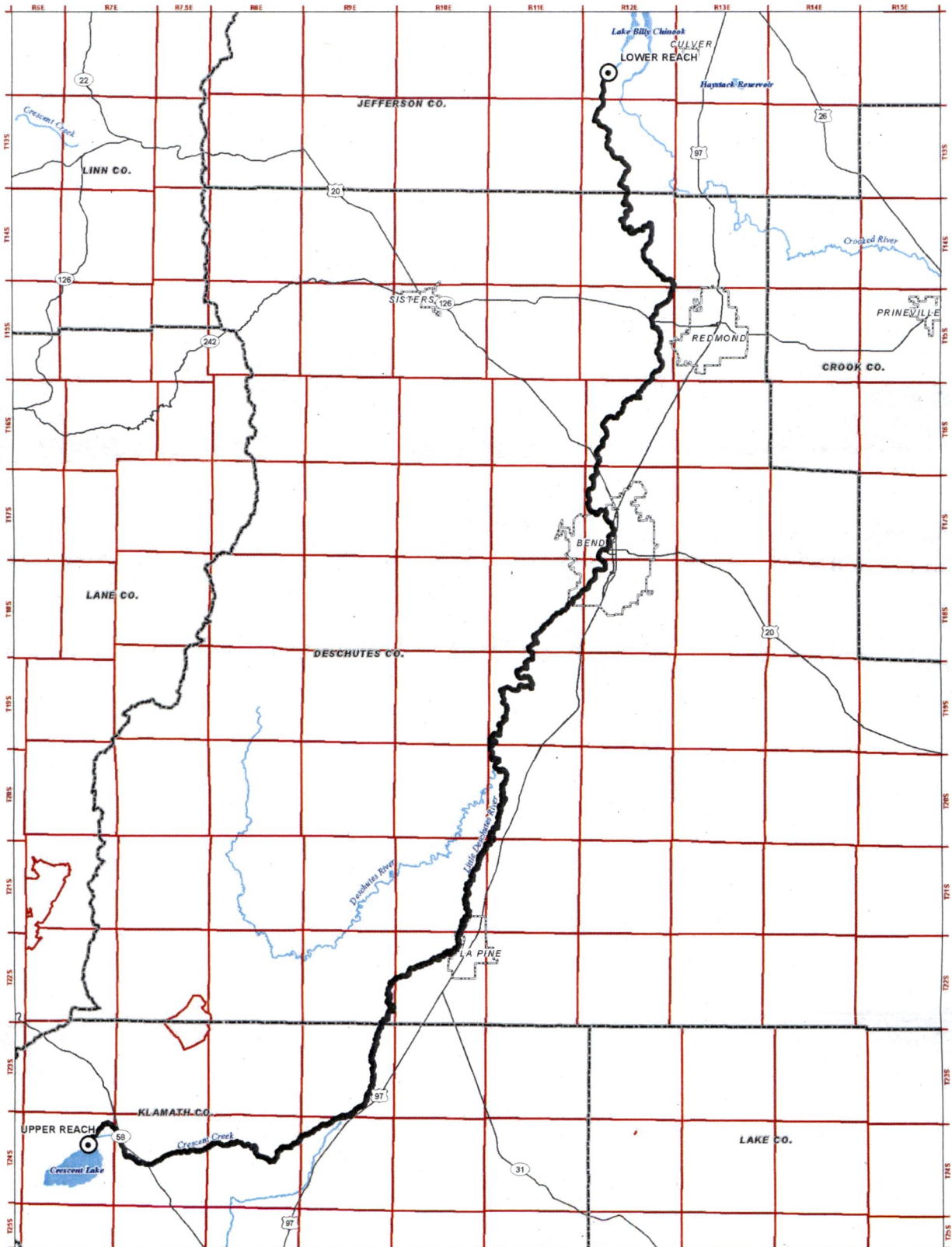

- LEGEND**
- Place of Use (POU)
  - County
  - City
  - Highway
  - River
  - Lake or Reservoir

**REACH DESCRIPTIONS**  
 (Identical to Instream Certificate 91923)  
 Upper Reach: 24 South, 6 East, Section 11, SESW  
 Lower Reach: 12 South, 12 East, Section 29, NWSW (Deschutes River mile 120)

**DISCLAIMER**  
 This map was prepared for the purpose of identifying the location of a water right only and it is not intended to provide legal dimensions or location of property ownership lines.  
 Date: September 28, 2017  
 Data Sources: Data Sources: Crook Co. GIS, USGS, OGI

**RECEIVED**

NOV 29 2017

**OWRD**

**Application for Secondary Instream  
 Water Right Permit in the Name of  
 Tumalo Irrigation District  
 Place of Use Map**

Deschutes, Jefferson, and Klamath Counties, Oregon



P-88478