

Water Right Application to Use Groundwater Points of Appropriation and Place of Use Map

Suprise Valley Electrification Corporation

Lake County

Township 33 South, Range 18 East (W.M.)

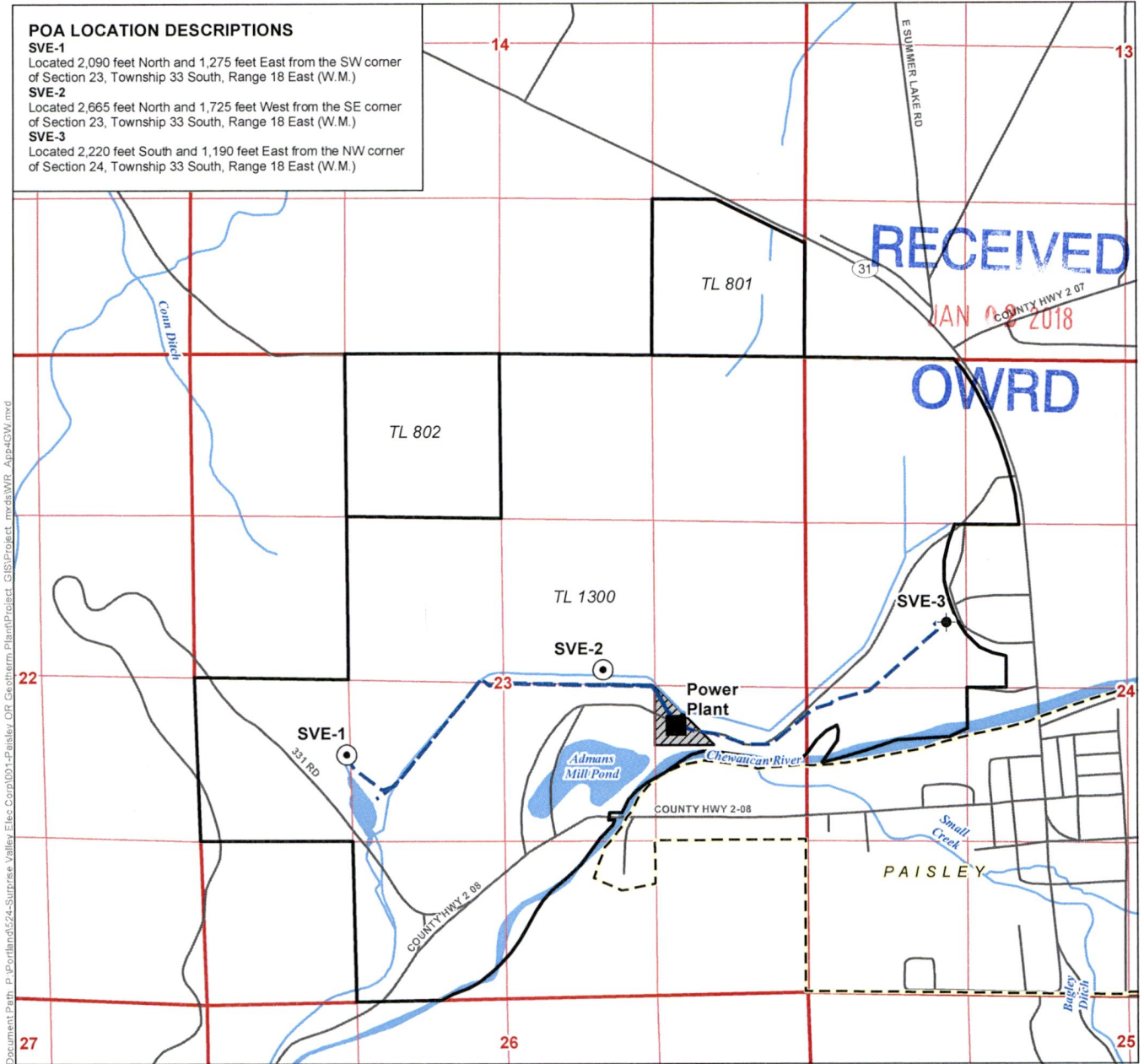

POA LOCATION DESCRIPTIONS
SVE-1
 Located 2,090 feet North and 1,275 feet East from the SW corner of Section 23, Township 33 South, Range 18 East (W.M.)
SVE-2
 Located 2,665 feet North and 1,725 feet West from the SE corner of Section 23, Township 33 South, Range 18 East (W.M.)
SVE-3
 Located 2,220 feet South and 1,190 feet East from the NW corner of Section 24, Township 33 South, Range 18 East (W.M.)

Document Path: P:\ord\land\524-Suprise Valley Elec Corp\001-Paisley OF Groundwater Plant\Project_GIS\Project_mxd\WFR_Appd\GW.mxd

- LEGEND**
- Point of Appropriation (POA)
 - ◆ Injection Well (SVE-3)
 - Power Plant
 - Power Plant Piping System
 - ▨ Place of Use (POU)
 - Tax Lot
 - Paisley City Limit
 - Road
 - ~ Watercourse
 - Waterbody

DISCLAIMER
 This map was prepared for the purpose of identifying the location of a water right only and it is not intended to provide legal dimensions or location of property ownership lines.

MAP NOTES
 Date: September 20, 2017
 Data Sources: OWRD, USGS, US BLM, ESRI

RECEIVED BY OWRD
DEC 04 2017
SALEM, OR

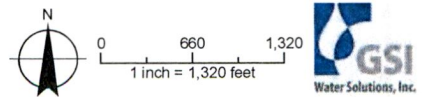

G-18594