

# Water Right Application to Use Groundwater Points of Appropriation and Place of Use Map

Suprise Valley Electrification Corporation

Lake County  
Township 33 South, Range 18 East (W.M.)

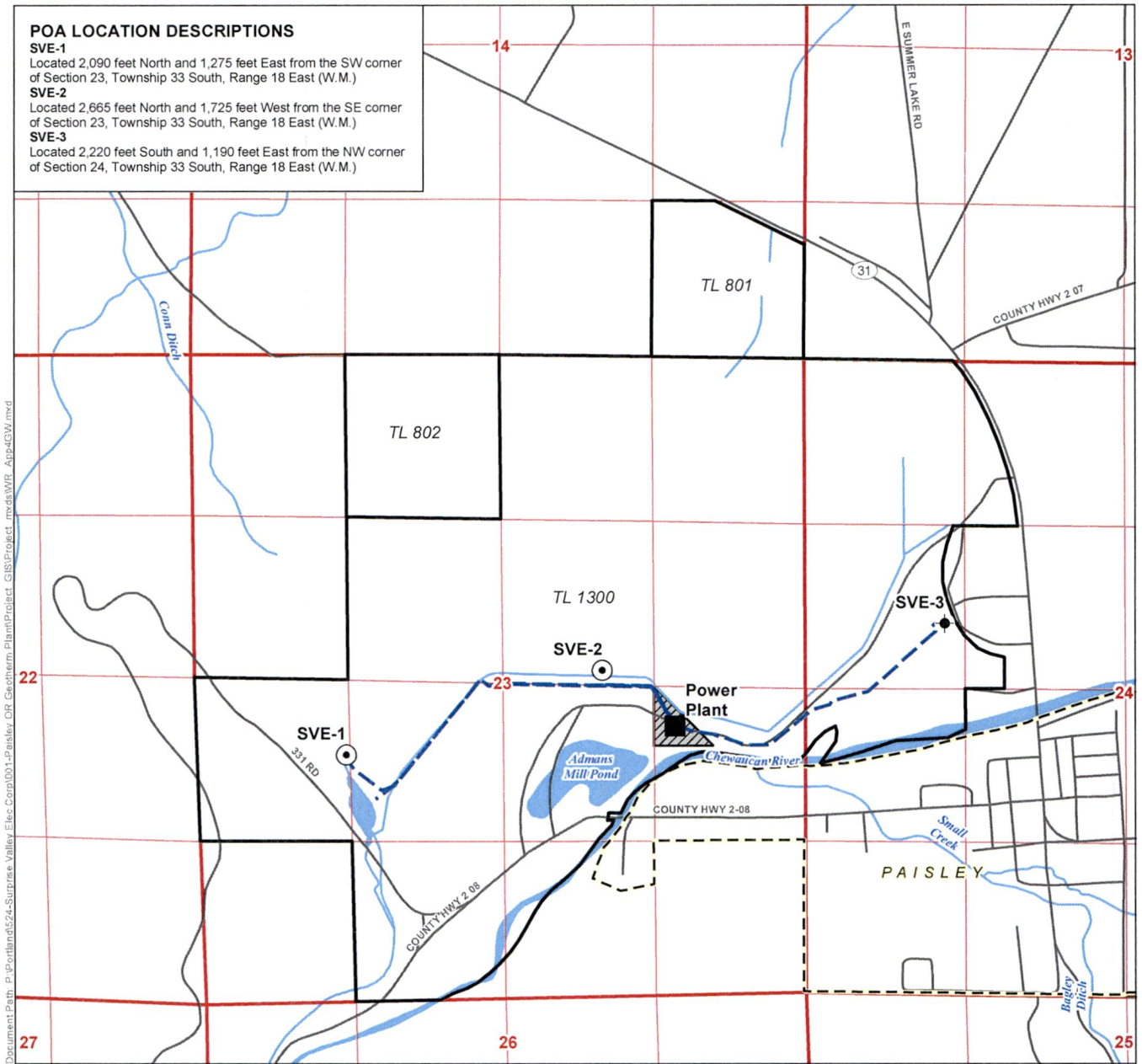

**POA LOCATION DESCRIPTIONS**  
**SVE-1**  
 Located 2,090 feet North and 1,275 feet East from the SW corner of Section 23, Township 33 South, Range 18 East (W.M.)  
**SVE-2**  
 Located 2,665 feet North and 1,725 feet West from the SE corner of Section 23, Township 33 South, Range 18 East (W.M.)  
**SVE-3**  
 Located 2,220 feet South and 1,190 feet East from the NW corner of Section 24, Township 33 South, Range 18 East (W.M.)

Document Path: P:\ord\hand\6524-Suprise Valley Elec. Corp\001-Paisley OF Geoterm Plant\Project\_GIS\Project\_mxd\Map\_App-GW.mxd

- LEGEND**
- Point of Appropriation (POA)
  - Injection Well (SVE-2)
  - Power Plant
  - Power Plant Piping System
  - Place of Use (POU)
  - Tax Lot
  - Paisley City Limit
  - Road
  - Watercourse
  - Waterbody

**DISCLAIMER**  
 This map was prepared for the purpose of identifying the location of a water right only and it is not intended to provide legal dimensions or location of property ownership lines.

RECEIVED BY OWRD  
 DEC 04 2017  
 SALEM, OR

**RECEIVED**  
 MAP NOTES  
 Date: September 20, 2017  
 Data Sources: OWRD, USGS, US BLM, ESRI

JAN 02 2018

**OWRD**

0 660 1,320  
 1 inch = 1,320 feet

6-18-17