







ADJUDICATION SURVEY OF COW CREEK HARNEY COUNTY OREGON

MAP SHOWING STREAMS AND IRRIGATED LANDS PREPARED
IN ACCORDANCE WITH SECTION 47-611 OREGON CODE 1930
FOR USE IN THE DETERMINATION OF WATER RIGHTS BEFORE
THE STATE ENGINEER
OF THE

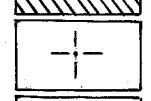
STATE OF OREGON
OFFICE OF THE STATE ENGINEER 1936
CHAS. E. STRICKLIN STATE ENGINEER

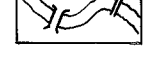
LEGEND

-  DITCHES AND DIVERSION POINTS
-  NATURAL DEPRESSIONS
-  IRRIGATED LANDS
-  LOCATED CORNERS
-  BUILDINGS AND FENCES
-  CREEKS, DAMS AND BRIDGES

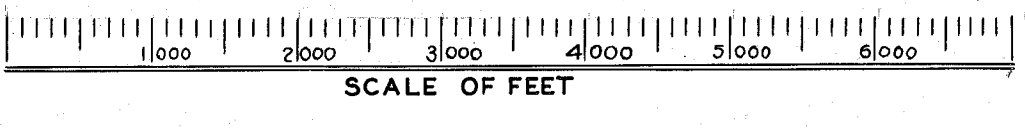

T. 20 S., R. 33 E.

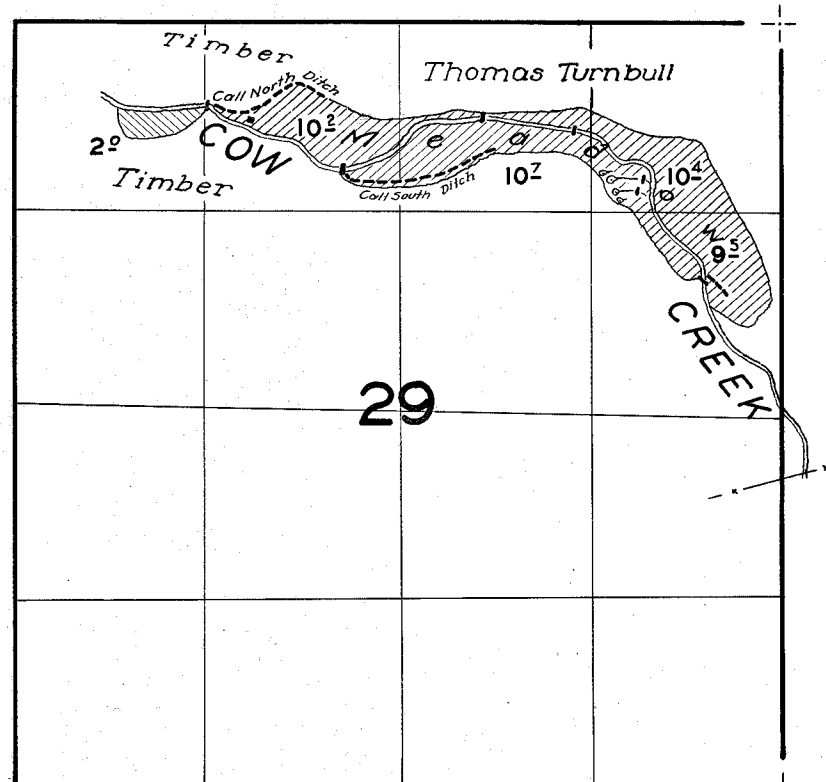

Surveyed July 1, 1936

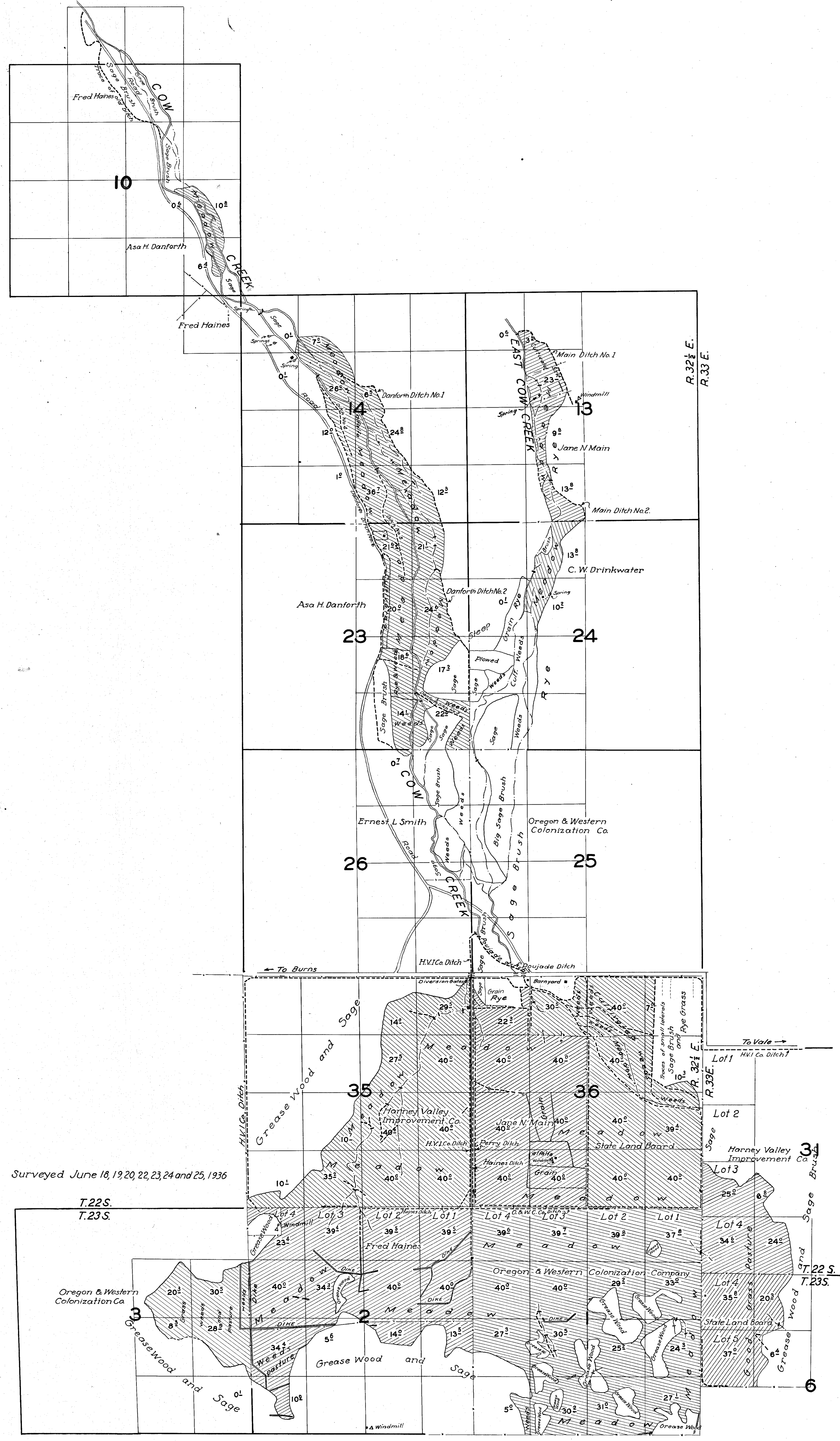

Surveyed June 18, 19, 20, 22, 23, 24 and 25, 1936

T. 22 S.
T. 23 S.

