

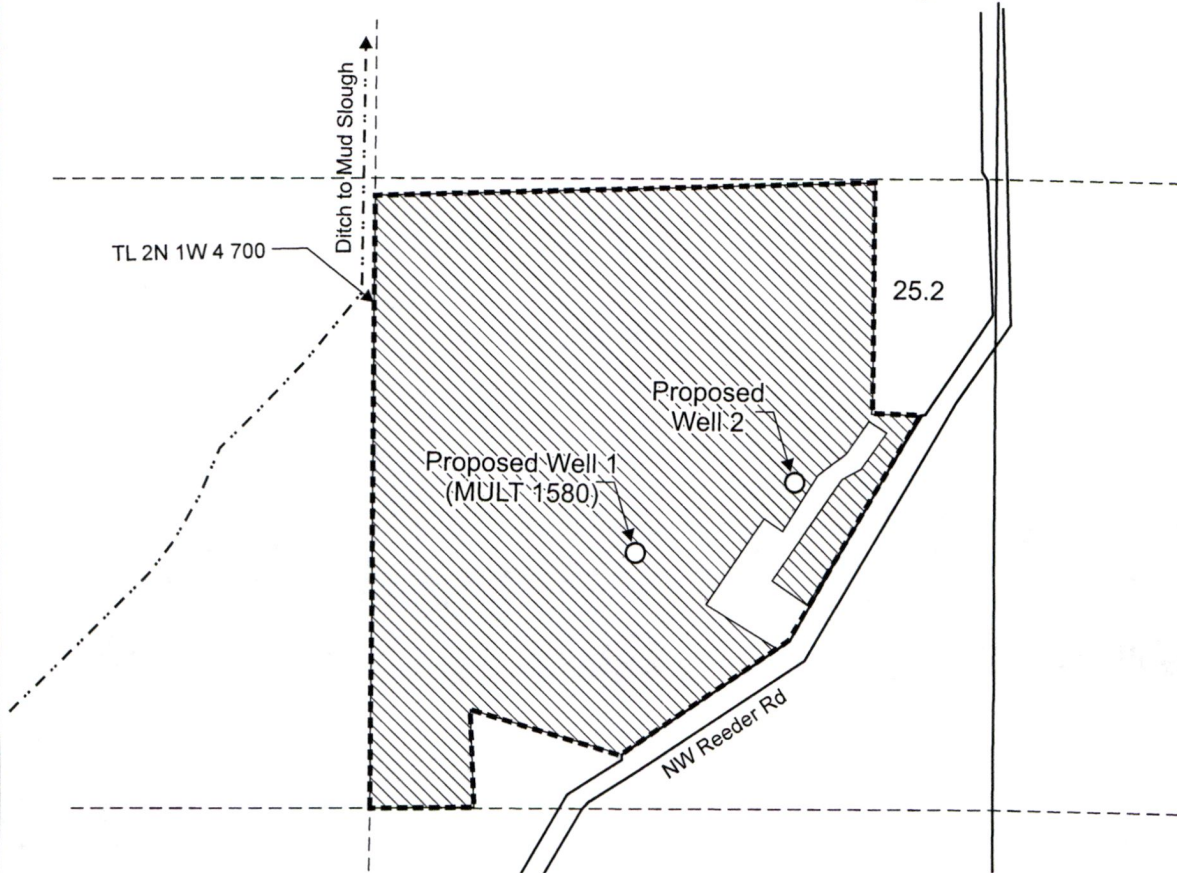

T.2N. R.1W. Section 4, W.M.



Proposed Well 1 (MULT 1580) is located 1,830 feet north and 740 feet west from the SE corner, Section 4.

Proposed Well 2 is located 1,980 feet north and 400 feet west from the SE corner, Section 4.

 Area (25.2 Acres) to be Irrigated

 Tax lot boundary

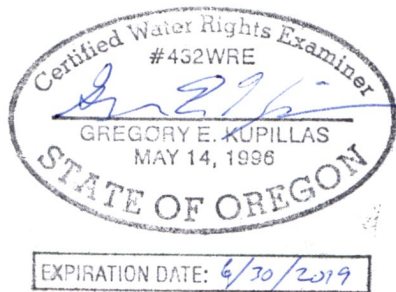

RECEIVED

MAR 23 2018

OWRD

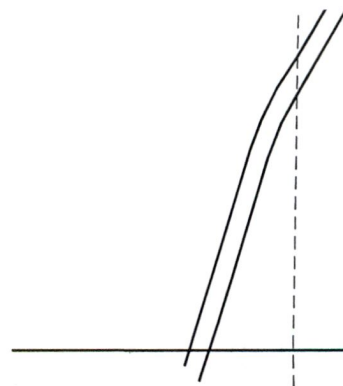

This map was prepared for the purpose of identifying the location of a water right only and is not intended to provide legal dimensions or location of property ownership lines.

Water Right Application Map

Columbia Holdings LLC c/o Peter Stott
T.2N. R.1W. Section 4, W.M.

Pacific Hydro-Geology Inc.

03/2018

StottGWApp.cdr

6-18629