

Township 22 S, Range 31 E.

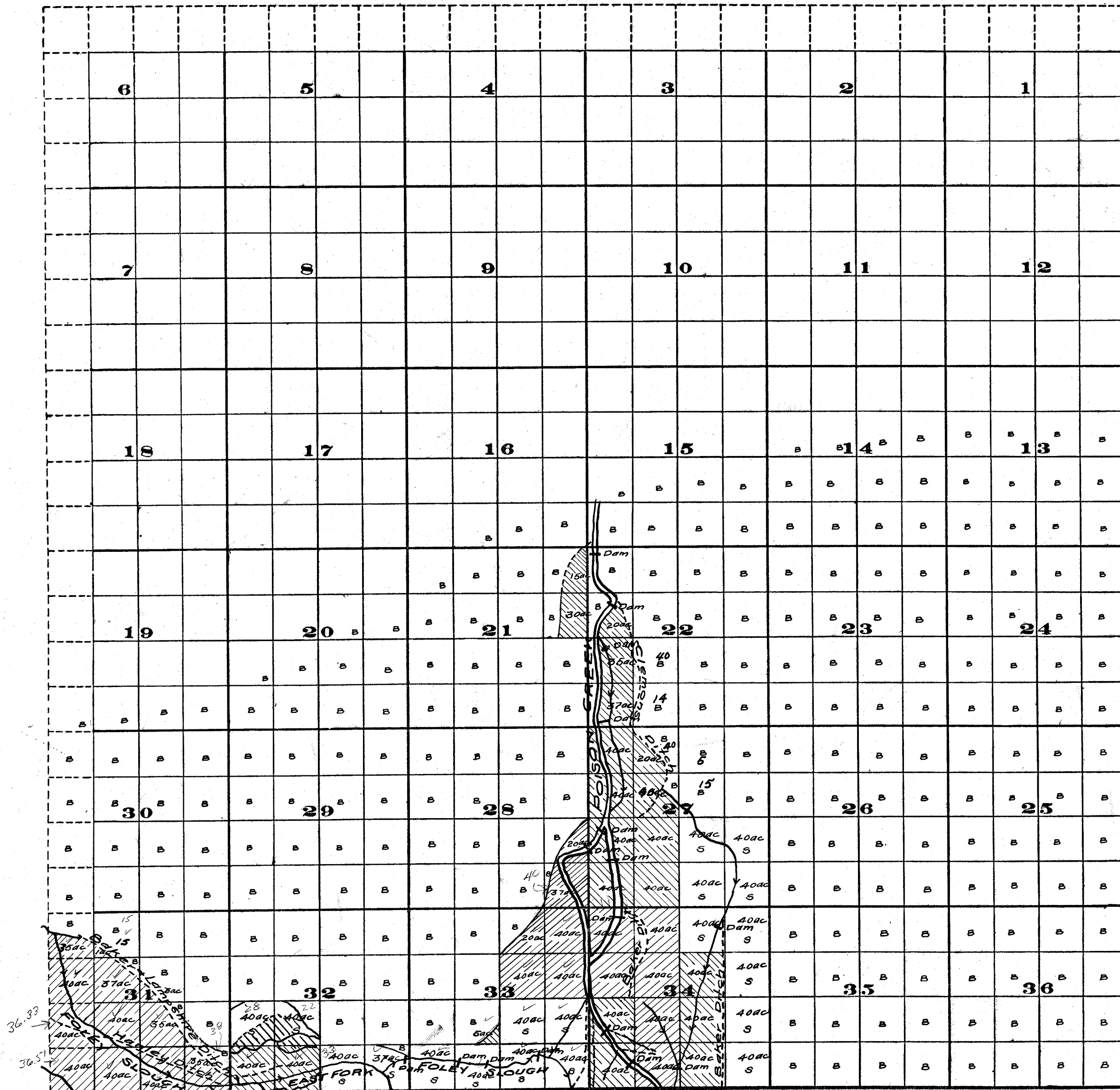



Survey by J.S. McMahon 1811 Re Survey by H.M. Donnelly 1912

FROM OFFICE OF THE STATE ENGINEER, SALEM, OREGON

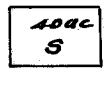
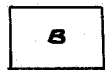

LEGEND

-  Meadow Land with Irrigated Area
-  Grain Land with Irrigated Area
-  Sub Irrigated Land with Area
-  Sage Brush

ADJUDICATION OF SILVIES RIVER & TRIBUTARIES

John H. Lewis State Engineer.

Examined Aug 22, 1912