

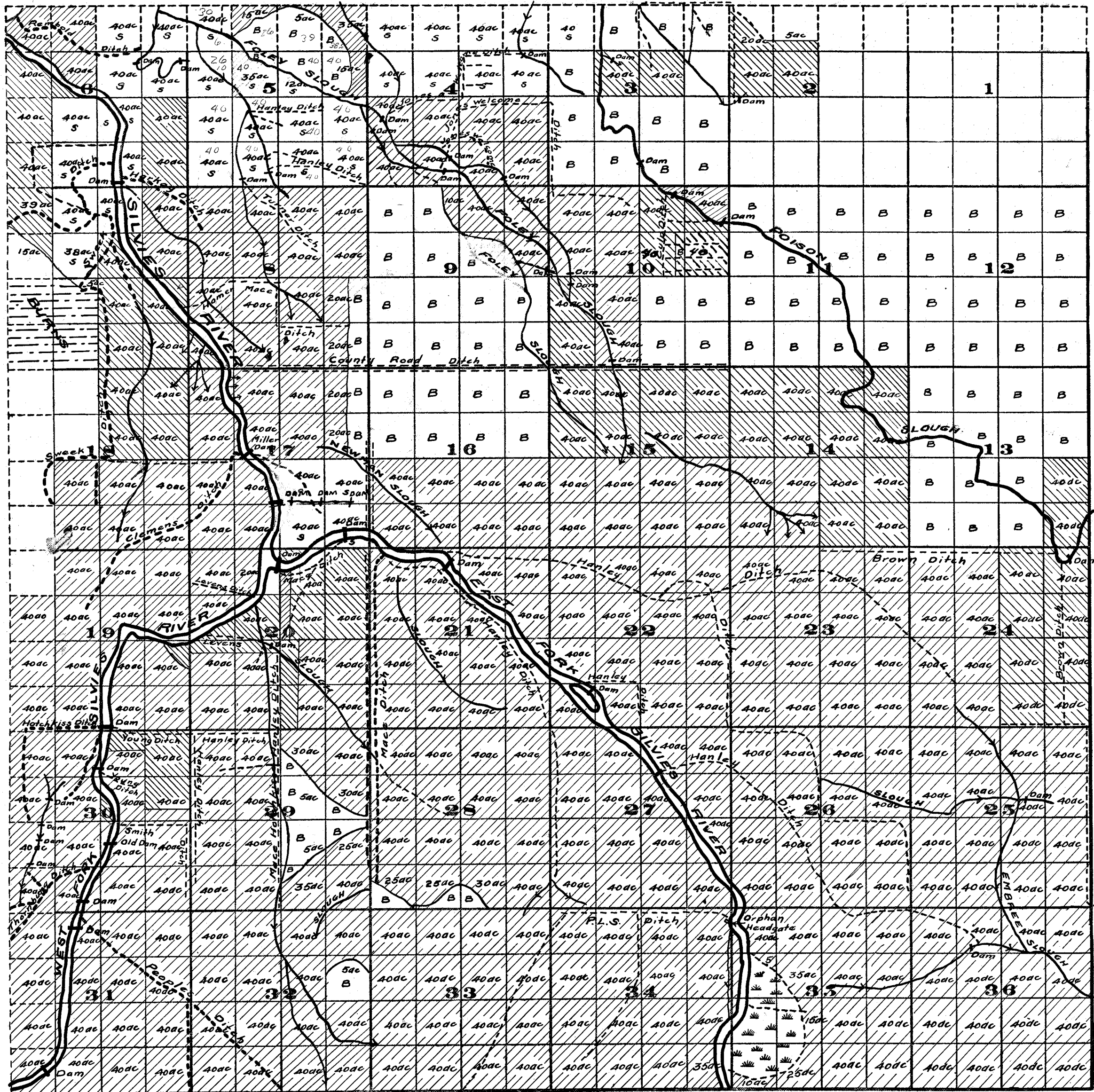

# Township 23S, Range 31E.

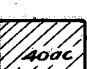

Survey by J.S. McMahon 1911 Resurvey by H.K. Donnelly 1912.  
 Scale of Feet.

FROM OFFICE OF THE STATE ENGINEER, SALEM, OREGON

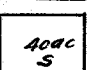
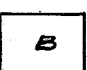
- LEGEND**
-  Meadow Land with Irrigated Area
  -  Grain and Cultivated Land with Irrigated Area
  -  Sub Irrigated Land with Area
  -  Sage Brush Land

## ADJUDICATION OF SILVIE RIVER & TRIBUTARIES

John H. Lewis State Engineer

Examined Aug 22, 1912