

T.20S. R.5W. Section 2, W.M.

35 36





J. Thompson
DLC 37

TL 20 5W 02 801

2 1

Dam is located 455 feet south and 1,030 feet west (Reference Certificate 90716: 300 feet south and 900 feet west) from the NE 1/16 corner, Section 2.

Point of Diversion on the Reservoir is located 1,840 feet south and 2,215 feet west from the NE corner, Section 2.

-  West Reservoir
-  Acres (10.7 acres) to be irrigated from Reservoir.
-  Mainlines
-  Tax lot boundary
-  Donation Land Claim boundary

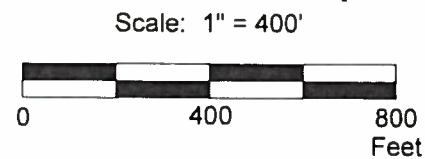
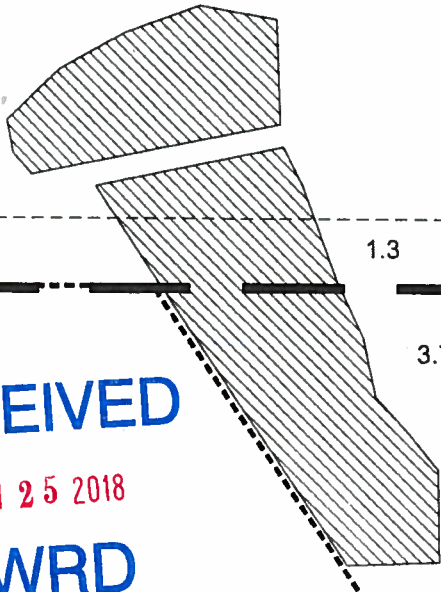
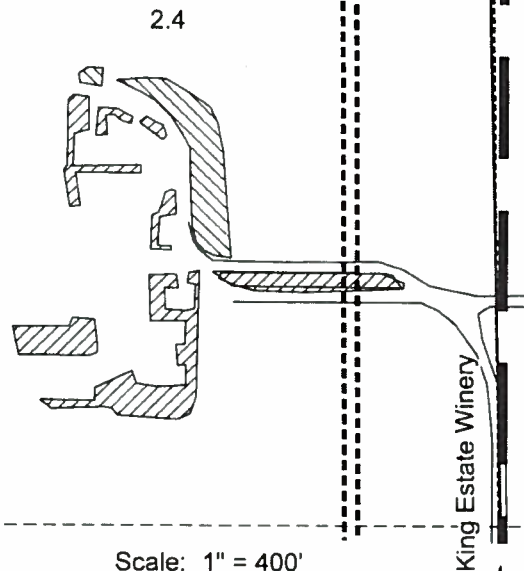
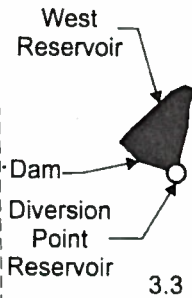
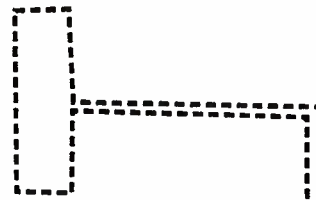

This map was prepared for the purpose of identifying the location of a water right only and is not intended to provide the dimensions or location of property ownership lines.

Surface Water Application Map

King Estate Winery
T.19S. R.5W. Sec. 35 & 36,
T.20S, R.5W. Sec. 1, 2, 11 & 12, W.M.

Pacific Hydro-Geology Inc.

07/2017
Rev: 06/2018

RECEIVED
JUN 25 2018
DWRD

S-88571

King Estates Winery Application Map.pdf