

Township 20S, Range 30E.

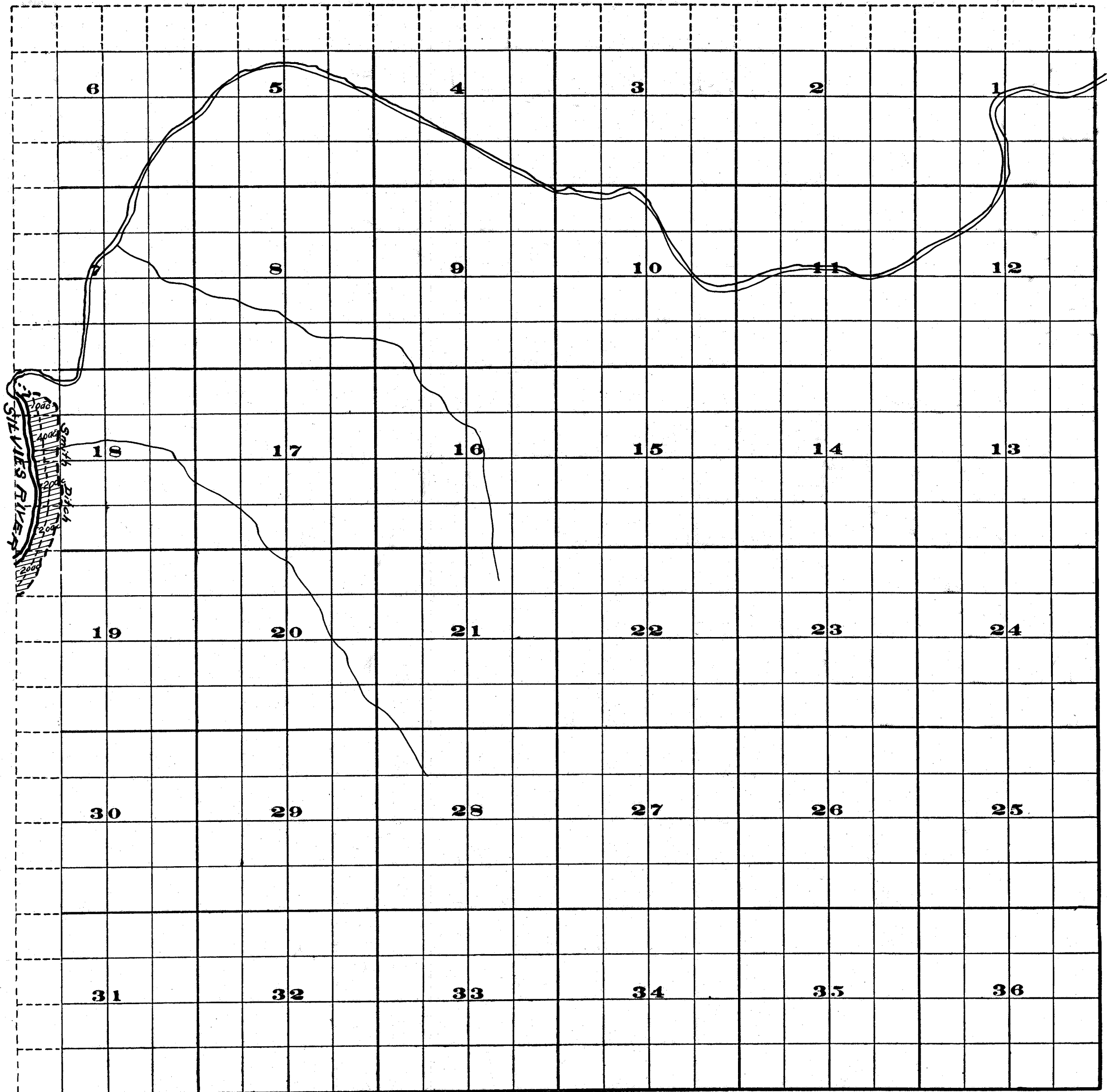



Survey by J.S. Mahan July 1911 Resurvey by H.K. Donnelly 1912.

Scale of Feet.

FROM OFFICE OF THE STATE ENGINEER, SALEM, OREGON

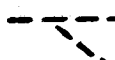
LEGEND

-  Irrigated Land with Area
-  Ditches
-  Streams

ADJUDICATION
 OF
SILVIES RIVER & TRIBUTARIES
 JOHN H. LEWIS STATE ENGINEER
 Examined Aug 22, 1912

Township 23S, Range 31E.

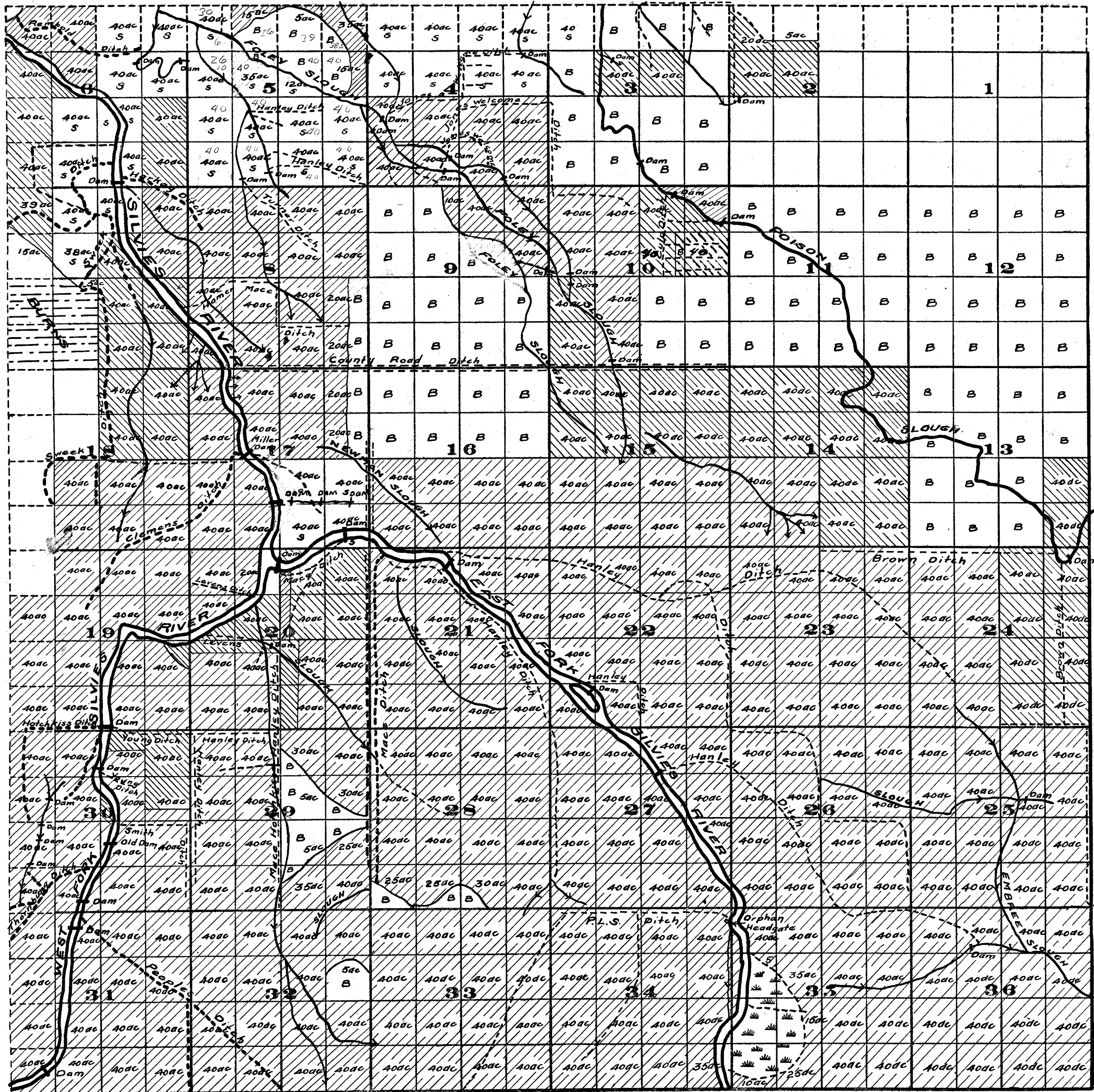

Survey by J.S. McMahon 1911 Resurvey by H.K. Donnelly 1912.

Scale of Feet.

FROM OFFICE OF THE STATE ENGINEER, SALEM, OREGON

- LEGEND**
- Meadow Land with Irrigated Area
 - Grain and Cultivated Land with Irrigated Area
 - Sub Irrigated Land with Area
 - Sage Brush Land

**ADJUDICATION
OF
SILVIE RIVER & TRIBUTARIES**

John H. Lewis State Engineer

Examined Aug 22, 1912