

22853 Harris Rd Gallagher Proposed Pond 1:4000

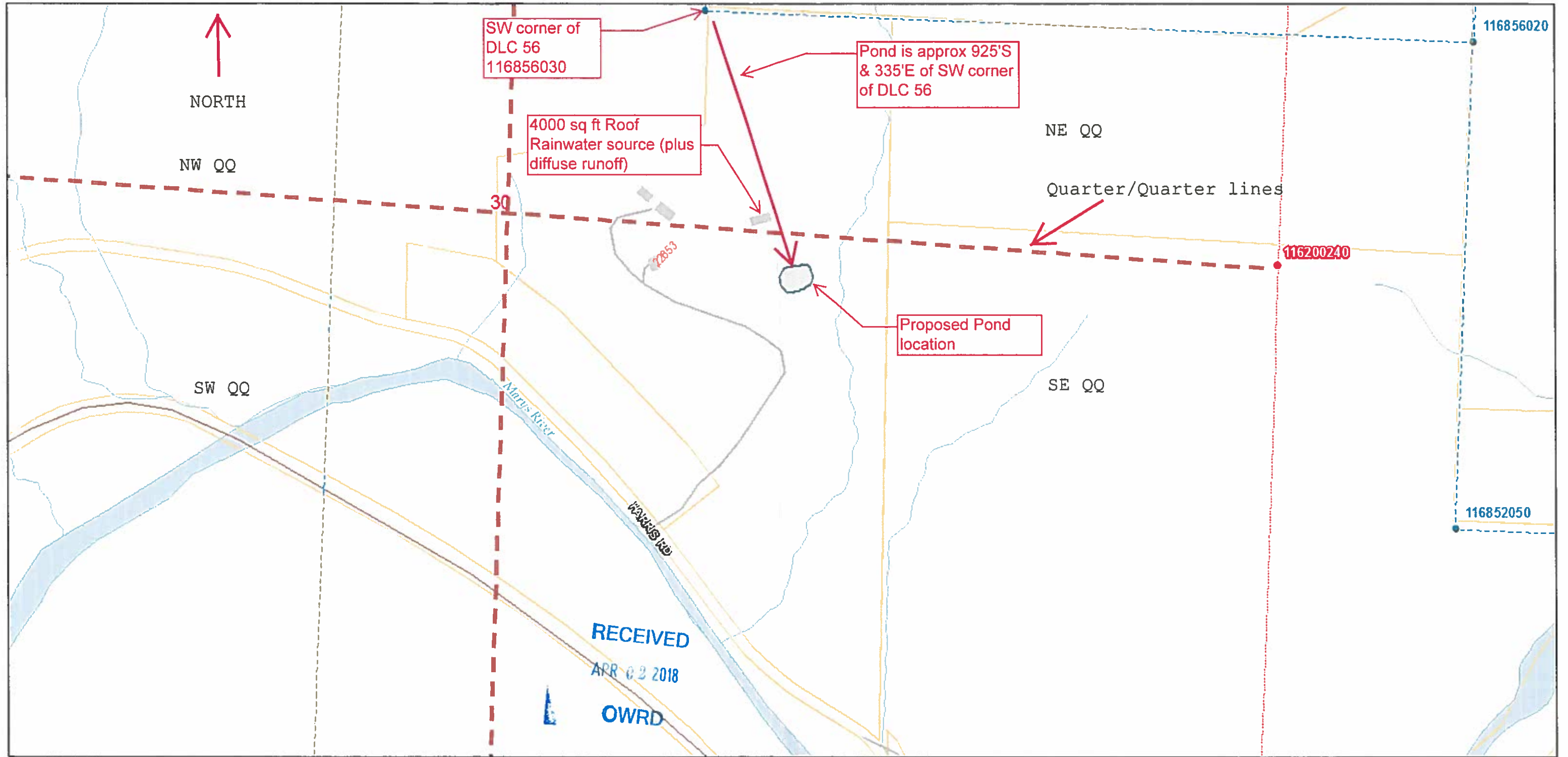

2/22/2018, 12:14:29 AM

ArcGIS_Public.SDE.sectionlines

SEC-LINE

ArcGIS_Public.SDE.section_centroids

TaxlotOwners

ArcGIS_Public.SDE.Railroads

ArcGIS_Public.SDE.Roads

ArcGIS_Public.SDE.dlc_comer_index

ArcGIS_Public.SDE.section_corner_index

Donation Land Claims

ArcGIS_Public.SDE.survey_index

County_Addresses

Buildings

Driveways

Hydro_polys

Hydro_lines

Cities and Places

County Boundary

County Parks

11S Township

6W Range

30 Section

NE/SE Quarter/Quarter

Tax Lot: 302

1:4,000

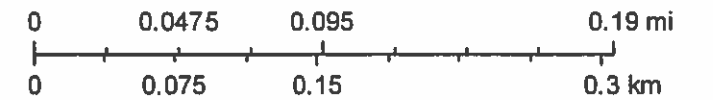

Benton County, Oregon

Benton County, Oregon

This product is for informational purposes and may not have been prepared for, or be suitable for legal, engineering, or surveying purposes. Users of this information should review or consult the primary data and information.

R-88461

22853 Harris Rd Gallagher Proposed Pond 1:1320

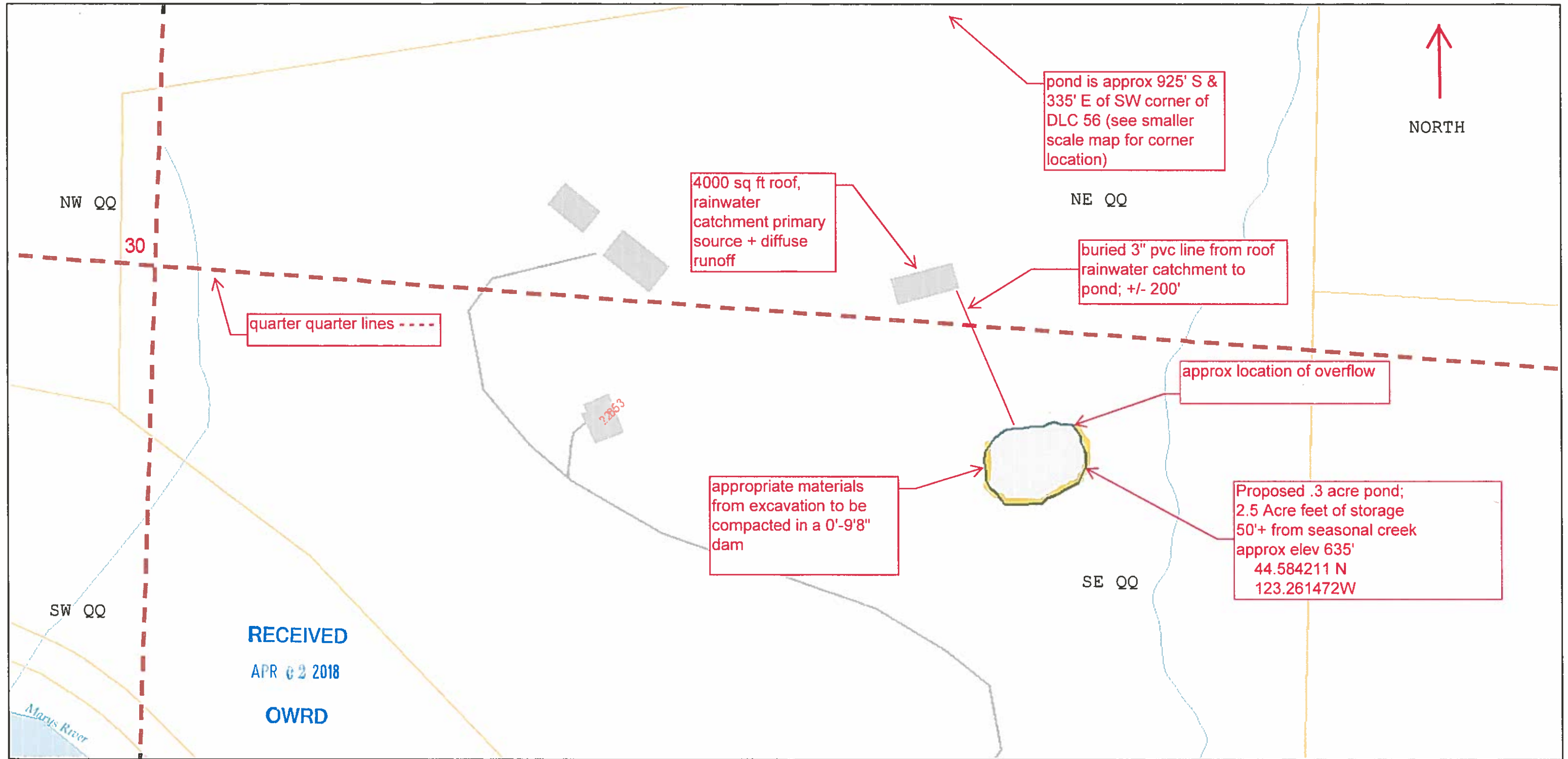

2/22/2018, 12:14:57 AM

- | | |
|-------------------------------------|---------------------|
| ArcGIS_Public.SDE.section_centroids | — Driveways |
| TaxlotOwners | ■ Hydro_polys |
| ArcGIS_Public.SDE.Roads | — Hydro_lines |
| ArcGIS_Public.SDE.survey_index | ■ Cities and Places |
| County_Addresses | □ County Boundary |
| ■ Buildings | ■ County Parks |

11S Section
 6W Range
 30 Section
 NE/SE QQ
 Tax Lot: 302

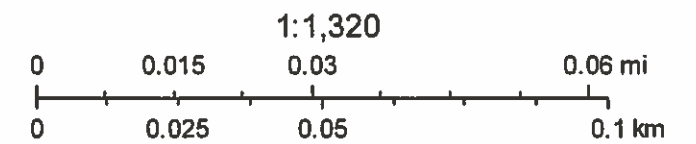

Benton County, Oregon