

Application No. 12994

Permit No. 9276

Certificate No. 10164

FEEES PAID

Date	Amount	Receipt
9-17-29	5.00	106
10-17-29	5.00	106
Total	10.00	

FEEES REFUNDED

Date	Amount	Check

Name E. J. Richards

By Gates, Ore.

Address Gates, Ore.

Date filed Sept. 14, 1929

Action suspended until

Returned to applicant

Date completed

Date of approval 11-6-29

CONSTRUCTION

Date for beginning 11-6-30

Date for completion 10-1-31

Extended to

Date for application of water 10-1-32

Extended to

PROSECUTION OF WORK

Form "A" filed January 12, 1930

Form "B" filed October 21, 1932

Form "C" filed October 21, 1932

FINAL PROOF

Blank mailed November 1, 1932

Proof received Sept. 11, 1933

Date certificate issued October 14, 1933

Receipt for recording fee No. 16545 for 1.00

Stream Index, Page No. 2 - p 39 b

Application Record, Book No.

ASSIGNMENTS

Date	To whom	Address	Volume

REMARKS

0.05 sec. ft. from unnamed stream for domestic

10-28-31 - Card for C

10-4-32 - Card for C

6-28-33 - Form 102

OK for Cert

Form A

NOTICE OF BEGINNING OF CONSTRUCTION

I, E. J. Richards, the holder of Application No. 12994, being
Permit No. 9276, issued by the State Engineer of the State of Oregon

(Reservoir or Enlargement)

for the appropriation of 0.05 second-feet of the waters of unnamed stream
in accordance with the tenor of such permit and the limitations endorsed thereon by the State Engineer,

began the actual construction of the works described therein on the 1 day of may, 1930
being within the time limitation as fixed in said permit for the beginning of construction work.

2 men laying foundation 4 men building cement tank
The appropriator should state the manner of beginning construction work, number of men and teams employed, the amount of work completed up to the date of this

statement, and any additional information which may tend to show the beginning of work in good faith.

IN WITNESS WHEREOF, I have hereunto set my hand this 10 day of June, 1930

Gates Cr.
(Present Address)

E. J. Richards
(Signature of Applicant)

Fill out, detach, and mail to the State Engineer, Salem, Oregon.

Form B

NOTICE OF COMPLETION OF CONSTRUCTION

I, E. J. Richards, the holder of Application No. 12994, being
Permit No. 9276, issued by the State Engineer of the State of Oregon

(Reservoir or Enlargement)

for the appropriation of 0.05 second-feet of the waters of unnamed creek
in accordance with the tenor of such permit and the limitations endorsed thereon by the State Engineer,

have completed the construction of the works described therein the 30 day of sept, 1931
being within the time limitation as fixed in said permit or as extended by the State Engineer for the
completion of construction work.

Remarks: _____
If the works have a less capacity than as described in the permit, or you have definitely abandoned your plan of irrigating any of the lands described
in your permit, you should so state in order that our records may not be unnecessarily encumbered.

IN WITNESS WHEREOF, I have hereunto set my hand this 1 day of October, 1932

(Present Address)

E. J. Richards
(Signature of Applicant)

Fill out, detach, and mail to the State Engineer, Salem, Oregon.
Form D should be used in reporting progress of work if more than one year has been allowed for completion.

Form C

NOTICE OF COMPLETE APPLICATION OF WATER TO A BENEFICIAL USE

I, E. J. Richards, the holder of Application No. 12994, being
Permit No. 9276, issued by the State Engineer of the State of Oregon

(Reservoir or Enlargement)

for the appropriation of 0.05 second-feet of the waters of unnamed creek
in accordance with the tenor of such permit and the limitations endorsed thereon by the State Engineer,

completely applied the water to a beneficial use, on the 30 day of Sept, 1932
being the time limitation as fixed in said permit or as extended by the State Engineer for the complete
application of water to a beneficial use.

Remarks: _____
If all of the water granted in the permit had not been fully applied to beneficial use, you should so state, so that delinquent appropriators may
have notice.

IN WITNESS WHEREOF, I have hereunto set my hand this 1 day of October, 1932

E. J. Richards
(Signature of Applicant)

Ok
to proceed

Sec. 27

Tp. 25

R. 3 E.

approx
3/4 mi. west
of Gates

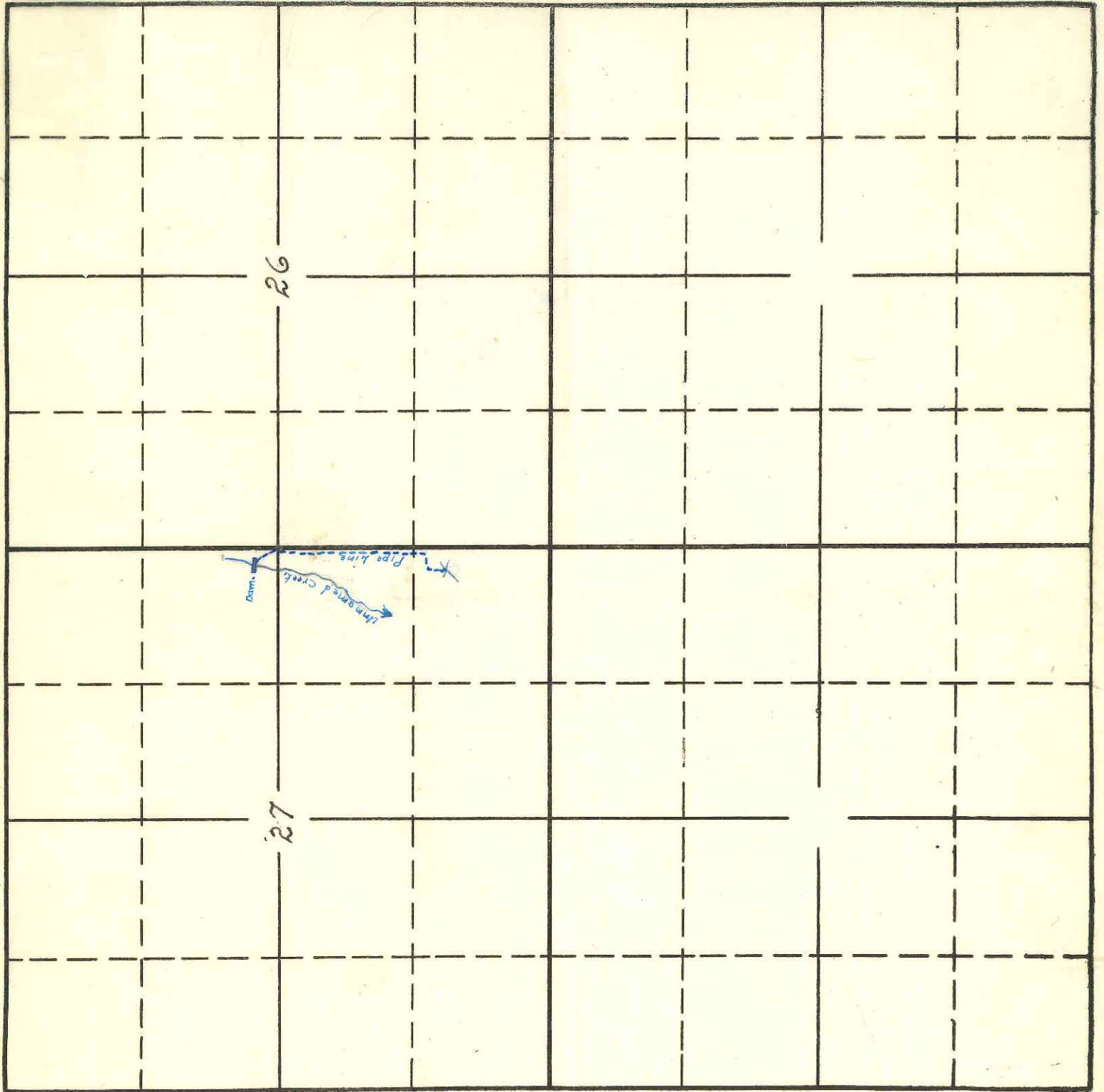

Application No. 12994
 Permit No. 9276

PERMIT NO. 9 2 7 6

10/69

APPLICATION NO. 12994

COUNTY Marion

PROOF OF APPROPRIATION OF WATER

1. Name E. J. Richards 2. Address Gates, Oregon.

3. Source of supply unnamed stream

Tributary of North Fork Santiam River

4. Amount of water 0.05 sec. ft. D.D.2 5. Priority date August 14, 1929.

6. Use domestic

7. Location of point of diversion, SE $\frac{1}{4}$ NE $\frac{1}{4}$ Sec. 27, Twp. 9 S, Range 3 E, W. M.
(Legal Subdivision)

8. The description of land given below corresponds to that found in your permit covering land to be irrigated, or, if for other purposes, the place of use. In the blank column on the right, headed "No. acres actually irrigated," fill in the number of acres you have irrigated in each of the tracts described:

Township	Range	Section	Forty-acre Tract	No. Acres Described in Permit	No. Acres Actually Irrigated
PLACE OF USE:					
9 S.	3 E.	27	SE $\frac{1}{4}$ SE $\frac{1}{4}$		This column must be filled in if water is used for irrigation <i>no irrigation</i>

(Attach separate sheet if necessary)

DESCRIPTION OF WORKS

9. (a) If a dam has been constructed, give description: Height, _____ ft.; length on top, _____ ft.; length on bottom _____ ft.; material used and character of construction, _____

(b) Give description of headgate: Width, _____ ft.; depth, _____ ft.; material used and character of construction, Cement Tank

(c) Size of canal: Width on top (at waterline) _____ ft.; width on bottom, _____ ft.; depth of water, _____ ft.; grade, _____ ft. fall per 1,000 ft. Actual capacity, _____ sec.-ft. Give general description: Cement Tank

(d) Pipe line: Description of intake, pipe

Length of pipe, 184³ ft.; size at intake, 1 1/4 in.; size at 300 ft. from intake, 1 in.; size at place of use, 3/4 in. Difference in elevation between intake and place of use, _____ ft.

Is grade uniform? yes Actual capacity of pipe line, _____ sec.-ft.

Give general description: Cement tank holding 700 gal
(Material: Steel, wrought, cast iron, wood stave, etc.)

(e) Pumping plant: Give size and type of pump, _____

Suction lift, _____ ft.; discharge lift, _____ ft. Type of motor used _____

Horse power rating, _____ H. P. Actual capacity of pump, _____ sec.-ft.

10. During what months is water beneficially used _____

11. State character of soil _____

Kind of crops raised _____

12. Does the accompanying map, filed with your application, show correctly the point of diversion, area of land irrigated, or place of use? _____

13. If not, wherein is such map in error? _____

14. Domestic use: Give number of families actually using water at this time two

15. If for power, mining, municipal, manufacturing, storage or any other purpose than irrigation, give extent and method of such use _____

extent and method of such use
.....
.....

AFFIDAVIT OF APPROPRIATOR

STATE OF OREGON,

County of marion } ss.

I, E. J. Richards, being first duly sworn, depose and say that I have read the above and foregoing proof of appropriation of water; that I know the contents thereof, and that the facts therein stated are true.

IN WITNESS WHEREOF, I have hereunto set my hand this 9th day of September, 1933

E. J. Richards

Subscribed and sworn to before me this 9 day of September, 1933

H. Pfeiffer

Notary Public for Oregon

[NOTARIAL SEAL]

My commission expires My Commission Expires Feb. 29, 1936

AFFIDAVIT OF WITNESSES

STATE OF OREGON,

County of marion } ss.

We, C. H. Bowes, and A. A. Shepherd of marion Co., being first duly sworn, depose and say that

we are well acquainted with the facts and conditions set forth in the foregoing statement relative to proof of appropriation of water under Permit No.....; that we and each of us have been over and upon each tract described in said proof, and from such personal inspection have knowledge that all necessary ditches, dams and other diversion and distributing works have been constructed, and water used as stated therein; that we have carefully read such proof of appropriation, and that each and every statement contained therein is true to the best of our knowledge and belief.

C. H. Bowes

A. A. Shepherd

Subscribed and sworn to before me this 9 day of September, 1933

H. Pfeiffer

Notary Public for Oregon

[NOTARIAL SEAL]

My commission expires My Commission Expires Feb. 29, 1936

STATE ENGINEER
RECEIVED
DEPT. OF
SALT

November 14, 1929

Gates
Mr. E. J. Richards,
Gates,
Oregon.

Dear Sir:

enclosed in this letter the application

Herewith you will find Application No. 12994, being Permit No. 9273, together with blue print.

The application has been approved and recorded in this office.

*where I applied for permit
It was my intention to come
to Salem with this paper
but I decided to mail this*

as I am very busy

W. J. Stitt
Gates, Oregon

approx 3/4 mi w of Gates on or near Hwy

The above claims vested right
for stock below Richards and
has protested injury but not being
subsequent appropriator nothing can be done (and)

RECEIVED JAN 1930

RECEIVED
OCT 17 1929
SALEM, OREGON

Gates, Or, Oct 16 - 1929
Rhea Luper. State Engineer
Salem.

Enclosed in this letter the application
for permit, map, and check for
\$5⁰⁰ for filing fees. I paid you
\$5⁰⁰ when I applied for permit
It was my intention to come
to Salem with this paper
but I decided to mail this
as I am very busy. if this
money is not sufficient
please let me know at once
I am enclosing an addressed
envelope, if there is any thing
more required please tell me.

E. J. Richards Gates Or

September 17, 1929.

Mr. E. J. Richards,
Gates,
Oregon.

Dear Sir:

In accordance with our understanding when you were in the office we are returning to you Application No. 12994 for completion, maps and a balance of fees. This application has been so endorsed that it will retain its priority if re-submitted to this office on or before October 17th, 1929.

Yours very truly,

WILMA LUPER
State Engineer

By _____
Office Assistant.

LAS:LN

Handwritten notes: please tell me... Richards Gates Or

DEAR SIR:

WILMA LUPER
STATE ENGINEER

September 17, 1929