

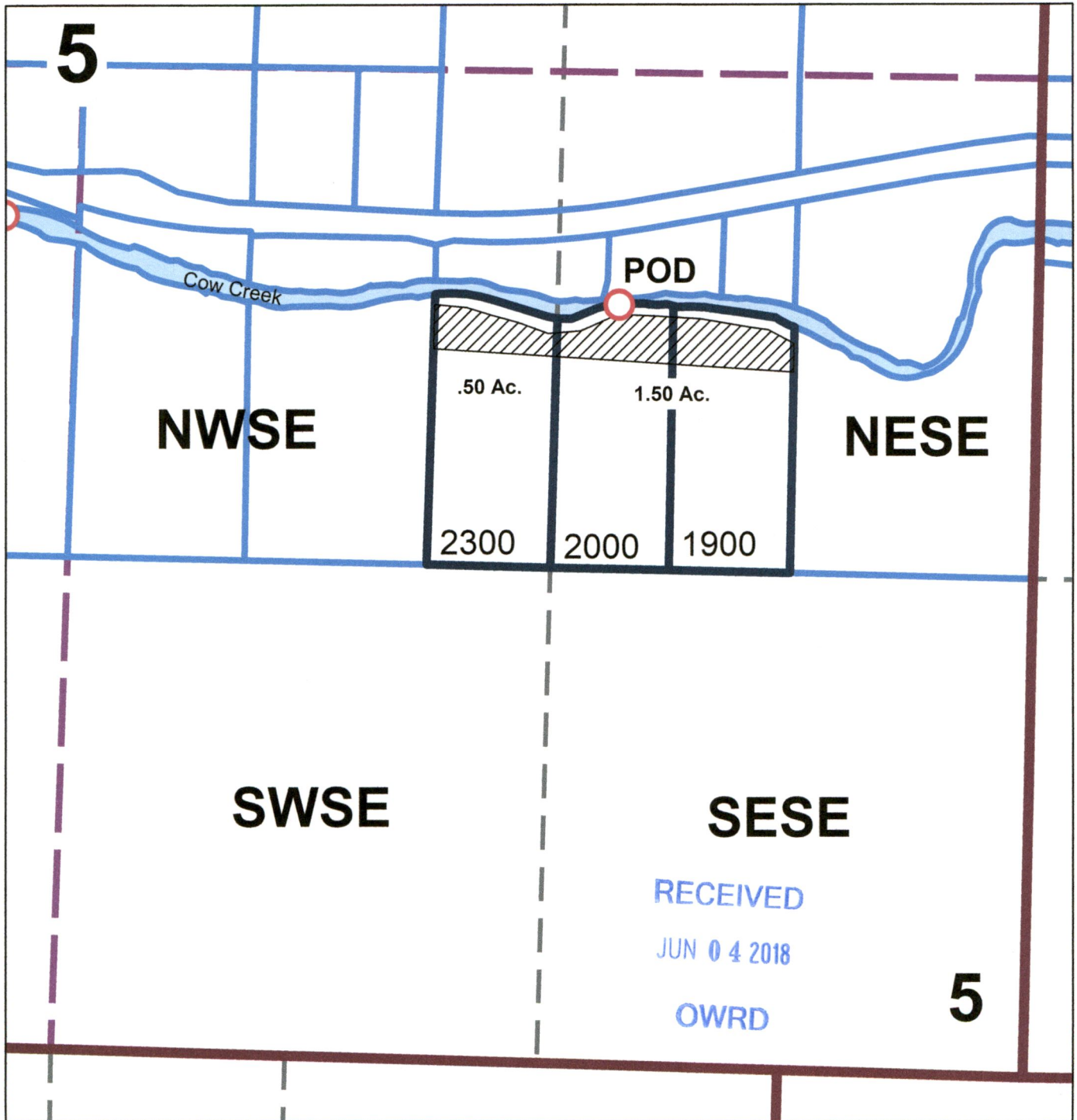

**Water Right Application Map**  
**Larry Buchholz**  
**SE 1/4 Sec. 5 T.32S. R.4W. W.M.**  
**Douglas County**  
**Scale: 1" = 400'**



**Point of Diversion is 2065 ft. North and 1130 ft. West from the Southeast Quarter Corner of Section 5.**

*J. Peases*