



**Reservoir Application Map**  
**Annette Therese Pacheco**  
**T.26S. R.6W. Section 27**  
**Douglas County**  
**Scale: 1" = 400'**

RECEIVED

JUL 03 2018

OWRD

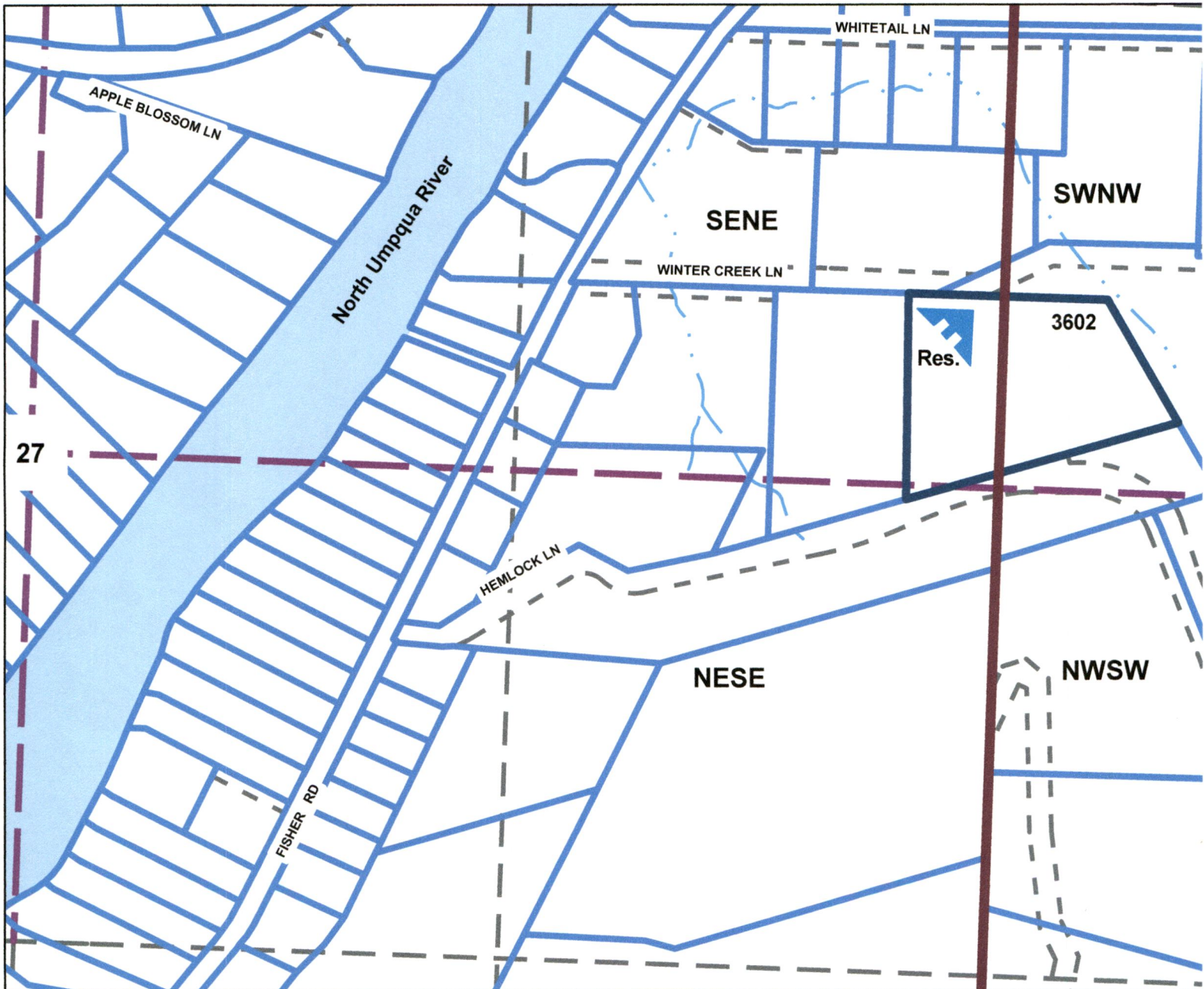

**Reservoir is located 430 ft. North and 130 ft. West from the East Quarter Corner Section**

R-88598