

**RECEIVED**

DEC 13 1983

WATER RESOURCES DEPT.  
SALEM, OREGON

LAUREL HILL DITCH  
Point of Diversion (Proposed)  
1500 ft. N., 125 ft. E. from  
center corner of Section 1

**RECEIVED**

MAR 27 1984

WATER RESOURCES DEPT.  
SALEM, OREGON

Certificate No. 32822  
T. 38 S., R. 5 W., Sec. 1, SE4NW4  
25.0 Acres

Certificate No. 32822  
T. 38 S., R. 5 W., Sec. 1, NE4SW4  
11.9 Acres

BRIDGEPOINT DITCH  
Point of Diversion (Authorized)  
1,075 ft. N., 1,660 ft. W. from  
SE4 corner of Section 17

T-5455  
LAUREL HILL DITCH



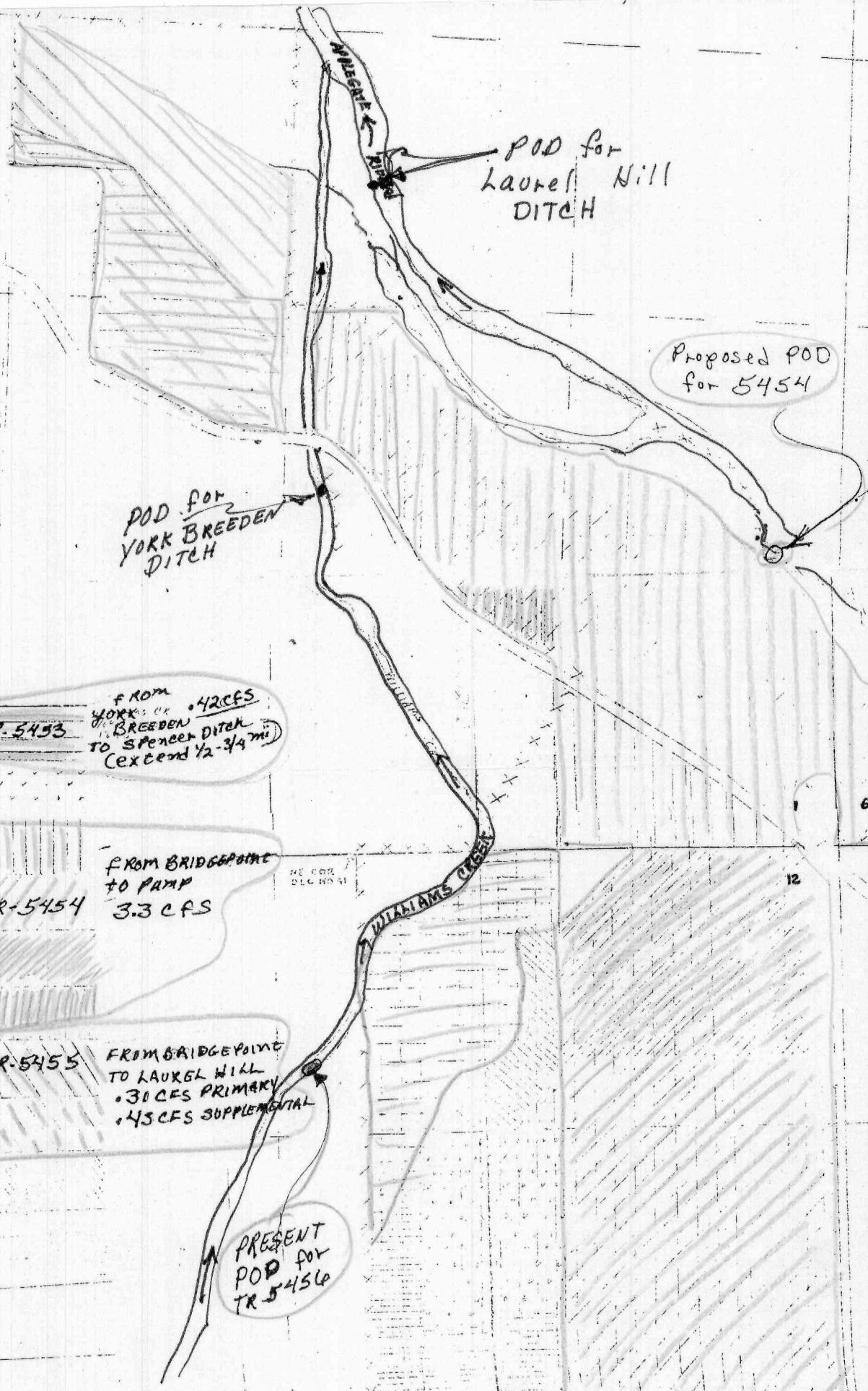

C-16307

TR-5453

FROM YORK OR BREEDEN TO SPENCER DITCH (extend 1/2-3/4 mi) .42 CFS

C-16309

C-32813

C-32818

TR-5454

FROM BRIDGEPOINT TO PUMP 3.3 CFS

C-32820

C-32821

C-32822 (Primary)

TR-5455

FROM BRIDGEPOINT TO LAUREL HILL .30 CFS PRIMARY .45 CFS SUPPLEMENTAL

C-32822 (Supplemental)

PRESENT POD for TR-5456

C-49853 (Permit 27151)

TRANSFER 5456

.39 CFS

From Pump To Spencer Ditch

Spencer Ditch diverts w/1/4 sec 13