

Cont. 2776
 Cont. in name of Mary Ellen Leonard
 Vol. 1 Pg 219 Althouse Creek

ALTHOUSE DITCH

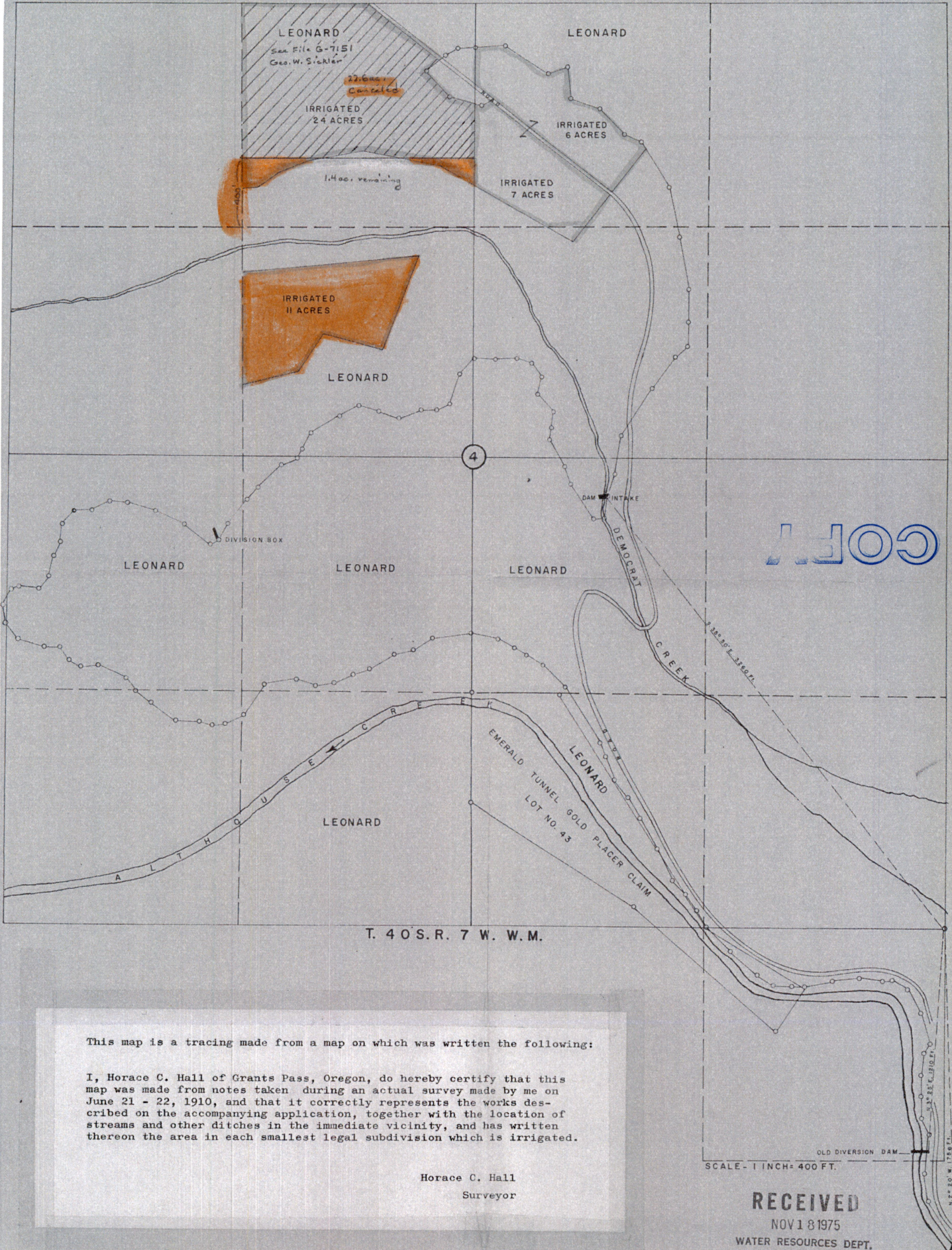

This map is a tracing made from a map on which was written the following:

I, Horace C. Hall of Grants Pass, Oregon, do hereby certify that this map was made from notes taken during an actual survey made by me on June 21 - 22, 1910, and that it correctly represents the works described on the accompanying application, together with the location of streams and other ditches in the immediate vicinity, and has written thereon the area in each smallest legal subdivision which is irrigated.

Horace C. Hall
 Surveyor

SCALE - 1 INCH = 400 FT.

RECEIVED
 NOV 18 1975
 WATER RESOURCES DEPT.
 SALEM, OREGON