

The sketch below is made solely for the purpose of assisting in locating said premises and the Company assumes no liability for variations, if any, in dimensions and location ascertained by actual survey.

Pioneer National Title Insurance Company
Title and Trust Division

RECEIVED
JUN 6 1973
STATE ENGINEER
SALEM, OREGON

699-0426

INDEX	
COLUMN 2	
NO.	OUT OF INST.
88	
89	
90	
91	
92	
93	
94	
95	
96	
97	
98	
99	
100	
101	
102	
103	
104	
105	
106	
107	
108	
109	
110	
111	
112	
113	
114	
115	
116	
117	
118	
119	
120	
121	
122	
123	
124	
125	
126	
127	
128	
129	
130	
131	
132	
133	
134	
135	
136	
137	
138	
139	
140	
141	
142	
143	

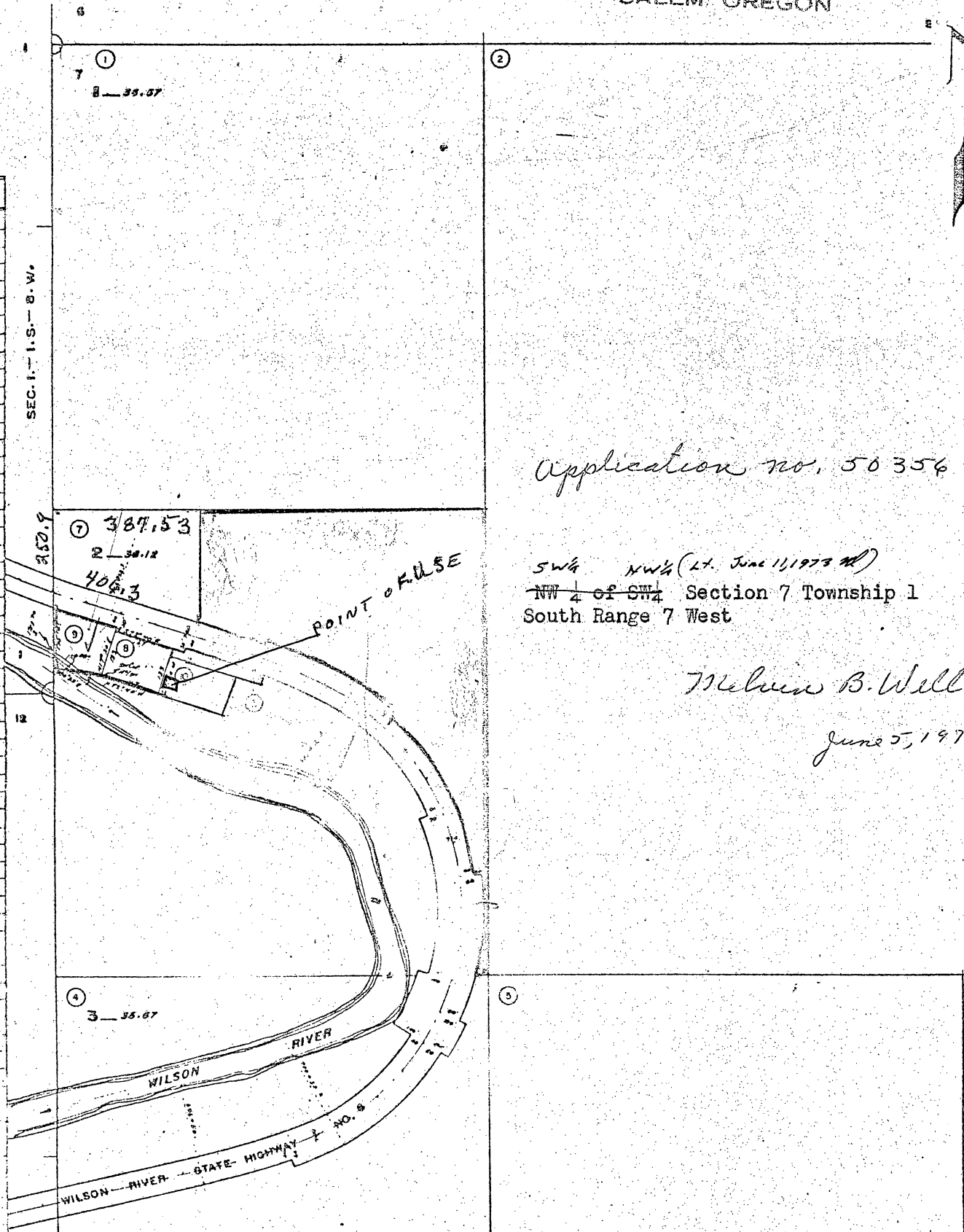

Application no. 50356

SW $\frac{1}{4}$ NW $\frac{1}{4}$ (LT. June 11, 1973 M)
NW $\frac{1}{4}$ of SW $\frac{1}{4}$ Section 7 Township 1
South Range 7 West

Melvin B. Wells
June 5, 1973

29-31049