

Application Map  
Greg Timm  
NESW 1/4 Section 14 T.27S. R6W.  
Douglas County  
1" - 400'

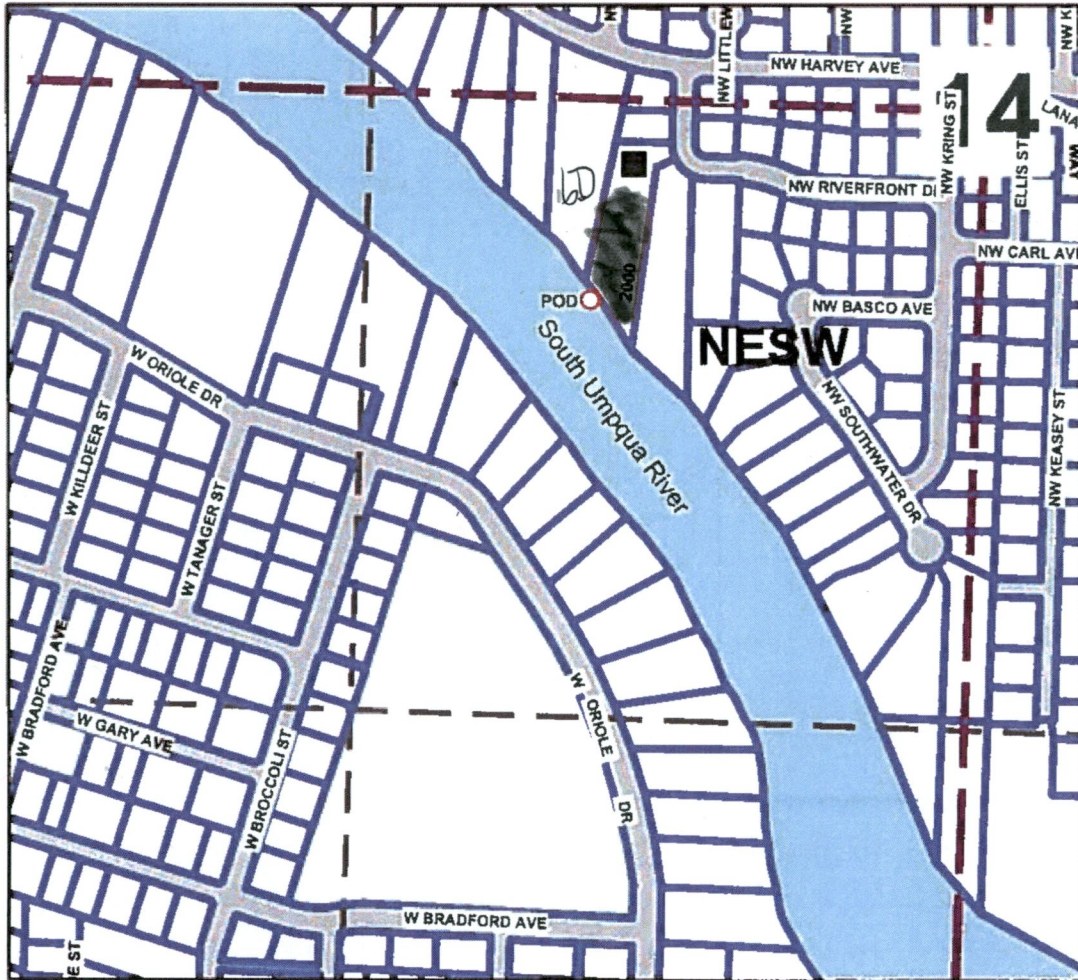

Point of diversion is 430 ft. South and 840 ft. West  
from the Center of Section 14.

RECEIVED

MAY 09 2019

OWRD

RECEIVED

MAY 02 2019

OWRD

5-88729

Application Map  
Greg Timm  
NESW 1/4 Section 14 T.27S. R6W.  
Douglas County  
1" - 400'

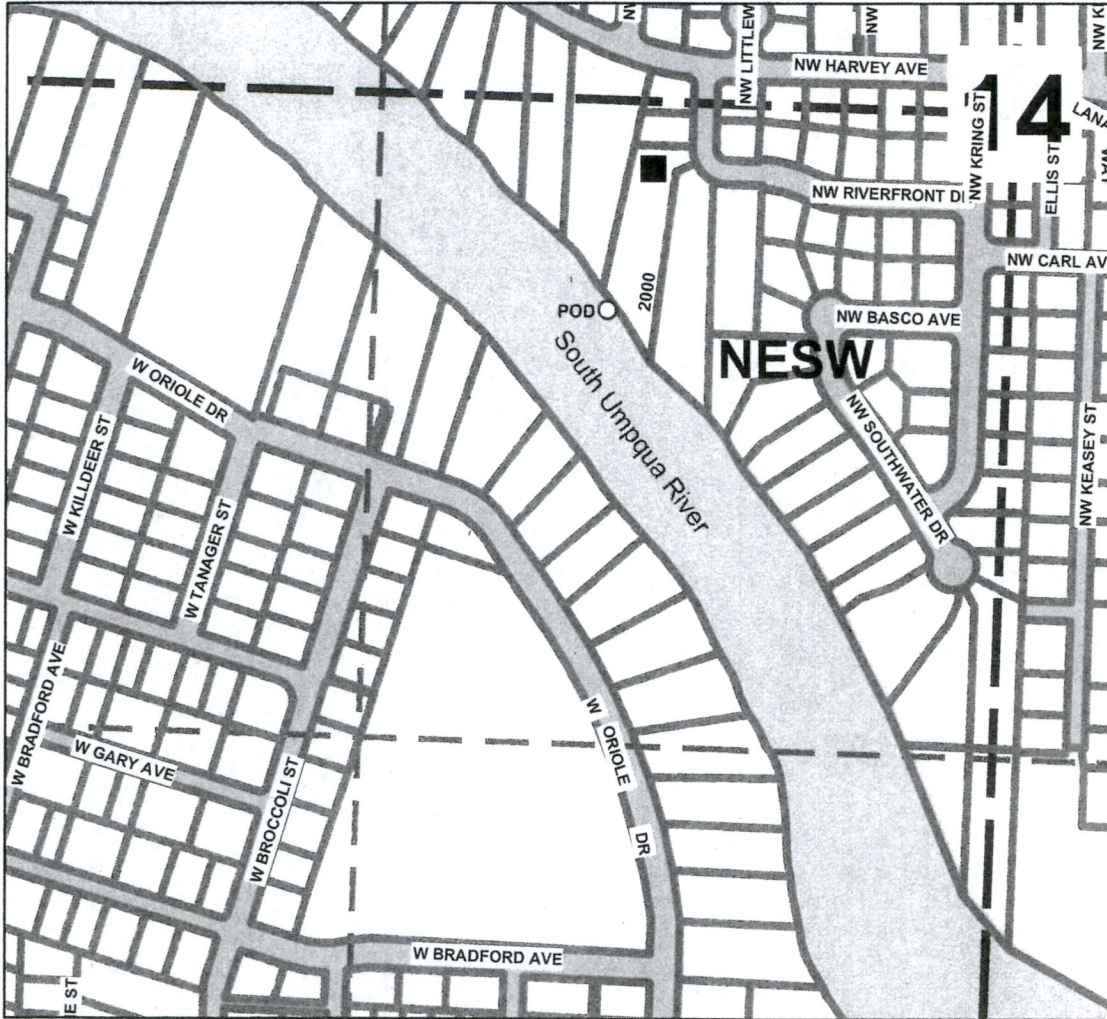
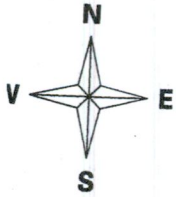

Point of diversion is 430 ft. South and 840 ft. West  
from the Center of Section 14.

RECEIVED  
MAY 02 2019  
OWRD

Supersede

**Application Map  
Greg Timm  
NESW 1/4 Section 14 T.27S. R6W.  
Douglas County  
1" - 400'**

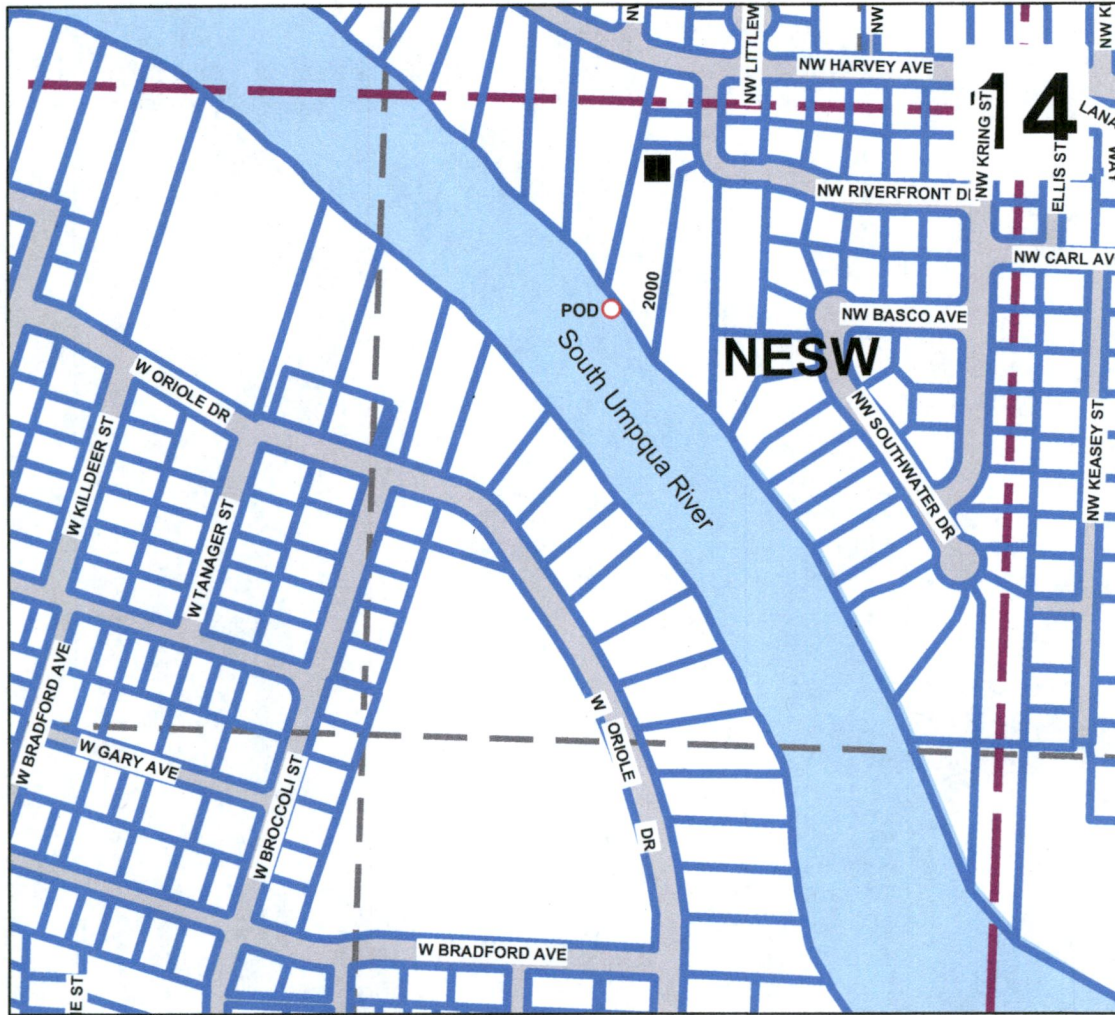

**Point of diversion is 430 ft. South and 840 ft. West  
from the Center of Section 14.**

RECEIVED

MAY 02 2019

OWRD

5-88769