

# Application for a Permit to Store Water in a Reservoir in the Name of Chris and Joan Horton

RECEIVED

MAY 23 2019

OWRD

Polk County  
Section 4, Township 10 South, Range 5 West (W.M.)

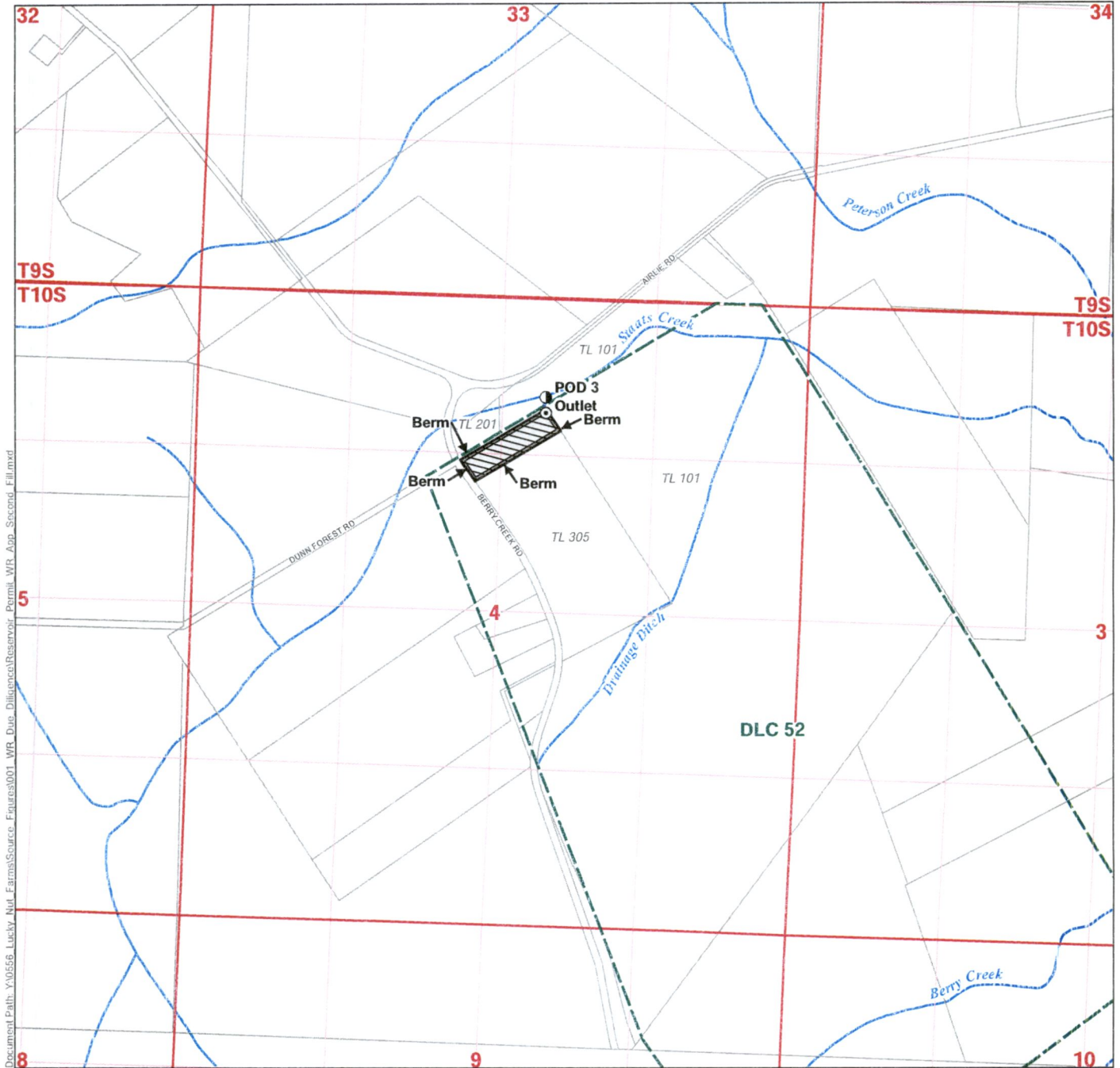

**LEGEND**

- Proposed Point of Diversion (POD)
- ⊙ Outlet
- ▨ Proposed Reservoir/ Proposed Place of Use (POU)
- Conveyance Pipe
- Donation Land Claim (DLC)
- ⊕ Tax Lot
- ~ Watercourse

**DISCLAIMER**

This map was prepared for the purpose of identifying the location of a water right only and it is not intended to provide legal dimensions or location of property ownership lines.

**MAP NOTES**

Date: June 1, 2018  
Data Sources: OWRD, US BLM, USGS, ESRI

**LOCATION DESCRIPTIONS**

**Center of Proposed Reservoir**  
Located 1,280 feet South and 2,555 feet West from the NE corner of Section 4, Township 10 South, Range 5 West (W.M.)  
**POD 3**  
Located 850 feet South and 2,280 feet West from the NE corner of Section 4, Township 10 South, Range 5 West (W.M.)

RECEIVED

JUL 02 2018

OWRD

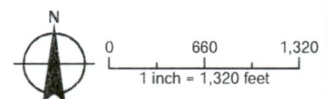

R-88774

RECEIVED

MAY 23 2019

OWRD

# Application for a Permit to Store Water in a Reservoir in the Name of Chris and Joan Horton

Polk County  
Section 4, Township 10 South, Range 5 West (W.M.)

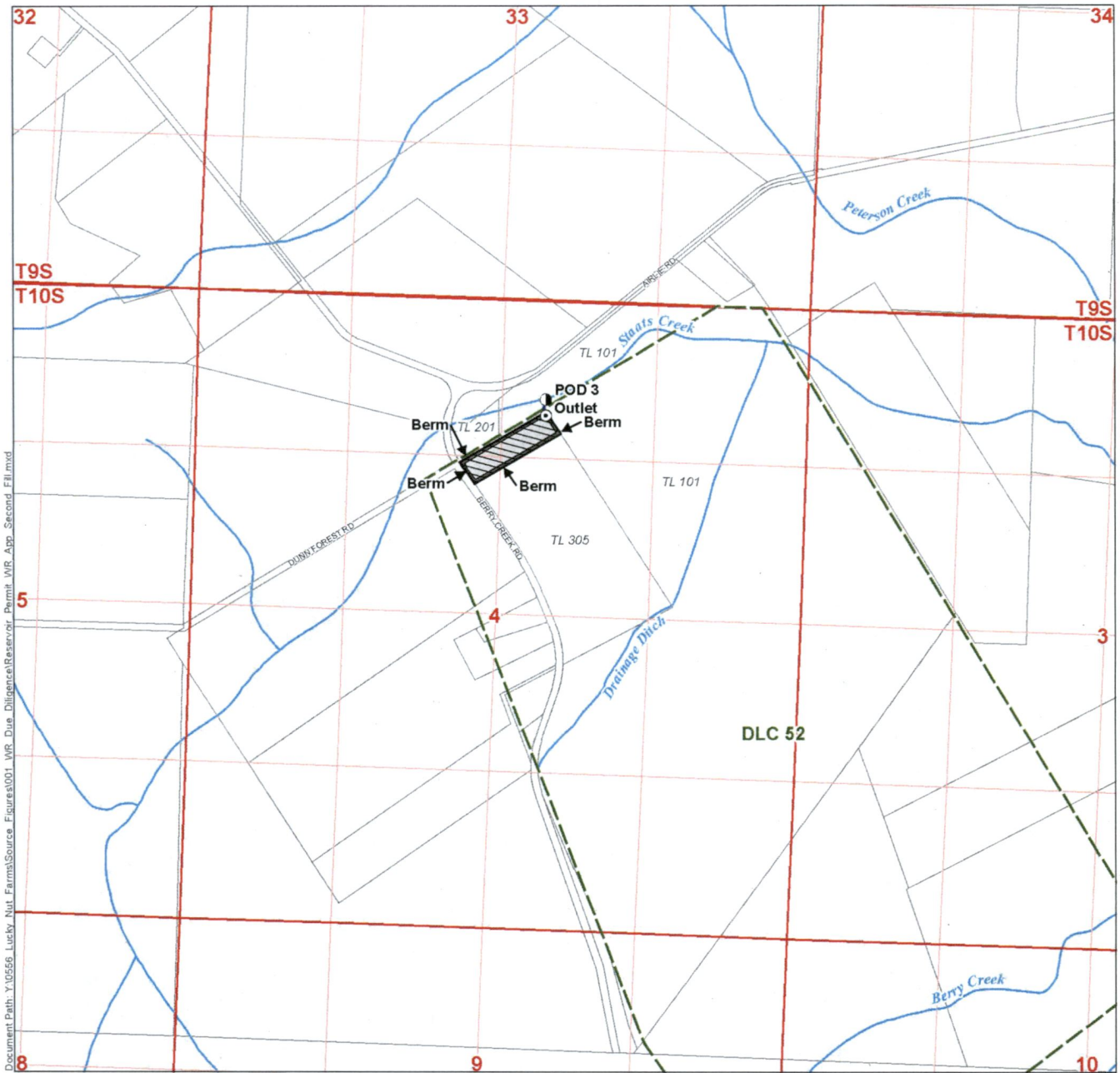

### LEGEND

- Proposed Point of Diversion (POD)
- Outlet
- Proposed Reservoir/ Proposed Place of Use (POU)
- Conveyance Pipe
- Donation Land Claim (DLC)
- Tax Lot
- Watercourse

### DISCLAIMER

This map was prepared for the purpose of identifying the location of a water right only and it is not intended to provide legal dimensions or location of property ownership lines.

### MAP NOTES

Date: June 1, 2018  
Data Sources: OWRD, US BLM, USGS, ESRI

### LOCATION DESCRIPTIONS

**Center of Proposed Reservoir**  
Located 1,280 feet South and 2,555 feet West from the NE corner of Section 4, Township 10 South, Range 5 West (W.M.)

**POD 3**  
Located 850 feet South and 2,280 feet West from the NE corner of Section 4, Township 10 South, Range 5 West (W.M.)

RECEIVED

JUL 02 2018

OWRD

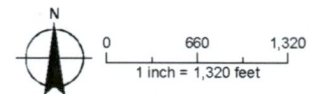

R-88774