

**Water Right Application Map
2 Gen Parker Vineyards LLC
T.25S. R.6W. Sections 31 and 32
Douglas County
Scale: 1" = 400'**

RECEIVED
JUN 06 2019
OWRD

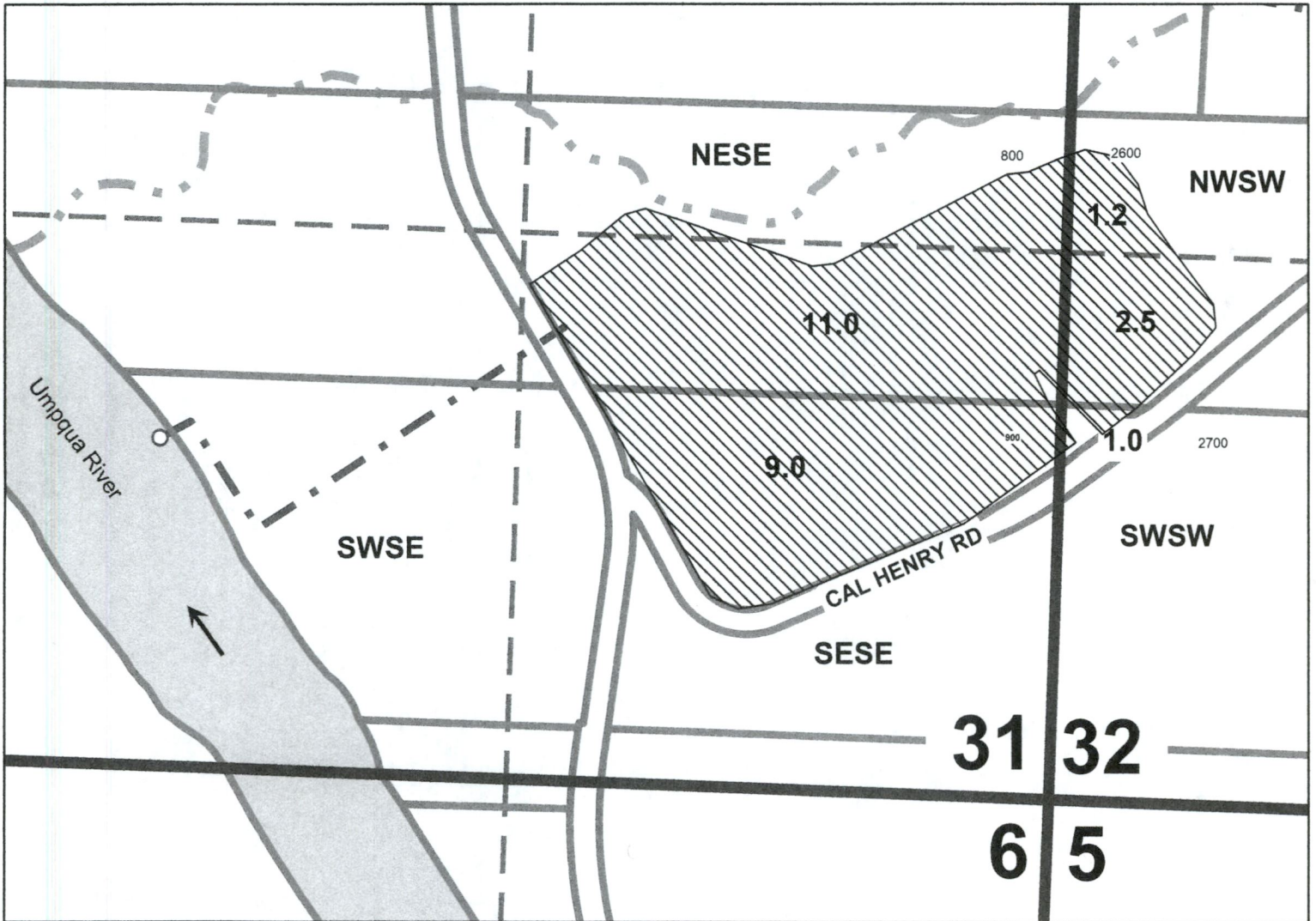

**Point of diversion is 800 ft. South and 2200 ft. West from
the Southeast Corner of Section 31**

**Water Right Application Map
2 Gen Parker Vineyards LLC
T.25S. R.6W. Sections 31 and 32
Douglas County
Scale: 1" = 400'**

RECEIVED
JUN 06 2019
OWRD

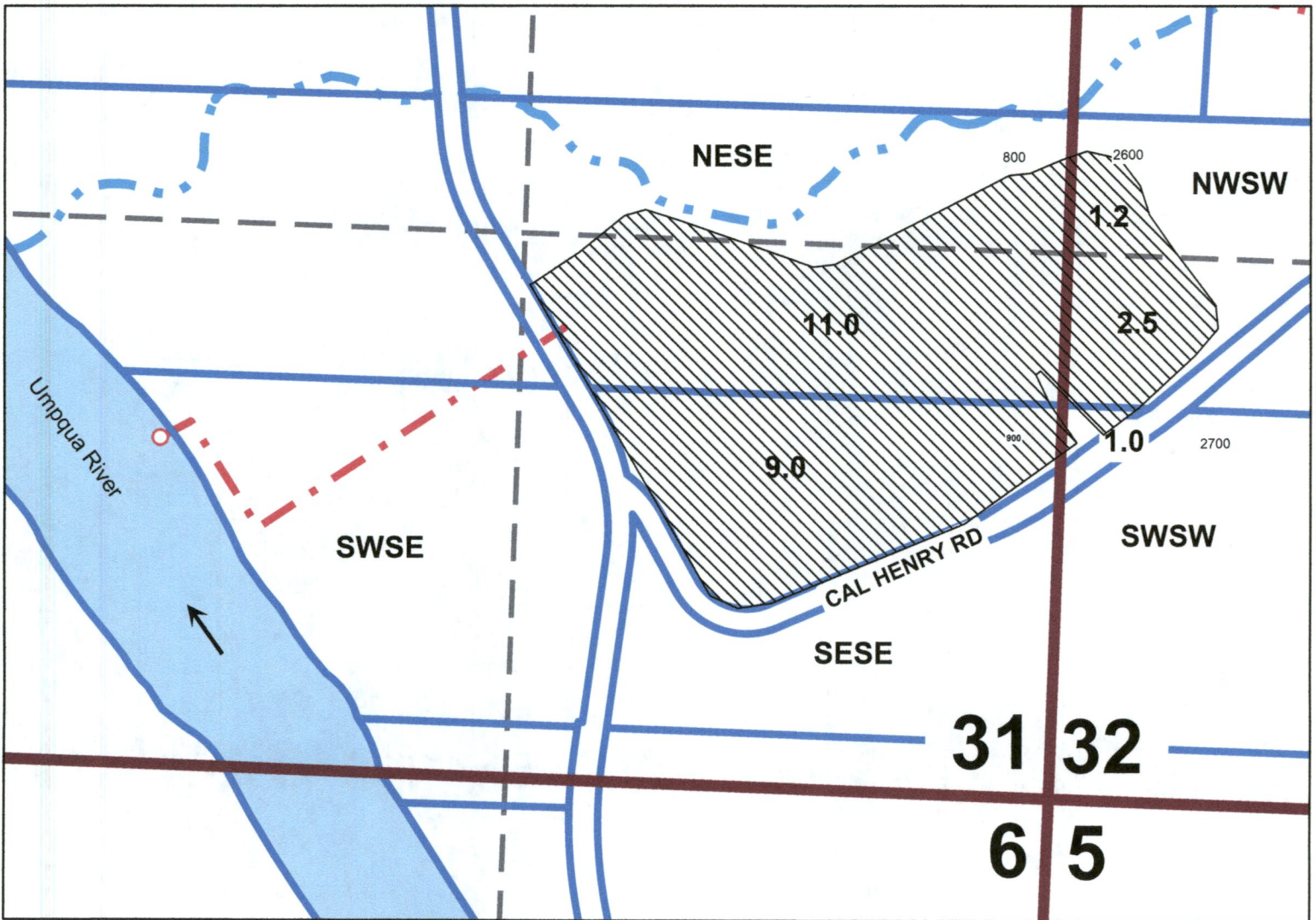

**Point of diversion is 800 ft. South and 2200 ft. West from
the Southeast Corner of Section 31**