

Township 14S., Range 39E.

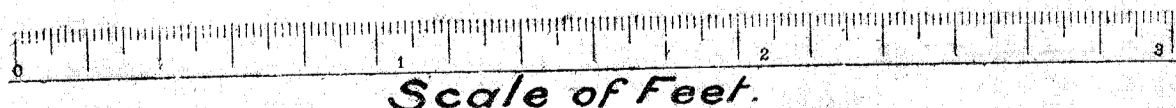
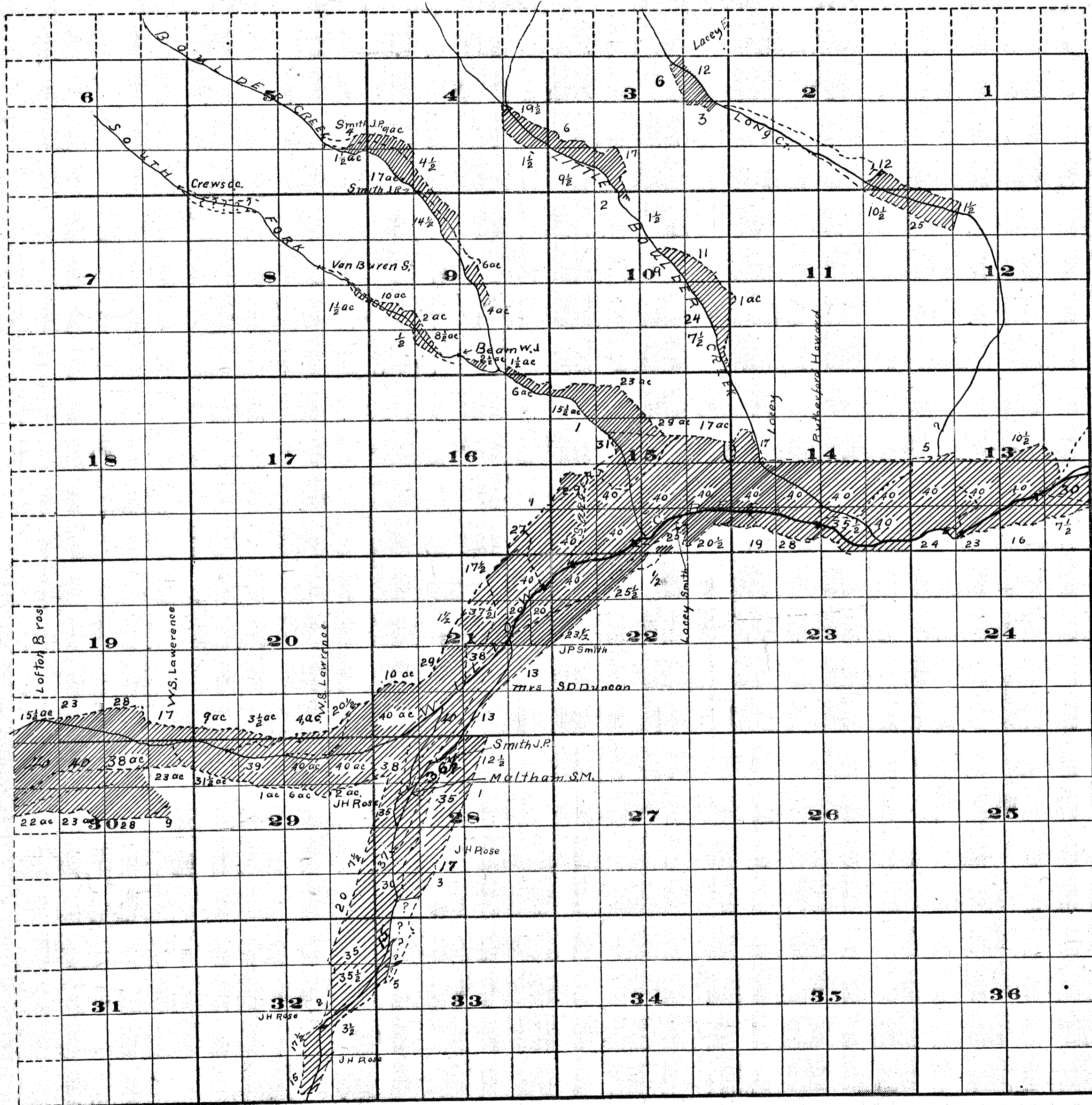

FROM OFFICE OF THE STATE ENGINEER, SALEM, OREGON
 Survey By Rhea Luper
 April 1910

36d - 2437 ac.
 41 mi

John H. Lewis State Eng.
 Examined, Aug 24, 1910.

Adjudication - Willow Creek - Malheur Co.,