

MIDDLETON Cory M * WRD

From: Richard Mellor <mellorr55@gmail.com>
Sent: Wednesday, July 17, 2019 6:52 AM
To: MIDDLETON Cory M * WRD
Subject: Re: OWR thanks for the call . Yes I want to change my application to multipurpose

On Tue, Jul 16, 2019 at 2:07 PM MIDDLETON Cory M * WRD <Cory.M.Middleton@oregon.gov> wrote:

As per our conversation, I am writing this email to clarify the Water Use in your Reservoir (Alternate Review) application. I have suggested that you change the Water Use from Irrigation to Multipurpose. I won't be able to move the application forward until I get a written authorization to change the use on your application. I am also attaching a link to the application that will allow you to use the stored water. If you have any questions please don't hesitate to give me a call or shoot me an email.

https://www.oregon.gov/OWRD/WRDFormsPDF/surface_water_app.pdf

Thank you, Cory Middleton

Oregon Water Resources Department

725 Summer St. NE Suite A

Salem, OR 97301

503-986-0801

map

RECEIVED

JUL 12 2019



Oregon Water Resources Department
725 Summer Street NE, Suite A
Salem Oregon 97301
(503) 986-0900
www.wrd.state.or.us

OWRD

Application for a Permit to
**Store Water
in a Reservoir**
(Alternate Review)

Alternate Review Process (ORS 537.409): You may use this form for any reservoir storing less than 9.2 acre-feet or with a dam less than 10 feet high.

Use a separate form for each reservoir

Please type or print in dark ink. If your application is found to be incomplete or inaccurate, we will return it to you. If any requested information does not apply, insert "n/a". A summary of review criteria and procedures that are generally applicable to these applications is available at www.wrd.state.or.us/OWRD/PUBS/forms.shtml.

1. APPLICANT INFORMATION

Applicant: Richard Mellor
First Last
Mailing Address: 508 Doermer Rd
Roseburg OR 97471
City State Zip
Phone: Cell 541-670-3353
Home Work Other
Fax: _____ E-Mail Address*: mellor55@gmail.com

* By providing an e-mail address, consent is given to receive all correspondence from the department electronically. (paper copies of the final order documents will also be mailed.)

2. AGENT INFORMATION

The agent is authorized to represent the applicant in all matters relating to this application.

Agent: _____
First Last
Mailing Address: _____

City State Zip
Phone: _____
Home Work Other
Fax: _____ E-Mail Address*: _____

* By providing an e-mail address, consent is given to receive all correspondence from the department electronically. (paper copies of the final order documents will also be mailed.)

3. LOCATION AND SOURCE

A. Reservoir Name: N/A

B. Source: Provide the name of the water body or other source from which water will be diverted, and the name of the stream or lake it flows into. Indicate if source is run-off, seepage, or an unnamed stream or spring.
Source: Field Run off Tributary to: _____

C. County in which diversion occurs: Douglas

App. No. <u>R-88720</u>	For Department Use Permit No. _____	Date _____
-------------------------	--	------------

D. Reservoir Location

Township (N or S)	Range (E or W)	Section	quarter/quarter	tax lot number
T27S	R7W	12	NWNW	1100

E. Dam: Maximum height of dam: 0 feet. If excavated, write "zero feet".

F. Quantity: Amount of water to be stored in the reservoir at maximum capacity. List volume in acre-feet: 5 Acre-feet = $\frac{\text{Average Length} \times \text{Average Width} \times \text{Average Depth}}{43,560}$

4. WATER USE

Indicate the proposed use(s) of the stored water. **NOTE: You may wish use" for your reservoir. Multipurpose use does not limit the types of Multipurpose covers all uses including: stockwater, fish and wildlife, agriculture, fire protection and pollution abatement.** If any use will be the type of storage listed, a secondary application must be filed to approp

IRRIGATION

RECEIVED

JUL 12 2019

OWRD

5. PROPERTY OWNERSHIP

Please provide a copy of the recorded deed(s).

Do you own all the land where you propose to divert, transport, and use water.

Yes (please check appropriate box below then skip to section 5)

There are no encumbrances

This land is encumbered by easements, right of way, roads of way, roads or other encumbrances

No (Please check the appropriate box below)

I have a recorded easement or written authorization permitting access.

I do not currently have written authorization or easement permitting access.

Written authorization or an easement is not necessary, because the only affected lands I do not own are state-owned submersible lands, and this application is for irrigated and/or domestic use only (ORS 274.040). (Do not check this box if you described your use as "Multipurpose" in #3 above.)

List the names and mailing addresses of all affected landowners:

Please see email correspondence on July 17th changing WATER USE from Irrigation to Multi-Purpose.

6. ENVIRONMENTAL IMPACT

- A. **Channel:** Is the reservoir: in-stream or off channel?
- B. **Wetland:** Is the project in a wetland? Yes No Don't know
- C. **Existing:** Is this an existing reservoir? Yes No
If yes, how long has it been in place? _____ years.
- D. **Fish Habitat:** Is there fish habitat upstream of the proposed structure? Yes No Don't know
If yes, how much? _____ miles.
- E. **Partnerships:** Have you been working with other agencies? Yes No
Indicate agency, staff and phone numbers of those involved. Also indicate any agencies that are cost sharing in this project.

7. WITHIN A DISTRICT

Check here if the point of diversion or place of use are located within or served by an irrigation or other water district.

Irrigation District Name	Address	
City	State	Zip

8. DESCRIPTION

Provide a description of the design and operation of the proposed diversion, including a description of how live flow will be passed outside the authorized storage season. Use this space for narrative. You may also provide narrative and sketches on separate pages.

RECEIVED
JUL 1 2 2019
OWRD

RECEIVED
JUL 1 2 2019
OWRD 3

If the diversion involves a dam, use this space for sketches of the diversion (e.g. cross-section of the dam with its dimensions, dimension and placement of outlet pipe, means of passing live flow outside of the authorized storage season, and means for providing fish passage).



9. SIGNATURE

I swear that all statements made and information provided in this application are true and correct to the best of my knowledge.



Applicant Signature

7-1-19
Date

- Before you submit your application be sure you have:**
- Answered each question completely.
 - Included a legible map that includes Township, Range, Section, quarter-quarter and tax lot number.
 - The map must meet map requirements to be accepted.
 - Included a land use form or receipt stub signed by a local planning official.
 - Included a check payable to Oregon Water Resources Department for the appropriate amount.

RECEIVED
JUL 1 2 2019
OWRD

RECEIVED

JUL 1 2 2019

OWRD 4

WATERMASTER ALTERNATE RESERVOIR APPLICATION REVIEW SHEET

Recommendations for Water Right Applications under the Alternate Reservoir review process (ORS 537.409)

In lieu of the water right application process set forth in ORS 537.140 to 537.211, an owner of a reservoir may submit an alternate reservoir application for a reservoir that has a storage capacity less than 9.2 acre-feet or a dam or impoundment structure less than 10 feet in height. ORS 537.409 describes the criteria used to evaluate alternate reservoir applications.

The review shall be limited to issues pertaining to: a) water availability, b) potential detrimental impact to existing fishery resources; and c) potential injury to existing water rights. (ORS 537.409 (6))

Within 60 days after the department provides public notice...any person may submit detailed, legally obtained information in writing, requesting the department to deny the application for a permit on the basis that the reservoir: (a) Would result in injury to an existing water right; or (b) Would pose a significant detrimental impact to existing fishery resources. (ORS 537.409 (5))

The review of alternate reservoirs is limited to these criteria only.

Application #: R- Applicant's Name: *Mellor, Richard*

1) Does the proposed reservoir have the potential to injure existing water rights? NO YES
Explain:

2) Can conditions be applied to mitigate the potential injury to existing water rights? NO YES *na*

If YES, which conditions are recommended:

3) Did you meet with staff from another agency to discuss this application? NO YES

Who: Agency: Date:
Who: Agency: Date:

Watermaster printed name: *Susan Douthett*
Watermaster signature: *Susan Douthett* Date: *7/1/19*

WRD Contact: Caseworker: Water Rights Division, 503-986-0900 / Fax 503-986-0901

RECEIVED

NOTE: This completed form must be returned to the applicant

RECEIVED
JUL 12 2019 5

OWRD

ODFW Alternate Reservoir Application Review Sheet

This portion to be completed by the applicant.

Applicant Name/Address/Phone/Email: Richard Mellor 508 Doerner Rd
508 Roseburg OR 97911

Reservoir Name: N/A Source: Field Drainage Volume (AF): 5

Twp Rng Sec QQ: _____ Basin Name: _____ in-channel
 off-channel

Note: It is unlikely that ODFW will be able to complete this form while you wait, nevertheless we recommend making an appointment to submit the form so as to provide any necessary clarifications. See pg. 6 of Instructions for contact information.

This portion to be completed by Oregon Department of Fish and Wildlife (ODFW) District staff.

- 1) Is the proposed project and AO¹ off channel? YES NO
 (if yes then proceed to #4; if no then proceed to #2)
- 2) Is the proposed project or AO located where NMF² are or were historically present?..... YES NO
 (if yes then proceed to #3; if no then proceed to #4)
- 3) If NMF are or were historically present:
 - a. Is there an ODFW-approved fish-passage plan?..... YES NO
 - b. Is there an ODFW-approved fish-passage waiver or exemption?..... YES NO

If fish passage is required under ORS 509.580 through .910, then either 3(a) or 3(b) must be "Yes" to move forward with the application. If responses to 3(a) and 3(b) are "No", then the proposed reservoir does not meet the requirements of Oregon Fish Passage Law and shall not be constructed as proposed.

4) Would the proposed project pose any other significant detrimental impact to an existing fishery resource locally or downstream?..... YES NO
 Explain below (for example, list STE species or other existing fishery resources that would be impacted negatively.)

- Any diversion or appropriation of water for storage during the period _____ through _____ poses a significant detrimental impact to existing fishery resources. (For example, if diversion of water for storage during a certain time period would cause a significant detrimental impact to an existing fishery resource, then ODFW should recommend conditions or limitations.) If NMF fish are present at the project site or point of water diversion then the applicant should be advised that a fish screen consistent with screening criteria will be required.
- This proposed pond or reservoir contemplates impounding water in the Columbia Basin above Bonneville Dam. ODFW has determined that additional diversions of water in this area pose a significant detrimental impact to existing fishery resources during the period April 15 through September 30.

RECEIVED
JUL 12 2019

OWRD

¹ AO = Artificial Obstruction means any dam, diversion, culvert or other human-made device placed in waters of this state that precludes or prevents the migration of native migratory fish. ORS 509.580 (1)

² NMF = Native Migratory Fish Species in Oregon as defined by OAR 635 - 412 - 0005 (32)

R-88720

ODFW Alternate Reservoir Application Review Sheet

This portion to be completed by the applicant.

Applicant Name/Address/Phone/Email: Richard Mellor, 508 Doerner Road, Roseburg, OR 97471

541-670-3353, mellorr55@gmail.com

Reservoir Name: N/A Source: Run-off Volume (AF): 9

Twp Rng Sec QQ: 27S-R07-11 Basin Name: Umpqua River in-channel
 off-channel

Note: It is unlikely that ODFW will be able to complete this form while you wait, nevertheless we recommend making an appointment to submit the form so as to provide any necessary clarifications. See pg. 6 of Instructions for contact information.

This portion to be completed by Oregon Department of Fish and Wildlife (ODFW) District staff.

1) Is the proposed project and AO¹ off channel? YES NO
 (if yes then proceed to #4; if no then proceed to #2)

2) Is the proposed project or AO located where NMF² are or were historically present?..... YES NO
 (if yes then proceed to #3; if no then proceed to #4)

3) If NMF are or were historically present:

- a. Is there an ODFW-approved fish-passage plan?..... YES NO
- b. Is there an ODFW-approved fish-passage waiver or exemption?..... YES NO

If fish passage is required under ORS 509.580 through .910, then either 3(a) or 3(b) must be "Yes" to move forward with the application. If responses to 3(a) and 3(b) are "No", then the proposed reservoir **does not meet** the requirements of Oregon Fish Passage Law and **shall not** be constructed as proposed.

4) Would the proposed reservoir pose any other significant detrimental impact to an existing fishery resource?..... YES NO

Explain below (for example, list STE species or other existing fishery resources that would be impacted negatively.)

- Any diversion or appropriation of water for storage during the period _____ through _____ poses a significant detrimental impact to existing fishery resources. (For example, if diversion of water for storage during a certain time period would cause a significant detrimental impact to an existing fishery resource, then ODFW should recommend conditions or limitations.) If NMF fish are present at the project site or point of water diversion then the applicant should be advised that a fish screen consistent with screening criteria will be required.
- This proposed pond or reservoir contemplates impounding water in the Columbia Basin above Bonneville Dam. ODFW has determined that additional diversions of water in this area pose a significant detrimental impact to existing fishery resources during the period April 15 through September 30.

RECEIVED

JUL 12 2019

OWRD

¹ AO = **Artificial Obstruction** means any dam, diversion, culvert or other human-made device placed in waters of this state that precludes or prevents the migration of native migratory fish. ORS 509.580 (1)

² NMF = **Native Migratory Fish** Species in Oregon as defined by OAR 635-412-0005 (32)

The District visited Mr. Mellor's property on Thursday May 23, 2019. The pond was not in the floodplain and not adjacent to a fish-bearing stream. The ponds had no fish currently and the landowner said that he does not intend to stock any. The drainage into the inlet was already dry.

Lined area for notes or additional information.

If YES, can conditions be applied to mitigate the significant detrimental impact to an existing fishery resource?
 NO (explain) YES (select from Menu of Conditions on next page)

Lined area for providing explanation for 'NO' or details for 'YES'.

ODFW Signature: Eric Himmelreich Print Name: Eric Himmelreich

ODFW Title: Habitat Restoration Biologist Date: 5/23/2019

NOTE: This completed form must be returned to the applicant.

Revised 8/2/11

RECEIVED
JUL 12 2019
OWRD

2-88720

Use this menu to identify appropriate conditions to be included in the permit, and indicate the abbreviations on the review form:

fishpass: As required by ORS 509.585, a person owning or operating an artificial obstruction (AO) may not construct or maintain any AO across any waters of this state that are inhabited, or historically inhabited, by native migratory fish (NMF) without providing passage for NMF. A person owning or operating an AO shall, prior to construction, fundamental change in permit status or abandonment of the AO in any waters of this state, obtain a determination from ODFW as to whether NMF are or historically have been present in the waters. If ODFW determines that NMF are or historically have been present in the waters, the person owning or operating the AO shall either submit a proposal for fish passage to ODFW or apply for a waiver or exemption. Approval of the proposed fish-passage facility, waiver, or exemption must be obtained from the department prior to construction, permit modification or abandonment of the AO. Approved fish-passage plans, waivers, and exemptions shall maintain adequate passage of NMF at all times (ORS 509.601) as per the approved plan, waiver or exemption.

fishself: The permittee shall install, maintain, and operate fish screening and by-pass devices consistent with current Oregon Department of Fish and Wildlife (ODFW) standards. Fish screening is to prevent fish from entering the proposed diversion while by-pass devices provide adequate upstream and downstream passage for fish. The required screen and by-pass devices are to be in place and functional prior to diversion of any water. Permittee shall obtain written approval from ODFW that the installation of the required screen and by-pass devices meets the state's criteria or the permittee shall submit documentation that ODFW has determined screens and/or by-pass devices are not necessary.

fishapprove: The permittee shall install, maintain, and operate fish screening and by-pass devices consistent with current Oregon Department of Fish and Wildlife (ODFW) standards. Fish screening is to prevent fish from entering the proposed diversion while by-pass devices provide adequate upstream and downstream passage for fish. The required screen and by-pass devices are to be in place and functional, and approved in writing by ODFW prior to diversion of any water. The permittee may submit evidence in writing that ODFW has determined screens and/or by-pass devices are not necessary.

fishdiv33: If the riparian area is disturbed in the process of developing a point of diversion, the permittee shall be responsible for restoration and enhancement of such riparian area in accordance with ODFW's Fish and Wildlife Habitat Mitigation Policy OAR 635-415. For purposes of mitigation, the ODFW Fish and Wildlife Habitat Mitigation Goals and Standards, OAR 635-415, shall be followed.

The use may be restricted if the quality of the source stream or downstream waters decrease to the point that those waters no longer meet existing state or federal water quality standards due to reduced flows.

The permittee shall install, maintain, and operate fish screening and by-pass devices consistent with current Oregon Department of Fish and Wildlife (ODFW) standards. Fish screening is to prevent fish from entering the proposed diversion while by-pass devices provide adequate upstream and downstream passage for fish. The required screen and by-pass devices are to be in place and functional, and approved in writing by ODFW prior to diversion of any water. The permittee may submit evidence in writing that ODFW has determined screens and/or by-pass devices are not necessary.

fishmay: Notwithstanding that ODFW has made a determination that fish screens and/or by-pass devices are not necessary at the time of permit issuance, the permittee may be required in the future to install, maintain, and operate fish screening and by-pass devices to prevent fish from entering the proposed diversion and to provide adequate upstream and downstream passage for fish.

b52 Water may be diverted only when Department of Environmental Quality sediment standards are being met.

b5 The water user shall install and maintain adequate treatment facilities meeting current DEQ requirements to remove sediment before returning the water to the stream.

b51a The period of use has been limited to _____ through _____.

b57 Before water use may begin under this permit, a totalizing flow meter must be installed at each diversion point.

b58 Before water use may begin under this permit, a staff gage that measures the entire range and stage between full reservoir level and dead-pool storage must be installed in the reservoir. The staff gage shall be United States Geological Survey style porcelain enamel iron staff gage style A, C, E or I.

futile call: The use of water allowed herein may be made only at times when waters from the (NAME OF SURFACE WATER) would not otherwise flow into a tributary of the _____ River or sufficient water is available to satisfy all prior rights, including rights for maintaining instream flows.

riparian: If the riparian area is disturbed in the process of developing a point of diversion, the permittee shall be responsible for restoration and enhancement of such riparian area in accordance with ODFW's Fish and Wildlife Habitat Mitigation Policy OAR 635-415. For purposes of mitigation, the ODFW Fish and Wildlife Habitat Mitigation Goals and Standards, OAR 635-415, shall be followed.

wq: The use may be restricted if the quality of the source stream or downstream waters decrease to the point that those waters no longer meet existing state or federal water quality standards due to reduced flows.

fence: The stream and its adjacent riparian area shall be fenced to exclude livestock.

blv: Water must be diverted to a trough or tank through an enclosed water delivery system. The delivery system must be equipped with an automatic shutoff or limiting flow control mechanism or include a means for returning water to the stream source through an enclosed delivery system. The use of water shall not exceed 0.10 cubic feet per second per 1000 head of livestock.

RECEIVED

OWRD

Land Use Information Form



725 Summer Street NE, Suite A
Salem, Oregon 97301-1266
(503) 986-0900
www.wrd.state.or.us

Applicant: Richard Mellor
First Last

Mailing Address: 508 Doerner Rd

Roseburg OR 97471 Daytime Phone: 541-670-3353
City State Zip

A. Land and Location

Please include the following information for all tax lots where water will be diverted (taken from its source), conveyed (transported), and/or used or developed. Applicants for municipal use, or irrigation uses within irrigation districts may substitute existing and proposed service-area boundaries for the tax-lot information requested below.

Township	Range	Section	¼ ¼	Tax Lot #	Plan Designation (e.g., Rural Residential/RR-5)	Water to be:			Proposed Land Use:
T27S	R7W	12		1100		<input type="checkbox"/> Diverted	<input type="checkbox"/> Conveyed	<input checked="" type="checkbox"/> Used	Irrigation
						<input type="checkbox"/> Diverted	<input type="checkbox"/> Conveyed	<input type="checkbox"/> Used	
						<input type="checkbox"/> Diverted	<input type="checkbox"/> Conveyed	<input type="checkbox"/> Used	
						<input type="checkbox"/> Diverted	<input type="checkbox"/> Conveyed	<input type="checkbox"/> Used	

List all counties and cities where water is proposed to be diverted, conveyed, and/or used or developed:

Douglas

B. Description of Proposed Use

Type of application to be filed with the Water Resources Department:

- Permit to Use or Store Water
 Water Right Transfer
 Permit Amendment or Ground Water Registration Modification
 Limited Water Use License
 Allocation of Conserved Water
 Exchange of Water

Source of water: Reservoir/Pond
 Ground Water
 Surface Water (name) _____

Estimated quantity of water needed: 1.5
 cubic feet per second
 gallons per minute
 acre-feet

Intended use of water: Irrigation
 Commercial
 Industrial
 Domestic for _____ household(s)
 Municipal
 Quasi-Municipal
 Instream
 Other _____

Briefly describe:

Bulge in irrigation system, Reservoir fills from Field Run off

Note to applicant: If the Land Use Information Form cannot be completed while you wait, please have a local government representative sign the receipt at the bottom of the next page and include it with the application filed with the Water Resources Department.

See bottom of Page 3. →

RECEIVED

JUL 12 2019

OWRD 10

Land Use Information Form



725 Summer Street NE, Suite A
Salem, Oregon 97301-1266
(503) 986-0900
www.wrd.state.or.us

\$165
Doug Co

NOTE TO APPLICANTS

In order for your application to be processed by the Water Resources Department (WRD), this Land Use Information Form must be completed by a local government planning official in the jurisdiction(s) where your water right will be used and developed. The planning official may choose to complete the form while you wait, or return the receipt stub to you. Applications received by WRD without the Land Use Form or the receipt stub will be returned to you. Please be aware that your application will not be approved without land use approval.

This form is NOT required if:

- 1) Water is to be diverted, conveyed, and/or used only on federal lands; **OR**
- 2) The application is for a water right transfer, allocation of conserved water, exchange, permit amendment, or ground water registration modification, and **all** of the following apply:
 - a) The existing and proposed water use is located entirely within lands zoned for exclusive farm-use or within an irrigation district;
 - b) The application involves a change in place of use only;
 - c) The change does not involve the placement or modification of structures, including but not limited to water diversion, impoundment, distribution facilities, water wells and well houses; and
 - d) The application involves irrigation water uses only.

NOTE TO LOCAL GOVERNMENTS

The person presenting the attached Land Use Information Form is applying for or modifying a water right. The Water Resources Department (WRD) requires its applicants to obtain land-use information to be sure the water rights do not result in land uses that are incompatible with your comprehensive plan. Please complete the form or detach the receipt stub and return it to the applicant for inclusion in their water right application. You will receive notice once the applicant formally submits his or her request to the WRD. The notice will give more information about WRD's water rights process and provide additional comment opportunities. You will have 30 days from the date of the notice to complete the land-use form and return it to the WRD. If no land-use information is received from you within that 30-day period, the WRD may presume the land use associated with the proposed water right is compatible with your comprehensive plan. Your attention to this request for information is greatly appreciated by the Water Resources Department. If you have any questions concerning this form, please contact the WRD's Customer Service Group at 503-986-0801.

RECEIVED

JUL 12 2019

OWRD

For Local Government Use Only

OWRD

The following section must be completed by a planning official from each county and city listed unless the project will be located entirely within the city limits. In that case, only the city planning agency must complete this form. This deals only with the local land-use plan. Do not include approval for activities such as building or grading permits.

Please check the appropriate box below and provide the requested information

Land uses to be served by the proposed water uses (including proposed construction) are allowed outright or are not regulated by your comprehensive plan. Cite applicable ordinance section(s): Zoned FG - Farm Grazing - Ludo 3.3.050.5 & 3.3.075.16

Land uses to be served by the proposed water uses (including proposed construction) involve discretionary land-use approvals as listed in the table below. (Please attach documentation of applicable land-use approvals which have already been obtained. Record of Action/land-use decision and accompanying findings are sufficient.) **If approvals have been obtained but all appeal periods have not ended, check "Being pursued."**

Type of Land-Use Approval Needed (e.g., plan amendments, rezones, conditional-use permits, etc.)	Cite Most Significant, Applicable Plan Policies & Ordinance Section References	Land-Use Approval:	
		<input type="checkbox"/> Obtained <input type="checkbox"/> Denied	<input type="checkbox"/> Being Pursued <input type="checkbox"/> Not Being Pursued
		<input type="checkbox"/> Obtained <input type="checkbox"/> Denied	<input type="checkbox"/> Being Pursued <input type="checkbox"/> Not Being Pursued
		<input type="checkbox"/> Obtained <input type="checkbox"/> Denied	<input type="checkbox"/> Being Pursued <input type="checkbox"/> Not Being Pursued
		<input type="checkbox"/> Obtained <input type="checkbox"/> Denied	<input type="checkbox"/> Being Pursued <input type="checkbox"/> Not Being Pursued
		<input type="checkbox"/> Obtained <input type="checkbox"/> Denied	<input type="checkbox"/> Being Pursued <input type="checkbox"/> Not Being Pursued

Local governments are invited to express special land-use concerns or make recommendations to the Water Resources Department regarding this proposed use of water below, or on a separate sheet.

R24476, R141384 Property ID #'s make up the total lot.
Zoned FG - Farm Grazing
WS19-0537

DOUGLAS COUNTY PLANNING DEPARTMENT
ROOM 106, JUSTICE BUILDING
DOUGLAS COUNTY COURTHOUSE
ROSEBURG, OR 97470

Name: Robin Lambert Title: Duty Planner
Signature: [Signature] Phone: 541-440-4289 Date: 7/1/19
Government Entity: Douglas County Planning Department

Note to local government representative: Please complete this form or sign the receipt below and return it to the applicant. If you sign the receipt, you will have 30 days from the Water Resources Department's notice date to return the completed Land Use Information Form or WRD may presume the land use associated with the proposed use of water is compatible with local comprehensive plans.



Receipt for Request for Land Use Information

Applicant name: _____
City or County: _____ Staff contact: _____
Signature: _____ Phone: _____ Date: _____



Douglas County

Planning and Sanitation Pre-Application Worksheet

RECEIVED
JUL 12 2019

OTHER ACTION

OWRD

Worksheet Number <h2 style="margin: 0;">WS19-0537</h2>	Applicant MELLOR, RICHARD P & SUZANNE 508 DOERNER RD ROSEBURG, OR 97471 (541) 670-3353	Owner MELLOR, RICHARD P & SUZANNE 508 DOERNER RD ROSEBURG, OR 97471
---	---	---

SITE INFORMATION

Site Address 508 DOERNER RD ROSEBURG, OR 97471	MTL 27-07W-12-01100	Property ID Number (Primary) R24476	Size (Acres) 41.35
Improvement LUCS FOR OWRD		Proposed Use Land Use Compatibility Statement	
Existing Structures (Number and Type) 2 HOUSES, 3 BARNs		Distance of Building Site from River, Creek, or Stream Bank >50 FEET	
Directions N/A			

As, for, or on behalf of, all property owners:
APPLICANT SIGNATURE: *Richard P Mellor* **DATE:** 7-1-19

PLANNING DEPARTMENT INFORMATION

Zoning FG	Overlays
---------------------	----------

SETBACKS (EFU - Grazing)

Front Property Line of Right of Way 30 Feet	Rear Line 10 Feet	Side Line 10 Feet	Exterior Side Line N/A
Sign Code NO SIGN PROPOSED - N/A	Special Setback N/A	Riparian Setback 50 FEET	
Parking Spaces Required N/A	Building Height None	Flood Plain No	Floor Height Above Ground N/A

Conditions of Approval
LUCS FOR WATER USE TO USE/STORE WATER FOR IRRIGATION SYSTEM; NO STRUCTURAL DEVELOPMENT AUTHORIZED; MUST ACQUIRE ALL APPLICABLE PERMITS FROM REQUIRED AGENCIES.

Sanitation N/A	Sanitary District	Water N/A	Access Permit Required? NOT REQ'D
--------------------------	-------------------	---------------------	---

Report Codes
NONSTRUCTURAL SEPTIC-EXISTING PUBLIC WATER COUNTY ACCESS

Refer To
RESOURCE REPORT

Approved By: RAL	Date: 7/1/2019	Receipt #: P33727	Amount: \$ 165.00	Expiration Date: 6/29/2020
----------------------------	--------------------------	-----------------------------	-----------------------------	--------------------------------------

SANITATION INFORMATION

SE#	STP#	Existing System	System: Approved ___ Denied ___
Remarks			
By:	Date:	CSC Date:	

R-88720

FOOT PLAN	Worksheet #:	WS19-0537	Property ID #:	R24476
Applicant:	Richard Mellon		Phone #:	541-670-3353
Site Address:	500 Doernen Rd Roseburg OR 97471		Co. Road #:	90

INFORMATION NEEDED:

1. Proposed Structure and Distance From Property Lines;
2. Other Existing Structures on Property;
3. Access Road and Driveway Location
4. Landmarks (Roads, Rivers, etc.);
5. Indicate Direction of Drainage from Building Site;
6. Indicate Location Of Septic System and Water / Sewer Lines
7. Initial Waiver At Bottom of Page



EXAMPLE:

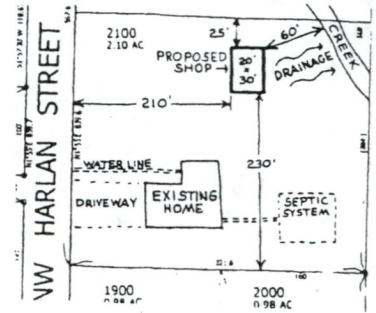

SEE ATTACHED

RECEIVED
 JUL 12 2019
 OWRD

WAIVER. I understand it is the responsibility of the applicant and property owner to consider issues such as drainage, flooding, soil stability, or excessive slopes in this project. I also understand that approval of this Pre-Application Worksheet and Plot Plan does not release me from compliance with private covenants, restrictions, or easements affecting this property.

R-88720

(Initials) RRM

92-14882 WARRANTY DEED BOOK 1195 PAGE 98

KNOW ALL MEN BY THESE PRESENTS, That Richard A. Crocker and Wanda Jean Crocker husband and wife hereinafter called the grantor, for the consideration hereinafter stated, to grantor paid by Richard P. Mellor and Suzanne Mellor, husband and wife hereinafter called the grantee, does hereby grant, bargain, sell and convey unto the grantee and grantee's heirs, successors and assigns, that certain real property, with the tenements, hereditaments and appurtenances thereunto belonging or in any way appertaining, situated in Douglas County, State of Oregon, described as follows, to-wit:

Lots 15, 16, and 17, FIRST ADDITION TO EDEN ORCHARDS, Douglas County, Oregon. Excepting that portion of Lots 16 and 17 sold to Douglas County by deed, Recorder's No. 219077, Deed Records of Douglas County, Oregon--

Tax Card No. 43916.00

(IF SPACE INSUFFICIENT, CONTINUE DESCRIPTION ON REVERSE SIDE)

To Have and to Hold the same unto the grantee and grantee's heirs, successors and assigns forever. And grantor hereby covenants to and with grantee and grantee's heirs, successors and assigns, that grantor is lawfully seized in fee simple of the above granted premises, free from all encumbrances except 1992-93 taxes, and easements of record and taxes have been assessed as farm land

and that grantor will warrant and forever defend the premises and every part and parcel thereof against the lawful claims and demands of all persons whomsoever, except those claiming under the above described encumbrances.

The true and actual consideration paid for this transfer, stated in terms of dollars, is \$200,000.00. However, the actual consideration consists of or includes other property or value given or promised which is consideration (indicate which).

In construing this deed, where the context so requires, the singular includes the plural and all grammatical changes shall be made so that this deed shall apply equally to corporations and to individuals.

In Witness Whereof, the grantor has executed this instrument this 18th day of August, 1992; if a corporate grantor, it has caused its name to be signed and its seal, if any, affixed by an officer or other person duly authorized to do so by order of its board of directors.

THIS INSTRUMENT WILL NOT ALLOW USE OF THE PROPERTY DESCRIBED IN THIS INSTRUMENT IN VIOLATION OF APPLICABLE LAND USE LAWS AND REGULATIONS. BEFORE SIGNING OR ACCEPTING THIS INSTRUMENT, THE PERSON ACQUIRING FEE TITLE TO THE PROPERTY SHOULD CHECK WITH THE APPROPRIATE CITY OR COUNTY PLANNING DEPARTMENT TO VERIFY APPROVED USES.

Richard A. Crocker
Wanda Jean Crocker



STATE OF OREGON, County of Douglas ss. This instrument was acknowledged before me on August 18, 1992, by Richard A. Crocker and Wanda Jean Crocker. This instrument was acknowledged before me on 19, 19.

Notary Public for Oregon
My commission expires 8/30/93

STATE OF OREGON COUNTY OF DOUGLAS ss. I, GAY FIELDS, COUNTY CLERK AND RECORDER OF CONVEYANCES, DO HEREBY CERTIFY THAT THIS INSTRUMENT WAS RECORDED 1992 AUG 19 AM 11:30 IN THE OFFICIAL RECORDS OF DOUGLAS COUNTY. DEPUTY GAY FIELDS

COMMERCIAL TITLE CO. 72852/vh P. O. BOX 1325 ROSEBURG, OREGON 97131

RECEIVED JUL 12 2019 OWRD

12-88720



Oregon Water Resources Department Alternate Reservoir Application

[Main](#)

[Help](#)

[Return](#)

[Contact Us](#)

For impoundments less than 10 feet in height or storing less than 9.2 acre feet of water.

Today's Date: Tuesday, July 9, 2019

Base Application Fee.		\$410.00
Proposed Dam Height in feet.		
Proposed Reservoir volume in Acre Feet.	5	\$175.00
Permit Recording Fee. ***		\$520.00
*** the Permit Recording Fee is not required when the application is submitted but, must be paid before a permit will be issued. It is fully refundable if a permit is not issued. If the recording fee is not paid prior to issuance of the Final Order, permit issuance will be delayed.	<input type="button" value="Recalculate"/>	
Estimated cost of Permit Application		\$1,105.00

OWRD Fee Schedule

Fee Calculator Version: B20170117

RECEIVED

JUL 12 2019

OWRD

R-88720