

2-12-70 (2)

Abstract of Permit No. R-3263

Application No. R-38650

Certificate No.

Name

William V. Katzenbach Assigned
19704 Williams Highway
Williams, Oregon

Harold P. & Virginia
Saxler, P.O. Box 41
1621 Meadow Flat
Road Williams, Oregon
Grange Field, Oregon

Address

Source of water supply

in Kings Reservoir, trib. Williams Creek and Two Unnamed drainage ways, Trib. Applegate River, to be appropriated under Appl: #38651, Permit #28514.

Use

Irrigation and stock being 1/2 a.f. for irrig. & 1/2 a.f. for Stock

Point of diversion

~~Sec. 27, T. 38 N., R. 5 W., S. 4.~~ in the county of Josephine.

Number of acres

DESCRIPTION OF LAND TO BE IRRIGATED OR PLACE OF USE

| Twp. | Range | Sec. | NE 1/4 | | | | NW 1/4 | | | | SW 1/4 | | | | SE 1/4 | | | | |
|------|-------|------|--------|--------|--------|--------|--------|--------|--------|--------|--------|--------|--------|--------|--------|--------|--------|--------|--|
| | | | NE 1/4 | NW 1/4 | SW 1/4 | SE 1/4 | NE 1/4 | NW 1/4 | SW 1/4 | SE 1/4 | NE 1/4 | NW 1/4 | SW 1/4 | SE 1/4 | NE 1/4 | NW 1/4 | SW 1/4 | SE 1/4 | |
| | | | | | | | | | | | | | | | | | | | |
| 38S | 5W | 27 | | | | | | | | | | | | | | | | | |
| | | | | | | | | | | | | | | | | | | | |
| | | | | | | | | | | | | | | | | | | | |
| | | | | | | | | | | | | | | | | | | | |
| | | | | | | | | | | | | | | | | | | | |
| | | | | | | | | | | | | | | | | | | | |
| | | | | | | | | | | | | | | | | | | | |

Priority date

April 17, 1963

Amount of water

1.0 acre feet

being 1/4 a.f. from each of the un-named drainage ways & 1/2 a.f. from Williams Creek

Time limit to begin construction

July 18, 1964

Time limit to complete construction 10-1-65 extended to

extended to

Time limit to completely apply water extended to

extended to

Remarks: . . .

1970-A
4-15-70
2928

dbm

Basin 15, Vol. . . .

INFO: MR. SANDERS

DAM: LENGTH: L SHAPED - 140 FT.
MIN. CREST WIDTH: 8 FT
SLOPES: UPSTREAM - ~~2:1~~ 2 1/2:1
DOWNSTREAM - ~~2 1/2:1~~ 2:1

NOTE: DAM BADLY
OVERGROWN W/ WILD ROSES

CONDUIT: 6" STEEL - VERTICAL GATE VALVE US,
LOCATED 15 FT FROM LEFT END OF DAM

SPILLWAY: LOCATED RIGHT END OF DAM

X-SEC $\frac{0^{\circ}}{0^{\circ}}$ $\frac{-18}{5^{\circ}}$ $\frac{-18}{11^{\circ}}$ $\frac{0^{\circ}}{14^{\circ}}$
GRADE = 5%

| | | | |
|-------------|---------------------------|----------------------------|---------------------------------------|
| ELEVATIONS: | DOWNSTREAM INVERT CONDUIT | 100 ⁰ (ASSUMED) | |
| | HIGH POINT ON DAM | 107 ⁰ | |
| | PRESENT WATER LEVEL | 103 ⁵ | |
| | HWL, H. STORAGE | 105 ⁵ | |
| | LOW POINT ON DAM | 107 ³ | |
| | 6/W CREST | 105 ⁵ | $\frac{105^5}{100^0}$ = 5' max dip |

(S.A.)d

$0^3 \times 5^5 \times .6 =$

1.000ft

Donald R Buell
Field Engineer
Apr. 15, 1970

SAW EVIDENCE OF STOCK AROUND RESERVOIR
DRB

William G. Katzenbach

19704 WILLIAMS HWAY.

WILLIAMS, OREGON.

TWP. 38 S. R. 5 W. M. SEC. 27

SCALE 1" = 660 FEET.

TWP 38 S. R. 5 W. S35.

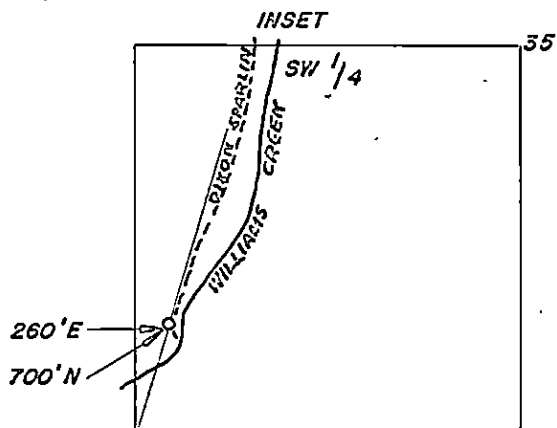

SCALE 1" = 1320 FEET.

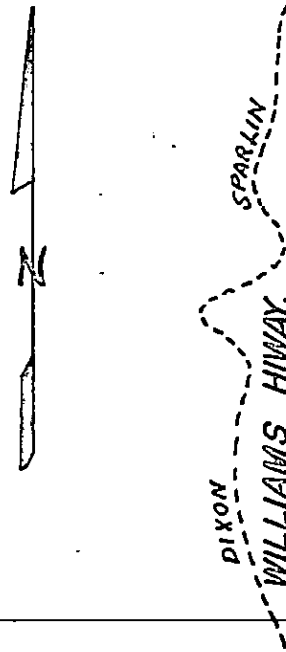

27

STATE FORESTRY

5 AC

23 AC

17 AC

33 AC

35 AC

35 AC

RES.

Application No. 38651

Permit No. 28814 cert 16343

240' N
260' W

SE CORN.