

# APPLICATION TO USE STORED WATER

IN THE NAME OF THE ESTATE OF MARIE GAIL McELROY  
(JOSEPH V. RYCKMAN, MD, PERSONAL REPRESENTATIVE)

TOWNSHIP 37 S, RANGE 6 W, SECTION 24 W.M.  
JOSEPHINE COUNTY OREGON

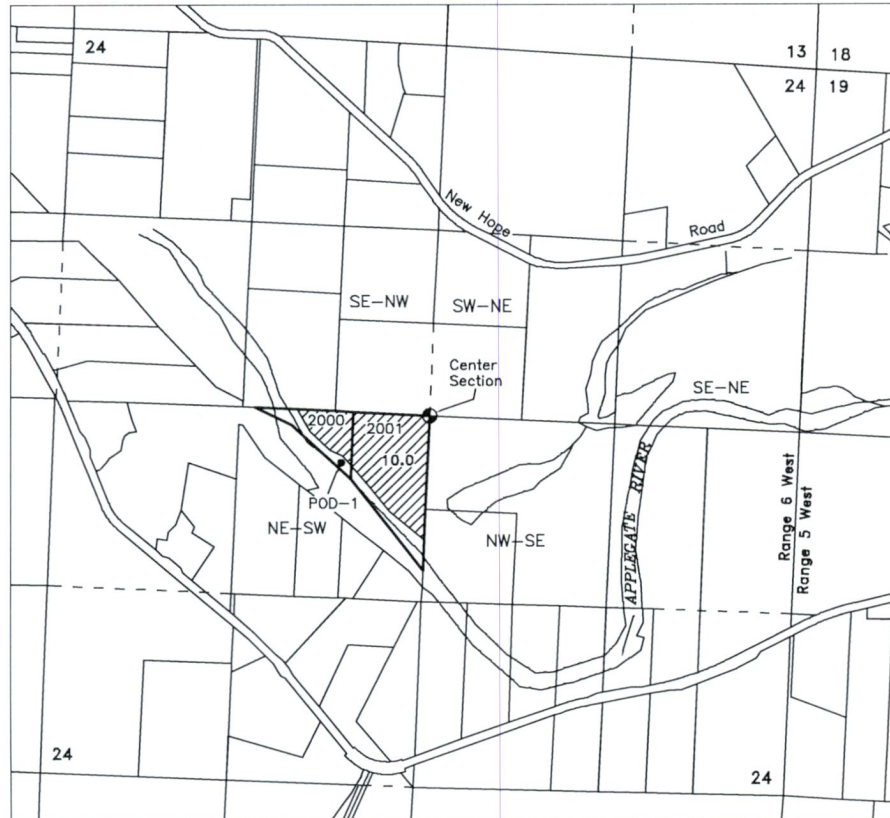

POINT OF REDIVERSION: 360 feet south & 620 feet west  
from the center corner of section 24

RECEIVED

OCT 14 2019

OWRD



Irrigation of 10.0 Acres

SOURCE: Applegate Lake Reservoir  
Constructed under Permit R-7810

CONTACT:

Joseph V. Ryckman  
10907 Edgewater Drive  
Cleveland, OH 44102

Base map Josephine County GIS Tax Lots over Oregon  
Map aerial photo for assumed best fit

This map is not intended to provide legal dimensions  
or locations of property ownership lines

Scale  
1 inch = 1320 feet



Drawn 9/11/2019 - n.e.d.  
Revised 9/11/2019 - n.e.d.

add S-88747