

T.5S. R.3W. Section 27, 28, 33, 34

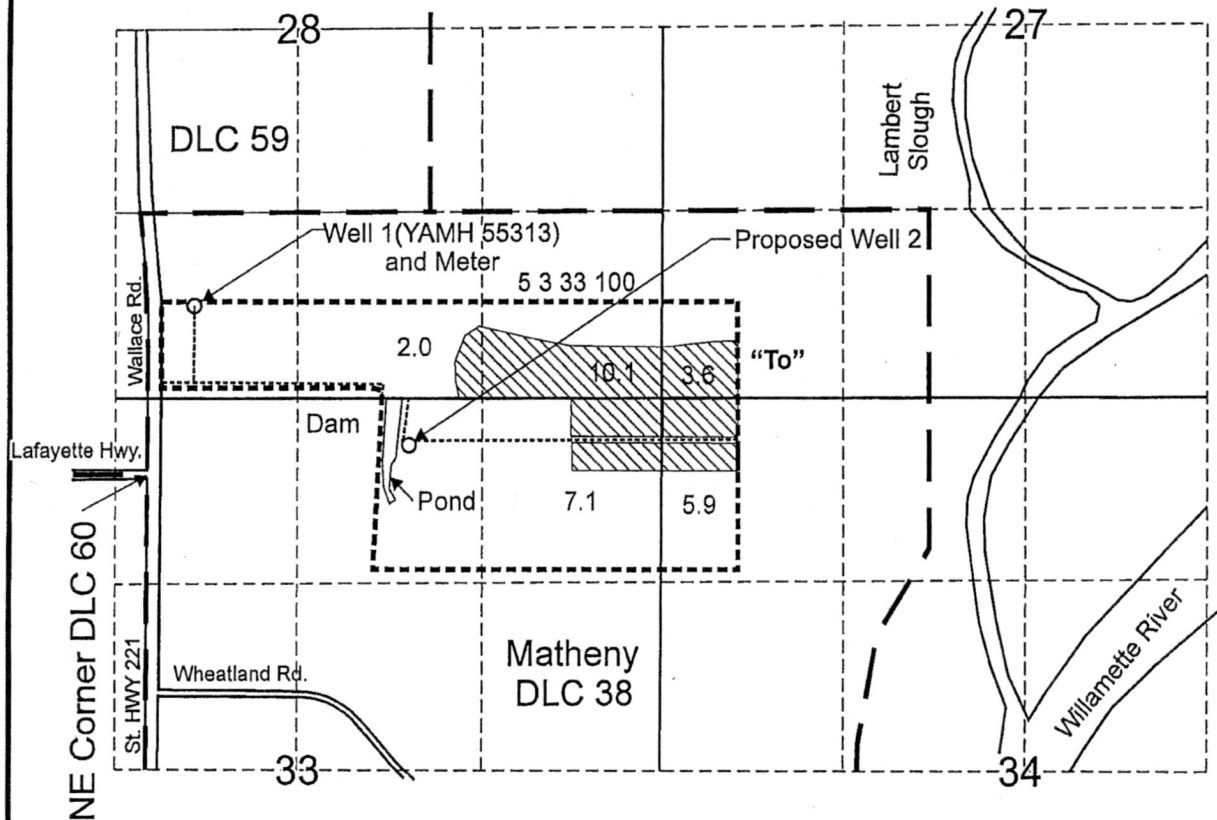

Well 1 (YAMH 55313) is located 1,200 feet north and 265 feet east from the NE corner, Adam Matheny DLC 60.

Proposed Well 2 is located 200 feet north and 1,880 feet east from the NE corner, Adam Matheny DLC 60.

 Area (28.7 Acres) to be irrigated under GR-1960 (Priority 1944).

----- Tax lot boundary

..... Mainline

RECEIVED
 CERTIFIED WATER RIGHTS EXAMINER
 #60772WRE
Melissa R. Kupillas
 MELISSA R. KUPILLAS
 JUNE 28, 1990
 STATE OF OREGON
 WATER RESOURCES DEPT
 SALEM, OREGON

EXPIRATION DATE 6/30/13

Scale: 1" = 1,320'

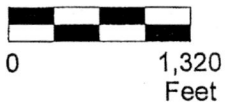

This map was prepared for the purpose of identifying the location of a water right only and is not intended to provide legal dimensions or location of property ownership lines.



Ground Water Registration Modification (Map 3 of 3)
 GR-1960

Carlton Nursery Co. LLC
 T.5S. R.3W. Section 28, W.M.

Pacific Hydro-Geology Inc.