



Oregon Water Resources Department
 725 Summer Street NE, Suite A
 Salem Oregon 97301-1266
 (503) 986-0900
 www.wrd.state.or.us

RECEIVED

JUN 11 2007

WATER RESOURCES DEPT
 SALEM, OREGON

Request for Assignment

If for multiple rights, a separate form and fee for each right will be required.

1. Don Johnson / 4 J. Ranch
 (Name of Applicant / Permit / Transfer Holder)

PO Box 66 Riddle OR 97469 541 874 2231
 (Mailing address) (City) (State) (Zip) (Phone #)

- ...hereby assign all my interest in and to application/permit/transfer;
- ...hereby assign all my interest in and to a portion of application/permit/transfer;
 (You must include a map showing the portion of the application/permit to be assigned.)
- ...hereby assign a portion of my interest in and to the entire application/permit/transfer;

Application # G15675, Permit # G15252; Transfer # _____
 -OR-

GR Statement # _____, GR Certificate of Registration # _____

as filed in the office of the Water Resources Director, to:

THOMAS M. Howard and BARBARA Howard
 (Name of New Owner)

PO Box 196 Drewsey OR 97904 541 493 2603
 (Mailing address) (City) (State) (Zip) (Phone #)

NOTE: If there are other owners of the property described in this Application, Permit, Transfer or Certificate of Ground Water Registration, you must provide a list of all other owners' names and mailing addresses and attach it to this form.

I hereby certify that I have notified all other owners of the property described in this Application, Permit or Certificate of Registration of this request for assignment.

Witness my hand this 25th day of May, 2007.

Applicant/Permit holder _____

Applicant/Permit holder _____

DO NOT WRITE IN THIS BOX

This certifies assignment and record change at Oregon Water Resources Department effective 8:00 a.m. on date of receipt at Salem, Oregon. Fee receipt # 88076
 For Director by Jerry Sauter, Program Analyst in Water Rights Division *Jerry Sauter*

The completed "Request for Assignment" form *must* be submitted to the Department along with the appropriate recording fees:

- \$25 for the first page, and
- \$5 for each additional page.

[as required by ORS 536.050(1)(d)]

OK SIGN PARTIAL
 J.H.S. 6/12/2007

T 24 S, R 33 E, WM

RECEIVED

JAN 16 2001
WATER RESOURCES DEPT.
SALEM, OREGON

RECEIVED

JAN 03 2002
WATER RESOURCES DEPT.
SALEM, OREGON

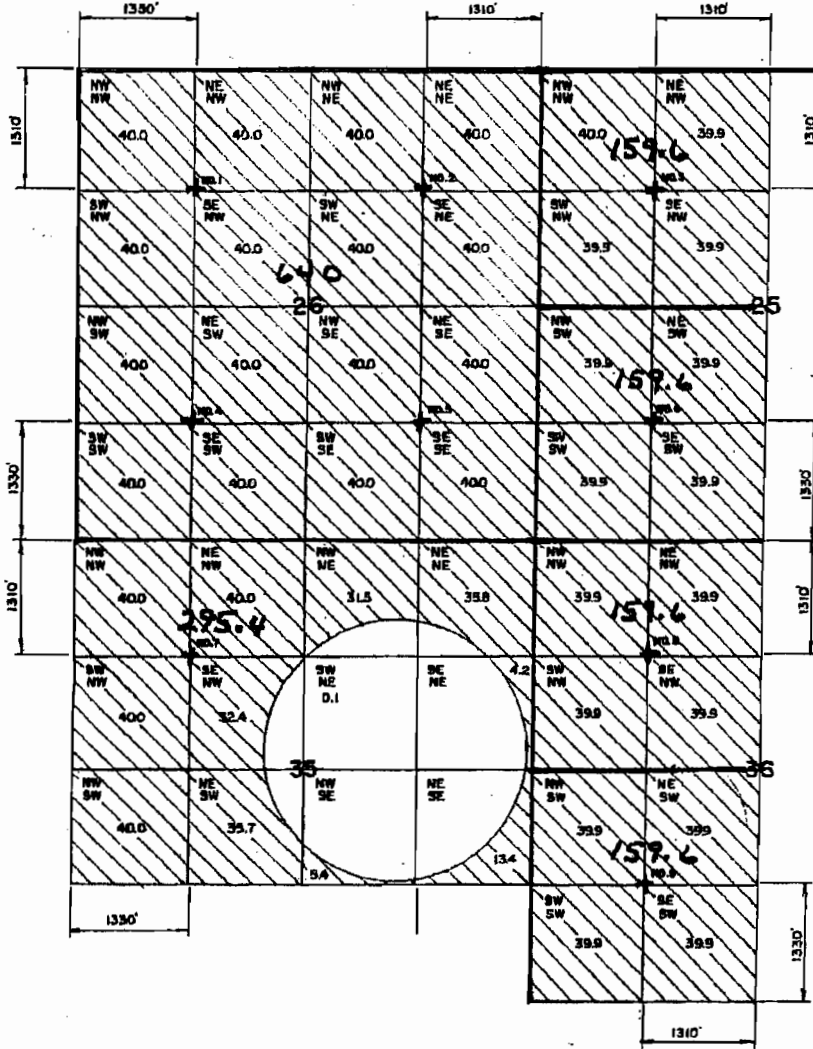

This portion to be
Assigned from
Don Johnson to Thomas M.
and BARBARA HOWARD.

WELL LOCATIONS

Well No.	N/S Dist.	E/W Dist.	From Cor.
1	1310' S	1300' E	NW of Sec. 26
2	1310' S	1310' W	NE of Sec. 26
3	1310' S	1310' W	N1/4 of Sec. 25
4	1310' N	1330' E	SW of Sec. 26
5	1330' N	1310' W	SE of Sec. 26
6	1330' N	1310' W	S1/4 of Sec. 25
7	1310' S	1300' E	NW of Sec. 35
8	1310' S	1310' W	N1/4 of Sec. 36
9	1330' N	1310' W	S1/4 of Sec. 36

SECTIONS 25 & 36 - TAX LOT 8900
SECTION 26 - TAX LOT 7400
SECTION 35 - TAX LOT 9100

4 - WELL LOCATIONS (TOTAL OF 9 WELLS)

THE PURPOSE OF THIS MAP IS TO
IDENTIFY THE LOCATION OF THE
WATER RIGHT. IT IS NOT INTENDED
TO PROVIDE INFORMATION RELATIVE
TO THE LOCATION OF PROPERTY
OWNERSHIP.

Application No. G-15675
Permit No. G-15852

	4J RANCH / CRANE		
	WATER RIGHT APPLICATION MAP		
	Scale: 4" = 1 MILE	Date: 9-15-2001	Job: 2027
	Dwn: CHRIS Cld:		M.A. PALMER & SONS, INC. ENGINEERING & SURVEYING 711 Piedmont Village - Box 81 Burns, Oregon 97720