

10213

STATE OF OREGON, COUNTY OF COOS,

SECTION No. 23

STATE ENGINEER
RECEIVED

JUN 1 1925

SALEM, OREGON

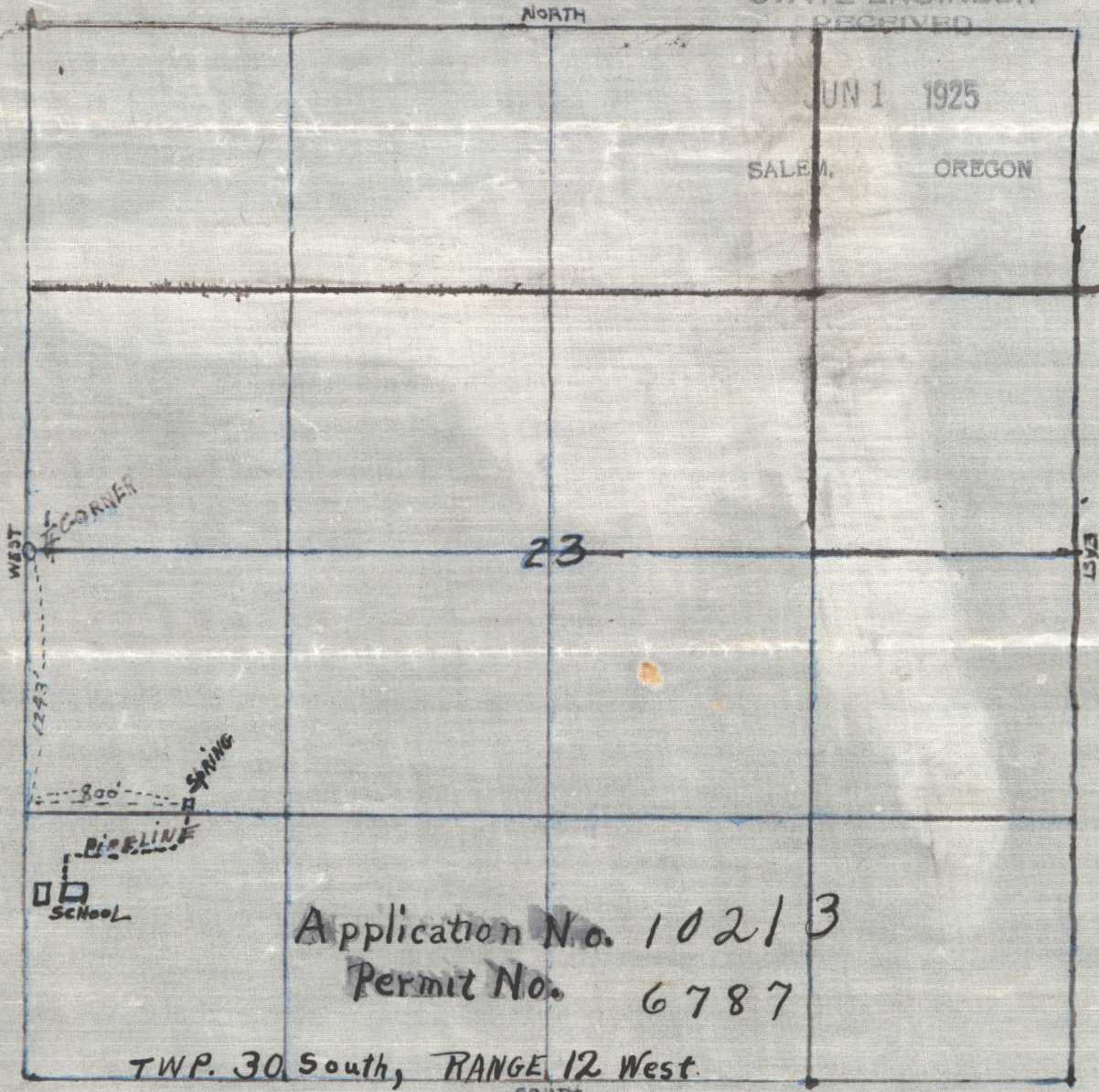

Application No. 10213
Permit No. 6787

TWP. 30 South, RANGE 12 West.

REMARKS—Location of Spring for purpose of providing water for School Houses in S.W. $\frac{1}{4}$ of S.W. $\frac{1}{4}$ Section 23
Spring is located 1243 feet South and 800 feet East of $\frac{1}{4}$ Corner between Sections 23 and 22 TOWN 20 South RANGE 12 WEST of Willamette Meridian Coos County, Oregon.

SCALE = 6" = 1 MILE

B. F. Segner C. E.
by Fred C. Whitt.

10213

10213

STATE OF OREGON, COUNTY OF Coos,

Section No. 23

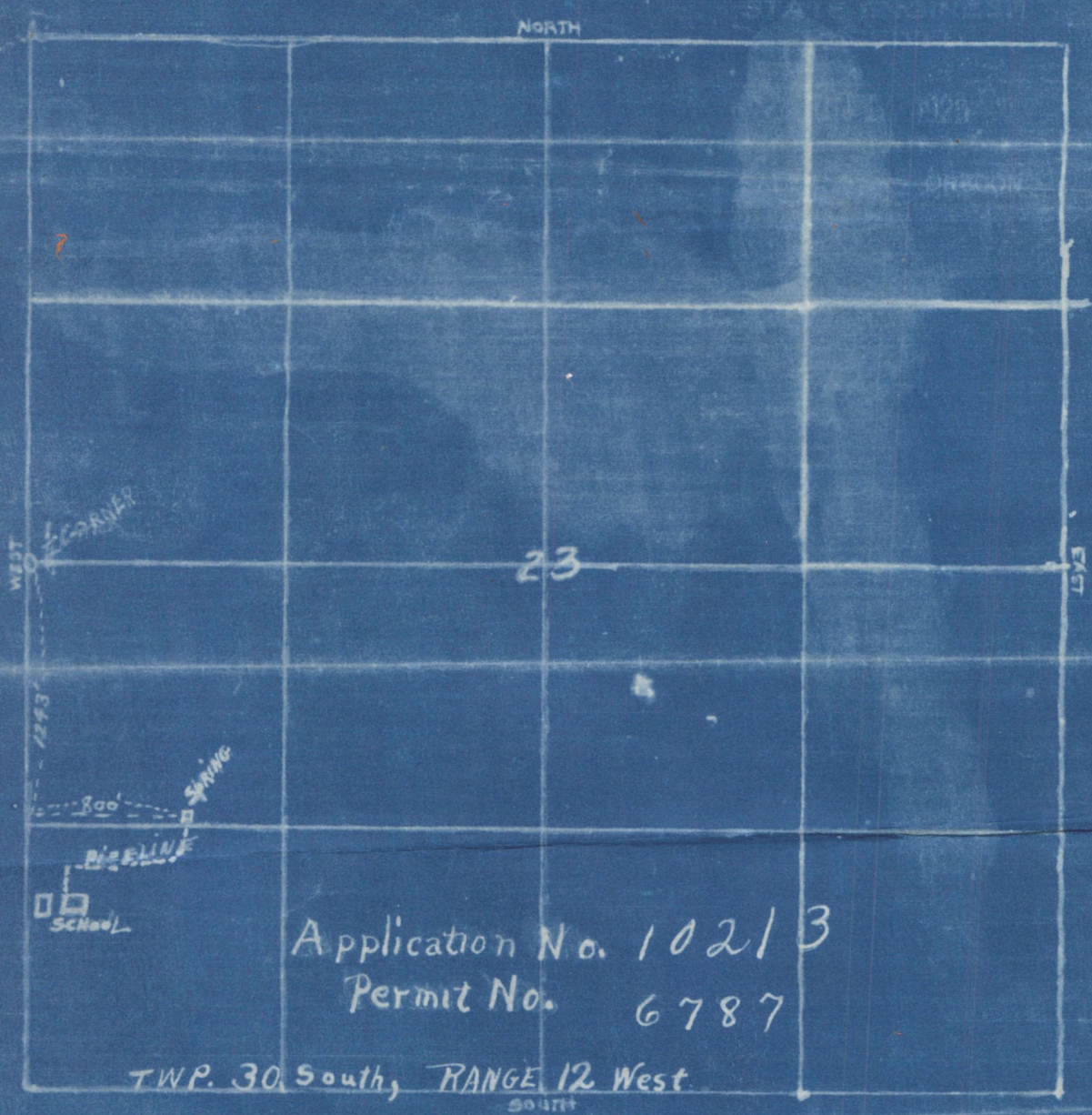

Application No. 10213
 Permit No. 6787

TWP. 30 South, RANGE 12 West

REMARKS - Location of Spring for purpose of providing water for School Houses in S.W. $\frac{1}{4}$ of S.W. $\frac{1}{4}$ Section 23. Spring is located 1243 feet South and 800 feet East of $\frac{1}{4}$ Corner between Sections 23 and 22 TOWN 30 South RANGE 12 WEST of Willamette Meridian Coos County, Oregon.

SCALE = 6" = 1 MILE

B. F. Segue C. E.
 by Fred C. Whitte

10213

10513

STATE OF OREGON, COUNTY OF Coos,

Section No. 23

STATE ENGINEER RECEIVED

JUN 1 1925

SALEM, OREGON

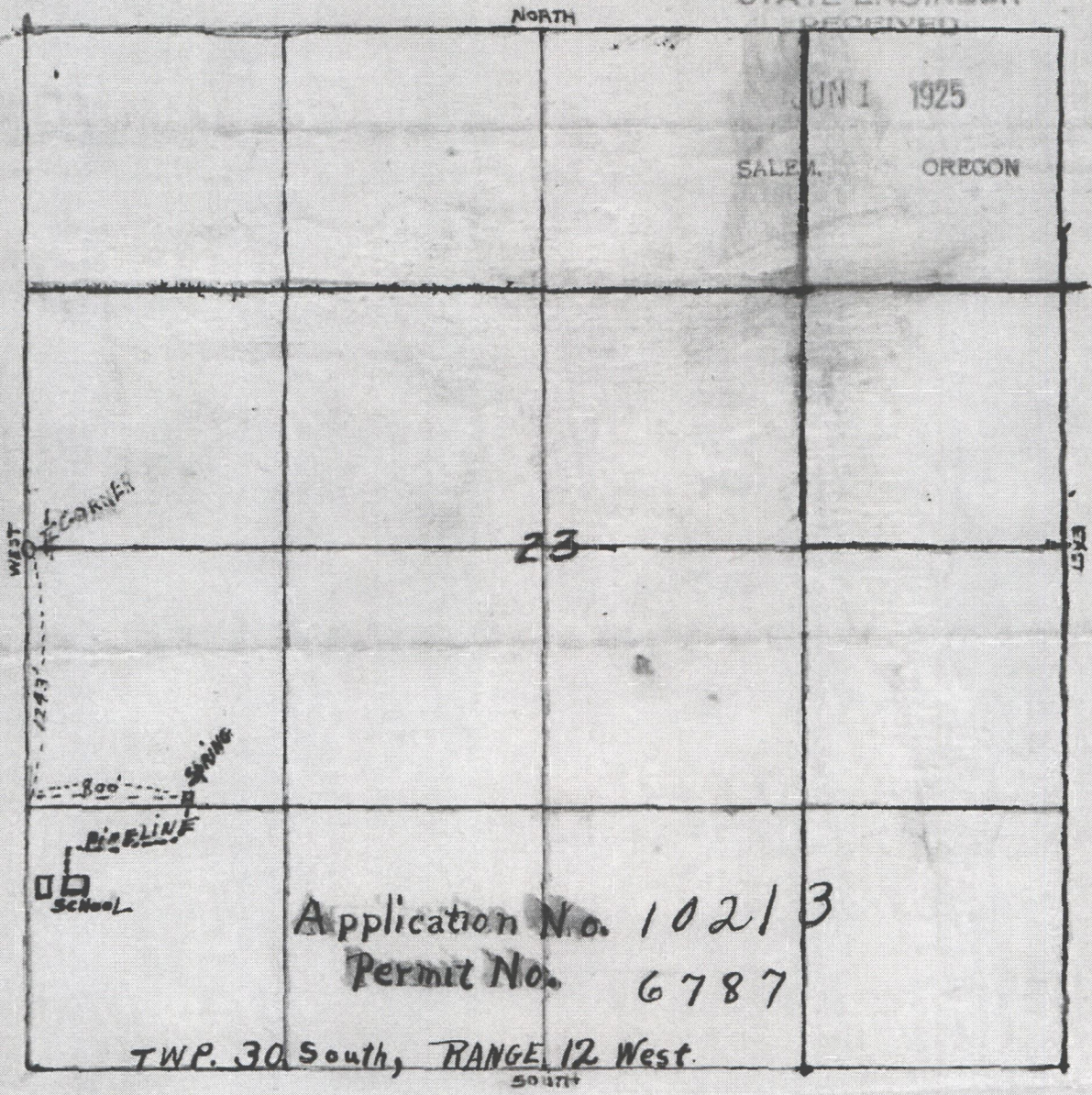

Application No. 10213
Permit No. 6787

TWP. 30 South, RANGE 12 West.

REMARKS Location of Spring for purpose of providing water for School Houses in S.W. 1/4 of S.W. 1/4 Section 23
Spring is located 1243 feet South and 800 feet East of 1/4 Corner between Sections 23 and 22 TOWN 27 South RANGE 12 WEST 1/4 Willamette Meridian Coos County, Oregon.

SCALE = 6" = 1 MILE

B. F. Segner C. E.
by Fred C. Whitt.

10213

STATE OF OREGON, COUNTY OF COOS,

Section No 23

STATE OF OREGON

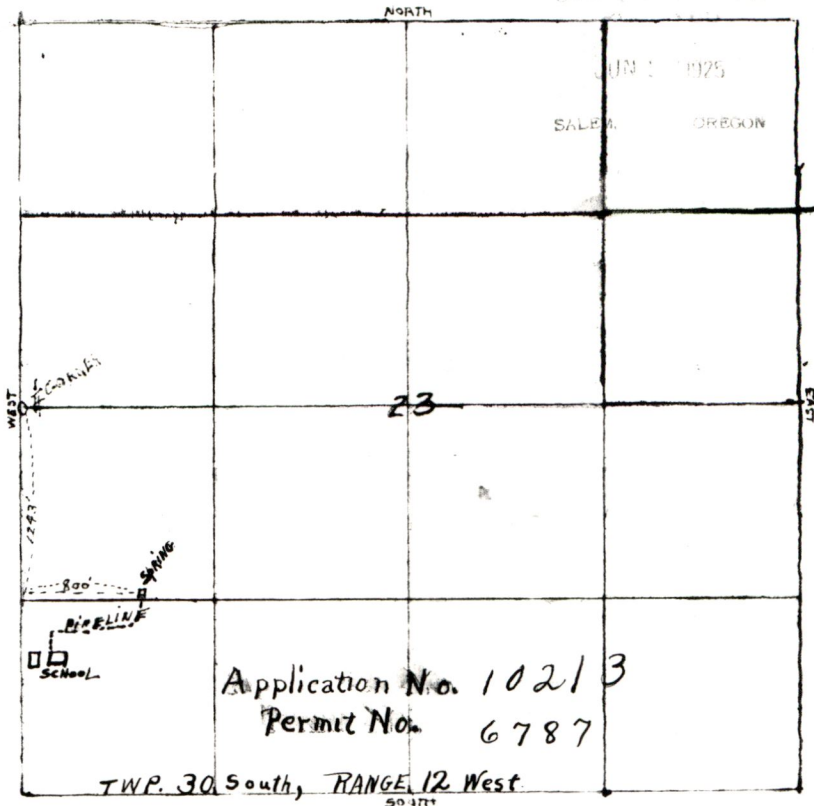

10213

Application No. 10213
Permit No. 6787

TWP. 30 South, RANGE 12 West

REMARKS—Location of Spring for purpose of providing water for School Houses in S.W. 1/4 of S.W. 1/4 Section 23
Spring located 1243 feet South and 800 feet East of
1/4 Corner between Sections 23 and 22 TOWN 30 South RANGE 12 WEST
1/4 Willamette Meridian Coos County, Oregon.

SCALE = 1" = 1 MILE

B. F. Deane C. E.
By Fred [unclear]

Copy