

M. JOHN YOUNGQUIST
WATER RESOURCES CONSULTANT

827 SE MOSHER
ROSEBURG, OREGON 97470
PHONE/FAX: (541) 672-5692

RECEIVED

MAR - 9 1998

WATER RESOURCES DEPT.
SALEM, OREGON

PROJECT MANAGEMENT

PERMITS/LICENSING

RESEARCH

PLANNING

March 1, 1998

Laura K. Snedaker, Senior Water Rights Examiner
Oregon Water Resources Department
158 12th Street, NE
Salem, Oregon 97310-0210

Re: Application No. R-83543

Dear Ms. Snedaker

Enclosed find a corrected application map and supplemental sheet for the reservoir application. I believe these will correctly address the items raised in your letter to Lynn Cary dated February 17, 1998.

Please contact me if you have any questions or need additional information.

Yours truly,

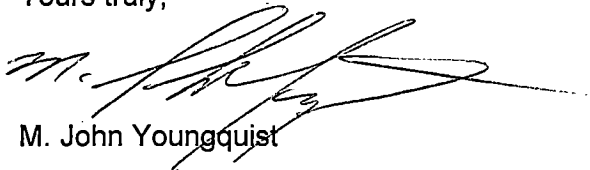

M. John Youngquist

cc: Cary Bogs
Route 1, Box 1507
Bandon, Oregon 97411

RECEIVED

MAR - 9 1998

WATER RESOURCES DEPT.
SALEM, OREGON

APPLICATION MAP

IN THE NAME OF CARY BOGS

T 30 S, R 14 W, W.M, SECTION 7

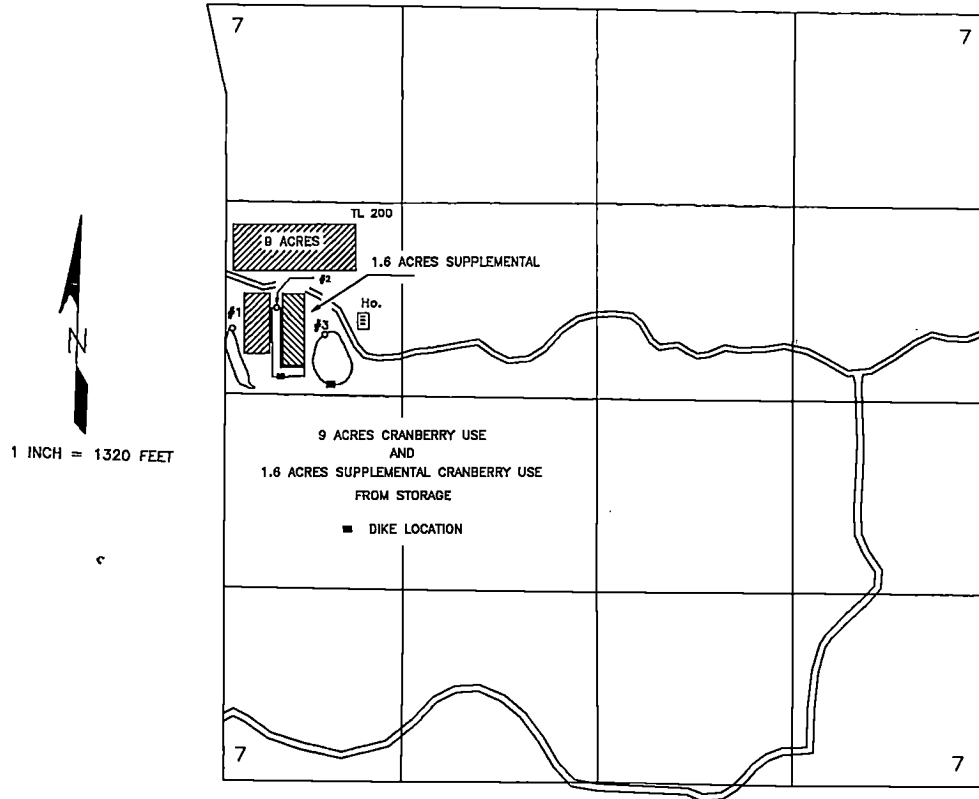

THE POINTS OF DIVERSION ARE TO BE LOCATED AS FOLLOWS:

SOURCE	NORTH	EAST	¼ ¼	COMMENT
RESERVOIR No. 1	455 FEET	60 FEET	SW¼ NW¼	PUMP @ DAM
RESERVOIR No. 2	540 FEET	360 FEET	SW¼ NW¼	PUMP LOCATION
RESERVOIR No. 3	390 FEET	700 FEET	SW¼ NW¼	PUMP LOCATION
RESERVOIR No. 2	115 FEET	400 FEET	SW¼ NW¼	HIGHEST DIKE LOCATION
RESERVOIR No. 3	60 FEET	750 FEET	SW¼ NW¼	HIGHEST DIKE LOCATION

ALL FROM THE WEST QUARTER CORNER OF SECTION 7 AND WITHIN SECTION 7, TOWNSHIP 30 SOUTH, RANGE 14 WEST, W.M.; IN COOS COUNTY.

THE PURPOSE OF THIS MAP IS TO IDENTIFY THE LOCATION OF THE WATER RIGHT.
IT IS NOT INTENDED TO PROVIDE INFORMATION RELATIVE TO THE LOCATION OF
PROPERTY OWNERSHIP BOUNDARY LINES.

RECEIVED

MAR - 9 1998

WATER RESOURCES DEPT.
SALEM, OREGON

CARY BOGS RESERVOIR APPLICATION
SUPPLEMENTAL SHEET

Reservoir No.	Type of Dam	Height	Outlet	Storage	Surface Area	Depth	Spillway
Reservoir No. 1	Earth Fill	9.5 Feet	18"	9 acre feet	1.0 Acre	16 feet	3' bottom width trapezoidal spillway around right abutment on original ground
Reservoir No. 2	Excavated	5.0 Feet	None	20 acre feet	1.2 Acres	25 feet	10" overflow pipe
Reservoir No. 3	Earth Fill	8.5 Feet	8"	27.6 acre feet	2.0 Acres	23 feet	3' bottom width trapezoidal spillway around left abutment on original ground

Comment: Reservoir No. 1 will be located in a "dry" draw. It will be filled by runoff from adjacent fields and rainfall.

Reservoir No. 2 will be excavated along side of cranberry fields. There may be a small dike (less than 10 feet in height) along the southeast side.

Reservoir No. 3 will be constructed in a sloping field. The field slopes from north to south and there will be a short dam on the down slope side. There is no drainage channel in the field at this time.

I will not encounter ground water in the excavated portions of the reservoir. Each reservoir will require considerable excavation to attain the required storage. I have attempted to drill wells for my water supply, however, there is insufficient ground water available for my use on this property.

M. John Youngquist
Water Resources Consultant
827 SE Mosher Avenue
Roseburg, Oregon 97470

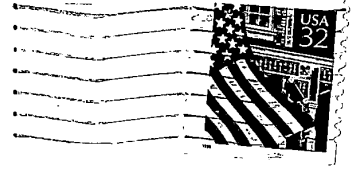

Laura Snedaker
Oregon Water Resources Department
158 12th Street, NE
Salem, Oregon 97310-0210

97310+0700

