

APPLICATION TO STORE WATER

ALTERNATE REVIEW PROCESS

TOWNSHIP 39S, RANGE 5W, W.M.

JOSEPHINE COUNTY OREGON

RECEIVED

JAN 31 2020

OWRD

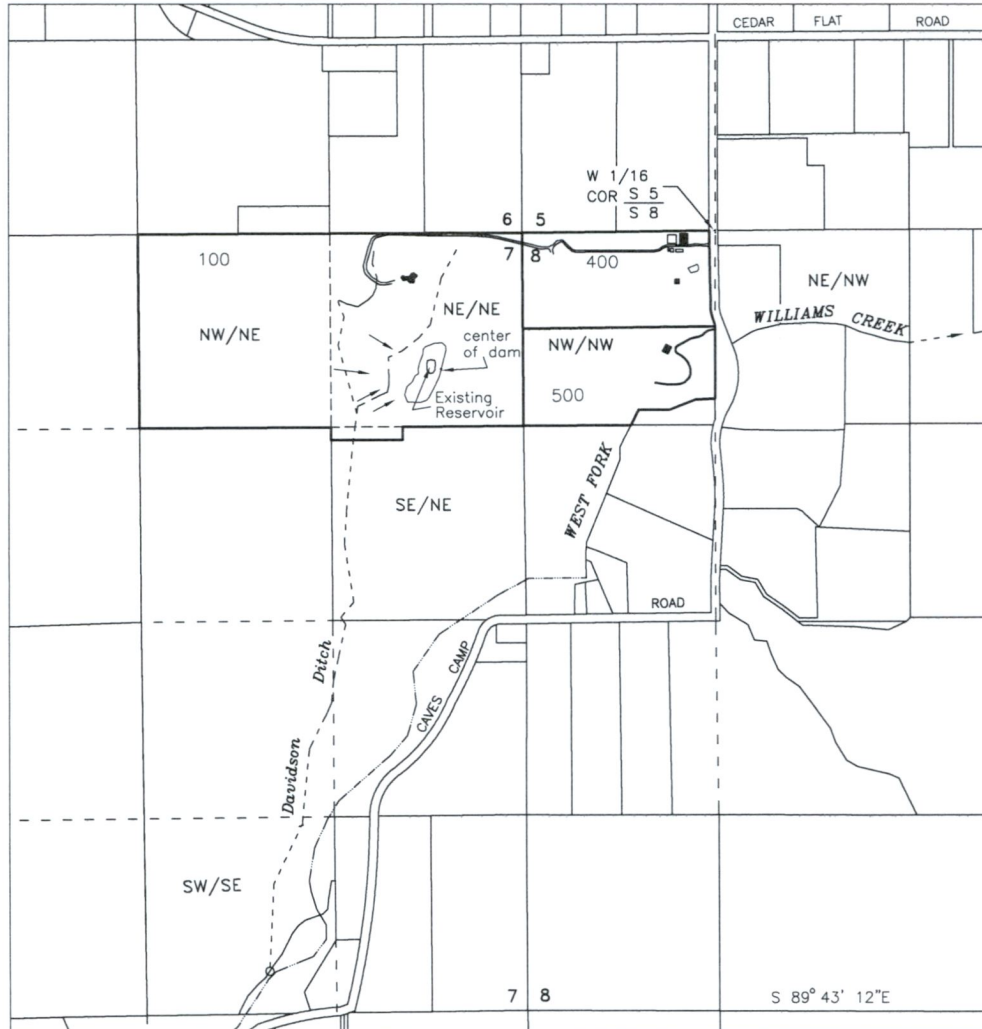

Legend

PREPARED FOR: FULL CIRCLE PROPERTIES, LLC
P.O. Box 471
Williams, OR 97544

Scale
1" = 1320'

Center of Dam – 950 feet South & 1885 feet west from the W 1/6 corner of Section 5 & 8 (proposed)

 Reservoir – 9.5 Acre-Feet
 Source – Runoff

Base map Josephine County GIS Tax Lots over 6/29/2018 Google aerial photo & Oregon Map aerial downloaded 1/13/2015 for assumed best fit

This map is not intended to provide legal dimensions or locations of property ownership lines

map oriented to south line of section 8, S89° 43'12"E

drawn 11/20/2019 n.e.d.



R-98804