

SECTION

TOWNSHIP 36 S, RANGE 7 W, W. M.

North

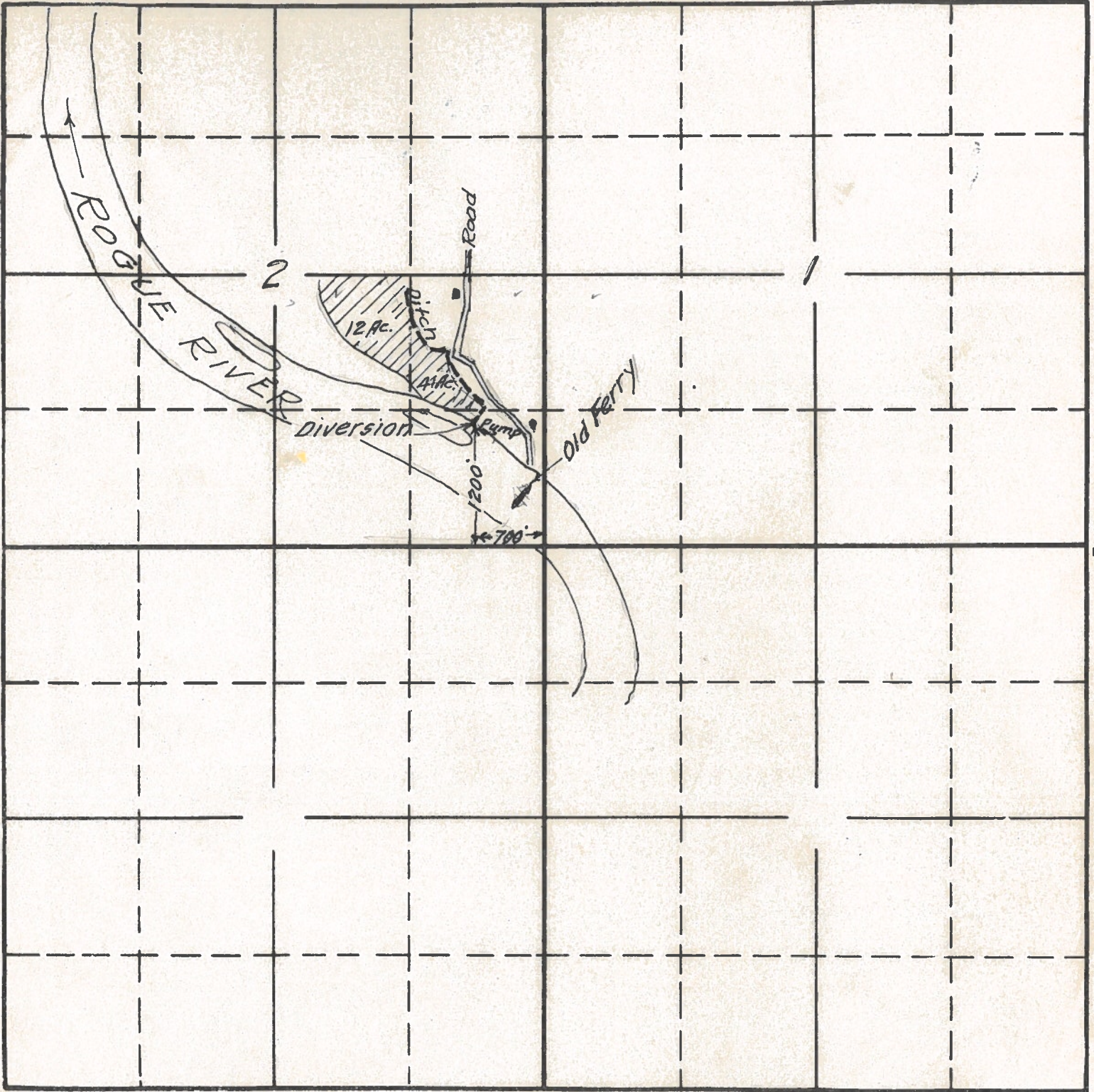

West

East

South

18106 or
15-60

RECEIVED
8:00 AM
MAY 23 1939
STATE ENGINEER
SALEM, OREGON

Maud G. Kerr
May 1939

APPLICATION No. 18106
PERMIT No. 13761