

30 S Range 6 W , W.M.

North

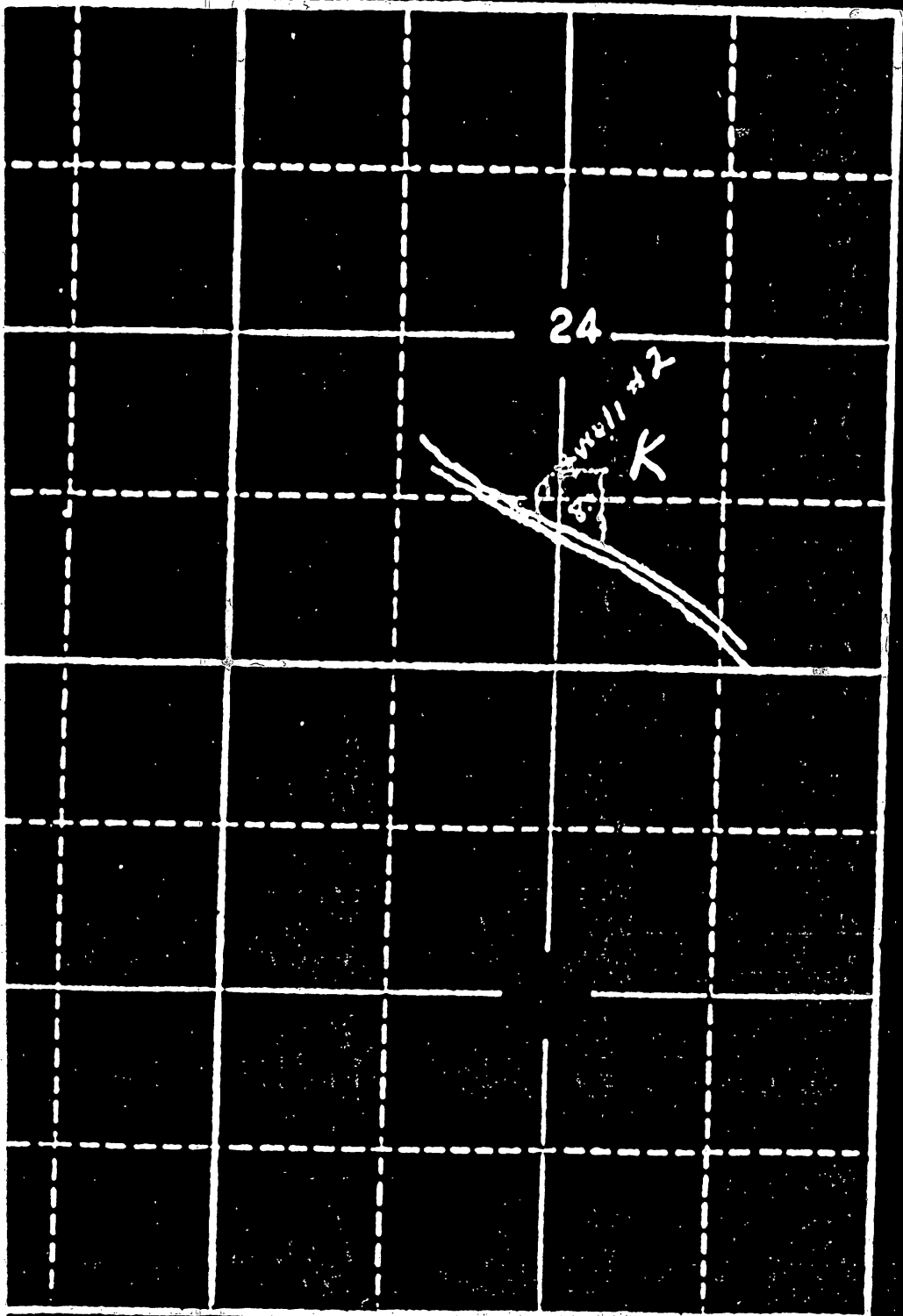

Copy 1.00 AC. NE SW
1.00 AC. SE SW
2.00 AC. NW SE
4.00 AC SW SE

Township 30 S Range 6 W, W.M.
North

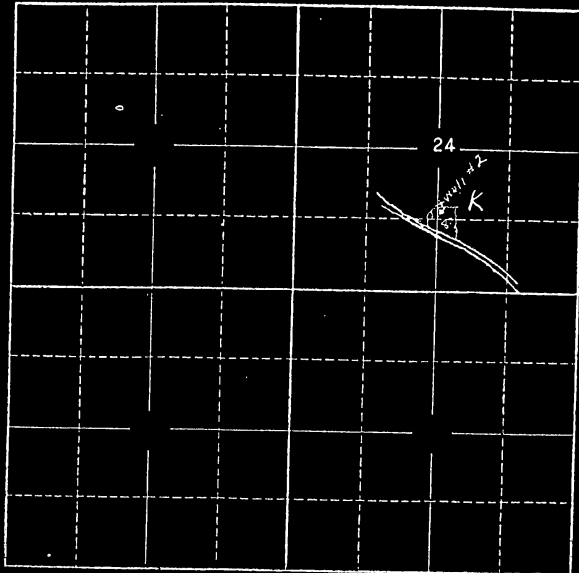

Locate well and acreage of irrigated land on plat.
Scale: 2" = 1 Mile

STATE OF OREGON

County of Douglas } ss.

I, Mayme E. Carter, being first duly sworn, do hereby certify that I have read the foregoing Registration Statement and that all of the items therein contained are true to the best of my knowledge and belief.

Mayme E. Carter
(Signature of Registrant)

Subscribed and sworn to before me this 17 day of July, 1958

My commission expires March 16, 1959

David Carter
(Notary Public)

(SEAL)

For Oregon

CERTIFICATE OF REGISTRATION

STATE OF OREGON } ss.
County of Marion

This is to certify that the foregoing Registration Statement was received in the office of the State Engineer on the _____ day of _____, 1958, at _____ o'clock _____ M. and has been duly recorded in said office in Book No. 10 of Registration Statements on page GR-3313

Witness my hand this 10th day of March, 1959

#1500

GR 3313

Registration Statement

OF CLAIMANT OF RIGHT TO APPROPRIATE GROUND WATER

ASSIGNED. See Misc. Rec. Vol. 7 Page 2174

TO THE STATE ENGINEER OF OREGON:

I, Mayme E. Carter (a Widow)
of Route 1, Box 107 Riddle County of Douglas
(Mailing address)
State of Oregon, do hereby make application for a certificate of registration as evidence of a right to appropriate ground water.

1. Source from which water is withdrawn is Pump Well
(Flowing well, pump well, infiltration trench, or tunnel)

2. Location is: 1/2 Mile East of Riddle
(Approximate distance and direction from nearest city or town)

and is more particularly described as follows: Beginning at a point 3.41 chains S from the J.C. Vanderbosch D.L.C.No. 47 T 30 S . R 6 W, W.M. Thence South 1° East 420 Ft.

(a) N.W.1/4 of S.E.1/4 of Sec. 24, Twp. 30 S, Rge. 6 W, W.M.
(Give distance and bearing to corner of section or other legal subdivision)
(Smallest legal subdivision) (N. or S.) (E. or W.)

or (b) within limits of recorded platted property, town or city:
in Lot _____, Block _____ of _____
(Name of plat or addition)

County of _____
(If within city or town, give name)

3. Construction Work was begun on July 1951; was completed on July 1951
(Date) (Date)
and the ground water claimed was first used for the purposes set out below on Last half July 1951
(Date)
since which time the water has been used When the pear crop sets so as to justify irrigating.
(Continuously or Intermittently)
from 15 of June to last of Aug.
(Date) (Date)

4. Quantity of water claimed and used is 120 gallons per minute; _____ acre feet per year.

5. Purpose or Purposes for which water is used Irrigating approx. 8 acres of pear orchard
(Domestic, irrigation, municipal, manufacturing, industrial, etc.)

6. Description of Well: Depth 15 feet. Type Dug
(Dug or drilled)
diameter 30 inches. Elevation of ground at well site 700 feet, mean sea level.
(As near as known)
Depth to water table 12 feet. July 1954

7. Capacity of Well: 120 g.p.m. with 2 feet drawdown.
_____ g.p.m. with _____ feet drawdown.
Date of test July 2x 1954

If Flowing Well: Measured discharge _____ g.p.m. on _____
(Date)

Shut-in pressure at ground surface _____ lbs. per sq. in. on _____
(Date)

Water is controlled by _____
(Cap, valve, etc.)

If log of well is not available, give name and address of driller

11. Infiltration Trench: Covered or open

Dimensions: Length ft. Minimum depth ft. Maximum depth ft.

Bottom width ft. Discharge g.p.m. Date of test

12. Tunnel: Type of lining

Dimensions:
(Length, course, and cross sectional size)

Position of water bearing stratum with reference to portal of tunnel

Log of tunnel: (Preceding table for log of well may be used, if desired. Give footage from portal and character of materials, as pertinent.)

13. Pumping Equipment:

(a) Pump Pacific V. Belt Drive Centrifugal Capacity 120 g.p.m.
(Make, type and size)

(b) Motor Electric Single Phase 5 H.P.
(Type and horsepower)

14. Location of area irrigated or to be irrigated, or place of use if for purposes other than irrigation.

Township North or South	Range E. or W. of Willamette Meridian	Section	Forty-acre Tract	Number Acres To Be Irrigated	Date of Reclamation
30 S	6 W	24	N.W. 1/4 of S.E. 1/4	2 ⁰	1951
30 S	6 W	24	S.W. 1/4 of S.E. 1/4	4 ⁰	"
30 S	6 W	24	N.E. 1/4 of S.W. 1/4	1 ⁰	"
30 S	6 W	24	S.E. 1/4 of S.W. 1/4	1 ⁰	"
				<u>8⁰ Ac</u>	"

15. If the ground water supply is supplemental to an existing water supply, identification of any application for a permit, permit, certificate or adjudicated right to appropriate water made or held by the registrant.

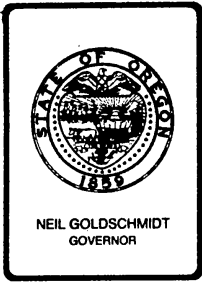

Water Resources Department

3850 PORTLAND ROAD NE, SALEM, OREGON 97310

PHONE 503 378-3739

May 19, 1989

EDWARD P. THOMPSON
875 COUNTRY CLUB ROAD, SUITE A
EUGENE, OR 97401

REFERENCE: Files GR-2360 and GR-2361

We have received your letters dated May 16, 1989 and security assignment.

They have been placed in the files.

Sincerely,

Thomas E. Shook
Water Right Specialist

RECEIVED

MAY 19 1989

WATER RESOURCES DEPT.
SALEM, OREGON

EDWARD P. THOMPSON
ATTORNEY AT LAW
875 COUNTRY CLUB ROAD, SUITE A
EUGENE, OREGON 97401
TELEPHONE (503) 683-1900

May 16, 1989

Mr. Tom Shook
Water Rights Specialist
Water Resources Department
3850 Portland Road, N.E.
Salem, OR 97310

RE: Files GR 2360 and GR 2361
Carter/Sweetwood

Dear Mr. Shook:

This will confirm our phone conversation of May 12 in which you notified me that you had received my letter of May 3, and had updated your file to show the owner of the water rights as the Estate of Carter, which were then assigned to Sweetwood. You also informed me that you had sent back the assignment for security from Sweetwood to Carter. As we agreed, I am returning that to you so that your records will reflect the continuing interests of the Estate of Carter as a security interest holder in the unadjudicated water rights referenced above. You have suggested that the way to accomplish that within your system is to place it in the relevant "file," and you have assured me that the existence of that security interest will be disclosed to anyone who asks about the ownership of those rights. Thank you for your courtesies.

Very truly yours,

EDWARD P. THOMPSON

EPT: dh
Enclosures
cc: Client

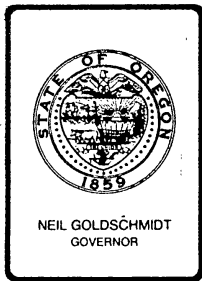

Water Resources Department

3850 PORTLAND ROAD NE, SALEM, OREGON 97310

PHONE 503 378-3739

May 12, 1989

EDWARD P. THOMPSON
875 COUNTRY CLUB ROAD, SUITE A
EUGENE, OR 97401

REFERENCE: Files GR-2360 AND 2361

The assignments, by deed, of statements identified as applications GR-2360 and GR-2361, certificates of registration GR-2242 and GR-2243 to Darrel T. Carter have been filed in the records of the Water Resources Department.

The reassignments of the same claims from the Estate of Juanita Carter to Harold D. Sweetwood have also been recorded in the records of the Water Resources Department.

The original assignment has been sent to Mr. Sweetwood.

Our receipt No. 57882 covering the \$30 filing and recording fees is enclosed. The \$20 submitted by the title company was refunded earlier.

I did not reassign the claims to the Estate of Juanita Carter. That document is also enclosed. In the event Mr. Sweetwood does not satisfy the contract, this form could be submitted along with the recording fee and our records would be changed to show the Estate of Juanita Carter as holder of claims GR-2242 and GR-2243.

Sincerely,

Thomas E. Shook
Water Right Specialist

cc: Harold D. Sweetwood
Watermaster, Gary Ball, Dist 15

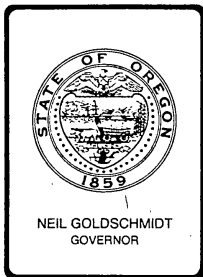

Water Resources Department

3850 PORTLAND ROAD NE, SALEM, OREGON 97310

PHONE 503 378-3739

February 23, 1989

DOUGLAS COUNTY TITLE COMPANY
PO BOX 1700
ROSEBURG, OR 97470-0414

REFERENCE: Files GR-2360 and GR-2361
ESCROW 88-325 Carter/Sweetwood

Here are our refund checks numbered 6689 and 6692 in the amount of \$20.

The assignment was not completed and our records still show Mayme E. Carter as holder of claims GR-2242 and GR-2243.

Sincerely,

Thomas E. Shook
Water Right Specialist



Water Resources Department

3850 PORTLAND ROAD NE, SALEM, OREGON 97310

PHONE 503 378-3739

November 30, 1988

DOUGLAS COUNTY TITLE COMPANY
P.O. BOX 1700
ROSEBURG, OR. 97470-0414

REFERENCE: Files GR-2360 AND GR-2361
Carter/Sweetwood

We have not had a response to my letter dated July 22, 1988 regarding an assignment of Certificates of Registration GR-2242 and GR-2243.

Unless we hear from you within 30 days from the date of this letter, we will assume our records are not to be changed and the \$20 you submitted will be refunded to you.

Sincerely,

Thomas E. Shook
Water Right Specialist

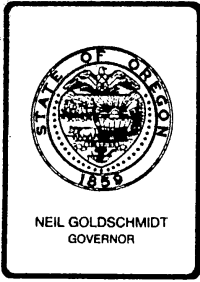

Water Resources Department

3850 PORTLAND ROAD NE, SALEM, OREGON 97310

PHONE

503-378-3739

July 22, 1988

DOUGLAS COUNTY TITLE COMPANY
PO BOX 1700
ROSEBURG, OR. 97470-0414

REFERENCE: Files GR-2360 and GR-2361

We have received requests to assign Certificates of Registration GR-2242 and GR-2243 from the Juanita L. Carter Estate to Harold D. Sweetwood and re-assign these statements to the Juanita L. Carter Estate along with a check in the amount of \$20.

Our records show these statements to be in the name of Mayme E. Carter. It is my understanding that Mayme Carter has passed away; therefore, it will be necessary for the personal representative for her estate to sign an assignment form giving the name to be shown on our records. A new form is enclosed for this reason.

I have also enclosed the two assignments sent to us for recording.

Further action will be withheld on these files for a reasonable length of time pending your reply.

Sincerely,

Thomas E. Shook
Water Right Specialist

GE-2561

March 24, 1959

Wayne E. Carter
Rt. 1, Box 107
Middle, Oregon

Dear Madam:

GR-2561
GR-2243

GR-2360
GR-2361

July 30, 1958

Mayme E. Carter
Route 1, Box 107
Riddle, Oregon

Dear Madam:

This will acknowledge receipt of your two well registration statements and check for fees in the amount of \$30 for which our receipts Nos. 17952 and 17953 are enclosed.

The statements have been assigned Nos. GR-2360 and GR-2361 and after we have had an opportunity to examine them we will communicate with you further.

Very truly yours,

LEWIS A. STALEY
State Engineer

By
Wm. S. Partholomew
Geologist

mb
enc

RECEIVED RECEIVED (2)

MAY 19 1988

JUN 07 1988

WATER RESOURCES DEPT. SALEM, OREGON

GROUND WATER REGISTRATION ASSIGNMENT

I, Harold D. Sweetwood

(Mailing Address) (City) (County) (State) (Zip)

do hereby assign all my right, title and interest in and to ground waters and 2361 acquired through Statement No. GR-2360/, Certificate of Registration No. GR 2242/ and 2243 of record in the office of the Water Resources Director of Oregon to Estate of Juanita L. Carter, or its assigns, c/o John E.

Carter, 3191 Crocker Road, Eugene, Lane County, Oregon 97404
(Mailing Address) (City) (County) (State) (Zip)

This assignment is for security only. Upon performance and discharge of a certain Land Sale Contract regarding the property surrounding the wells listed above, the security interest of the Estate of Juanita L. Carter shall cease and all right, title and interest in the ground water registration shall be and remain in the name of Harold D. Sweetwood, the assignor hereunder.

WITNESS my hand this 1st day of June, 1988.

Harold D. Sweetwood

Signature of the Assigner
Harold D. Sweetwood

STATE OF OREGON, } ss
County of Marion.

I certify that the within was received by me on the _____ day of _____, 19____, at _____ o'clock _____ m., and was recorded in Miscellaneous Records, Vol. _____ Page _____.

Water Resources Director

The completed assignment must be submitted to the Water Resources Director, 3850 Portland Road, NE, Salem, Oregon 97310, together with a recording fee in the amount of _____