



February 15, 2016

Machelle Bamberger  
Oregon Water Resources Department  
725 Summer Street NE, Suite A  
Salem, OR 97301

RE: Extension Application for Permit G-12301 (Sunnyside Dairy, LLC)

Dear Ms. Bamberger:

On behalf of my client, Sunnyside Dairy, LLC, please find enclosed an extension application for Permit G-12301. Also enclosed are supporting documents and a check in the amount of \$575 for application fees.

Should you have any questions concerning this application, please do not hesitate to contact me.

Respectfully,

A handwritten signature in blue ink that reads "Molly Reid".

Molly Reid  
Senior Water Resources Consultant  
(541) 310-7264 Cell

Cc: Rosalio Brambila, Manager, Sunnyside Dairy, LLC  
File

Enclosures: Extension Application  
Check #6618  
Supporting Documents

**RECEIVED**

FEB 16 2016

WATER RESOURCES DEPT  
SALEM, OREGON

**RECEIVED**

FEB 17 2016

WATER RESOURCES DEPT  
SALEM, OREGON

TO THE DIRECTOR OF THE OREGON WATER RESOURCES DEPARTMENT  
***A separate extension application must be submitted for each permit as per  
OAR 690-315-0020(2).***

I, Sunnyside Dairy, LLC – Rosalio Brambila (Manager)

NAME OF PERMIT HOLDER [OAR 690-315-0020(1) and (3)(a)]

4581 Maple Grove Road  
ADDRESS

Sunnyside  
CITY

WA  
STATE

98944  
ZIP

(509) 837-4779  
PHONE

rosalio@oorddairy.com  
E-MAIL ADDRESS

**RECEIVED**

FEB 17 2016

WATER RESOURCES DEPT  
SALEM, OREGON

the permit holder of:

Application Number G-12559

Permit Number G-12301

[OAR 690-315-0020(3)(b)]

**RECEIVED**

FEB 16 2016

WATER RESOURCES DEPT  
SALEM, OREGON

do hereby request that the time in which to:

complete construction (of diversion/appropriation works and/or purchase and installation of the equipment necessary to the use of water), which time now expires on **Month: October Day: 1 Year: 2014**, be extended to October 1, 2020 [OAR 690-315-0020(3)(i)]

N/A (Check this box if the permit does not specify a date by when construction must be completed.)

and/or the time in which to:

apply water to full beneficial use under the terms and conditions of the permit, which time now expires on **Month: October Day: 1 Year: 2014**, be extended to October 1, 2020 [OAR 690-315-0020(3)(i)]

I am the permit holder, or have written authorization from the permit holder (attached to this Application for Extension of Time), to apply for an extension of time under this permit. I understand that false or misleading statements in this extension application are grounds for OWRD to suspend processing of the request and/or reason to deny the extension.

Rosalio Brambila 2-11-16  
Signature Date  
Rosalio Brambila Manager  
Printed Name Title

Before submitting your Application for Extension of Time, make sure the following items are included:

- This completed Application for Extension of Time.
- Statutory fee of \$575.
- Signature page (Second page of this Application for Extension of Time).
- All supporting documentation and/or evidence referenced in the Application for Extension of Time.

**MAIL COMPLETED APPLICATION**  
along with the Supporting documents and/ or evidence

**\$575 STATUTORY FEE TO:**

**Water Resources Department  
Attn: Water Right Permit Extensions  
725 Summer Street NE, Suite A  
Salem, Oregon 97301**

**RECEIVED**

**FEB 17 2016**

**WATER RESOURCES DEPT  
SALEM, OREGON**

**RECEIVED**

**FEB 16 2016**

**WATER RESOURCES DEPT  
SALEM, OREGON**



**GENERAL TIPS:**

- Permit holders of **municipal or quasi-municipal water use permits DO NOT use this form**. The correct form is APPLICATION FOR EXTENSION OF TIME FOR MUNICIPAL AND QUASI-MUNICIPAL WATER USE PERMITS, available at the following link:  
[http://www.oregon.gov/owrd/PUBS/docs/forms/fillable\\_muni\\_quasi\\_ext\\_app\\_form\\_2014.doc](http://www.oregon.gov/owrd/PUBS/docs/forms/fillable_muni_quasi_ext_app_form_2014.doc)
- Request the reasonable amount of time necessary to fully complete construction of the water project and/or to fully use the permitted quantity of water under the terms and conditions of your permit. Should this request be approved, it will be OWRD's expectation that you will complete your project within the new time period allowed. Future extensions may not be granted.
- A separate APPLICATION FOR EXTENSION OF TIME must be submitted for each permit. OAR 690-315-0020(2).
- An instruction sheet, INSTRUCTIONS FOR COMPLETING AN APPLICATION FOR EXTENSION OF TIME FOR A WATER RIGHT PERMIT (Attachment A), provides details that will help you answer each question on the application. Permit extensions are evaluated under OAR Chapter 690, Division 315. These rules may be viewed at:  
[http://arcweb.sos.state.or.us/pages/rules/oars\\_600/oar\\_690/690\\_315.html](http://arcweb.sos.state.or.us/pages/rules/oars_600/oar_690/690_315.html)
- You may provide OWRD with any additional information or evidence that will aid us in making our decision. Please note that OWRD may require other information that is necessary to evaluate the application. OAR 315-0020(3)(n).

- After careful review of the Application for Extension of Time, you may contact OWRD at (503) 986-0900, to ask questions and request assistance from a Permit Extensions Specialist in the Water Rights Services Division.
- An Application for an Extension of Time will be reviewed for completeness. OWRD will return any incomplete or deficient applications to the applicant. OAR 690-315-0040(1)(a).

**Reference Materials Needed to Complete this Application:**

- **The water right permit.** If needed, a copy of the water right permit can be downloaded from the Department’s Website at <http://apps.wrd.state.or.us/apps/wr/wrinfo/> (using the link to the Water Rights Information System (WRIS). Or, a copy of the permit (or other documents) may be requested by water right application number from the Water Rights Division at 503-986-0900 (copy fees will apply).
- **Documentation which demonstrates compliance with permit conditions** (for example, well construction logs; static water level measurement reports; annual water use reports; ODFW fish screen certification; a plan to monitor the effect of water use on ground water aquifers utilized under the permit; etc.).

**Questions to complete this application for an Extension of Time**

Please see the instruction sheet to help you answer these questions.

**1. Beginning Construction within required deadlines.** OAR 690-315-0020(3)(d)

For Groundwater Permits

Has construction of the well begun?  Yes  No

Date construction began Month: \_\_\_\_\_ Day: \_\_\_\_\_ Year: \_\_\_\_\_

**Details of construction and attach documentation:** See previous extension application – attached. Well logs attached.

**RECEIVED**  
FEB 17 2016  
WATER RESOURCES DEPT  
SALEM, OREGON

**RECEIVED**  
FEB 16 2016  
WATER RESOURCES DEPT  
SALEM, OREGON

ODR 690-315-0020(3)(A)(e)(A)

2. Permits typically contain standard or special conditions that must be fully satisfied to lawfully develop and use permitted water. Review the permit subject to this extension to identify which of the conditions listed in the 2<sup>nd</sup> column are contained within it. Using the extra row labeled "other" to specify any other additional conditions specified in a final order approving a permit amendment or prior extension of time. In the 1<sup>st</sup> column check the box for each condition (row) identified as relevant. In the 3<sup>rd</sup> column check "Yes" if you have completed or met the permit condition. Check "No" if the condition is not yet satisfied. In the 4<sup>th</sup> column, give the date when the condition was satisfied or will be satisfied. Attach any pertinent documentation. Note: a pump test condition does not need to be addressed here however; you must submit the results of the test to the Department for approval prior to certification.

CHART-A

Permit Conditions in this Permit		Have Completed or Met?	Date satisfied/ or will be satisfied
Checkbox	Ground water Check those included on this permit		
<input checked="" type="checkbox"/>	Installation of a meter/totalizing flow meter	<input type="checkbox"/> Yes <input type="checkbox"/> No	2014
<input checked="" type="checkbox"/>	Submittal of annual water usage report	<input type="checkbox"/> Yes <input type="checkbox"/> No	2014
<input type="checkbox"/>	Submittal of initial static water level measurement	<input type="checkbox"/> Yes <input type="checkbox"/> No	N/A
<input type="checkbox"/>	Submittal of annual static water level measurements in the month required	<input type="checkbox"/> Yes <input type="checkbox"/> No	N/A
<input type="checkbox"/>	Submittal of Seven consecutive static water level measurements in the month required	<input type="checkbox"/> Yes <input type="checkbox"/> No	N/A
<input type="checkbox"/>	Special well construction standards	<input type="checkbox"/> Yes <input type="checkbox"/> No	N/A
<input type="checkbox"/>	Submittal of a monitoring plan	<input type="checkbox"/> Yes <input type="checkbox"/> No	N/A
<input type="checkbox"/>	Other (Specify):	<input type="checkbox"/> Yes <input type="checkbox"/> No	N/A
<input type="checkbox"/>	Other (Specify):	<input type="checkbox"/> Yes <input type="checkbox"/> No	N/A
<input type="checkbox"/>	Other (Specify):	<input type="checkbox"/> Yes <input type="checkbox"/> No	N/A
Surface Water or Reservoir			N/A
<input type="checkbox"/>	Installation of a meter/ totalizing flow meter/ in-line meter	<input type="checkbox"/> Yes <input type="checkbox"/> No	N/A
<input type="checkbox"/>	Installation a staff gauge	<input type="checkbox"/> Yes <input type="checkbox"/> No	N/A
<input type="checkbox"/>	Installation of a fish screen	<input type="checkbox"/> Yes <input type="checkbox"/> No	N/A
<input type="checkbox"/>	Installation of a fish by-pass device	<input type="checkbox"/> Yes <input type="checkbox"/> No	N/A
<input type="checkbox"/>	Installation of a fish passage	<input type="checkbox"/> Yes <input type="checkbox"/> No	N/A
<input type="checkbox"/>	Installation of an outlet gate/pipe/ conduit	<input type="checkbox"/> Yes <input type="checkbox"/> No	N/A
<input type="checkbox"/>	Submittal of a letter from ODFW that fish screen, fish by-pass device, and or fish passage is not required	<input type="checkbox"/> Yes <input type="checkbox"/> No	N/A
<input type="checkbox"/>	Submit as-built plans and specification	<input type="checkbox"/> Yes <input type="checkbox"/> No	N/A
<input type="checkbox"/>	Submittal of a letter from an engineer prior to storage	<input type="checkbox"/> Yes <input type="checkbox"/> No	N/A
<input type="checkbox"/>	Other (Specify):	<input type="checkbox"/> Yes <input type="checkbox"/> No	N/A
<input type="checkbox"/>	Other (Specify):	<input type="checkbox"/> Yes <input type="checkbox"/> No	N/A
<input type="checkbox"/>	Other (Specify):	<input type="checkbox"/> Yes <input type="checkbox"/> No	N/A



RECEIVED

FEB 17 2016

RECEIVED

FEB 16 2016

If you have NOT complied with Permit conditions, explain the reasons why and indicate a date certain, when you will be in compliance.

Permit Conditions have been met.

WATER RESOURCES DEPT  
SALEM, OREGON

WATER RESOURCES DEPT  
SALEM, OREGON

[OAR 690-315-0020(3)(e)]

3. Provide evidence of physical work made toward completion of the water system, and of progress made toward making beneficial use of water within the permitted time period (CHART-B); and if applicable, within the time period of the most recent extension granted (CHART-C). CHART-B (below) must be completed for all Application for Extension of Time requests. Use *chronological order*. (this does NOT include planning, formulating a business plan, securing financing, letting contracts, purchasing but not installing equipment, surveying, clearing land, or planting crops)

CHART-B

DATE	WORK ACCOMPLISHED BEFORE PERMIT WAS ISSUED <i>List any work done before the permit was issued – eg. well drilled.</i>	COST*
	See previous extension application and order (attached.)	
DATE	WORK ACCOMPLISHED AFTER PERMIT WAS ISSUED <i>and PRIOR TO DATE SPECIFIED IN PERMIT FOR COMPLETE APPLICATION OF WATER</i> <i>List work/actions done during the permitted time period.</i>	COST*
	Date the permit was signed - find date above signature on last page of permit.	
	See previous extension application and order (attached)	
	Date the permit specified complete application of water to the use shall be made- all permits contain this date.	
DATE	WORK ACCOMPLISHED AFTER the date the permit specified complete application of water <i>COMPLETE ONLY IF THIS IS YOUR 1st APPLICATION FOR AN EXTENSION OF TIME: List work done after the date specified in the permit for complete application of water up to the date of this Application for Extension of Time.</i>	COST*
	See previous extension application and order (attached)	
Total Cost for Chart-B		N/A

\* If exact cost is not known, you must provide your best estimate.

4. If this is not your 1st Application for Extension of Time request, fill out CHART-C below in addition to CHART-B above. Use *chronological order*.

**CHART-C**

DATE	<b>WORK ACCOMPLISHED DURING THE LAST EXTENSION PERIOD</b> <i>List all work done during the last authorized extension period.</i>	COST*
10-1-2014	"Extended From" date for complete application of water used in the 1 <sup>st</sup> (or the most recent) Application for Extension of Time.	
2013	Property purchased from foreclosure (Weaver Springs)	\$4.3M
6-2014	Remaining acreage put to use (55 acres)	\$126,500
5-2014	Purchased two pivots	\$75,000
10-2014	Contract farming costs	<del>\$51,000</del>
10-1-2014	"Extended To" date for complete application of water resulting from the 1 <sup>st</sup> (or the most recent) Application for Extension of Time.	
DATE	<b>WORK ACCOMPLISHED AFTER THE LAST EXTENSION PERIOD EXPIRED</b> <i>List all work done after the last authorized date for complete application of water up to the date of this Application for Extension of Time.</i>	COST*
1-2016	Preparation of extension application	<del>\$5,000</del>
6-2015	Drilled additional well; purchased pump, electricity, piping	\$125,000
2014-2016	Hired water rights consultant to help organize water rights records and prepare necessary applications for extensions, amendments, and claims.	<del>\$10,000</del>
<b>Total Cost of Chart-C</b>		<del>\$ 392,500</del>

\* If exact cost is not known, you must provide your best estimate. [OAR 690-315-0020(3)(f)]

326,500

5. **Cost of project to date: \$392,500 (Sunnyside's Expenses)**  
 (The total combined cost from CHART-B and CHART-C) [OAR 690-315-0020(f)]

**RECEIVED**  
 FEB 17 2016  
 WATER RESOURCES DEPT  
 SALEM, OREGON

**RECEIVED**  
 FEB 16 2016  
 WATER RESOURCES DEPT  
 SALEM, OREGON

[OAR 690-315-0020(3)(e)(B)]

**Provide evidence of the maximum rate (or duty, if applicable) of water diverted for beneficial use under this permit and/or prior extensions of time (if any) made to date.**

**RECEIVED**  
 FEB 17 2016  
 WATER RESOURCES DEPT  
 SALEM, OREGON

**TIP:** Report the rate used to date. Unless full beneficial use has been made, this rate will be less than the rate authorized on the permit.

**6. For Surface Water Permit Extensions (e.g. S-XXXX or R-XXXX): N/A**  
**TIP:** Report the rate in the same units of measurement as specified in the permit.

**7. For Ground Water Permit Extensions (e.g. G-12301):**  
**TIP:** Include information from ALL wells that pertain to this permit, including drilled wells not currently used.

**CHART-D**

Well # as identified on Permit	Water User's Well #	Has this well been drilled?	IF DRILLED					
			Well Log Number e.g. MORR 50473	Well Tag Number e.g. # 27566 or N/A	Is the actual drilled location authorized on this permit or on a permit amendment? (See 8 below)	Maximum instantaneous rate used to date from this well -- under <u>this permit</u> only (CFS or GPM)	Is this well authorized or utilized under any OTHER water rights?	If yes, provide the Permit, Certificate, or Transfer No.
1	2	Yes <input checked="" type="checkbox"/> No <input type="checkbox"/>	HARN 50149	L- 14600	Yes <input type="checkbox"/> No <input checked="" type="checkbox"/>	2.1 cfs approx..	Yes <input type="checkbox"/> No <input checked="" type="checkbox"/>	- -
	1	Yes <input checked="" type="checkbox"/> No <input type="checkbox"/>	HARN 50516	L- 41297	Yes <input type="checkbox"/> No <input type="checkbox"/>	x	Yes <input type="checkbox"/> No <input checked="" type="checkbox"/>	- -
	1	Yes <input checked="" type="checkbox"/> No <input type="checkbox"/>	HARN 51788	Deepening	Yes <input type="checkbox"/> No <input type="checkbox"/>	1.2 cfs approx..	Yes <input type="checkbox"/> No <input checked="" type="checkbox"/>	- -
Total instantaneous rate from all wells utilized under this permit						3.3 cfs		

**8. If the drilled location of a well is not authorized on this permit, please specify its location below, or provide a map showing its location.**

Has or will a Permit Amendment Application been/be filed? Yes  No

If a Permit Amendment Application has been filed: Transfer No. T- Permit Amendment will be filed as soon as extension is approved, to add points of appropriation, correctly identify the location of existing wells, and amend a portion of the place of use.

Well # 2 Actual location: NESE Section 2, T26S R30E  
 Well # 1 Actual location: NESW Section 2, T26S R30E

**RECEIVED**  
 FEB 16 2016  
 WATER RESOURCES DEPT  
 SALEM, OREGON

[OAR 690-315-0020(3)(e)(C)]

**9. Provide the total number of acres irrigated to date under this permit (if applicable). List by year, the number of acres irrigated each year since permit issuance, and provide a copy of the application map identifying the acres irrigated. 197.6 acres by 2005, and remaining 57.4 acres in mid 2014.**



Total acres irrigated to date: 255

**Ground Water Permits:** Please specify which wells are being utilized for this irrigation.

Well #1 Acres 255                      Well # \_\_\_\_\_ Acres \_\_\_\_\_

Well #2 Acres 255                      Well # \_\_\_\_\_ Acres \_\_\_\_\_

**RECEIVED**

FEB 17 2016

WATER RESOURCES DEPT  
SALEM, OREGON

[OAR 690-315-0020(3)(i)(j)]

**10. Provide a summary of your future plans and schedule to complete the construction of the water system, and/or apply water to full beneficial use under the terms and conditions of the permit.**

**CHART-E**

APPROXIMATE DATE RANGE (projected)	WORK OR ACTION TO BE ACCOMPLISHED (projected)	ESTIMATED COST (projected)
May 2016 or as soon as extension is approved	Need to file a permit amendment to show place of use changes, add wells to permit, and correctly identify location of existing wells.	<del>\$5,000</del>
May 2016 approx.	Install flowmeters on new well	\$10,000
March 2016	Static water level measurements on wells	<del>\$1,500</del>
December 2016	Water Use Reporting	
Year: 2020	Date intend to apply water to full beneficial use under the terms and conditions of this permit.	
<b>Total Cost</b>		<b>\$ 16,500</b>

[OAR 690-315-0020(3)(g)]

**11. Estimated remaining cost to complete the project: \$16,500**  
(The total cost from CHART-E)

**RECEIVED**

FEB 16 2016

WATER RESOURCES DEPT  
SALEM, OREGON

[OAR 690-315-0020(3)(h)]

**12. Describe the reasons why the construction was not completed, and/or water was not beneficially used within permit time limits. Provide supporting information for the reason(s) that best fits your circumstances. Include any additional unforeseen events and/or other governmental regulation or requirements.**

At the time of the filing of the previous extension (2011), the owner of the property was Gordon Bloomquist. In 2013 the property went in to foreclosure and was sold to Sunnyside Dairy LLC. The permit was assigned to the new owner and a farm manager was brought in. The former farm manager mishandled the application of resources and as a result delayed the development of the permitted acreage. When the remaining acreage was developed, the applicant was informed by OWRD that it was too late to file for a permit amendment to change the location of a portion of the acres, as well as to add additional POAs as the changes were made within six months of the October 2014 completion date. The applicant experienced some construction

problems in one of the existing wells and needed to replace one of the wells in order to put the water to full beneficial use under the terms and conditions of the permit.

[OAR 690-315-0020(3)(k)]

**13. Justify the time requested to complete the project and/or apply the water to full beneficial use.** Include any other information or evidence to establish that the requested amount of time is sufficient and that you will be able to complete the project within the amount of time requested.

The land to which this groundwater permit is appurtenant went through foreclosure in 2013. This land is part of a larger piece of property that has multiple water rights. The applicant purchased the property out of foreclosure and began the daunting process of assessing and cleaning up the property and the water rights. The applicant is currently working with the local watermaster (JR Johnson) to address WRD's concerns pertaining to the place of use and correct well locations. The 255 acres of this water right have been developed; however some of the acres and wells are not in the location originally proposed in the permit. Additionally, a portion of the remaining lands developed overlap another water right (Permit G-16421 – of which the applicant is also preparing a permit amendment to amend a portion of the place of use.) We are requesting this additional extension so that the applicant can file a permit amendment to address both the place of use and POA/APOA changes, and to apply water to beneficial use under the terms and conditions of the permit.

**RECEIVED**

FEB 17 2016

WATER RESOURCES DEPT  
SALEM, OREGON

**RECEIVED**

FEB 16 2016

WATER RESOURCES DEPT  
SALEM, OREGON

[OAR 690-315-0020(3)(m)(n)]

**14. Provide any other information you wish OWRD to consider while evaluating your Application for Extension of Time.**

The new landowner (permittee) has made significant financial investments in the development of this permit – which is part of a larger property project. Financial resources have been diverted to complete development of additional water rights on this property. Given the complexity of the multiple water rights associated with this large property, and the delays caused by purchasing a foreclosed property, replacing a farm manager, drought - circumstances beyond the control of the permit holder, an extension of time until 2020 is both reasonable and necessary to apply water to beneficial use under the terms and conditions of the permit.

**RECEIVED**

FEB 17 2016

WATER RESOURCES DEPT  
SALEM, OREGON

**RECEIVED**

FEB 16 2016

WATER RESOURCES DEPT  
SALEM, OREGON

Attachment #1  
Map of Water Use Development of G-12301  
Permit Extension Application for Sunnyside Dairy G-12301

---



RECEIVED

FEB 17 2016

WATER RESOURCES DEPT  
SALEM, OREGON

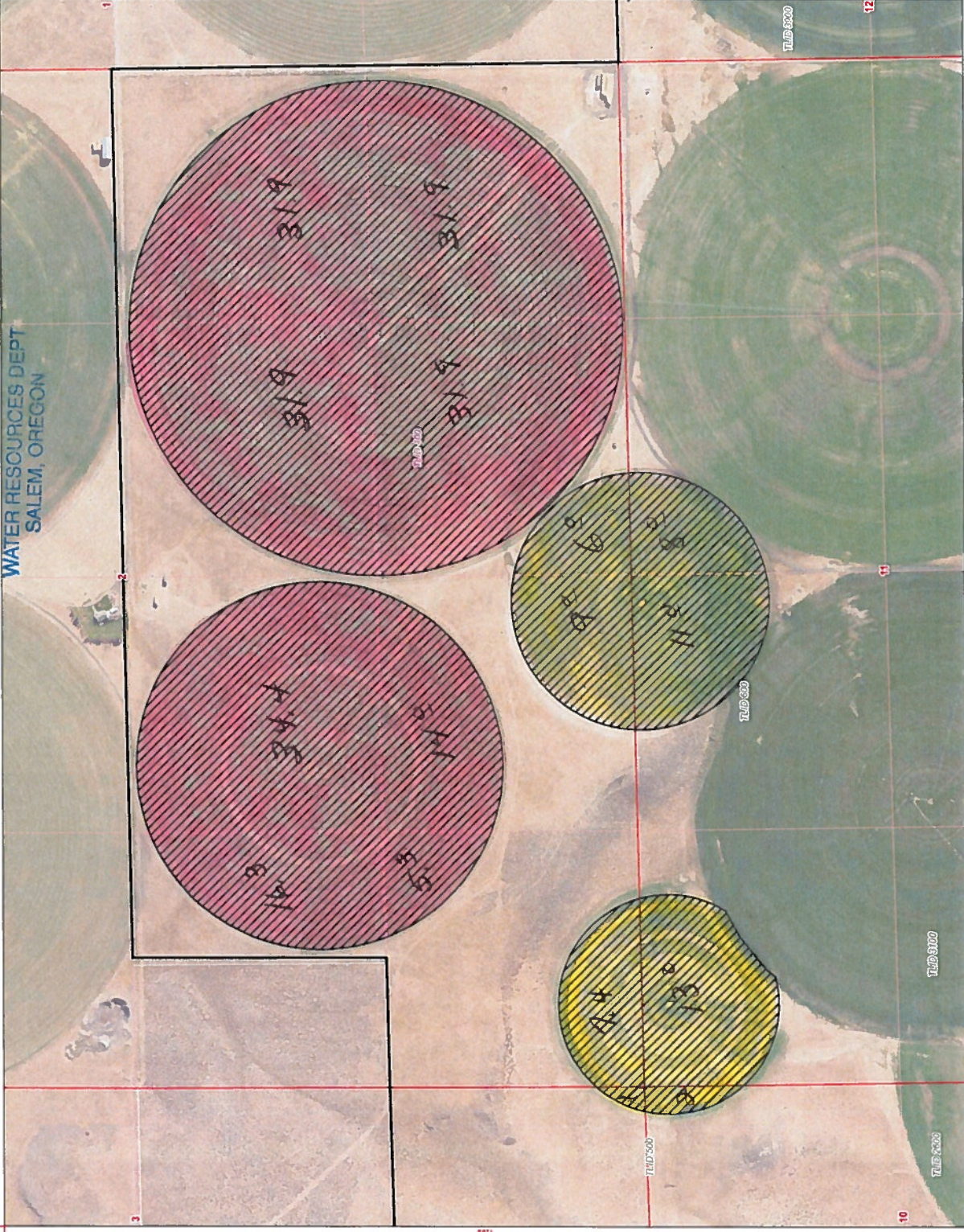

**FIGURE 1**

**Weaver Springs Water Right**

Application G-12559, Permit G-12301  
Sunny Side Dairy, Harney County, Oregon  
Township 26 South, Range 30 East

**LEGEND**

- Place of Use, G-12301
- All Other Features
- Weaver Springs Property
- Tax Lot
- Road

*developed  
by previous extension  
10/2005*

*developed  
in mid 2014*

**RECEIVED**

FEB 16 2016

WATER RESOURCES DEPT  
SALEM, OREGON



**MAP NOTES:**  
Map Date: 2/16/2016  
Data Source: USGS, ONWR, ESRI, Air Photo  
From MAP: 2014



**RECEIVED**

FEB 17 2016

WATER RESOURCES DEPT  
SALEM, OREGON

**RECEIVED**

FEB 16 2016

WATER RESOURCES DEPT  
SALEM, OREGON

Attachment #2  
Permit G-12301 and Permit Map  
Permit Extension Application for Sunnyside Dairy G-12301

---

STATE OF OREGON

COUNTY OF HARNEY

PERMIT TO APPROPRIATE THE PUBLIC WATERS

THIS PERMIT IS HEREBY ISSUED TO

JOE ECKLEY  
HC 71 BOX 441  
BURNS, OREGON 97720

(541) 493-2560

The specific limits for the use are listed below along with conditions of use.

APPLICATION FILE NUMBER: G-12559

SOURCE OF WATER: A WELL WITHIN MALHEUR LAKE BASIN

PURPOSE OR USE: IRRIGATION OF 255.0 ACRES

Rate of use: 3.19 CUBIC FEET PER SECOND

PERIOD OF ALLOWED USE: WATER MAY BE APPROPRIATED FOR IRRIGATION FROM MARCH 1 THROUGH OCTOBER 31

DATE OF PRIORITY: JUNE 7, 1991

POINT OF DIVERSION LOCATION: NW 1/4 SW 1/4, SECTION 1, T26S, R30E, W.M.; 260 FEET SOUTH AND 40 FEET EAST FROM THE W 1/4 CORNER OF SECTION 1

The amount of water used for irrigation under this right, together with the amount secured under any other right existing for the same lands, is limited to a diversion of ONE-EIGHTIETH of one cubic foot per second (or its equivalent) and 3.0 acre-feet for each acre irrigated during the irrigation season of each year.

THE PLACE OF USE IS LOCATED AS FOLLOWS:

NE 1/4 SW 1/4	40.0 ACRES
NW 1/4 SW 1/4	20.0 ACRES
SE 1/4 SW 1/4	35.0 ACRES
NE 1/4 SE 1/4	40.0 ACRES
NW 1/4 SE 1/4	40.0 ACRES
SW 1/4 SE 1/4	40.0 ACRES
SE 1/4 SE 1/4	40.0 ACRES

SECTION 2

TOWNSHIP 26 SOUTH, RANGE 30 EAST, W.M.

**RECEIVED**  
FEB 17 2016

WATER RESOURCES DEPT  
SALEM, OREGON

**RECEIVED**

FEB 16 2016

WATER RESOURCES DEPT  
SALEM, OREGON

RECEIVED

RECEIVED

FEB 16 2016

FEB 17 2016

WATER RESOURCES DEPT  
SALEM, OREGON

WATER RESOURCES DEPT  
SALEM, OREGON PAGE 2

Measurement, recording and reporting conditions:

- A. Before water use may begin under this permit, the permittee shall install a meter or other suitable measuring device as approved by the Director. The permittee shall maintain the meter or measuring device in good working order, shall keep a complete record of the amount of water used each month and shall submit a report which includes the recorded water use measurements to the Department annually or more frequently as may be required by the Director. Further, the Director may require the permittee to report general water use information, including the place and nature of use of water under the permit.
- B. The permittee shall allow the watermaster access to the meter or measuring device; provided however, where the meter or measuring device is located within a private structure, the watermaster shall request access upon reasonable notice.

#### STANDARD CONDITIONS

The wells shall be constructed in accordance with the General Standards for the Construction and Maintenance of Water Wells in Oregon. The works shall be equipped with a usable access port, and may also include an air line and pressure gauge adequate to determine water level elevation in the well at all times.

The use shall conform to such reasonable rotation system as may be ordered by the proper state officer.

Prior to receiving a certificate of water right, the permit holder shall submit the results of a pump test meeting the department's standards, to the Water Resources Department. The Director may require water level or pump test results every ten years thereafter.

Failure to comply with any of the provisions of this permit may result in action including, but not limited to, restrictions on the use, civil penalties, or cancellation of the permit.

This permit is for the beneficial use of water without waste. The water user is advised that new regulations may require the use of best practical technologies or conservation practices to achieve this end.

By law, the land use associated with this water use must be in compliance with statewide land-use goals and any local acknowledged land-use plan.

The use of water shall be limited when it interferes with any prior surface or ground water rights.

The Director finds that the proposed use(s) of water described by this permit, as conditioned, will not impair or be detrimental to the public interest.

Actual construction of the well shall begin within one year from permit issuance, and shall be completed on or before October 1, 1998. Complete application of the water to the use shall be made on or before October 1, 1999.

Issued February 29, 1996

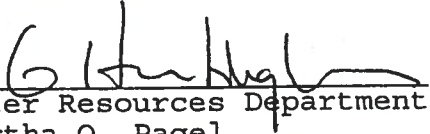
  
Water Resources Department  
Martha O. Pagel  
Director

B - ext. to 10/1/05

C - ext. to 10/1/05

**RECEIVED**  
FEB 17 2016  
WATER RESOURCES DEPT  
SALEM, OREGON

**RECEIVED**  
FEB 16 2016  
WATER RESOURCES DEPT  
SALEM, OREGON

Application G-12559  
Basin 12

Water Resources Department  
Volume 1 Basin 12 & Misc.

PERMIT G-12301  
District 10



Application No. G-12559  
 Permit No. G12301

T 26 S north of Malheur Lake,  
 R 30 E, WM

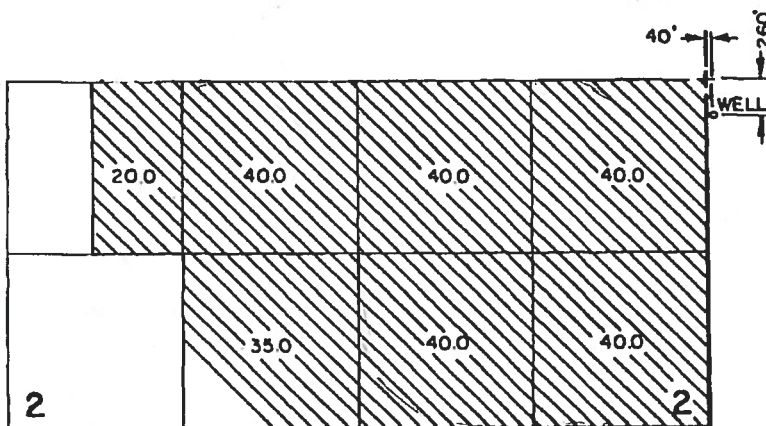

RECEIVED

FEB 17 2016

WATER RESOURCES DEPT  
 SALEM, OREGON

THE PURPOSE OF THIS MAP IS TO  
 IDENTIFY THE LOCATION OF THE  
 WATER RIGHT. IT IS NOT INTENDED  
 TO PROVIDE INFORMATION RELATIVE  
 TO THE LOCATION OF PROPERTY  
 OWNERSHIP

RECEIVED

FEB 16 2016

WATER RESOURCES DEPT  
 SALEM, OREGON

	JOE ECKLEY		BURNS, OR
	WATER RIGHT APPLICATION MAP		
	Scale: 4 $\frac{1}{2}$ I MILE	Date: MAY 1991	Job: 1277
	Dsn: Drn: CTP Ckd:	M. A. PALMER & SONS, INC. ENGINEERING & SURVEYING 254 N. Alder - Box 61 Burns, Oregon 97720	Sht. No. 1
	of 1		

**RECEIVED**

FEB 17 2016

WATER RESOURCES DEPT  
SALEM, OREGON

**RECEIVED**

FEB 16 2016

WATER RESOURCES DEPT  
SALEM, OREGON

Attachment #3  
Previous Extension Application and Final Order  
Permit Extension Application for Sunnyside Dairy G-12301

---

Oregon Water Resources Department  
Water Right Services Division

RECEIVED

FEB 16 2016

Water Rights Application  
Number G-12559

WATER RESOURCES DEPT  
SALEM, OREGON

**Final Order**  
**Extension of Time for Permit Number G-12301**  
**Permit Holder: Gordon Bloomquist**

Appeal Rights

This is a final order in other than a contested case. This order is subject to judicial review under ORS 183.484. A request for judicial review must be filed within the 60 day time period specified by ORS 183.484(2). Pursuant to ORS 536.075 and OAR 137-004-0080 you may either file for judicial review, or petition the Director for reconsideration of this order. A petition for reconsideration may be granted or denied by the Director, and if no action is taken within 60 days following the date the petition was filed, the petition shall be deemed denied.

Application History

Permit G-12301 was issued by the Department on February 29, 1996. The permit called for completion of construction By October 1, 1998 and complete application of water to beneficial use by October 1, 1999. One prior permit extension has been granted for Permit G-12301. The most recent extension resulted in the full application of water being extended to October 1, 2005. On February 29, 2011, Gordon Bloomquist submitted to the Department an Application for Extension of Time for Permit G-12301. In accordance with OAR 690-315-0050(2), on August 30, 2011, the Department issued a Proposed Final Order proposing to extend the time to complete construction to October 1, 2014, and the time to apply water to full beneficial use to October 1, 2014. The protest period closed October 14, 2011, in accordance with OAR 690-315-0060(1). No protest was filed.

The Department adopts and incorporates by reference the Proposed Final Order dated August 30, 2011.

At time of issuance of the Proposed Final Order the Department concluded that, based on the factors demonstrated by the applicant, the permit may be extended subject to no additional conditions.

The applicant has demonstrated good cause for the permit extension pursuant to ORS 537.230, 539.010(5) and OAR 690-315-0040(2).

RECEIVED

FEB 17 2016

WATER RESOURCES DEPT  
SALEM, OREGON

Order

The extension of time for Application G-12559, Permit G-12301, therefore, is approved. The deadline for completing construction is extended from October 1, 2005 to October 1, 2014. The deadline for applying water to full beneficial use within the terms and conditions of the permit is extended from October 1, 2005 to October 1, 2014.

DATED: January 6, 2012

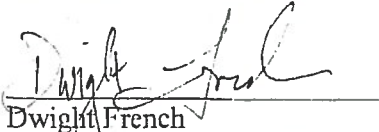

Dwight French  
Water Rights Services Division Administrator, for  
PHILLIP C. WARD, DIRECTOR

**RECEIVED**  
FEB 17 2016  
WATER RESOURCES DEPT  
SALEM, OREGON

**RECEIVED**

FEB 16 2016

WATER RESOURCES DEPT  
SALEM, OREGON

- 
- If you have any questions about statements contained in this document, please contact Jerry Gainey at (503) 986-0812.
  - If you have other questions about the Department or any of its programs, please contact our Water Resources Customer Service Group at (503) 986-0900
-



RECEIVED

FEB 16 2016

WATER RESOURCES DEPT  
SALEM, OREGON



Oregon Water Resources Department  
725 Summer Street NE, Suite A  
Salem Oregon 97301  
(503) 986-0900  
www.wrd.state.or.us

# Application for Extension of Time for a Water Right Permit (Non-Municipal / Non-Quasi-municipal Water Use)

TO THE DIRECTOR OF THE OREGON WATER RESOURCES DEPARTMENT

A separate extension application must be submitted for each permit as per  
OAR 690-315-0020(2).

This application and a summary of review criteria and procedures that are generally applicable to this  
application are available at <http://www.wrd.state.or.us/OWRD/PUBS/forms.shtml>.

RECEIVED

FEB 17 2011

I, Gordon Bloomquist  
NAME OF PERMIT HOLDER [OAR 690-315-0020(1) and (3)(a)]

WATER RESOURCES DEPT  
SALEM, OREGON

30042 Weaver Springs LN Burns STATE OR ZIP 97720  
ADDRESS CITY STATE ZIP

541-495-2445  
PHONE

E-MAIL ADDRESS  
APP # G-12559

the permit holder of: Application Number G-12066 PERMIT # G-12301

Permit Number G-12301 ~~G-12129~~  
[OAR 690-315-0020(3)(b)]

RECEIVED

DEC 29 2009

WATER RESOURCES DEPT  
SALEM, OREGON

do hereby request that the time in which to:

complete construction (of diversion/appropriation works and/or purchase and installation of the  
equipment necessary to the use of water), which time now expires on October 1, 2005, be  
extended to October 1, 2014.

N/A (Check this box if the permit does not specify a date by when construction must be completed.)

and/or the time in which to:

apply water to full beneficial use under the terms and conditions of the permit, which time now  
expires on October 1, 1, be extended to October 1, 2014

AB. 2-14-2011

RECEIVED

Before submitting your Application for Extension of Time, make sure the following items are included:

- This completed Application for Extension of Time.
- Statutory fee of \$500.
- Signature page (last page of this Application for Extension of Time).
- All supporting documentation and/or evidence referenced in the Application for Extension of Time.

RECEIVED  
FEB 17 2016

WATER RESOURCES DEPT  
SALEM, OREGON

### MAIL COMPLETED APPLICATION

along with the

\$500 STATUTORY FEE TO:

Water Resources Department  
Attn: Water Right Permit Extensions  
725 Summer Street NE, Suite A  
Salem, Oregon 97301

RECEIVED

FEB 22 2010

WATER RESOURCES DEPT  
SALEM, OREGON

RECEIVED

DEC 29 2009

FEB 17 2011

WATER RESOURCES DEPT  
SALEM, OREGON

WATER RESOURCES DEPT  
SALEM, OREGON

RECEIVED

FEB 16 2016

WATER RESOURCES DEPT  
SALEM, OREGON



#### GENERAL TIPS:

- Permit holders of municipal or quasi-municipal water use permits **DO NOT** use this form. The correct form is *Application for Extension of Time for Municipal and Quasi-Municipal Water Use Permits*, available at the following link:  
<http://www.wrd.state.or.us/OWRD/PUBS/forms.shtml#other>
- Request the reasonable amount of time necessary to fully complete the water construction project and/or to fully use the permitted quantity of water under the terms and conditions of your permit. Should this request be approved, it will be OWRD's expectation that you will complete your project within the new time period allowed. Future extensions may not be granted.
- A separate Application for Extension of Time must be submitted for each permit. OAR 690-315-0020(2).
- An instruction sheet (Instructions for Filling Out Extension of Time Application for Permits) provides details that will help you answer each question on the application. Permit extensions are evaluated under OAR Chapter 690, Division 315. These rules may be viewed at:  
<http://www.wrd.state.or.us/OWRD/LAW/index.shtml>.

RECEIVED

FEB 17 2016

WATER RESOURCES DEPT  
SALEM, OREGON

- You may provide OWRD with any additional information or evidence that will aid us in making our decision. Please note that OWRD may require other information that is necessary to evaluate the application. OAR 315-0020(3)(n).
- After careful review of the Application for Extension of Time, you may contact OWRD at (503) 986-0900, to ask questions and request assistance from a Permit Extensions Specialist in the Water Rights and Adjudications Division.
- Once an Application for Extension of Time is received by OWRD, it will be reviewed for completeness. OWRD will return any incomplete or deficient applications to the applicant. OAR 690-315-0040(1)(a).

**Reference Materials Needed to Complete this Application:**

- The water right permit. If needed, a copy of the water right permit can be downloaded from the Department's Website at <http://www.wrd.state.or.us> (find the link to the Water Rights Information System (WRIS). Or, a copy of the permit (or other documents) may be requested by water right application number from the Water Rights Division at 503-986-0900 (copy fees will apply).
- Documentation which demonstrates compliance with permit conditions (for example, well construction logs; static water level measurement reports; annual water use reports; ODFW fish screen certification; a plan to monitor the effect of water use on ground water aquifers utilized under the permit; etc.).

**Answer the Following Questions to Complete this Application for Extension of Time**

[OAR 690-315-0020(3)(d)]

1. Did the actual construction of the water system/well drilling begin within the time specified in the permit?  Yes  No



**TIP:** Not all permits specify a date by which construction was to begin.

Date construction began is: 1991

Details of construction: Pivot + main line installed

RECEIVED

FEB 22 2010

WATER RESOURCES DEPT  
SALEM, OREGON

RECEIVED

FEB 16 2016

WATER RESOURCES DEPT  
SALEM, OREGON

RECEIVED

FEB 17 2011

WATER RESOURCES DEPT  
SALEM, OREGON

RECEIVED

DEC 29 2009

WATER RESOURCES DEPT  
SALEM, OREGON





RECEIVED

FEB 16 2016

RECEIVED

FEB 17 2016

WATER RESOURCES DEPT  
SALEM, OREGON

WATER RESOURCES DEPT  
SALEM, OREGON

- 3. Provide evidence of physical progress made toward completion of the water system, and of progress made toward making beneficial use of water within the permitted time period (CHART-C); and if applicable, within the time period of the most recent extension granted (CHART-D).

3-A) CHART-C (below) must be completed for all Application for Extension of Time requests. Use chronological order.

CHART-C

DATE	WORK ACCOMPLISHED BEFORE PERMIT WAS ISSUED <i>List any work done before the permit was issued, e.g., well drilled.</i>	COST
1980	WELL DRILLED	

DATE	WORK ACCOMPLISHED AFTER PERMIT WAS ISSUED <i>Amount of work specified in permit for complete application of water.</i>	COST
------	---	------

1991	Date the permit was signed - find date above signature on last page of permit. PIVOTS INSTALLED	100,000
------	--	---------

1996	Date the permit specified "Actual Construction Work" shall begin ("A-Date") - not all permits contain this date.	
------	--	--

RECEIVED

DEC 29 2009

10/1/2000	Date the permit specified complete application of water to the use shall be made ("C-Date") - all permits contain this date.	
-----------	--	--

WATER RESOURCES DEPT  
SALEM, OREGON

CHART-C (continued)

DATE	WORK ACCOMPLISHED AFTER "C-DATE" <i>Completion of the system or application for extension of time. This work done after the permit for complete application of water up to the date of this application for extension of time.</i>	COST
------	---	------

1997	WELL DRILLED - PIPE + WIRE RECEIVED	35,000
------	-------------------------------------	--------

WATER RESOURCES DEPT  
SALEM, OREGON

RECEIVED

Total Cost for Chart-C		
------------------------	--	--

FEB 22 2010

\* If exact cost is not known, you must provide your best estimate.

WATER RESOURCES DEPT  
SALEM, OREGON

WATER RESOURCES DEPT  
SALEM, OREGON

3-B) If this is not your 1st Application for Extension of Time request, fill out CHART-D below (in addition to CHART-C above). Use chronological order.

**CHART-D**

DATE	WORK ACCOMPLISHED DURING THE LAST EXTENSION PERIOD <i>(list all work done during the last authorized extension period)</i>	COST
10/1/99	"Extended From" date for complete application of water used in the 1 <sup>st</sup> (or the most recent) Application for Extension of Time.	
2000	New Well Drilled	30,000.00
10/1/2005	"Extended To" date for complete application of water resulting from the 1 <sup>st</sup> (or the most recent) Application for Extension of Time.	

**CHART-D (Continued)**

DATE	WORK ACCOMPLISHED AFTER THE LAST EXTENSION PERIOD EXPIRED <i>(list all work done after the last authorized date for complete application of water up to the date of this application for extension of time)</i>	COST
2009	New Well, Pipe, + wire	47,000.00

RECEIVED

RECEIVED

RECEIVED

WATER RESOURCES DEPT  
SALEM, OREGON

WATER RESOURCES DEPT  
SALEM, OREGON

WATER RESOURCES DEPT  
SALEM, OREGON

Total Cost of Chart-D

\* If exact cost is not known, you must provide your best estimate.

[OAR 690-315-0020(3)(f)]

4. Cost of project to date: ~~\$177,000.00~~ \$212,000  
 (The total combined cost from CHART-C and CHART-D)

B 2-14-2011

[OAR 690-315-0020(3)(e)(B)]

RECEIVED

FEB 16 2016

6. Provide the total number of acres irrigated to date under this permit (if applicable).

Total acres irrigated to date: 197.6

WATER RESOURCES DEPT  
SALEM, OREGON

Ground Water Permits: Please specify which wells are being utilized for this irrigation.

Well # 41297 Acres 197.6 Well # \_\_\_\_\_ Acres \_\_\_\_\_

Well # 81445 Acres 197.6 Well # \_\_\_\_\_ Acres \_\_\_\_\_

RECEIVED

DEC 29 2009

WATER RESOURCES DEPT  
[OAR 690-315-0020(3)(g)]  
SALEM, OREGON

7. Provide a summary of your future plans and schedule to complete the construction of the water system, and/or apply water to full beneficial use under the terms and conditions of the permit.

CHART-F

APPROXIMATE DATE RANGE (Optional)	WORK OR ACTION TO BE ACCOMPLISHED (Optional)	ESTIMATED COST (Optional)
2013	Install Flow meters	1800.00
	Conduct pump test	RECEIVED
		FEB 22 2010
2013	Final Proof Survey	1000.00
		WATER RESOURCES DEPT SALEM, OREGON
Year:	Date intend to apply water to full beneficial use under the terms and conditions of this permit.	
Total Cost:		2800.00

[OAR 690-315-0020(3)(g)]

8. Estimated remaining cost to complete the project: 2800.00  
(The total cost from CHART-F)

[OAR 690-315-0020(3)(h)]

9. List the reasons why the project was not constructed, and/or water was not beneficially used within permit time limits. Provide supporting information for the reason(s) that best fits your circumstances (A, B, C or D). Ranch split between 2 owners then resold during permit time.

9-A) The project is of a size and scope that was originally planned to be phased in over a time frame longer than the one allowed in the permit.

CBU Denial letter did not come was not sent until April of 2008!

RECEIVED

FEB 17 2011

WATER RESOURCES DEPT  
SALEM, OREGON

RECEIVED

FEB 17 2013

WATER RESOURCES DEPT  
SALEM, OREGON



5. Provide evidence of the maximum rate (or duty, if applicable) of water diverted for beneficial use under this permit and/or prior extensions of time (if any) made to date.



**TIP:** Report the rate used to date. Unless full beneficial use has been made, this rate will be less than the rate authorized on the permit.

5-A) For Surface Water Permit Extensions (e.g. S-XXXX or R-XXXX):



**TIP:** Report the rate in the same units of measurement as specified in the permit.

Maximum rate used to date = \_\_\_\_\_ cfs (cubic feet per second) or,

Maximum rate used to date = \_\_\_\_\_ gpm (gallons per minute) or,

Acre-feet stored to date = \_\_\_\_\_ AF

5-B) For Ground Water Permit Extensions (e.g. G-XXXX):



**TIP:** Include information from ALL wells that pertain to this permit, including drilled wells not currently used.

RECEIVED

FEB 17 2010

WATER RESOURCES DEPT  
SALEM, OREGON

RECEIVED

DEC 29 2009

WATER RESOURCES DEPT  
SALEM, OREGON

RECEIVED

**CHART-E**

Well ID	Well Type	Well Status	Well Location	Well Depth	Well Construction	Well Completion	Well Production	Well Discharge
		Yes <input checked="" type="checkbox"/> No <input type="checkbox"/>	HAEN 1316	NA	Yes <input checked="" type="checkbox"/> No <input type="checkbox"/>	3.19 CFS	Yes <input checked="" type="checkbox"/> No <input type="checkbox"/>	6-8979
		Yes <input checked="" type="checkbox"/> No <input type="checkbox"/>		41297	Yes <input type="checkbox"/> No <input checked="" type="checkbox"/>	3.19 CFS	Yes <input type="checkbox"/> No <input checked="" type="checkbox"/>	-
		Yes <input checked="" type="checkbox"/> No <input type="checkbox"/>		81445	Yes <input type="checkbox"/> No <input checked="" type="checkbox"/>	3.19 CFS	Yes <input type="checkbox"/> No <input checked="" type="checkbox"/>	-
		Yes <input type="checkbox"/> No <input type="checkbox"/>			Yes <input type="checkbox"/> No <input type="checkbox"/>		Yes <input type="checkbox"/> No <input type="checkbox"/>	-
Total instantaneous rate from all wells utilized under this permit						3.19 CFS		

FEB 22 2010

WATER RESOURCES DEPT  
SALEM, OREGON

RECEIVED

FEB 17 2011

WATER RESOURCES DEPT  
SALEM, OREGON

5-C) If the drilled location of a well is not authorized on this permit, please specify its location below, or provide a map showing its location. Has or will a permit amendment application been/be filed? Yes  No

If a Permit Amendment Application has been filed: Transfer No. T-\_\_\_\_\_

Well # 41297: Actual location: 26 30 Sec 2 NESW

Well # 81445: Actual location: 26 30 Sec 2 SE SE

[OAR 690-315-0020(3)(e)(C)]

RECEIVED

FEB 16 2016

WATER RESOURCES DEPT  
SALEM, OREGON

9-B) The financial resources needed to develop the project precluded completion of the project within authorized time frames.

NA

9-C) Good faith attempts to comply with permit conditions and/or acquire permits from other agencies, or otherwise comply with government regulations, delayed completion of the project.

yes

RECEIVED

FEB 16 2016

WATER RESOURCES DEPT  
SALEM, OREGON

9-D) Acts of God or other unforeseen events delayed full development of the water system and use of water within the authorized time frames.

NO

[OAR 690-315-0020(3)(k)]

10. Justify the time requested to complete the project and/or apply the water to full beneficial use. Your justification should combine information from your answers from Questions 2-B, 7, 8, and 9 of this Application for Extension of Time, and should also include any other information or evidence to establish that the requested amount of time is sufficient and that you will be able to complete the project within the amount of time requested.

5 years is requested due to the fact that we want ample time to prove up on new P.A.

11. Provide any other information you wish OWRD to consider while evaluating your Extension of Time Application.

Ranch has changed hands 3 times in last 2 years and I am still ~~wondering~~ learning about all mistakes on water

RECEIVED

FEB 17 2016

WATER RESOURCES DEPT  
SALEM, OREGON

I am the permit holder, or have authorization from the permit holder, to apply for an extension of time under this permit. I understand that false or misleading statements in this extension application are grounds for OWRD to suspend processing of the request and/or reason to deny the extension.

RECEIVED

FEB 17 2011

Signature *Derek Blazynski* WATER RESOURCES DEPT - 18 - 2009 Date  
SALEM, OREGON

RECEIVED

FEB 22 2010

WATER RESOURCES DEPT  
SALEM, OREGON

RECEIVED

DEC 29 2009

WATER RESOURCES DEPT  
SALEM, OREGON



**RECEIVED**

FEB 17 2016

WATER RESOURCES DEPT  
SALEM, OREGON

**RECEIVED**

FEB 16 2016

WATER RESOURCES DEPT  
SALEM, OREGON

Attachment #4

Well Logs

Permit Extension Application for Sunnyside Dairy G-12301

RECEIVED

WELL ID# L14600

harn 50149

APR - 9 1997

STATE OF OREGON WATER SUPPLY WELL REPORT

(START CARD) # 85985

Instructions for completing this report are on the last page of this form WATER RESOURCES DEPT.

(1) OWNER: Well Number 2 Name Joseph R. Eckley Address HC 71 Box 441 City Burns State OR Zip 97720

(9) LOCATION OF WELL by legal description: County Harney Latitude Longitude Township 26 or S Range 30 E or WM. Section 2 NE 1/4 SE 1/4 Tax Lot 400 Lot Block Subdivision Street Address of Well (or nearest address) HC 71 Box 441 Burns OR.

(2) TYPE OF WORK: [X] New Well [ ] Deepening [ ] Alteration (repair/recondition) [ ] Abandonment (3) DRILL METHOD: [ ] Rotary Air [ ] Rotary Mud [X] Cable [ ] Auger [ ] Other

(10) STATIC WATER LEVEL: 89 1/2 ft. below land surface. Date 3-24-97 Artesian pressure lb. per square inch. Date

(4) PROPOSED USE: [ ] Domestic [ ] Community [ ] Industrial [X] Irrigation [ ] Thermal [ ] Injection [ ] Livestock [ ] Other

(11) WATER BEARING ZONES: Depth at which water was first found 40'

(5) BORE HOLE CONSTRUCTION: Special Construction approval [ ] Yes [X] No Depth of Completed Well 110 ft. Explosives used [ ] Yes [X] No Type Amount

Table with 4 columns: From, To, Estimated Flow Rate, SWL. Data rows: 40' to 70' (1000 gpm, 38'), 85' to 105' (400 gpm, 45')

HOLE SEAL table with columns: Diameter, From, To, Material, From, To, Sacks or pounds. Data rows: 20" 0 22' Bentonite 0 22' 10 sacks; 12" 22 120' none

(12) WELL LOG: Ground Elevation

How was seal placed: Method [ ] A [ ] B [ ] C [ ] D [ ] E Backfill placed from ft. to ft. Material Gravel placed from ft. to ft. Size of gravel

WELL LOG table with columns: Material, From, To, SWL. Data rows: Sandy loam Topsoil (0' to 4'), Sandy loam & clay mix (4' to 12'), Red cinders & clay mix (12' to 21'), Pumice layers & Red cinders (21' to 40'), Pumice layers & Black cinders (40' to 70', 38'), Black cinders & Black sand (70' to 75', 38'), Hard Black Basalt (75' to 80'), Blue Clay (80' to 85', 45'), Black cinders - coarse (80' to 105', 45'), Black Sand (105' to 120', 45')

(6) CASING/LINER: Table with columns: Diameter, From, To, Gauge, Steel, Plastic, Welded, Threaded. Casing: 12" 0' 77' .025 [X] [ ] [X] [ ] Liner: [ ] [ ] [ ] [ ]

RECEIVED FEB 16 2016 WATER RESOURCES DEPT SALEM, OREGON RECEIVED FEB 17 2016 WATER RESOURCES DEPT SALEM, OREGON

(7) PERFORATIONS/SCREENS: [X] Perforations Method mill knife [ ] Screens Type Material From 40' To 77' Slot size 1/4" Number 296 Diameter 12" Tele/pipe size 12" Casing [X] Liner [ ]

Date started 2-27-97 Completed 3-29-97 (unbonded) Water Well Constructor Certification:

(8) WELL TESTS: Minimum testing time is 1 hour. [X] Pump [ ] Bailer [ ] Air [ ] Flowing Artesian. Yield gal/min 1300 1300 1300 Drawdown 16' 16' 16' Drill stem at Time 1 hr. 2 hr. 5 hr.

I certify that the work I performed on the construction, alteration, or abandonment of this well is in compliance with Oregon water supply well construction standards. Materials used and information reported above are true to the best of my knowledge and belief.

Temperature of water 54° Depth Artesian Flow Found NO Was a water analysis done? [ ] Yes By whom NO Did any strata contain water not suitable for intended use? NO [ ] Too little [ ] Salty [ ] Muddy [ ] Odor [ ] Colored [ ] Other Depth of strata:

Signed Joseph R. Eckley WWC Number Date 4-7-97

(bonded) Water Well Constructor Certification: I accept responsibility for the construction, alteration, or abandonment work performed on this well during the construction dates reported above. All work performed during this time is in compliance with Oregon water supply well construction standards. Materials used and information reported above are true to the best of my knowledge and belief.

Signed Joseph R. Eckley WWC Number Date 4-7-97

STATE OF OREGON  
WATER SUPPLY WELL REPORT  
(as required by ORS 537.765)

HARN  
50516

WELL I.D.# 41297

(START CARD) # 102213

Instructions for completing this report are on the last page of this form.

RECEIVED  
FEB 17 2016

WATER RESOURCES DEPT  
SALEM, OREGON

(1) OWNER: Well Number #3  
Name Joseph RECKLEY  
Address HC 71, Box 491  
City Burns State OR Zip 97720

(2) TYPE OF WORK  
 New Well  Deepening  Alteration (repair/recondition)  Abandonment

(3) DRILL METHOD:  
 Rotary Air  Rotary Mud  Cable  Auger  
 Other

(4) PROPOSED USE:  
 Domestic  Community  Industrial  Irrigation  
 Thermal  Injection  Livestock  Other

(5) BORE HOLE CONSTRUCTION:  
Special Construction approval  Yes  No Depth of Completed Well 97 ft.  
Explosives used  Yes  No Type Amount

HOLE			SEAL			
Diameter	From	To	Material	From	To	Sacks or pounds
20"	0'	4'	Bentonite	0	20'	22-50*sacks
16"	4'	20'				

How was seal placed: Method  A  B  C  D  E  
 Other  
Backfill placed from \_\_\_ ft. to \_\_\_ ft. Material Bentonite  
Gravel placed from \_\_\_ ft. to \_\_\_ ft. Size of gravel

(6) CASING/LINER:

Diameter	From	To	Gauge	Steel	Plastic	Welded	Threaded
Casing: 12"	0'	76'	2.50	<input checked="" type="checkbox"/>	<input type="checkbox"/>	<input checked="" type="checkbox"/>	<input type="checkbox"/>
Liner:				<input type="checkbox"/>	<input type="checkbox"/>	<input type="checkbox"/>	<input type="checkbox"/>

(7) PERFORATIONS/SCREENS:

From	To	Stral size	Number	Diameter	Material	Tolo/pipe size	Casing	Liner
							<input type="checkbox"/>	<input type="checkbox"/>

(8) WELL TESTS: Minimum testing time is 1 hour

Pump  Bailer  Air  Flowing Artesian

Yield gal/min	Drawdown	Drill stem at	Time
50	0		1 hr.

Temperature of water 52° Depth Artesian Flow Found NA  
Was a water analysis done?  Yes By whom NO  
Did any strata contain water not suitable for intended use?  Too little  
 Salty  Muddy  Odor  Colored  Other None  
Depth of strata: None

(9) LOCATION OF WELL by legal description:  
County Harney Latitude Longitude  
Township 26 N or S Range 30 E or W W.M.  
Section 2 NE 1/4 SW 1/4  
Tax Lot 400 Lot Block Subdivision  
Street Address of Well (or nearest address)

(10) STATIC WATER LEVEL:  
66' ft. below land surface. Date 2/2/2000  
Artesian pressure lb. per square inch. Date

(11) WATER BEARING ZONES:  
Depth at which water was first found 70 feet

From	To	Estimated Flow Rate	SWL
70'	75'	50gpm	70'
81'	89'	50gpm	67'
92'	99'	50gpm	67'

(12) WELL LOG:  
Ground Elevation

Material	From	To	SWL
Sandy Soil	1'	4'	
Black Cinders (Fine)	4'	36'	
Black & Red Cinders (Coarse)	36'	50'	
Black Cinders w/white Dunite	50'	62'	
Sand Stone (Brown)	62'	70'	
Sand Stone - Dunite & Diatomite	70'	75'	70'
Black Basalt	75'	91'	70'
Clay (Cage Blue)	81'	89'	67'
Sand Stone medium	89'	92'	67'
Black sand (water bearing)	92'	99'	67'
Black Cinders w/pumice layer	99'	115'	67'

RECEIVED

RECEIVED

APR 26 2000

FEB 16 2016

WATER RESOURCES DEPT.  
SALEM, OREGON

WATER RESOURCES DEPT.  
SALEM, OREGON

Date started 9-23-98 Completed 4-20-2000

(unbonded) Water Well Constructor Certification:  
I certify that the work I performed on the construction, alteration, or abandonment of this well is in compliance with Oregon water supply well construction standards. Materials used and information reported above are true to the best of my knowledge and belief.

Signed Joseph D. Eckley WWC Number Date 4-23-2000

(bonded) Water Well Constructor Certification:  
I accept responsibility for the construction, alteration, or abandonment work performed on this well during the construction dates reported above. All work performed during this time is in compliance with Oregon water supply well construction standards. This report is true to the best of my knowledge and belief.

Signed Joseph D. Eckley WWC Number Date 4-23-2000

scvd 2-17-11 X  
This is "new well drilled 2000" from ext. app.



STATE OF OREGON
WATER SUPPLY WELL REPORT
(as required by ORS 537.765 & OAR 690-205-0210)

06-15-2011

WELL LABEL # L 41297

START CARD # 1013761

(1) LAND OWNER Owner Well I.D.

First Name Jim Last Name Robie
Company
Address 30042 Weaver Springs Lane
City Burns State Or Zip 97720

(2) TYPE OF WORK
New Well [ ] Deepening [x] Conversion [ ]
Alteration (repair/recondition) [ ] Abandonment [ ]

(3) DRILL METHOD
Rotary Air [x] Rotary Mud [ ] Cable [ ] Auger [ ] Cable Mud [ ]
Reverse Rotary [ ] Other [ ]

(4) PROPOSED USE
Domestic [ ] Irrigation [x] Community [ ]
Industrial/ Commercial [ ] Livestock [ ] Dewatering [ ]
Thermal [ ] Injection [ ] Other [ ]

(5) BORE HOLE CONSTRUCTION Special Standard [ ] (Attach copy)
Depth of Completed Well 247.00 ft.

Table with columns: Dia, From, To, Material, SEAL From, To, Amt, sacks/lbs. Contains data for bore hole construction.

How was seal placed: Method [ ] A [ ] B [ ] C [ ] D [ ] E [ ]
Backfill placed from ft. to ft. Material
Filter pack from ft. to ft. Material Size
Explosives used: [ ] Yes Type Amount

(6) CASING/LINER
Casing Liner Dia + From To Gauge Sil Plstc Wld Thrd

Table for casing/liner with columns: Casing, Liner, Dia, From, To, Gauge, Sil, Plstc, Wld, Thrd. Includes a diagram of casing/liner types.

Shoe [ ] Inside [ ] Outside [ ] Other Location of shoe(s)
Temp casing [ ] Yes Dia From To

(7) PERFORATIONS/SCREENS

Table for perforations/screens with columns: Per/S, Casing/Screen, Dia, From, To, Scrm/slot width, Slot length, # of slots, Tele/pipe size.

(8) WELL TESTS: Minimum testing time is 1 hour

Table for well tests with columns: Yield gal/min, Drawdown, Drill stem/Pump depth, Duration (hr). Includes test results for Pump, Bailer, Air, and Flowing Artesian.

Table for water quality concerns with columns: From, To, Description, Amount, Units.

(9) LOCATION OF WELL (legal description)

County Harney Twp 26.00 S N/S Range 30.00 E E/W WM
Sec 2 NE 1/4 of the SW 1/4 Tax Lot 400
Tax Map Number Lot
Lat 0 0 or DMS or DD
Long 0 0 or DMS or DD
Street address of well [x] Nearest address [ ]

30042 Weaver Springs Lane

(10) STATIC WATER LEVEL

Table for static water level with columns: Date, SWL(psi), SWL(ft). Includes data for Existing Well / Predeepening and Completed Well (06-14-2011, 91).

Flowing Artesian? [ ] Dry Hole? [ ]

WATER BEARING ZONES Depth water was first found 91

Table for water bearing zones with columns: SWL Date, From, To, Est Flow, SWL(psi), SWL(ft).

(11) WELL LOG

Table for well log with columns: Material, From, To, Ground Elevation. Includes a large 'RECEIVED' stamp and date 'FEB 17 2016'.

Date Started 06-10-2011 Completed 06-14-2011

(unbonded) Water Well Constructor Certification
I certify that the work I performed on the construction, deepening, alteration, or abandonment of this well is in compliance with Oregon water supply well construction standards.

License Number Date
Electronically Filed
Signed

(bonded) Water Well Constructor Certification
I accept responsibility for the construction, deepening, alteration, or abandonment work performed on this well during the construction dates reported above.

License Number 1424 Date 06-15-2011
Electronically Filed
Signed TIMOTHY K RILEY (E-filed)
Contact Info (optional)



**Water Use Report from OWRD Water-Use Database (Some paper records may not have been entered)  
Monthly Use**

user_id	owner	water use report_id	pod_facility_name	Logid (wells only)	water month	water year	cal-endar month	cal-endar year	water_used (acre feet)
31298	SUNNYSIDE DAIRY LLC	37058	PIVOT 2 (HARN 1318)	HARN 1318	1	2001	Oct	2000	0.00
31298	SUNNYSIDE DAIRY LLC	37058	PIVOT 2 (HARN 1318)	HARN 1318	2	2001	Nov	2000	0.00
31298	SUNNYSIDE DAIRY LLC	37058	PIVOT 2 (HARN 1318)	HARN 1318	3	2001	Dec	2000	0.00
31298	SUNNYSIDE DAIRY LLC	37058	PIVOT 2 (HARN 1318)	HARN 1318	4	2001	Jan	2001	0.00
31298	SUNNYSIDE DAIRY LLC	37058	PIVOT 2 (HARN 1318)	HARN 1318	5	2001	Feb	2001	0.00
31298	SUNNYSIDE DAIRY LLC	37058	PIVOT 2 (HARN 1318)	HARN 1318	6	2001	Mar	2001	0.00
31298	SUNNYSIDE DAIRY LLC	37058	PIVOT 2 (HARN 1318)	HARN 1318	7	2001	Apr	2001	0.00
31298	SUNNYSIDE DAIRY LLC	37058	PIVOT 2 (HARN 1318)	HARN 1318	8	2001	May	2001	70.81
31298	SUNNYSIDE DAIRY LLC	37058	PIVOT 2 (HARN 1318)	HARN 1318	9	2001	Jun	2001	118.05
31298	SUNNYSIDE DAIRY LLC	37058	PIVOT 2 (HARN 1318)	HARN 1318	10	2001	Jul	2001	85.93
31298	SUNNYSIDE DAIRY LLC	37058	PIVOT 2 (HARN 1318)	HARN 1318	11	2001	Aug	2001	85.02
31298	SUNNYSIDE DAIRY LLC	37058	PIVOT 2 (HARN 1318)	HARN 1318	12	2001	Sep	2001	87.76

Water Year Total (Acre Feet) 447.57

Water Use Report from OWRD Water-Use Database (Some paper records may not have been entered)  
 Monthly Use

user_id	owner	water use report_id	pod_facility_name	Logid (wells only)	water month	water year	cal-endar month	cal-endar year	water_used (acre feet)
31298	SUNNYSIDE DAIRY LLC	37058	PIVOT 2 (HARN 1318)	HARN 1318	1	2002	Oct	2001	0.00
31298	SUNNYSIDE DAIRY LLC	37058	PIVOT 2 (HARN 1318)	HARN 1318	2	2002	Nov	2001	0.00
31298	SUNNYSIDE DAIRY LLC	37058	PIVOT 2 (HARN 1318)	HARN 1318	3	2002	Dec	2001	0.00
31298	SUNNYSIDE DAIRY LLC	37058	PIVOT 2 (HARN 1318)	HARN 1318	4	2002	Jan	2002	0.00
31298	SUNNYSIDE DAIRY LLC	37058	PIVOT 2 (HARN 1318)	HARN 1318	5	2002	Feb	2002	0.00
31298	SUNNYSIDE DAIRY LLC	37058	PIVOT 2 (HARN 1318)	HARN 1318	6	2002	Mar	2002	0.00
31298	SUNNYSIDE DAIRY LLC	37058	PIVOT 2 (HARN 1318)	HARN 1318	7	2002	Apr	2002	0.00
31298	SUNNYSIDE DAIRY LLC	37058	PIVOT 2 (HARN 1318)	HARN 1318	8	2002	May	2002	0.07
31298	SUNNYSIDE DAIRY LLC	37058	PIVOT 2 (HARN 1318)	HARN 1318	9	2002	Jun	2002	0.84
31298	SUNNYSIDE DAIRY LLC	37058	PIVOT 2 (HARN 1318)	HARN 1318	10	2002	Jul	2002	0.84
31298	SUNNYSIDE DAIRY LLC	37058	PIVOT 2 (HARN 1318)	HARN 1318	11	2002	Aug	2002	0.02
31298	SUNNYSIDE DAIRY LLC	37058	PIVOT 2 (HARN 1318)	HARN 1318	12	2002	Sep	2002	0.00
<b>Water Year Total (Acre Feet)</b>									<b>1.77</b>

Water Use Report from OWRD Water-Use Database (Some paper records may not have been entered)  
 Monthly Use

user_id	owner	water use report_id	pod_facility_name	Logid (wells only)	water month	water year	cal-endar month	cal-endar year	water_used (acre feet)
31298	SUNNYSIDE DAIRY LLC	37058	PIVOT 2 (HARN 1318)	HARN 1318	1	2003	Oct	2002	0.00
31298	SUNNYSIDE DAIRY LLC	37058	PIVOT 2 (HARN 1318)	HARN 1318	2	2003	Nov	2002	0.00
31298	SUNNYSIDE DAIRY LLC	37058	PIVOT 2 (HARN 1318)	HARN 1318	3	2003	Dec	2002	0.00
31298	SUNNYSIDE DAIRY LLC	37058	PIVOT 2 (HARN 1318)	HARN 1318	4	2003	Jan	2003	0.00
31298	SUNNYSIDE DAIRY LLC	37058	PIVOT 2 (HARN 1318)	HARN 1318	5	2003	Feb	2003	0.00
31298	SUNNYSIDE DAIRY LLC	37058	PIVOT 2 (HARN 1318)	HARN 1318	6	2003	Mar	2003	0.00
31298	SUNNYSIDE DAIRY LLC	37058	PIVOT 2 (HARN 1318)	HARN 1318	7	2003	Apr	2003	0.00
31298	SUNNYSIDE DAIRY LLC	37058	PIVOT 2 (HARN 1318)	HARN 1318	8	2003	May	2003	33.01
31298	SUNNYSIDE DAIRY LLC	37058	PIVOT 2 (HARN 1318)	HARN 1318	9	2003	Jun	2003	99.03
31298	SUNNYSIDE DAIRY LLC	37058	PIVOT 2 (HARN 1318)	HARN 1318	10	2003	Jul	2003	102.34
31298	SUNNYSIDE DAIRY LLC	37058	PIVOT 2 (HARN 1318)	HARN 1318	11	2003	Aug	2003	82.53
31298	SUNNYSIDE DAIRY LLC	37058	PIVOT 2 (HARN 1318)	HARN 1318	12	2003	Sep	2003	0.00
<b>Water Year Total (Acre Feet)</b>									<b>316.91</b>

**Water Use Report from OWRD Water-Use Database (Some paper records may not have been entered)  
Monthly Use**

user_id	owner	water use report_id	pod_facility_name	Logid (wells only)	water month	water year	cal-endar month	cal-endar year	water_used (acre feet)
31298	SUNNYSIDE DAIRY LLC	37058	PIVOT 2 (HARN 1318)	HARN 1318	1	2004	Oct	2003	0.00
31298	SUNNYSIDE DAIRY LLC	37058	PIVOT 2 (HARN 1318)	HARN 1318	2	2004	Nov	2003	0.00
31298	SUNNYSIDE DAIRY LLC	37058	PIVOT 2 (HARN 1318)	HARN 1318	3	2004	Dec	2003	0.00
31298	SUNNYSIDE DAIRY LLC	37058	PIVOT 2 (HARN 1318)	HARN 1318	4	2004	Jan	2004	0.00
31298	SUNNYSIDE DAIRY LLC	37058	PIVOT 2 (HARN 1318)	HARN 1318	5	2004	Feb	2004	0.00
31298	SUNNYSIDE DAIRY LLC	37058	PIVOT 2 (HARN 1318)	HARN 1318	6	2004	Mar	2004	0.00
31298	SUNNYSIDE DAIRY LLC	37058	PIVOT 2 (HARN 1318)	HARN 1318	7	2004	Apr	2004	39.61
31298	SUNNYSIDE DAIRY LLC	37058	PIVOT 2 (HARN 1318)	HARN 1318	8	2004	May	2004	82.53
31298	SUNNYSIDE DAIRY LLC	37058	PIVOT 2 (HARN 1318)	HARN 1318	9	2004	Jun	2004	99.30
31298	SUNNYSIDE DAIRY LLC	37058	PIVOT 2 (HARN 1318)	HARN 1318	10	2004	Jul	2004	66.02
31298	SUNNYSIDE DAIRY LLC	37058	PIVOT 2 (HARN 1318)	HARN 1318	11	2004	Aug	2004	92.43
31298	SUNNYSIDE DAIRY LLC	37058	PIVOT 2 (HARN 1318)	HARN 1318	12	2004	Sep	2004	0.00

Water Year Total (Acre Feet) 379.90



**Water Use Report from OWRD Water-Use Database (Some paper records may not have been entered)  
Monthly Use**

user_id	owner	water use report_id	pod_facility_name	Logid (wells only)	water month	water year	cal-endar month	cal-endar year	water_used (acre feet)
31298	SUNNYSIDE DAIRY LLC	37058	PIVOT 2 (HARN 1318)	HARN 1318	1	2014	Oct	2013	0.00
31298	SUNNYSIDE DAIRY LLC	37058	PIVOT 2 (HARN 1318)	HARN 1318	2	2014	Nov	2013	0.00
31298	SUNNYSIDE DAIRY LLC	37058	PIVOT 2 (HARN 1318)	HARN 1318	3	2014	Dec	2013	0.00
31298	SUNNYSIDE DAIRY LLC	37058	PIVOT 2 (HARN 1318)	HARN 1318	4	2014	Jan	2014	0.00
31298	SUNNYSIDE DAIRY LLC	37058	PIVOT 2 (HARN 1318)	HARN 1318	5	2014	Feb	2014	0.00
31298	SUNNYSIDE DAIRY LLC	37058	PIVOT 2 (HARN 1318)	HARN 1318	6	2014	Mar	2014	0.00
31298	SUNNYSIDE DAIRY LLC	37058	PIVOT 2 (HARN 1318)	HARN 1318	7	2014	Apr	2014	0.00
31298	SUNNYSIDE DAIRY LLC	37058	PIVOT 2 (HARN 1318)	HARN 1318	8	2014	May	2014	0.00
31298	SUNNYSIDE DAIRY LLC	37058	PIVOT 2 (HARN 1318)	HARN 1318	9	2014	Jun	2014	96.18
31298	SUNNYSIDE DAIRY LLC	37058	PIVOT 2 (HARN 1318)	HARN 1318	10	2014	Jul	2014	46.12
31298	SUNNYSIDE DAIRY LLC	37058	PIVOT 2 (HARN 1318)	HARN 1318	11	2014	Aug	2014	50.31
31298	SUNNYSIDE DAIRY LLC	37058	PIVOT 2 (HARN 1318)	HARN 1318	12	2014	Sep	2014	42.17
<b>Water Year Total (Acre Feet)</b>									<b>234.78</b>

**Water Use Report from OWRD Water-Use Database (Some paper records may not have been entered)  
Monthly Use**

user_id	owner	water use report_id	pod_facility_name	Logid (wells only)	water month	water year	cal-endar month	cal-endar year	water_used (acre feet)
31298	SUNNYSIDE DAIRY LLC	37058	PIVOT 2 (HARN 1318)	HARN 1318	1	2015	Oct	2014	0.00
31298	SUNNYSIDE DAIRY LLC	37058	PIVOT 2 (HARN 1318)	HARN 1318	2	2015	Nov	2014	0.00
31298	SUNNYSIDE DAIRY LLC	37058	PIVOT 2 (HARN 1318)	HARN 1318	3	2015	Dec	2014	0.00
31298	SUNNYSIDE DAIRY LLC	37058	PIVOT 2 (HARN 1318)	HARN 1318	4	2015	Jan	2015	0.00
31298	SUNNYSIDE DAIRY LLC	37058	PIVOT 2 (HARN 1318)	HARN 1318	5	2015	Feb	2015	0.00
31298	SUNNYSIDE DAIRY LLC	37058	PIVOT 2 (HARN 1318)	HARN 1318	6	2015	Mar	2015	0.00
31298	SUNNYSIDE DAIRY LLC	37058	PIVOT 2 (HARN 1318)	HARN 1318	7	2015	Apr	2015	0.00
31298	SUNNYSIDE DAIRY LLC	37058	PIVOT 2 (HARN 1318)	HARN 1318	8	2015	May	2015	57.31
31298	SUNNYSIDE DAIRY LLC	37058	PIVOT 2 (HARN 1318)	HARN 1318	9	2015	Jun	2015	61.62
31298	SUNNYSIDE DAIRY LLC	37058	PIVOT 2 (HARN 1318)	HARN 1318	10	2015	Jul	2015	48.07
31298	SUNNYSIDE DAIRY LLC	37058	PIVOT 2 (HARN 1318)	HARN 1318	11	2015	Aug	2015	44.11
31298	SUNNYSIDE DAIRY LLC	37058	PIVOT 2 (HARN 1318)	HARN 1318	12	2015	Sep	2015	12.85

Water Year Total (Acre Feet) 223.96