

Application No. 611608

Permit No. 45901

RECEIVED

APR 28 1981

STATE OF OREGON WATER RESOURCES DEPARTMENT

Application for Permit to Appropriate Surface Water

I, Theodore R. McNeely (Name of Applicant)

of 1450 Fairview Rt, Coquille (Mailing Address) (City)

State of Ore, 97423 (Zip Code) Phone No. 396-2279 do hereby

make application for a permit to appropriate the following described waters of the State of Oregon:

1. The source of the proposed appropriation is AN UNNAMED STREAM

a tributary of Coquille R.

2. The point of diversion is to be located 500 ft N and 685 ft E from the S 1/4 corner of Sec 19

(Public Land Survey Corner)

(If there is more than one point of diversion, each must be described)

being within the SW 1/4 of the SE 1/4 of

Sec. 19 Tp. 28S R. 12W, W. M., in the county of Coos

3. Location of area to be irrigated, or place of use if other than irrigation.

Table with 5 columns: Township, Range, Section, List 1/4 1/4 of Section, List use and/or number of acres to be irrigated. Contains handwritten entries for Township 28S, Range 12W, Section 19, and irrigation details.

4. The amount of water which the applicant intends to apply to beneficial use is 0.015  
cubic feet per second from UN'nd Str. at POD #1 w/any deficiency in supply to come  
from SAME UN'nd Str. at POD #2  
(If water is to be used from more than one source, give quantity from each)

5. The use to which the water is to be applied is domestic = 0.01, stock = 0.005 cfs

6. DESCRIPTION OF WORKS

Include dimensions and type of construction of diversion dam and headgate, length and dimensions of supply ditch or pipeline, size and type of pump and motor, type of irrigation system to adequately describe the proposed distribution system.

POD #1: Concrete tiles in stream - 1200 feet 1" plastic pipe to holding tank - 1800 feet 1" plastic pipe to home & livestock on the west side of highway 42 by gravity - 1000 feet 1 1/4" pipe to remaining 4 homes & livestock by gravity. 3/4 hp. submersible pump to storage tank.

POD #2: Dirt dam 3 feet high - 600 feet 1" plastic pipe to POD #1 - 1/2 hp pump.

If for domestic use state number of families to be supplied 5

7. Construction work will begin on or before Has begun

8. Construction work will be completed on or before April 27, 1983

9. The water will be completely applied to the proposed use on or before April 27, 1984

Application No. 61608

Permit No. 45901

42800

Remarks:.....

.....  
.....  
.....  
.....  
.....  
.....  
.....  
.....  
.....  
.....

*Theodore R. McNeil*  
Signature of Applicant

*This is to certify that I have examined the foregoing application, together with the accompanying maps and data, and return the same for.....*

*In order to retain its priority, this application must be returned to the Water Resources Director with corrections on or before ....., 19.....*

WITNESS my hand this ..... day of ....., 19.....

..... Water Resources Director

By .....

*This instrument was first received in the office of the Water Resources Director at Salem, Oregon, on the*

*28* day of *April*, 19*81*, at *8:00* o'clock  
*A.M.*

Application No. *61608* Permit No. *45901*

*61608* *45901*

Application No. 61608

Permit No. 45901

Permit to appropriate the Public Waters of the State of Oregon

This is to certify that I have examined the foregoing application and do hereby grant the same SUBJECT TO EXISTING RIGHTS INCLUDING THE EXISTING FLOW POLICIES ESTABLISHED BY THE WATER POLICY REVIEW BOARD and the following limitations and conditions

The right herein granted is limited to the amount of water which can be applied to beneficial use and shall not exceed 0.015 cubic feet per second measured at the point of diversion from the stream, or its equivalent in case of rotation with other water users, from an unnamed stream

The use to which this water is to be applied is domestic for five families and stock, being 0.01 cfs for domestic and 0.005 cfs for stock.

If for irrigation, this appropriation shall be limited to of one cubic foot per second or its equivalent for each acre irrigated

and shall be subject to such reasonable rotation system as may be ordered by the proper state officer.

The priority date of this permit is April 28, 1981

Actual construction work shall begin on or before August 20, 1982 and shall

thereafter be prosecuted with reasonable diligence and be completed on or before October 1, 1983

Complete application of the water to the proposed use shall be made on or before October 1, 1984

WITNESS my hand this 20th day of August, 1981

James E. Seaman
Water Resources Director

RLX T

T 28 S R 12 W  
Sec 19

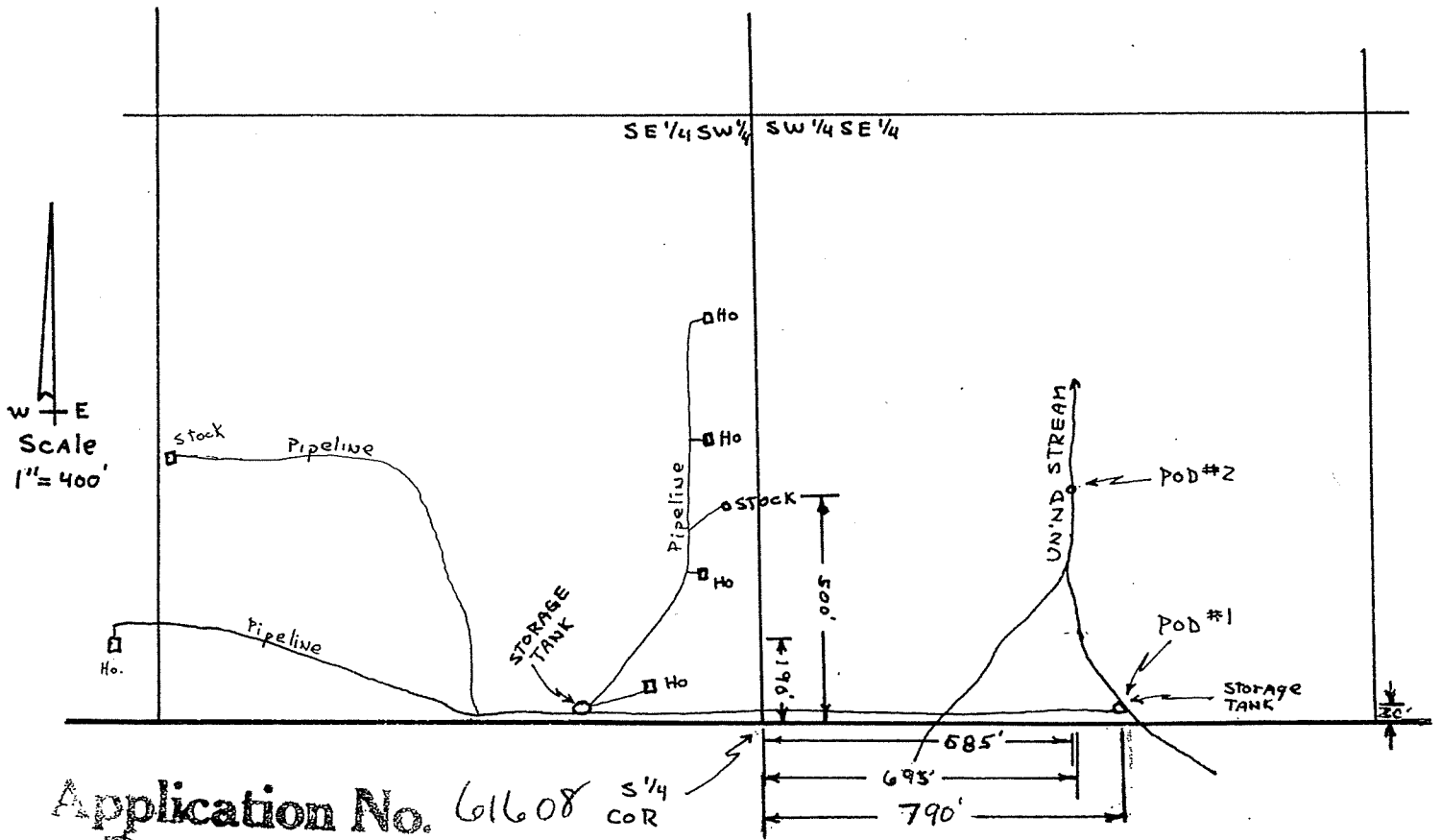

Application No. 61608 S 1/4  
Permit No. 45901 Co R

APR 23 1981  
WATER RESOURCES DEPT  
SALEM, OREGON

T 28 S R 12 W  
Sec 19

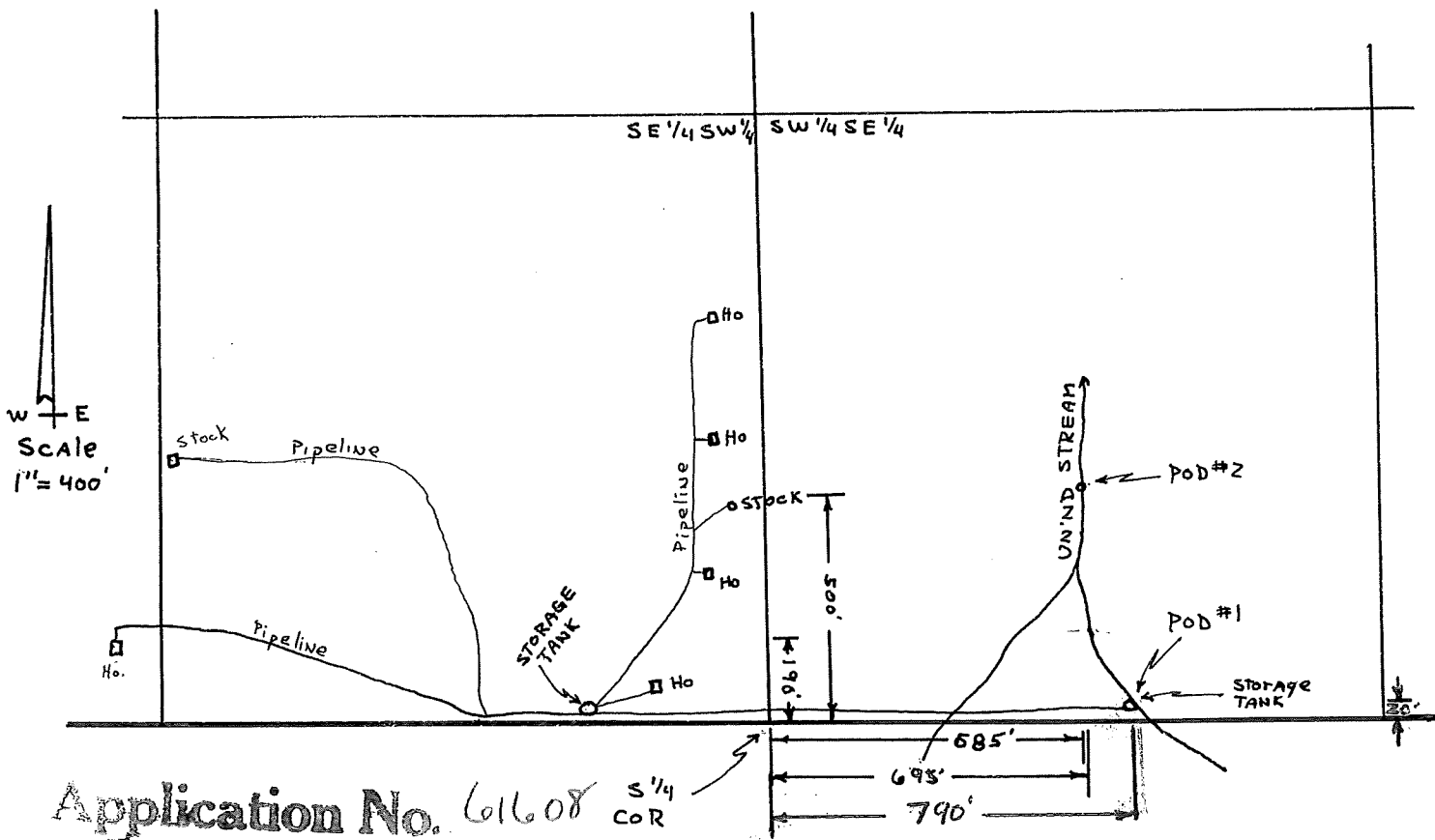

Application No. 61608 S 1/4 COR  
Permit No. 45901

RECEIVED  
APR 28 1981  
WATER RESOURCES DEPT  
SALEM, OREGON

COPY

TERRACE  
SCALE

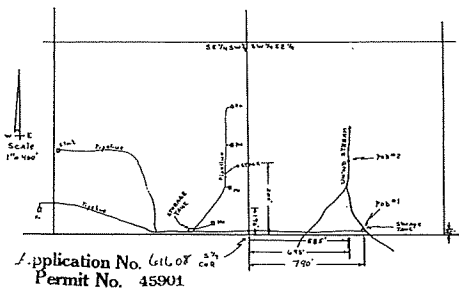

WATER-RESISTANT  
SHEATHING

RECEIVED RECEIVED

JAN 14 1981 APR 28 1981

WATER RESOURCES DEPT WATER RESOURCES DEPT  
SALEM, OREGON SALEM, OREGON

T 288 R 12  
Scale 1" = 400'

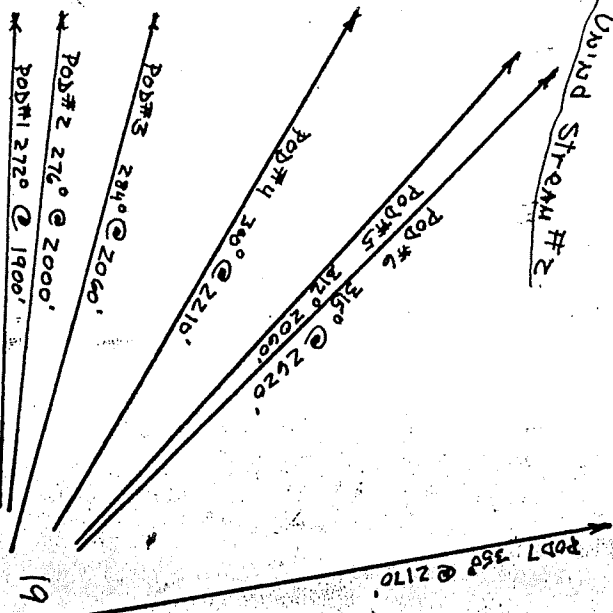
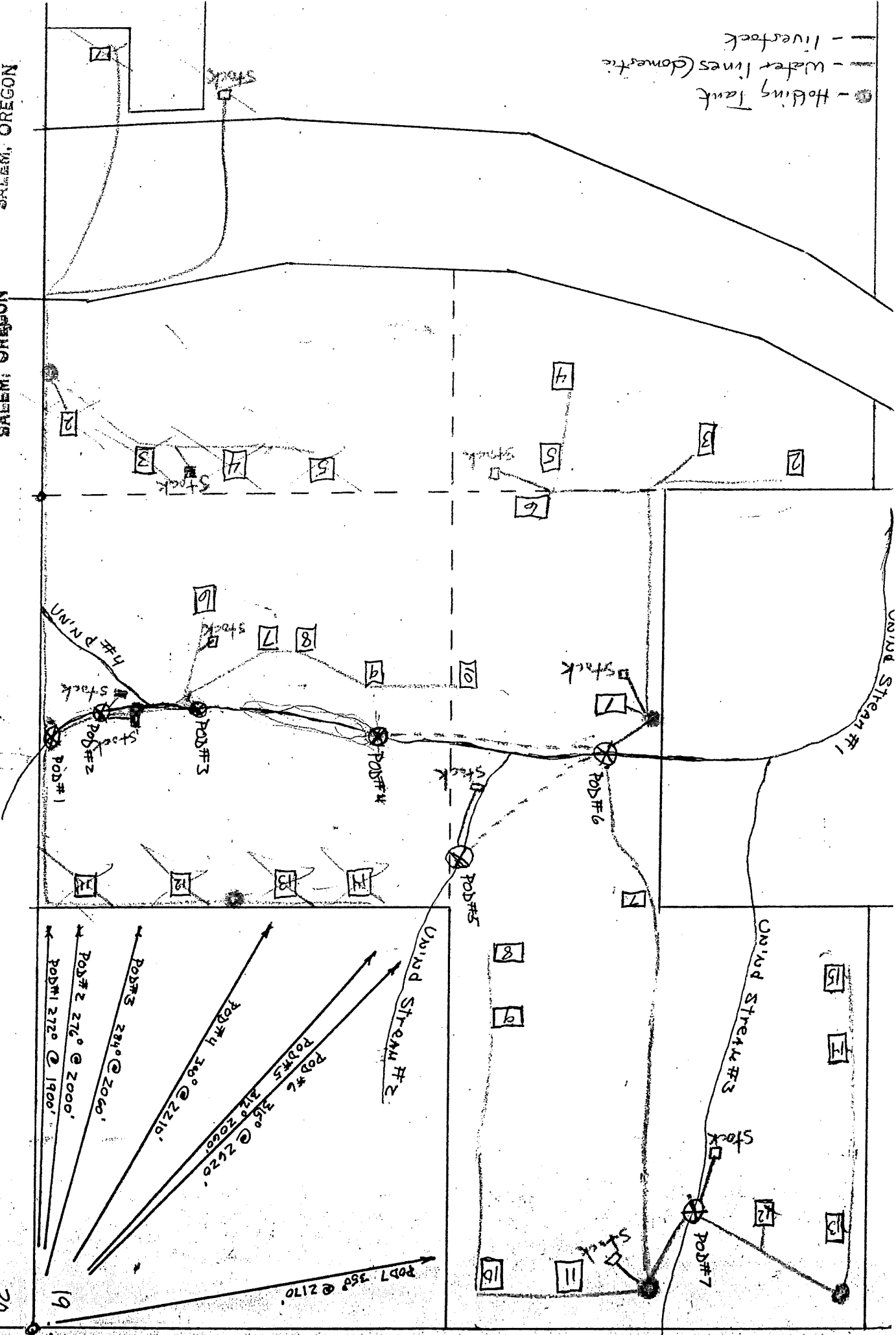

20



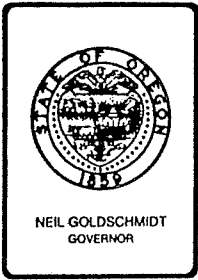

## Water Resources Department

3850 PORTLAND ROAD NE, SALEM, OREGON 97310

PHONE 378-3739

March 22, 1988

John Drolet  
Watermaster, Dist. 19  
290 North Central  
Coos Co. Annex  
Coquille, OR 97423

Dear John:

REFERENCE: Files 61604-61609, T.R. McNeely

You have asked if Mr. McNeely can still apply for extensions of the time limits for his Permits 45897, 45898, 45899, 45900, 45901, and 45902. The answer is "Yes, he can".

Except for Permit 45900 which was filed as "completed", we have not been notified as to what, if anything, was accomplished since the permits were issued. No B or C forms were filed, and no response was received from our March 26, 1985 certified letter.

Any request for extension of time would have to be very clear as to what was accomplished within the time limits in terms of construction and use of water. The permits are all awaiting survey, and carry the "survey regardless" designation.

Sincerely,

Steven P. Applegate  
Field Crews Supervisor

SPA:ldh

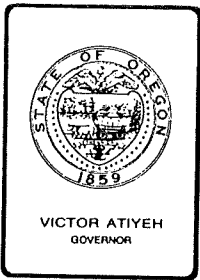

## Water Resources Department

MILL CREEK OFFICE PARK

555 13th STREET N.E., SALEM, OREGON 97310

PHONE

March 26, 1985

378-8508

Theodore R. McNeely  
1450 Fairview Route  
Coquille, OR 97423

REFERENCE: 61608

According to the terms of your Permit 45901 which was for 0.015 cubic foot per second of water from an unnamed stream for domestic use for five families and stock purposes in Coos County,

complete application of water was to have been made by October 1, 1984.

Complete application of water means the application of water to a beneficial use under the permit to the full extent intended. In the case of irrigation, it means beneficial irrigation of all the lands the permittee intends to cover under the terms of the permit. If the water has been used, you should promptly submit notice describing the extent of completion as set forth in the letter accompanying your permit and also in our postal card of October 18, 1984.

ORS 537.260 provides that: "Whenever the time within which any appropriation under a permit should have been perfected has expired and the owner of the permit fails or refuses within three months thereafter to submit to the Water Resources Director proof of completion of the appropriation as required by ORS 537.230 and 537.250, the Water Resources Director may, after 60 days notice by registered mail, order the cancellation of the permit..."

In accordance with the provisions of ORS 537.260, you are hereby notified that unless proof of beneficial use is received within 60 days from the date of this letter, the permit(s) may be canceled without further notice.

If for any reason, you are no longer interested in the project described by the permit, we would appreciate it if you would so advise. If the property involved has changed hands and any part of the project has been completed, you should immediately assign the permit to the new owner and advise us of his name and address. An assignment form will be furnished upon request.

Sincerely,

Bruce A. Estes, Supervisor  
Survey/Certificate Section

COPY

FORM 690-10-100  
CERTIFIED - RETURN RECEIPT REQUESTED

July 23, 1981

Theodore N. McNeely  
1430 Fairview Road  
Coquille, OR 97423

Dear Mr. McNeely:

REFERENCE: Files 61604, 61605, 61606, 61607, 61608 and 61609

Your six applications and accompanying maps have been reviewed. Application 61604 describes the proposed use of 0.015 cubic foot per second of water from two unnamed streams for domestic use for four families and stockwater; Application 61605 describes the proposed use of 0.01 cfs from two unnamed streams for domestic use for five families and stockwater; Application 61606 describes the proposed use of 0.015 cfs from two unnamed streams for domestic use for four families and stockwater; Application 61607 describes the proposed use of 0.07 cfs of water from two streams for domestic use for six families and stockwater; Application 61608 describes the proposed use of 0.017 cfs of water from an unnamed stream for domestic use for five families and stockwater, and Application 61609 describes the proposed use of 0.015 cfs from two unnamed streams for domestic use for five families and stockwater.

Permits will be issued for the use of water from the Coquille River and its tributaries. However, water may not be available during dry periods. The water may be needed to satisfy existing rights.

Your applications are in satisfactory form for the issuance of permits and will be considered for approval with the next group to be processed.

Sincerely,

STEPHEN C. BROWN  
Water Rights Engineer

SCB:wp  
enclosure Receipt 13035  
2042A



August 26, 1981

Theodore R. McNeely  
1450 Fairview Route  
Coquille, Oregon 97423

61604  
61605  
61606  
61607  
61608  
61609

Permits 45897, 45898, 45899, 45900, 45901 and 45902.

.....  
..... April 28, 1981 .....  
.....  
..... Application No. **61608** .....  
..... Permit No. **45901** .....  
Name Theodore R. McNeely .....  
Address 1450 Fairview Rt. Coquille, OR 97423 .....  
Assigned .....  
Address .....  
Beginning construction **AUG 20 1982** .....  
Completion of construction **OCT 1 - 1983** .....  
Extended to .....  
Complete application of water **OCT 1 - 1984** .....  
Extended to .....

Form 100 MAR 26 1985

