



Oregon Water Resources Department  
 725 Summer Street NE, Suite A  
 Salem, Oregon 97301-1271  
 (503) 986-0900  
 www.wrd.state.or.us

# Water Right Transfer Supplemental Form Map Waiver

The Director may waive or assist a transfer applicant in satisfying the map requirement (OAR 690-380-3100) for certain transfers if the criteria described in this form are met pursuant to OAR 690-380-3410.

This form must be prepared by the transfer applicant and the appropriate Regional Manager for the Oregon Water Resources Department. To prepare the form, a copy of the complete transfer application, including a description of the water rights to be transferred, must be provided to the Regional Manager.

This map waiver form must be signed by the Regional Manager and submitted with the transfer application.

Transfer Applicant: CITY OF SUMPTER

Water Right(s) to be transferred: 4377 (1873 PRIORITY)

1. The transfer **must** be one of the following. Please check the appropriate box.

- An instream transfer application filed pursuant to ORS 537.348.
- A transfer application necessary to complete a project funded by the Oregon Watershed Enhancement Board (OWEB) under ORS 541.375; or
- The transfer application is determined and endorsed in writing by ODFW as a change that will result in a net benefit to fish and wildlife habitat.

2. For an **instream transfer application filed pursuant to ORS 537.348**, a map waiver shall only be approved if the application meets one of the following additional criteria. Please check the appropriate box.

- The entirety of the right is being transferred to an instream water right and the location of the instream water right can be clearly delineated through reference to the existing point of diversion for the transferred right and other points of diversion or geographic reference points such as the mouth of the stream; or
- A map meeting the requirements of the transfer rules (OAR 690-380-3100) is available showing the lands not included in the transfer and the location of the instream water right can be clearly delineated through reference to the existing point of diversion for the transferred right and other points of diversion or geographic reference points such as the mouth of the stream. (Please include copy of map(s) with transfer application.)

T 10287  
 Transfer Application Map Waiver Form

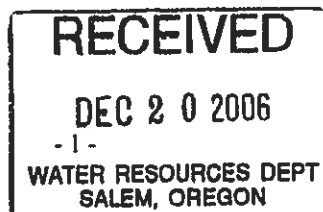

FSD Last Revised 3/6/2006

3. For a transfer application meeting any one of the criteria identified in #1 (including an instream transfer application), a map waiver may also be approved if other circumstances are present that make an application map unnecessary. If #2 does not apply, but circumstances are present that make an application map unnecessary, describe those circumstances below:

---

---

---

---

---

---

---

---

4. For any transfer application meeting one or more of the criteria identified in #1 that does not meet the criteria for a map waiver as described in #2 or #3, the Department may assist the applicant in development of the application map. The Department (through the regional office) may provide this assistance at the discretion of the appropriate Regional Manager. Please check the appropriate box below if the Department has provided assistance in development of the transfer application map:

- A map meeting the requirements of OAR 690-380-3100 has been prepared by Department staff and is included with the transfer application.
- The map provided with the transfer application has been developed with assistance from Department staff and meets the requirements of OAR 690-380-3100.

Signature:   
OWRD Regional Manager, EAST Region

Date: 7/19/06

T 10287

# Sumpter Municipal Water Diversion

Township 9 South, Range 36 East, W.M.

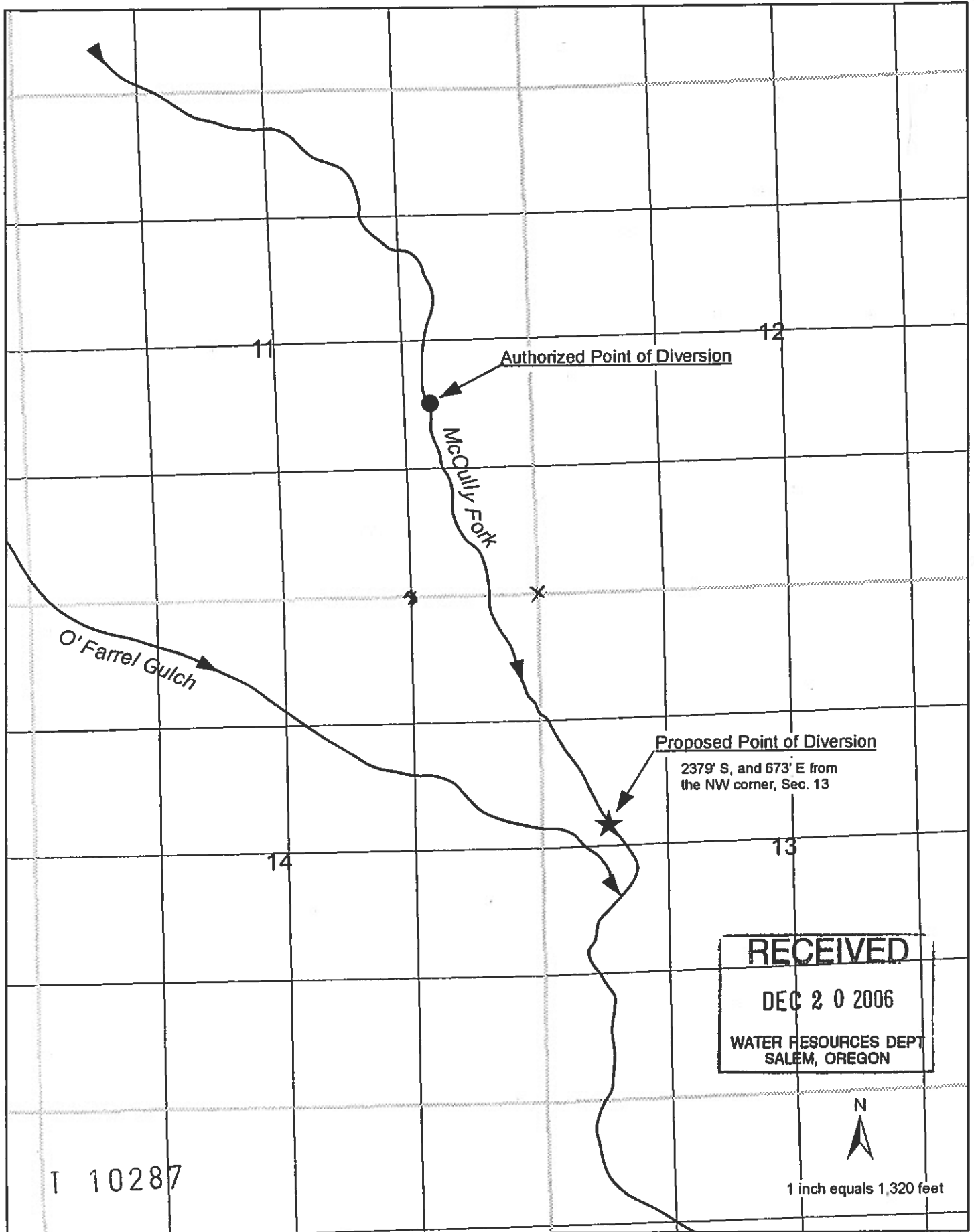

T 10287

**RECEIVED**  
DEC 20 2006  
WATER RESOURCES DEPT  
SALEM, OREGON



1 inch equals 1,320 feet

South \_\_\_\_\_, Range 36 East \_\_\_\_\_.

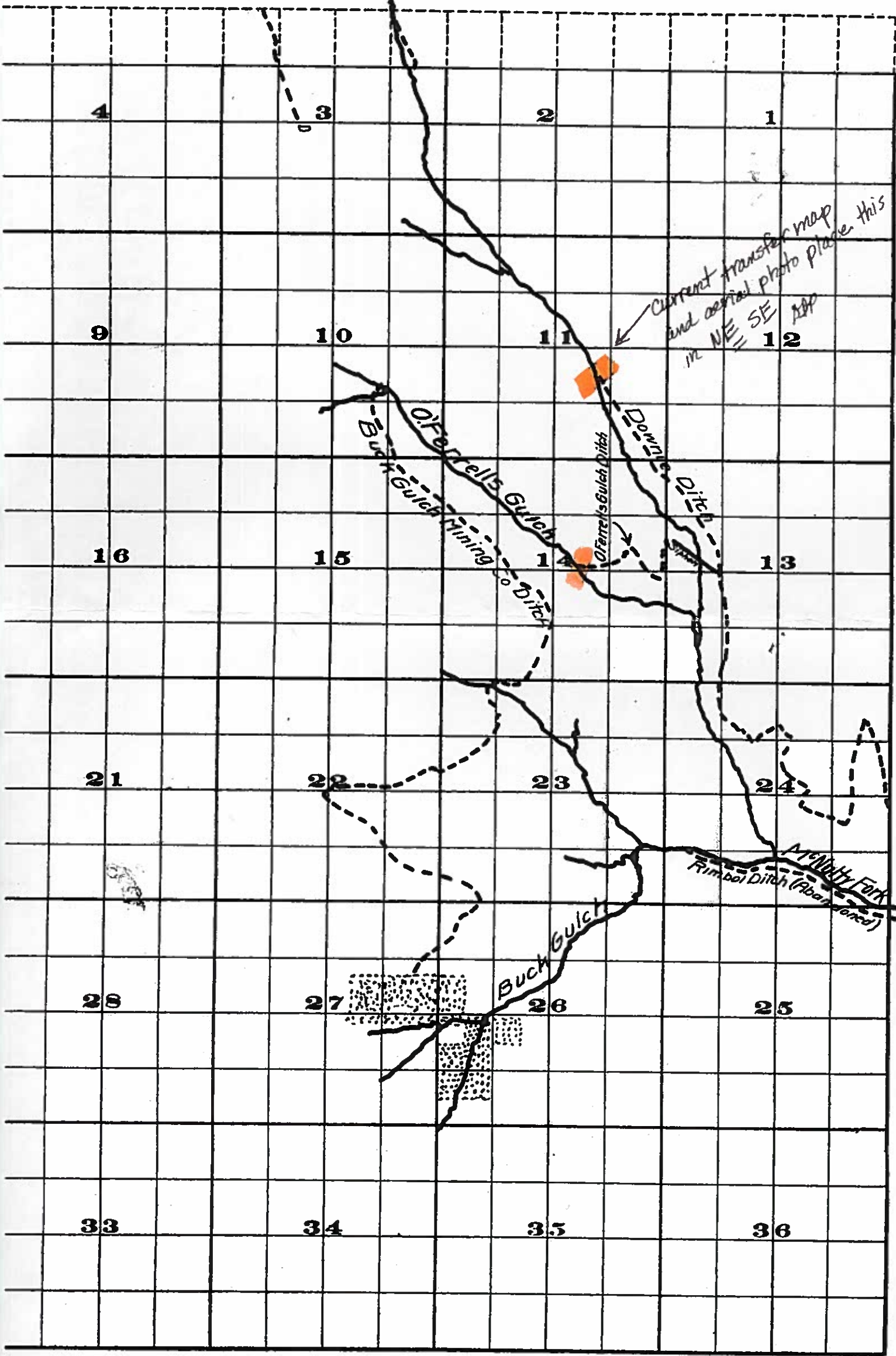

FROM OFFICE OF THE STATE ENGINEER, SALEM, OREGON

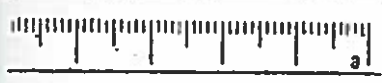

*Powder River Adjudication*  
*John H. Lewis State Engineer*  
*Examined June 6, 1912*

8 South

Range 36 East

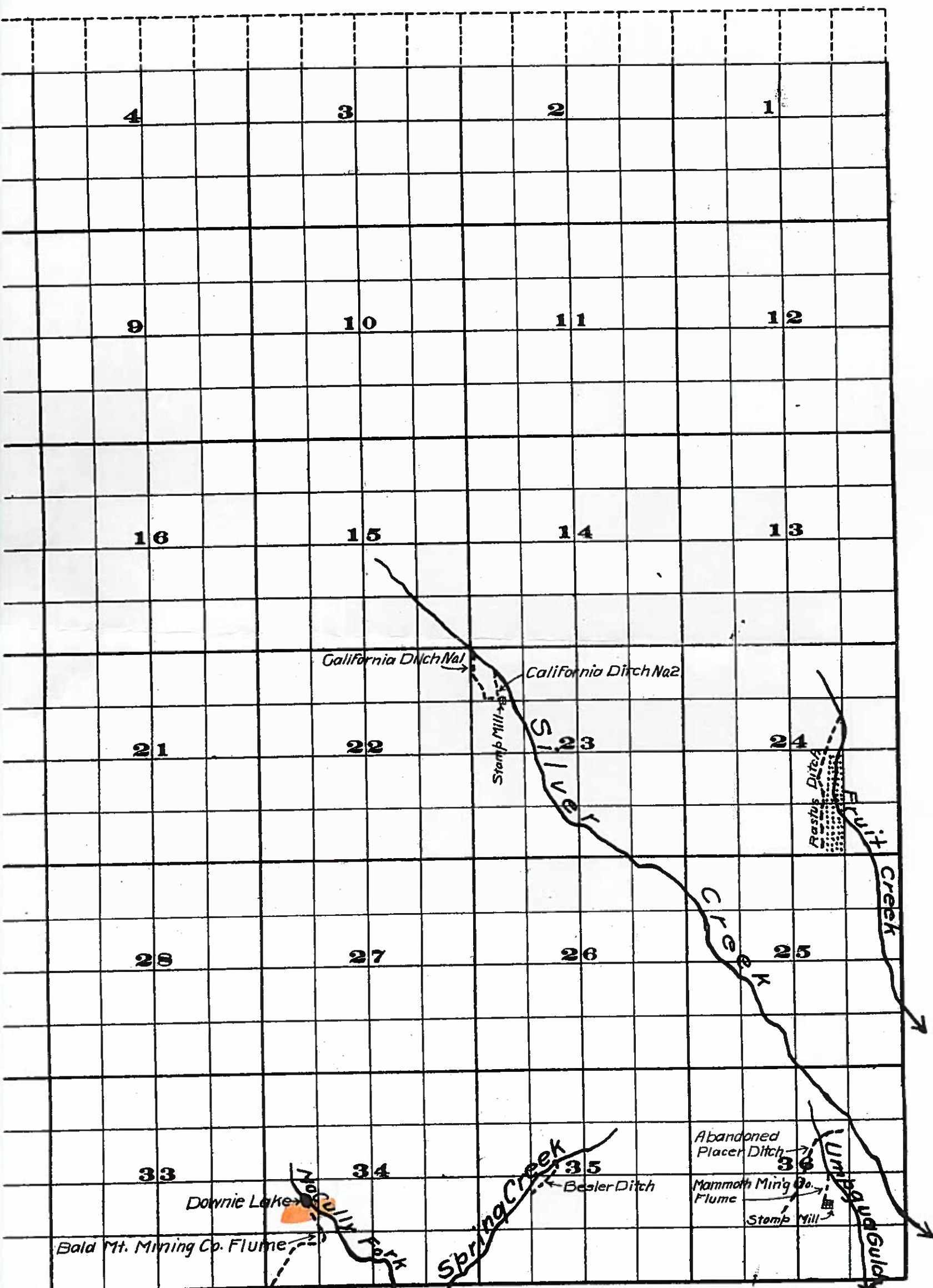

FROM OFFICE OF THE STATE ENGINEER, SALEM, OREGON



et.

Powder River Adjudication  
 John H. Lewis State Engineer  
 Examined June 6 1912