

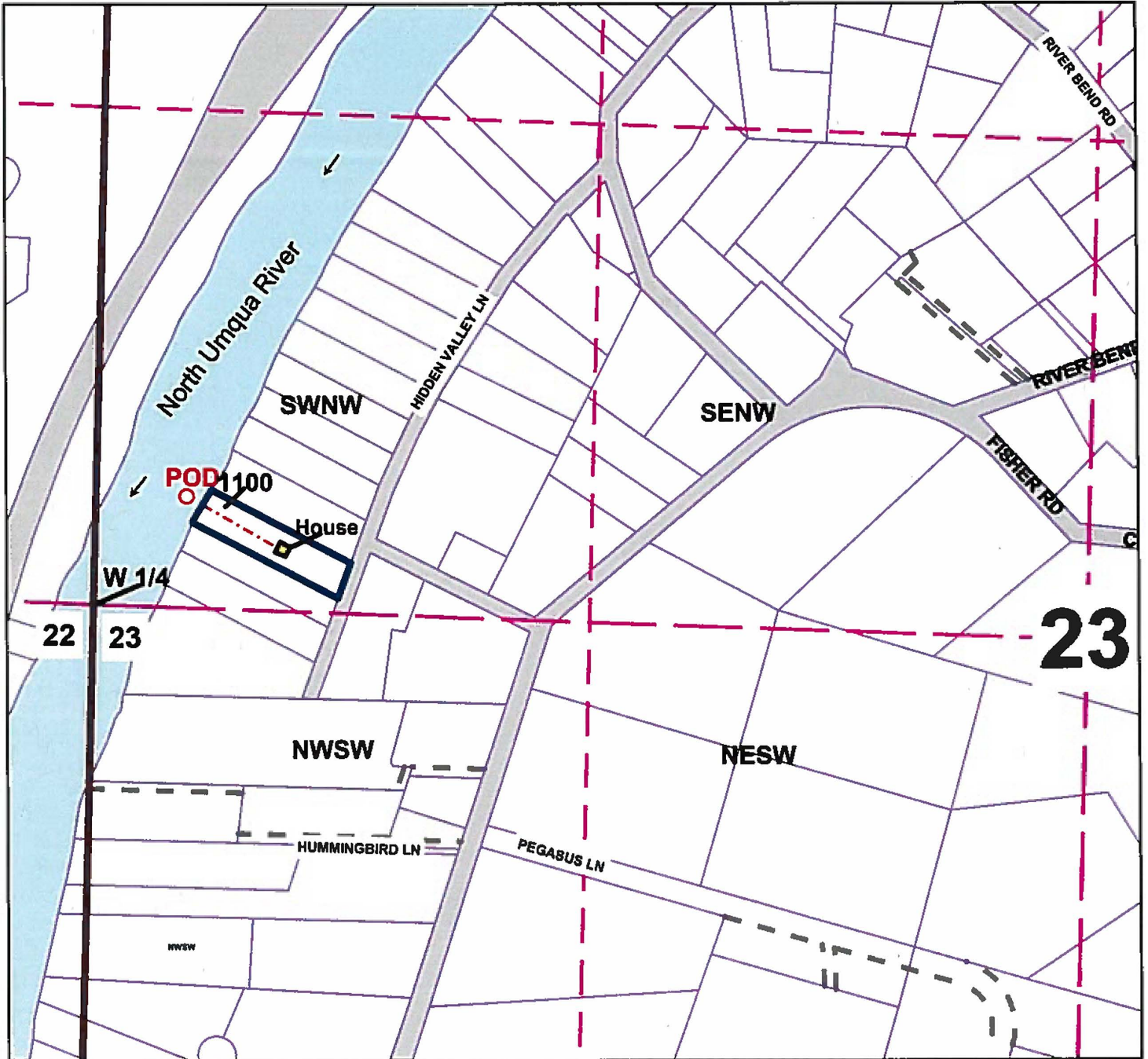

**Surface Water Application**  
**Kimoto**  
**T.26S R.6W Section 23 SWNW**  
**Douglas County**  
Scale: 1"= 400'

E-RECEIVED  
December 14, 2020  
OWRD



**Point of Diversion is 276 ft North and 220 ft East  
of the W 1/4 Section Corner of 23**

The purpose of this map is to identify  
the location of a water right.  
Not intended to show property ownership.