

GROUND WATER APPLICATION MAP
 FOR
 LAURIE & MICHAEL LEROUX
 UMATILLA COUNTY, OREGON
 S 1/2, SE 1/4, NE 1/4, SEC 29, T5N, R29E WM

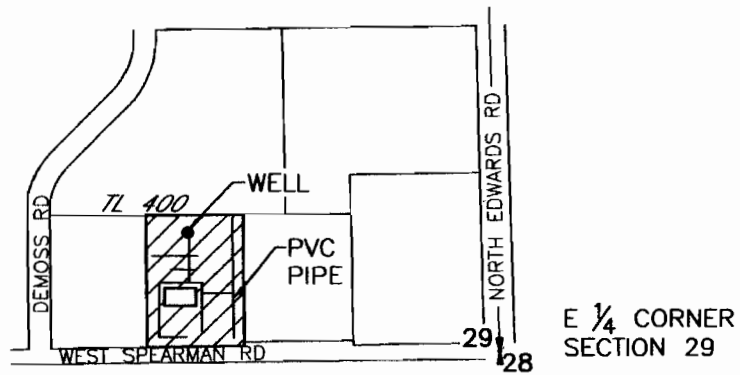

2.0ac AREA TO BE IRRIGATED

WELL LOCATED 280'N AND 690'W
 FROM THE E 1/4 CORNER SECTION 29

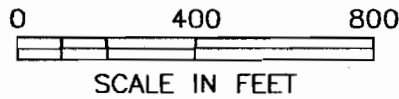
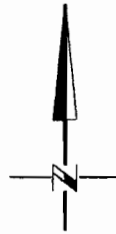

RECEIVED

MAY 29 2007

WATER RESOURCES DEPT
 SALEM, OREGON

NOTE:
 THE PURPOSE OF THIS MAP IS TO IDENTIFY THE APPROXIMATE LOCATION
 OF THE WATER RIGHT. IT IS NOT INTENDED TO PROVIDE INFORMATION
 RELATIVE TO THE LOCATION OF PROPERTY OWNERSHIP BOUNDARY LINES.

DRAWING: H:\CAD\AG\3522\LEROUX.DWG
 PRINTED BY: Roger.Ward on 05/21/07 06:13 AM

SCM Consultants, Inc.
 A Tetra Tech Company