

STATE OF OREGON
COUNTY OF BAKER
CERTIFICATE OF WATER RIGHT

This Is to Certify, That EARL and WILMA SUITTER

of Box 6, Durkee , State of Oregon , has made proof to the satisfaction of the STATE ENGINEER of Oregon, of a right to the use of the waters of Manning Creek

a tributary of Burnt River for the purpose of irrigation of 9.0 acres

under Permit No. 30056 of the State Engineer, and that said right to the use of said waters has been perfected in accordance with the laws of Oregon; that the priority of the right hereby confirmed dates from September 21, 1964

that the amount of water to which such right is entitled and hereby confirmed, for the purposes aforesaid, is limited to an amount actually beneficially used for said purposes, and shall not exceed 0.225 cubic foot per second

or its equivalent in case of rotation, measured at the point of diversion from the stream. The point of diversion is located in the NE $\frac{1}{4}$ SW $\frac{1}{4}$, Section 35, T. 11 S., R. 43 E., W. M. Diversion point located: 3440 feet South and 4500 feet East from N $\frac{1}{4}$ Corner, Section 34.

The amount of water used for irrigation, together with the amount secured under any other right existing for the same lands, shall be limited to one-fortieth of one cubic foot per second per acre, or its equivalent for each acre irrigated and shall be further limited to a diversion of not to exceed 3 acre feet per acre for each acre irrigated during the irrigation season of each year,

and shall conform to such reasonable rotation system as may be ordered by the proper state officer.

A description of the place of use under the right hereby confirmed, and to which such right is appurtenant, is as follows:

6.8 acres SW $\frac{1}{4}$ NE $\frac{1}{4}$
0.1 acre SE $\frac{1}{4}$ NE $\frac{1}{4}$
0.5 acre NE $\frac{1}{4}$ SE $\frac{1}{4}$
1.6 acres NW $\frac{1}{4}$ SE $\frac{1}{4}$
Section 34
T. 11 S., R. 43 E., W. M.

The right to the use of the water for the purposes aforesaid is restricted to the lands or place of use herein described.

WITNESS the signature of the State Engineer, affixed

this date. June 16, 1970

CHRIS L. WHEELER

State Engineer

P.T.S. - 1969 W
 October 18, 1969
 L. E. G.

Abstract of Permit No. ³⁰⁰⁵⁶ ~~30056~~

Application No. ~~40097~~

Certificate No.

Name

~~Frank ...~~ ~~Box 151~~ → ^{Wilma} Earl & A Switter

Address

~~... Oregon~~

Box 6
 Durkee, Oreg. 97905

Source of water supply

Hanging Creek, trib. Burnt River

Use

Irrigation of 9.0 acres

Point of diversion

~~1120' S. & 520' W. from center Sec. 35, being within NE SW, Sec. 35, T. 11 S., R. 43 E., N.M., in the county of Baker~~

Number of acres

Div. Pt. located: 3440 ft S. & 4500 ft E. from N 1/4 cor. ✓

DESCRIPTION OF LAND TO BE IRRIGATED OR PLACE OF USE

Sec 34

Twp.	Range	Sec.	NE 1/4				NW 1/4				SW 1/4				SE 1/4				
			NE 1/4	NW 1/4	SW 1/4	SE 1/4	NE 1/4	NW 1/4	SW 1/4	SE 1/4	NE 1/4	NW 1/4	SW 1/4	SE 1/4	NE 1/4	NW 1/4	SW 1/4	SE 1/4	
11S	43E	34			7.5												1.5		
																			Found
		34	SW 1/4	NE 1/4															6.8
			SE 1/4	NE 1/4															0.1
			NE 1/4	SE 1/4															0.5
			NW 1/4	SE 1/4															1.6
																			9.0

Priority date

September 21, 1964 ✓

Amount of water

0.225 c.f.s. measured at point of diversion

Time limit to begin construction

~~February 10, 1965~~

Time limit to complete construction

~~10-1-66~~ extended to extended to

Time limit to completely apply water

~~10-1-67~~ extended to extended to

Remarks: This appropriation shall be limited to 1/40th of one cubic foot per second or its equivalent for each acre irrigated and shall be further limited to a diversion of not to exceed 3 acre feet per acre for each acre irrigated during the irrigation season of each year, and shall be subject to such reasonable rotation system as may be ordered by the proper state officer.

Basin 9, Vol. 1

9.4

Info: Mr. Earl Saiter

Irrigation: Main Ditch from Middle Div. Pt. flows Northward along East side of field, then West along North edge of field, and Southward along West edge of field (along fence) and empties back into Manning Creek.

Flooding occurs from the West side ditch to the East, also Southward from North ditch. General slope of field is South, approx. 2%

Ditches: Main  Slope - 2%

Lateral  Slope - 2%

Crops: Hay & Pasture

Tie: To N. $\frac{1}{4}$ Cor. Sec. 34 also to S.E. cor Sec. 35

Div. Pt. A half circle steel flume, 18" diam. 12' long diverts water directly from bed of Creek, into main ditch.

Oct. 18, 1969, R. E. Gould
Field Engineer

T.11 S., R.45 E.W.M.

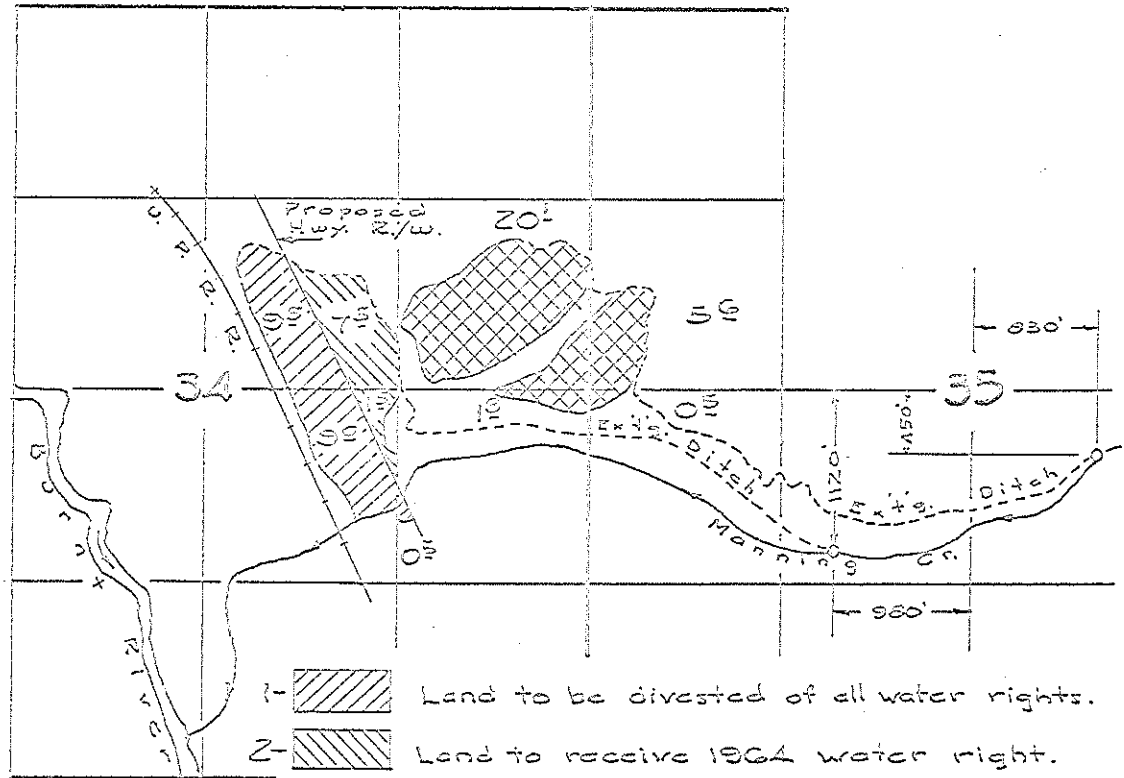

- 1- [diagonal lines] Land to be divested of all water rights.
- 2- [diagonal lines] Land to receive 1964 water right.
- 3- [cross-hatch] Land to receive 1879 water right.

Note: The 1879 water is transferred from lands 1 & 2 to 3.

MAP TO ACCOMPANY APPLICATION OF

FRED BUSS

DURKEE, ORE.

BAKER COUNTY

March, 1964

Scale 4" = 1 Mile

Note:

This map prepared from aerial photographs

David B. Hall

Watermaster, Dist. 8

Application No 40297
Permit No, 30056

T. 11 S., R. 43 E.W.M.

RECEIVED
SEP 21 1964
STATE ENGINEER
SALEM, OREGON

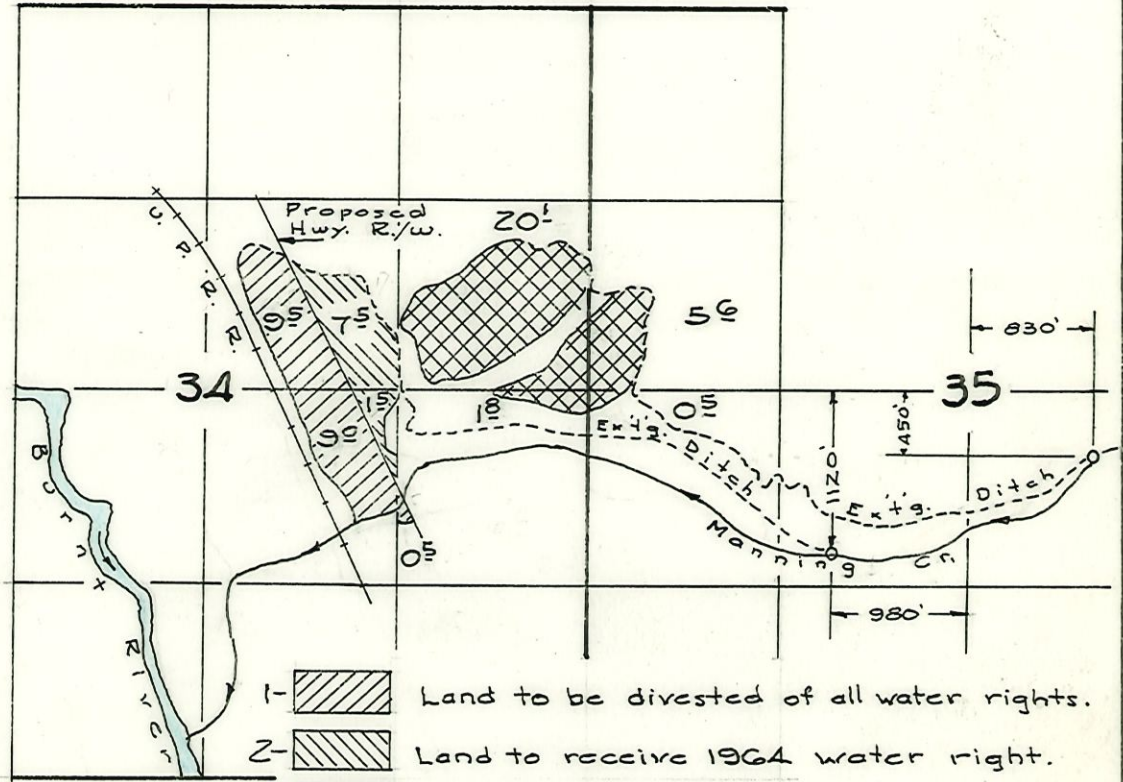

- 1- [diagonal lines] Land to be divested of all water rights.
- 2- [horizontal lines] Land to receive 1964 water right.
- 3- [cross-hatch] Land to receive 1879 water right.

Note: The 1879 water is transferred from lands 1 & 2 to 3.

MAP TO ACCOMPANY APPLICATION OF

FRED BUBB

DURKEE, ORE.
March, 1964

BAKER COUNTY
Scale 4" = 1 Mile

Note:
This map prepared from aerial photographs
David B. Hall
Watermaster, Dist. 8

Application No. 40297
Permit No. 30056

41359
40297
43207
B-148

March 25, 1970

Earl and Wilma Switter
Box 6
Durkee, Oregon 97905

Dear Sir and Madam:

Enclosed are the final proofs in connection with your permits numbered 30056, 30895 and 32301, and also your transfer number B-148.

The data contained in the proofs, which is based on an inspection and survey of your project made by a representative of this department, defines the extent to which your water right has been completed within the terms of your permit and transfer number B-148. The proofs should be dated and signed by you and returned to this office.

Upon receipt of the proofs, properly executed and accompanied by the statutory recording fee of \$3, certificates of water rights will be issued confirming the right thereunder and, after being recorded in the county records, will be forwarded to you.

Very truly yours,

Myron V. Bish
Assistant

MVB:cjs

Enclosures

B-148
41359
40297
43207

March 3, 1967

Karl Suitter
Box 6
Durkee, Oregon

Dear Sir:

This will acknowledge receipt of your returned application No. 43207 and the map.

If you intend to irrigate from October 1 to March 31 of each year on lands that now have existing rights for irrigation during the summer months, then the map and the number of acres to be irrigated in each forty must agree with the location of these lands, as shown in the earlier rights.

The map, which you submitted, does not now agree to the location of the lands irrigated with the older rights. The application map is made a permanent part of the record, and should therefore, be a more durable quality of tracing paper, if at all possible. The area to be irrigated should be more clearly defined by cross-hatching as shown on Page 8 of the enclosed booklet of Rules and Regulations.

I am returning your application and the map for correction and completion. The application is endorsed so that in order to retain its date of priority, it must be returned on or before May 3, 1967.

Very truly yours,

CHRIS L. WHEELER
State Engineer

By
Larry W. Jebousek
Assistant

LWJ:dly
Enclosures

September 29, 1966

Earl and Wilma Switter
Box 6
Durkee, Oregon

Dear Sir and Madam:

Enclosed is the assignment of permit No. 30056 from Fred D. and Emma Bubb to you. This has been recorded in the Miscellaneous Records of the State Engineer, Volume 4, page 843, and our records have been changed accordingly.

Also enclosed is our receipt No. 945 covering the recording fee of \$1.00.

Very truly yours,

CHRIS L. WHEELER
State Engineer

By
Myron V. Bish
Assistant

MVB:pju

Enclosures

September 13, 1966

Earl Suitter
Box 6
Durkee, Oregon 97205

Dear Sir:

This will acknowledge receipt of your notice of complete application of water in regards to permit No. 30056.

If you are the legal owner of the property in connection with this permit, then you should obtain an assignment of the permit from Fred Bubb.

Enclosed is a form with the proper application and permit numbers entered for your use. The form when completed, should be submitted to this office along with one dollar for recording fees.

Pursuant to your report and in line with the general practice of this office, a survey will be made at a later date. After this survey, proof may be made and a certificate issued covering the actual use of water as found by the engineer. In case of irrigation, any lands described in the permit that have not been irrigated will be automatically eliminated from the water right.

Very truly yours,

CHRIS L. WHEELER
State Engineer

By
Myron V. Bish
Assistant

MVB:pju

Enclosure

RECEIVED
SEP 13 1966
STATE ENGINEER
SALEM OREGON

Dusky, Oregon
Sept 10, 1966

Dear Sir:

I have purchased some property from Fred Bubb
and in cleaning up the papers on this property I find
this form for appropriation of public waters.

Since I am the new owner of the land
which this covers, I am filing this form in
my name.

Please let me know if there is any additional work
required to complete this application.

Sincerely
Earl Sutter

40297, permit No. 30056 with blue print.

Dear Sir:

Fred Bubb
Route 2, Box 191
Ontario, Oregon

March 4, 1965

40297

October 7, 1964

Mr. Fred Bubb
Route 2 Box 191
Ontario, Oregon

Dear Sir:

This will acknowledge your application for a permit to appropriate 0.23 cubic feet of water per second from Manning Creek, for the irrigation of 9 acres, and application for a change in place of use and point of diversion of water under water right certificate No. 5970, accompanying tracing and fees in the sum of \$30 for which receipts No. 2637 and 2638 are enclosed.

Your application for a permit to appropriate water from Manning Creek has been examined and filed under file No. 40297. Your application will be considered for approval by issuance of a permit with the next group.

Your application for permission to change the place of use and point of diversion under the existing water right has been filed under file No. B-148, and referred to the transfer section of this office. You will be advised of further action regarding your transfer application.

Very truly yours,

CHRIS L. WHEELER
State Engineer

By
Walter N. Perry, Assistant

WNP:kjc
Enclosures