

RECEIVED

FEB 11 2021

OWRD

T8S R40E WM

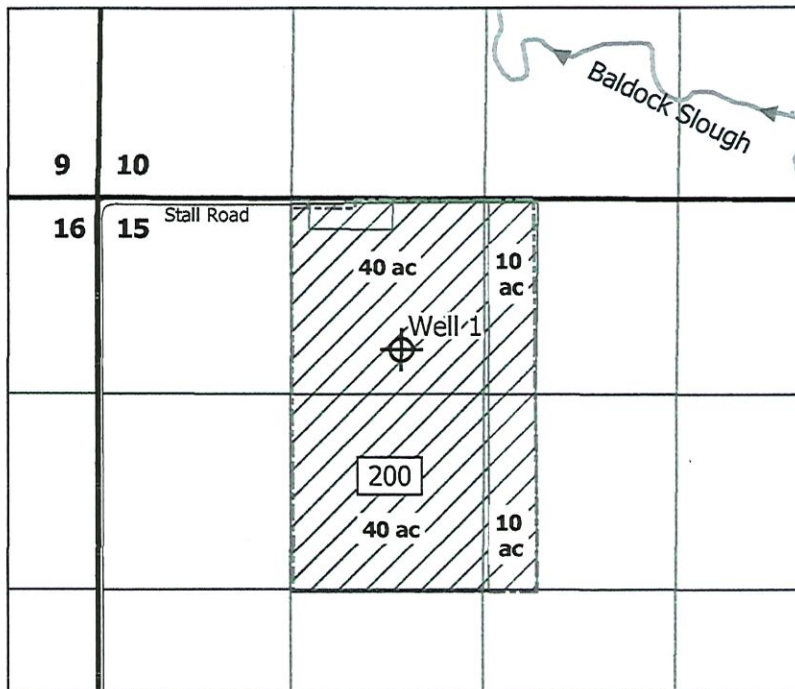

LEGEND

⊕ Well 1

▨ Proposed Place of Use

⊠ Baker County Taxlot Boundary 200



Garvin  
Hydrogeo  
LLC

MAP TO ACCOMPANY GROUNDWATER  
PERMIT APPLICATION  
BAKER COUNTY, OREGON

Prepared on behalf of Scott A. Brady



1 inch = 1,320 feet

Drawn by: Paul F. Garvin, R.G. C.W.R.E.  
Date: 2/2/21

Notes:  
Well 1 location: within a 100 ft radius of 2,080 feet east and 1,020 feet south  
from the NW Corner of Section 15

This map is not intended to provide legal dimensions or locations of property  
ownership lines.