

# FINAL PROOF SURVEY MAP

## IN THE NAME OF LOSHBAUGH INCORPORATED

APPLICATION R-73022

PERMIT R - 12106

APPLICATION S-73023

PERMIT 53001

SECTIONS 1 & 12, TOWNSHIP 30 SOUTH, RANGE 15 WEST, W.M.

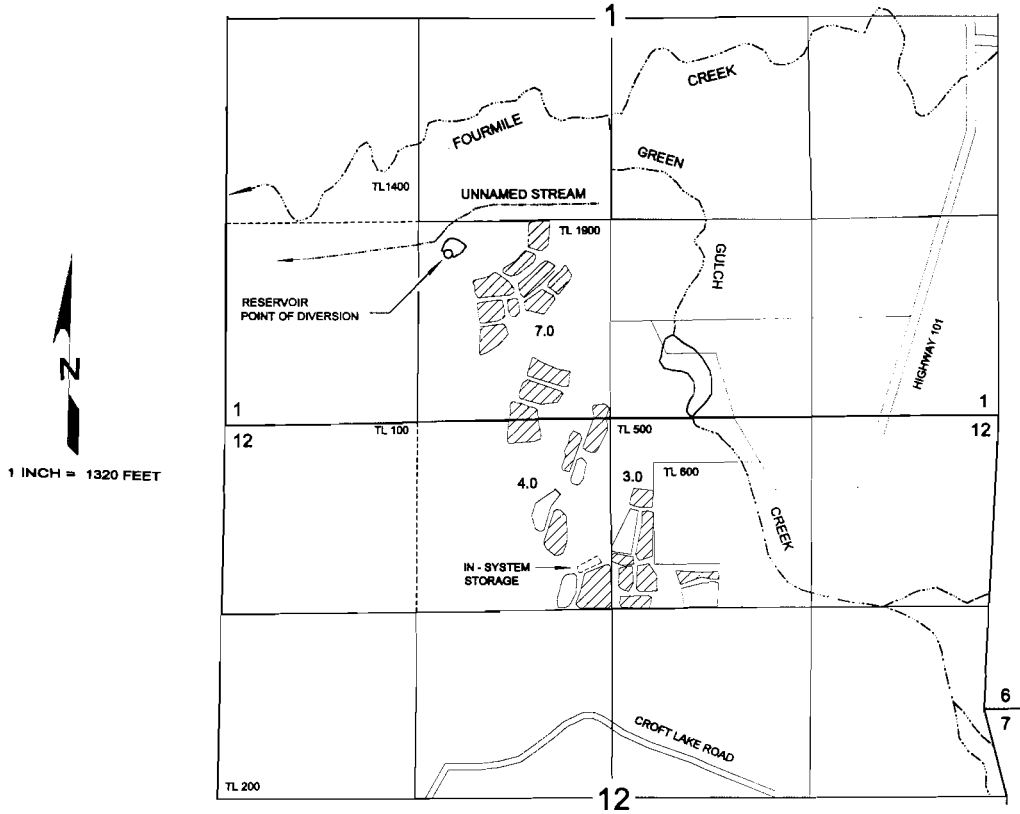

THE RESERVOIR POINT OF DIVERSION IS LOCATED 1110 FEET NORTH AND 1130 FEET WEST FROM THE SOUTH QUARTER CORNER OF SECTION 1; BEING WITHIN THE SE $\frac{1}{4}$  SW $\frac{1}{4}$  OF SECTION 1, TOWNSHIP 30 SOUTH, RANGE 15 WEST, W.M.; COOS COUNTY.

RECEIVED

MAR 15 1987

WATER RESOURCES DIVISION  
STATE OF OREGON

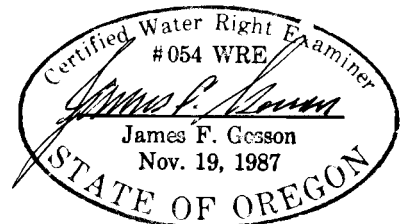

THE PURPOSE OF THIS MAP IS TO IDENTIFY THE LOCATION OF THE WATER RIGHT. IT IS NOT INTENDED TO PROVIDE INFORMATION RELATIVE TO THE LOCATION OF PROPERTY OWNERSHIP BOUNDARY LINES.