

RECEIVED

MAR 18 2021

OWRD

Reference Corner:
South 1/4 Corner Section 32,
T2S R45E W.M.

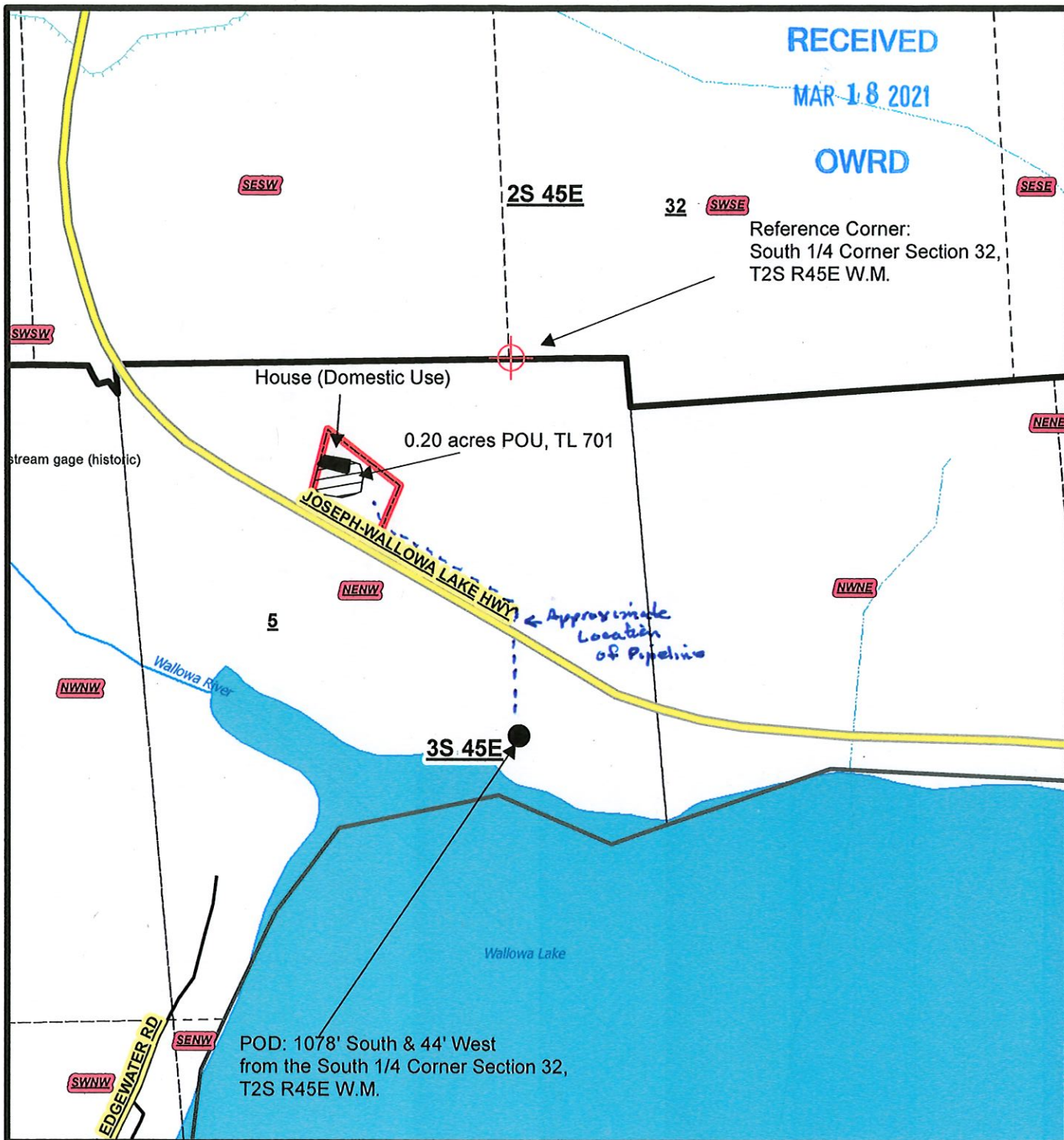









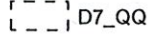
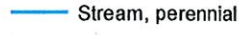
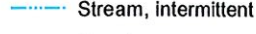

LOT 701 Newton Application Map: Domestic & 0.20 acre irrigation, Source: Wallowa Lake Reservoir

Map Disclaimer:

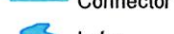
This product is for informational purposes and may not have been prepared for, or be suitable for legal, engineering, or surveying purposes. Users of this information should review or consult the primary data and information sources to ascertain the usability of the information. This map is not intended to display property lines

Disclaimer: This listing is the result of a manual search of the records of the Watermaster's Plat Cards and the WRIS database. The listing has not been field checked. That a right is of record is no guarantee that it has not been abandoned under the conditions of ORS 540.610. The plat card records of listed by the 40.0 acre quarter-quarter within a section. If the water right listed within a quarter-quarter is on more than one tax lot, this office has not itemized that water rights for each tax lot - only a survey could accurately depict how much of the water rights are on each tax lot.

-  POU_TL701
-  TL701
-  D7_TWP
-  D7_SEC
-  D7_QQ
-  Stream, perennial
-  Stream, intermittent
-  Canal
-  Connector
-  Lake
-  HWY
-  RD



Scale 1in=400ft

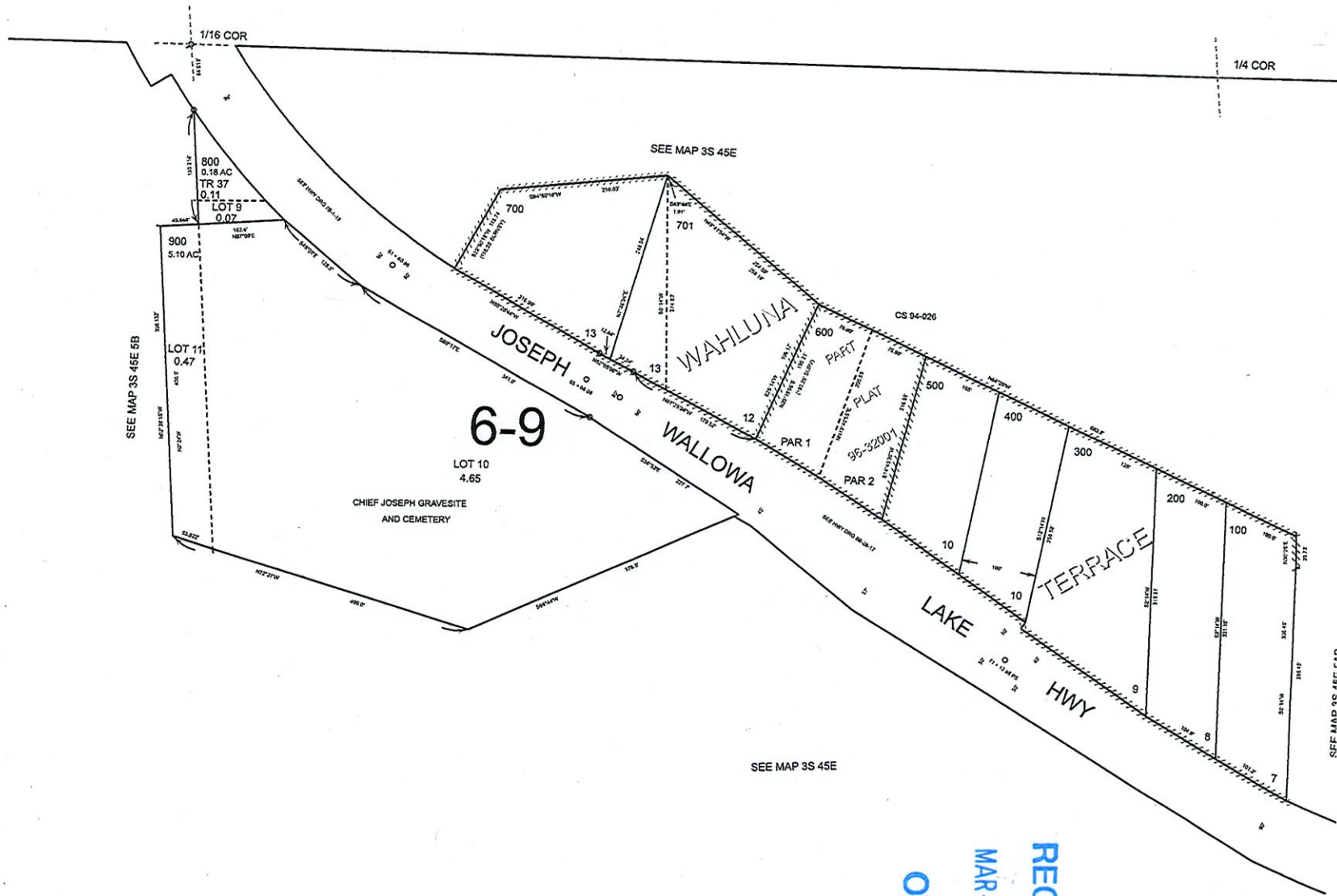

SEE MAP 3S 45E 5B

SEE MAP 3S 45E

SEE MAP 3S 45E

SEE MAP 3S 45E 5A

RECEIVED
MAR 18 2021
OWRD