

Name Douglas Bell Watts
By
Address 700 South Date Ave.
Alhambra, CA 91303

Application No. G **G10372**
Permit No. G **G 9636**
Certificate No. **64022**

Stream Index, Page No. *15-114*

FEES PAID		
Date	Amount	Receipt No.
6-12-81	30.00	24530
Cert. Fee		

Date filed June 12 1981
Priority *June 12, 1981*
Action suspended until *2890 plan*

FEES REFUNDED		
Date	Amount	Check No.

M
Return to applicant
Date of approval MAY 25 1982

ASSIGNMENTS

Date	To Whom	Address	Volume	Page

CONSTRUCTION

Date for beginning MAY 25 1983
Date for completion OCT 1 1983
Extended to
Date for application of water OCT 1 1984
Extended to

REMARKS

CARD FOR A MAY 27 1983

PROSECUTION OF WORK

Form "A" filed *June 8, 1983*
Form "B" filed *" " "*
Form "C" filed *June 8, 1983*

FINAL PROOF

Blank mailed *12-8-89*
Proof received
Date certificate issued FEB 07 1990

STATE OF OREGON,

County of Josephine

} ss.

FORM NO. 23 — ACKNOWLEDGMENT
STEVENS-NESS LAW PUB. CO., PORTLAND, ORE.

BE IT REMEMBERED, That on this 7th day of June, 1983,
before me, the undersigned, a Notary Public in and for said County and State, personally appeared the within
named Wayne M. Smith

known to me to be the identical individual described in and who executed the within instrument and
acknowledged to me that he executed the same freely and voluntarily.

IN TESTIMONY WHEREOF, I have hereunto set my hand and affixed
my official seal the day and year last above written.

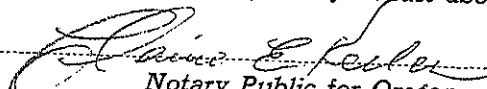
Notary Public for Oregon.
My Commission expires 5/6/86

T. 38 S., R. 7 W., W. M.

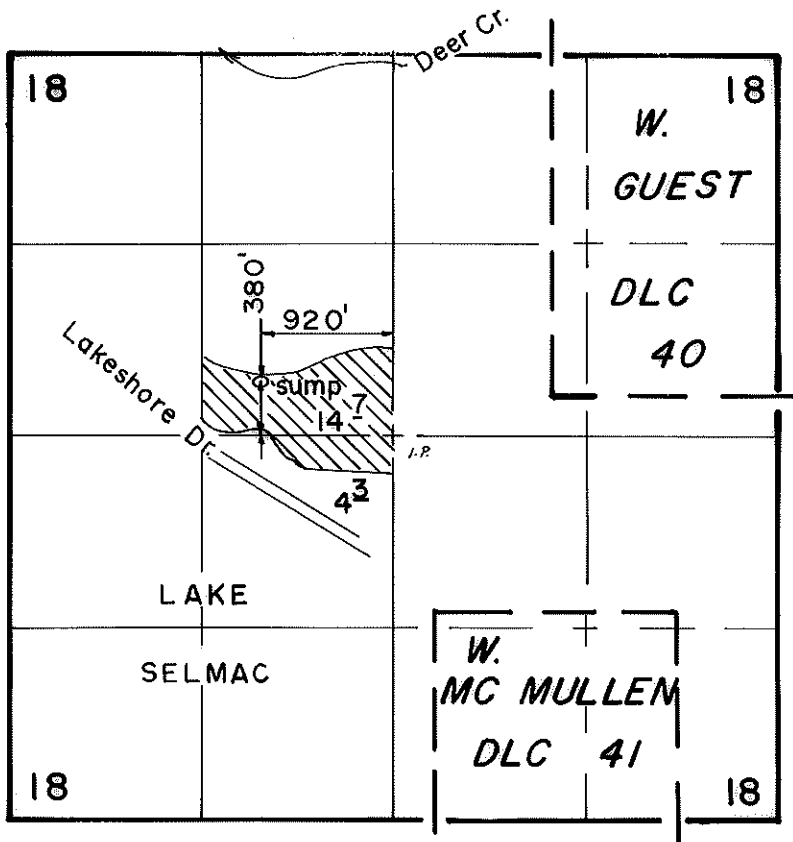

Scale: 1" = 1320'

FINAL PROOF SURVEY
UNDER

Application No. G-10372 Permit No. G-9636
IN NAME OF

DOUGLAS BELL WATTS

Surveyed JUN. 11. 1986, by B. S. JAMES.

T. 38 S., R. 7 W., W. M.

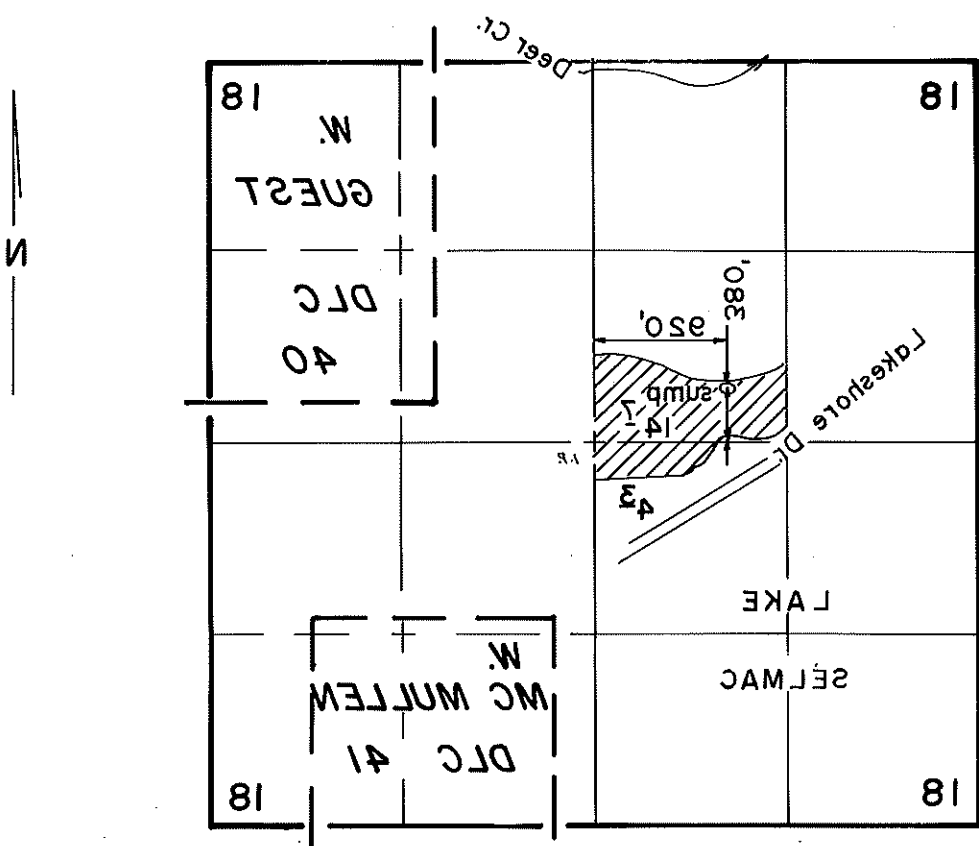

Scale: 1" = 1350'

FINAL PROOF SURVEY
UNDER

Application No. G-10375 Permit No. G-2232
 IN NAME OF
 DOUGLAS BELL WATTS
 Surveyed JUN. 11. 1886 by B. S. JAMES

STATE OF OREGON
COUNTY OF JOSEPHINE
PROPOSED CERTIFICATE OF WATER RIGHT

THIS CERTIFICATE ISSUED TO

DOUGLAS BELL WATTS
P.O. BOX 159
SELMA, OREGON 97538

confirms the right to use the waters of A SUMP in the DEER CREEK BASIN for the purpose of IRRIGATING 19.0 ACRES.

The right has been perfected under Permit G-9636. The date of priority is JUNE 12, 1981. The right is limited to not more than 0.24 CUBIC FOOT PER SECOND or its equivalent in case of rotation, measured at the sump.

The sump is located as follows:

SE 1/4 NW 1/4, SECTION 18, T 38 S, R 7 W, W.M.; 380 FEET NORTH AND 920 FEET WEST FROM THE CENTER 1/4 CORNER OF SECTION 18.

The amount of water used for irrigation, together with the amount secured under any other right existing for the same lands, shall be limited to ONE-EIGHTIETH of one cubic foot per second per acre, or its equivalent for each acre irrigated and shall be further limited to a diversion of not to exceed 2.5 acre-feet per acre for each acre irrigated during the irrigation season of each year, and shall be further limited to appropriation of water only to the extent that it does not impair or substantially interfere with existing surface water rights of others.

The right shall conform to such reasonable rotation system as may be ordered by the proper state officer.

A description of the place of use under the right, and to which such right is appurtenant, is as follows:

SE 1/4 NW 1/4 14.7 ACRES
NE 1/4 SW 1/4 4.3 ACRES
SECTION 18
TOWNSHIP 38 SOUTH, RANGE 7 WEST, W.M.

The right to the use of the water for the above purpose is restricted to beneficial use on the lands or place of use described.

G-10372



179-194R

Abstract of Permit

This is to certify that I have examined APPLICATION G-10372 and do hereby grant the same SUBJECT TO EXISTING RIGHTS and the following limitations and conditions:

P.O. Box 159, SELMA, OR, 97538 (10-84)

This permit is issued to Douglas Bell Watts of 700 South Date Avenue, Alhambra, California-91803, phone (213) 283-1898, for the use of the waters of a sump well, for the PURPOSE of irrigation; that the PRIORITY OF THE RIGHT dates from June 12, 1981, and is limited to the amount of water which can be applied to beneficial use and shall not exceed 0.28 cubic foot per second measured at the point of diversion from the well, or its equivalent in case of rotation with other water users.

0.24 C.F.S.

The well is to be LOCATED: ^{380'} ~~46~~ feet North and ^{920'} ~~1,420~~ feet East from the ^{W.} ~~W~~-1/4 Corner of Section 18, being within the SE 1/4 NW 1/4 of Section 18, Township 38 South, Range 7 West, WM, in the County of Josephine.

4/10/83-179-194R
6-11-86 BSL

A description of the PLACE OF USE under the permit, and to which such right is appurtenant, is as follows:

Township 38 South	Range 7 West, WM	Section 18	SE 1/4	NW 1/4	11.0 acres	14 ² ACRES
			NE 1/4	SW 1/4	11.0 acres	4 ³ ACRES
					TOTAL - 19 ² ACRES	

The AMOUNT OF WATER used for irrigation, together with the amount secured under any other right existing for the same lands, shall be limited to 1/80 of one cubic foot per second per acre, and shall be further limited to a diversion of not to exceed 2.5 acre-feet per acre for each acre irrigated during the irrigation season of each year, and shall be further limited to appropriation of water only to the extent that it does not impair or substantially interfere with existing surface water rights of others, and shall conform to such reasonable rotation system as may be ordered by the proper state officer.

The well shall be constructed in accordance with the General Standards for the Construction and Maintenance of Water Wells in Oregon.

The works constructed shall include an air line and pressure gauge or an access port for measuring line, adequate to determine water level elevation in the well at all times.

The permittee shall install and maintain a weir, meter, or other suitable measuring device, and shall keep a complete record of the amount of ground water withdrawn.

Actual construction work shall begin on or before May 25, 1983 and shall thereafter be prosecuted with reasonable diligence and be completed on or before October 1, 1983.

Complete application of the water to the proposed use shall be made on or before October 1, 1984.

WITNESS my hand this 25th day of May, 1982.

C-13837 (BHK)
 C-13888 (F-58)
 C-13891 (J-89)
 R-5552

WATER RESOURCES DIRECTOR

R-27051

Abstract of Permit

INFO.: SAME OWNER & ADDRESS AS APPLIED. MAILING ADDRESS
ALSO P.O. BOX 159, SELMA, OR 97538.

REPRESENTATIVE MR. SMITH, CARETAKER, SHOWED US
SYSTEM FOR MR. WHITS.

SOURCE: SUMP WELL

SYSTEM: PUMP DIRECT FROM SUMP THRU BURIED MAIN WITH
RISERS USES 3" ALUM LATERAL AND FLEX HOSE TO
1 GUN SPRINKLER.

DIVERSION: SUMP 60' DIA. X 6' DEEP. EXCAVATED BY
DIAG LINE.

PUMP: STA-RITE 3" X 2" CENT

BALDOR INDUSTRIAL ELECT. MOTOR - 10HP @ 3450 RPM

EQUIPMENT: 4" PVC MAIN LINE ± 1100'
3" ALUM LATERAL ± 160'
3" FLEX HOSE ± 50'
1 RUN GUN MODEL 1020H
.75 NOZZLE DIA. ± 19.1 M.M.

$$\frac{10(6^2)}{203^2 + 8} = 0.31 \text{ cfs}$$

MAX. USE: 1 GUN.

An Rainbird chart
 $\frac{19}{80} = 0.24 \text{ cfs}$
 $\frac{145 \text{ gpm}}{4150} = 0.32 \text{ cfs}$

LIFT: SUCTION: 8'
DISCHARGE: ± 0'

USE: PASTURE FOR DOZEN CATTLE

TIE: 41833-179-194R

Blue Jumbo HOSE 6-1186

NOTE:

C/A	COR	1 1/4" I.P
Sec	18	1 B.T.'S

REMARKS: AREA NOT INCLUDED IS NOT CLEARED OR IRRIGATED,

AREA IS COVERED WITH NATURAL BRUSH AND TREES

JUL 12 1961
WATER RESOURCES DEPT
SALEM, OREGON

*4 1/2 miles
w/ 2 users
floor hose with gun*

1" = 400'

SEE MAP 38 7 7



CANCELLED T.L.
701
1000
1001
101
790
200
190
103

*PASTURE
CATTLE - 1200*

*EXCAVATED
DEPTH UNKNOWN
ESTIMATED @ 6'*

*SEE ATTACHED
SURVEY MAP*

SEE MAP 38 8 13

SEE MAP 38 7 17

Application No. G 10372
Permit No. G 9636

SEE MAP 38 7 19

RECEIVED

APR 30 1962
WATER RESOURCES DEPT
SALEM, OREGON

IMPORTANT—This form is a notice to the Water Resources Director that permittee is ready to make final proof to the extent to which the water has actually been applied to the intended use under the terms of the permit. Permittee is cautioned that Certificate of Water Right will be issued based on the extent of the quantity and use as determined by the final proof inspection and survey which will be made in response to the filing of this Form C.

NOTE: In the case of an irrigation permit, this Form C should not be mailed to the Water Resources Department until all of the land described in the permit, which it is intended to irrigate under this permit at any time, has actually been irrigated.

Fill out, detach and mail to the Water Resources Department, Salem, OR 97310, when all of the water has been applied.

RECEIVED JUN 3 1983 WATER RESOURCES DEPT. SALEM, OREGON

Application No. G10372

NOTICE OF COMPLETE APPLICATION OF WATER TO A BENEFICIAL USE

I, [Redacted], the holder of Permit No. G9636, to appropriate the public waters of the state of Oregon, completely applied the waters to a beneficial use in accordance with the terms of said permit, on the 7 day of JUNE, 1983

Remarks: _____

IN WITNESS WHEREOF, I have hereunto set my hand this 7 day of June, 1983.

[Signature] (Signature of Applicant)

2600 Lake Street Dr. (Address)

Application No. G10372

NOTICE OF COMPLETION OF CONSTRUCTION

I, [Redacted], the holder of Permit No. G9636, to appropriate the public waters of the state of Oregon, completed the construction of the works described therein on the 7 day of JUNE, 1983.

Remarks: HAVE INSTALLED A 10HP 200GPM CENTRIFUGAL PUMP. If the works have less capacity than described in the permit, or you have definitely abandoned part of the proposed development, you should so state in order that our records may not be unnecessarily encumbered.

IN WITNESS WHEREOF, I have hereunto set my hand this 7 day of June, 1983.

[Signature] (Signature of Applicant)

Same (Address)

Fill out, detach and mail to the Water Resources Department, Salem, OR 97310, when construction work is completed.

Application No. G10372

NOTICE OF BEGINNING OF CONSTRUCTION

I, [Redacted], the holder of Permit No. G9636, to appropriate the public waters of the state of Oregon, began the actual construction of the works described therein on the 8th day of MAY, 1982.

Remarks: HAVE INSTALLED 1200' 4" PVC MAIN LINES IN GROUND.

INSTALLED SMALL MOBILE PUMP. GUNA INSTALLED ELECTRIC SERVICE TO PUMPING SITE. The appropriator must state the manner of beginning of construction, the amount of work completed and the type of equipment acquired for the water system up to the date of this statement, and any additional information which shows a substantial beginning of construction as authorized by your permit.

IN WITNESS WHEREOF, I have hereunto set my hand this 7 day of June, 1983.

[Signature] (Signature of Applicant)

Same (Address)

Fill out, detach and mail to the Water Resources Department, Salem, OR 97310, when construction work is begun.

OK 7/83

OK 7/83

OK 7/83



Water Resources Department

MILL CREEK OFFICE PARK

555 13th STREET N.E., SALEM, OREGON 97310

PHONE

File Number G-10372

June 10, 1983

Douglas Bell Watts
700 South Date Ave.
Alhambra, CA 01803

File No.

COPY

This will acknowledge receipt of your notice to the effect that complete application of water has been made under permit number ^{G-9636}

Pursuant to your report and in line with the general practice of this office, a survey will be made at a later date.

After this survey, proof may be made and certificate issued covering the actual use of water as found by the engineer. In case of irrigation, any lands described in the permit that have not been irrigated will be automatically eliminated from the water right.

In the meantime, the permit which you hold will be valid evidence of the water right in question so long as you continue to use the water.

Sincerely,

Bruce A. Estes, Supervisor
Survey-Certificate Section
Water Rights Division

Form 690-10-128 supporting data are enclosed to be kept in your records.--

STATE OF OREGON
ROUTE SLIP

Date April 28, 1982

TO: Steve Brown
Water Rights Division

FROM: Watermaster District #14

- CHECK Approval Investigate
 Necessary Action Confer
 Prepare Reply Per Telephone Conversation
 My Signature For Your Information
 Your Signature As Requested
 Initial and Return Note and File
 Return With More Details

RECEIVED

APR 30 1982

WATER RESOURCES DEPT
SALEM, OREGON

COMMENTS: Your letter of 4-7-82

The applicants were in this office today for assistance in making corrections. The corrections are based on the information they gave. Hope this will do it.

Application No. G 10372

Permit No.

STATE OF OREGON WATER RESOURCES DEPARTMENT

Application for a Permit to Appropriate Ground Water

RECEIVED JUN 12 1981 WATER RESOURCES DEPT SALEM, OREGON

I, DOUGLAS BELL WATTS (Name of Applicant)

of 700 SOUTH DATE AVE., ALHAMBRA (Mailing Address) (City)

State of CALIFORNIA 91803 Phone No. 213-283-1888 do hereby (Zip Code)

make application for a permit to appropriate the following described ground waters of the State of Oregon:

1. The development will consist of 1 SUMP WELL (Give number of wells, tile lines, infiltration galleries, etc.)

having a diameter of 50-20' and an estimated depth of 10-1420 feet.

2. The well or other source is to be located 20-110 ft. N and 1120 ft. W (N. or S.) (E. or W.)

from the CENTER W 1/4 corner of SEC. 18 (Public Land Survey Corner)

(If there is more than one well, each must be described)

being within the SE 1/4 of the NW 1/4 of

Sec. 18 Tp. 38 S R. 7 W, W. M., in the county of JOSEPHINE

3. Location of area to be irrigated, or place of use if use other than irrigation.

Township	Range	Section	List 1/4 1/4 of Section	List use and/or number of acres to be irrigated
<u>38 S</u>	<u>7 W</u>	<u>18</u>	<u>SW 1/4 NW 1/4</u>	<u>0.5</u>
			<u>SE 1/4 NW 1/4</u>	<u>110 AC</u>
			<u>NE 1/4 SW 1/4</u>	<u>11 AC</u>

4. It is estimated that feet of the well will require casing. (Kind)

5. Depth to water table is estimated Well drilled by..... (Feet)

20708

6. The amount of water which the applicant intends to apply to beneficial use is ~~3028~~ ²⁰⁷⁰⁸ cubic feet per second or 126 gallons per minute.

7. The use to which the water is to be applied is IRRIGATION

8. If the flow to be utilized is artesian, the works to be used for the control and conservation of the supply when not in use must be described.

9. If the location of the well, or other development work is less than one-fourth mile from a natural stream channel, give the distance to the channel and the difference in elevation between the stream bed and the ground surface at the source of development.

500' THOMPSON CREEK PRTTY LEVEL MAYBE 1'

10.

DESCRIPTION OF WORKS

Include length and dimensions of supply ditch or pipeline, size and type of pump and motor, type of irrigation system to adequately describe the proposed distribution system.

1- 5HP PUMP
1120' 3" MAIN PIPE
2" PIPE FROM MAIN PIPE TO RAINBIRDS 2' PIPE
EVERY 40' TO RAINBIRD

11. Construction work will begin on or before JUNE 1ST 1982

12. Construction work will be completed on or before JUNE 1ST 1983

13. The water will be completely applied to the proposed use on or before JUNE 1ST 1984

14. If the ground water supply is supplemental to an existing supply, identify the supply and existing water right.

Application No. G 10372

Permit No.

Application No. G 10372

Permit No.

PC

Permit to Appropriate the Public Waters of the State of Oregon

This is to certify that I have examined the foregoing application and do hereby grant the same, SUBJECT TO EXISTING RIGHTS INCLUDING THE EXISTING MINIMUM FLOW POLICIES ESTABLISHED BY THE WATER POLICY REVIEW BOARD and the following limitations and conditions:

The right herein granted is limited to the amount of water which can be applied to beneficial use and shall not exceed cubic feet per second measured at the point of diversion from the well or source of appropriation, or its equivalent in case of rotation with other water users, from.....

The use to which this water is to be applied is.....

If for irrigation, this appropriation shall be limited to of one cubic foot per second or its equivalent for each acre irrigated and shall be further limited to a diversion of not to exceed acre feet per acre for each acre irrigated during the irrigation season of each year;

and shall be subject to such reasonable rotation system as may be ordered by the proper state officer.

The well shall be constructed in accordance with the General Standards for the Construction and Maintenance of Water Wells in Oregon.

The works constructed shall include an air line and pressure gauge or an access port for measuring line, adequate to determine water level elevation in the well at all times.

The permittee shall install and maintain a weir, meter, or other suitable measuring device, and shall keep a complete record of the amount of ground water withdrawn.

The priority date of this permit is

Actual construction work shall begin on or before and shall thereafter be prosecuted with reasonable diligence and be completed on or before October 1, 19.....

Complete application of the water to the proposed use shall be made on or before October 1, 19.....

WITNESS my hand this day of....., 19.....

0.28
a sump well
irrigation

1/80
2 1/2
(ground wtr
special -
distrib with
surface wtr)

June 12, 1981

RWA

Remarks:

Enclosed please find an aerial map showing exact location of snags.

Douglas B. W...
Signature of Applicant

This is to certify that I have examined the foregoing application, together with the accompanying maps and data, and return the same for.....correction and completion.....

In order to retain its priority, this application must be returned to the Water Resources Director with corrections on or before.....June 7....., 19..82.....

WITNESS my hand this ...7th... day of...April....., 1982.....

.....James E. Sexson..... Water Resources Director

By *Stephen C. Brown*
Stephen C. Brown

RECEIVED
APR 30 1982
WATER RESOURCES DEPT
SALEM, OREGON

This instrument was first received in the office of the Water Resources Director at Salem, Oregon, on the
...12... day of ...June..., 19 81, at 8:00 o'clock
...A...M.

Application No. *G 10372*

Permit No.....

Ralph

02-5-82

appears that this "bump" is located
120 ft from water stored in a
reservoir called 'Lake Selmae'.

It may be that this water could
be considered GW however more than
not it is stored water being drawn from
the lake.

It may be this should be filed as
SW with a secondary Res. Filing

RP

NO QUESTION ABOUT HYDRAULIC CONNECTION.

PERMIT SHOULD BE CONDITIONED WITH OUR
"DISTRIBUTE WITH SURFACE WATER" CLAUSE

THERE IS NO USE OF WATER FROM LAKE SELMAE
(EXCEPT EVAPORATION) AS IT IS A RECREATION
FACILITY. (DOUBT IF THIS PROPOSED USE
WILL AFFECT W.L. OF THE LAKE.)

378-3066 or
1-800-452-7813
(message line)

April 7, 1982

Douglas Bell Watts
700 South Date Avenue
Alhambra, CA 91803

Dear Mr. Watts:

REFERENCE: File G-10372

Your application describing the use of 3.0 cubic feet of water per second from a sump for the irrigation of 25.9 acres, along with the map, has been reviewed.

The quarter-quarter section in which the sump is located must be described in Item 2.

The application and map should not show acreages or dimensions with approximate figures. The acreage and dimensions to the sump must be shown on the map and be in agreement with Items 2 and 3 of the application.

The legal description of the property where the water will be used is needed to verify the place of use. This may be copied from deed records, title insurance policy or sales contract.

I am returning your application and map for correction and completion. The application is endorsed so that in order to retain its priority date, it must be received in this office on or before June 7, 1982.

Sincerely,

Stephen C. Brown
Senior Water Rights Examiner

SCB:tw
enclosures



Water Resources Department

MILL CREEK OFFICE PARK

555 13th STREET N.E., SALEM, OREGON 97310

PHONE 378-3066 or
1-800-452-7813

June 19, 1981

Douglas Bell Watts
700 South Date Avenue
Alhambra, CA 91803

Dear Mr. Watts:

REFERENCE: File G-10372

We have received your application for use of water for irrigation along with the supporting data and fees. Our Receipt 24530 is enclosed. Your application has been filed and assigned number G-10372.

Because of the many applications which have been filed in recent months, we are temporarily behind in our processing. Your application will be examined in detail as soon as possible. We will contact you if we need any additional information. If a permit is required to satisfy the conditions of a loan or land sale or if other emergency conditions exist, please let us know and we will attempt to process your application in the shortest possible time.

The permit approving your application will be issued without further correspondence if no additional information is required. The proposed appropriation will be subject to existing minimum flows and demands of prior rights during periods of low water.

Thank you for your patience.

Sincerely,

RALPH H. JACKSON
Supervisor, Application/Permit Section
Water Rights Division

RHJ:wpc
enclosure
0427A
5513A

COPY

- SET 5/8" X 30' IRON ROD
- FD. 1/2" I PIPE UNLESS OTHERWISE NOTED

4 COR
1/2" I PIPE
T's

1329.00'

SET 5/8" I ROD

N89°29'54"E

2658.01'

É CURVE DATA

- ① Δ = 33°01'02"
- R = 1023.16'
- T = 303.40'
- LC = 581.48'
- LC BRG = N37°54'45"W

SET WITNESS COR.
N13°12'08"W 122.38'

N69°15'08"W
199.87'

N80°55'58"W
277.51'

THOMPSON CREEK
S71°22'35"W
480.39'

578°57'10"W
395.07'

SET WITNESS CORNER

N83°35'11"
100.00'

CW 1/16 COR.

SET 5/8" I ROD (NOTE: 1/16 COR. NOT ON R. W)

CUT "X" ON SW COR BRIDGE

N25°W 71.65'

CUT "X" ON E. WALL OF DAM SPILLWAY

N80°W 38.10'

FD 5/8" I. ROD EAST 4.68'

23.533 AC.

C1/4 COR.
FD 1-1/2" I PIPE
8 B.T.'s

TEMP R/W CURVE DATA

② LC = 417.80'

LC BRG = N42°16'44"W

11° AC

11° AC

5.3'

N89°06'09"E 629.62'

630.60'

N21°03'11"E
124.89'

N54°25'16"W
515.72'

DRIVE

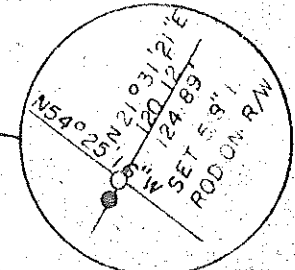

MAP

SHOWING A SURVEY IN THE W 1/2 OF SEC. 18, T. 38 S., R. 7 W., JOSEPHINE COUNTY, OREGON

RECEIVED
APR 30 1982
WATER RESOURCES DEPT
SALEM, OREGON

SCALE: 1" = 200'

3, 1981

581.96'

548.50'

365.77'

2678.45'

FENCE

BEARING

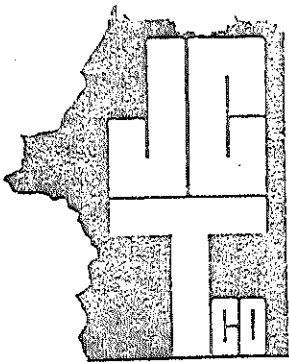

Josephine County Title Co.

locally owned — serving all of Josephine County

February 9, 1981

MINOR LAND PARTITION

prepared at the request of Kathy Allison

PARCEL I: Beginning at the Southeast corner of the Southeast Quarter of the Northwest Quarter of Section 18, Township 38 South, Range 7 West of the Willamette Meridian, Josephine County, Oregon; thence Northerly, along the East line of said Southeast Quarter of the Northwest Quarter, 550 feet, more or less, to the centerline of an existing creek, known commonly as Thompson Creek; thence Westerly, along said centerline to the West line of said Southeast Quarter of the Northwest Quarter; thence Southerly, along said West line to the Northerly right of way line of Lakeshore Drive (South Side Deer Creek Road); thence Southeasterly, along said Northerly right of way line, to the North-South centerline of said Section 18; thence Northerly, along said centerline, to the point of beginning. EXCEPTING THEREFROM that certain tract described as follows: Beginning at a 1/2 inch iron pipe set in a fence line, South 2°53' West 366.0 feet from the 2 inch iron pipe set in the center of Section 18, Township 38 South, Range 7 West of the Willamette Meridian, Josephine County, Oregon; thence South 3°03' West, along said fence line, 555.52 feet to a 1/2 inch iron pipe; thence North 55°35' West, along the Northerly boundary of Lakeshore Drive 672.87 feet; thence North 48°47' West 130.52 feet to a 1/2 inch iron pipe set in a fence line; thence North 24°42' East 125.0 feet to a 1/2 inch iron pipe; thence North 87°43' East 631.09 feet to the point of beginning.

26 ac. m/1

PARCEL II: Beginning at the Northwest corner of Section 18, Township 38 South, Range 7 West of the Willamette Meridian, Josephine County, Oregon; thence Easterly, along the North line of said Section 2640 feet, more or less, to the North Quarter corner of said Section; thence Southerly, along the North-South centerline of said Section, 2165 feet, more or less, to the centerline of an existing creek commonly called Thompson Creek; thence Westerly, along said centerline, to the East line of the Southwest Quarter of the Northwest Quarter of said Section; thence along said East line to the Northeast corner of the South Half of said Southwest Quarter of the Northwest Quarter; thence Westerly, along the North line thereof, to the Northeasterly right of way line of Lakeshore Drive (South Side Deer Creek Road); thence Westerly and Northwesterly, along said right of way line, to the West line of said Section 18; thence Northerly, along said West line, to the point of beginning.

115 ac.m/1

38-7-18 TL 800

DRD:ppl
H/22

Application No. G-10372
Permit No. G 9636

RECEIVED

APR 30 1982

WATER RESOURCES DEPT
SALEM, OREGON

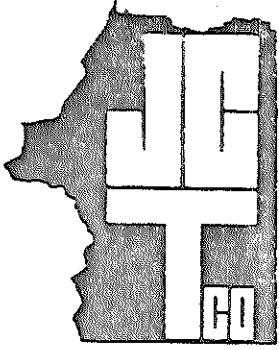

Josephine County Title Co.

locally owned — serving all of Josephine County

August 3, 1981

MINOR LAND PARTITION PREPARED AT THE
REQUEST OF MR. DOUGLAS B. WATTS
700 South Date Avenue
Alhambra, CA 91803

PARCEL I: Commencing at a 2 inch iron pipe set at the center of Section 18, Township 38 South, Range 7 West of the Willamette Meridian, Josephine County, Oregon; thence South 2° 53' West 366 feet to a 1/2 inch iron pipe; thence South 87° 43' West 631.09 feet to a 1/2 inch iron pipe; thence South 24° 42" West 125.00 feet to the Northerly right of way line of Lake Shore Drive; thence Northwesterly along said right of way line 170 feet to the true point of beginning; thence North, parallel with the North-South center line of said Section, 740 feet, more or less, to the center line of an existing creek, commonly known as Thompson Creek; thence Westerly, along the center line of said creek to the West line of said Southeast Quarter of the Northwest Quarter; thence Southerly along said West line to the Northerly right of way line of Lakeshore Drive; thence Southeasterly along said right of way line to the true point of beginning.

PARCEL II: Commencing at a 2 inch iron pipe set at the center of Section 18, Township 38 South, Range 7 West of the Willamette Meridian, Josephine County, Oregon; thence South 2° 53' West 366 feet to a 1/2 inch iron pipe; thence South 87° 43' West 631.09 feet to a 1/2 inch iron pipe; thence South 24° 42" West 125.00 feet to the Northerly right of way line of Lake Shore Drive; thence Northwesterly along said right of way line 170 feet to the true point of beginning; thence North, parallel with the North-South center line of said Section, 740 feet, more or less, to the center line of an existing creek, commonly known as Thompson Creek; thence Easterly along said center line to the North-South center line of said Section; thence Southerly along said North-South center line to the Northerly right of way line of Thompson Creek Road; thence Northwesterly along said right of way line to the true point of beginning. EXCEPTING THEREFROM that certain tract described as follows: Beginning at a 1/2 inch iron pipe set in a fence line, South 2° 53' West 366.0 feet from the 2 inch iron pipe set in the center of Section 18, Township 38 South, Range 7 West of the Willamette Meridian, Josephine County, Oregon; thence South 3° 03' West, along said fence line, 555.52 feet to a 1/2 inch iron pipe; thence North 55° 35' West, along the Northerly boundary of Lakeshore Drive 672.87 feet; thence North 48° 47' West 130.52 feet to a 1/2 inch iron pipe set in a fence line; thence North 24° 42' East 125.0 feet to a 1/2 inch iron pipe; thence North 87° 43' East 631.09 feet to the point of beginning.

DRD:cfs G/18

RECEIVED

APR 30 1982

WATER RESOURCES DEPT
SALEM, OREGON

Application No. **G 10372**
G 9636

118 N.E. G STREET (P.O. BOX 71) / GRANTS PASS, OREGON 97526 / GRANTS PASS: 476-6884 / CAVE JUNCTION: 592-2131

Permit No. _____	CLASS: _____	NO. 1: _____	ning Director _____	Partitioner - signature _____	Owner - signature _____	Print Name _____	FOR OFFICIAL USE ONLY
FOR OFFICIAL USE ONLY	Date _____	Partitioner - signature _____	Owner - signature _____	Print Name _____	Alhambra, California	700 S. DATE AVENUE	MR. DOUGLAS B. WATTS

JUL 12 1961
WATER RESOURCES DEPT
SALEM, OREGON

Handwritten:
FLOOR HOSE WITH GUN

SEE MAP 38 7 7



CANCELLED T.L.
 701
 1000
 1001
 101
 790
 200
 190
 103

Handwritten:
PASTURE
CATTLE - 12000
EXCAVATED
DITCH UNKNOWN
ESTIMATED @ 6'

Handwritten:
SEE ATTACHED
SURVEY MAP

SEE MAP 38 8 13

SEE MAP 38 7 17

Application No. G 10372
 Permit No. G 9636

SEE MAP 38 7 19

RECEIVED

APR 30 1962
 WATER RESOURCES DEPT
 SALEM, OREGON

SEE MAP 38 7 7



CANCELLED T.L.
 701
 1000
 1001
 101
 790
 200
 190
 103

SEE MAP 38 8 13

SEE MAP 38 7 17

SELMAC LAKE

SEE MAP

38 7 18-44

Application No. G 10372
Permit No. G 9636

P 38 7 19
 SEE MAP

RECEIVED
 APR 30 1982
 WATER RESOURCES DEPT
 SALEM, OREGON

RECEIVED

JUN 22 1981

WATER RESOURCES DEPT.
SALEM, OREGON

SUMP
HERE

Application No. 10372
Permit No.

SEC. 18 T.38S., R.7 W.
FLT. NO. 20-19-22

PHOTO SYM. BLM 0-80 AM
PHOTO DATE 7-1-80

PHOTO SCALE: 1" = 400'
NOTE: SECTION CORNER LOCATION

TY, OREGON

PREPARED BY VALLEY AERIAL MAPPING SERVICES INC., ROSEBURG, OR.