

55170

STATE OF OREGON

COUNTY OF

DOUGLAS

RECEIVED

AUG 29 1984

WATER RESOURCES DEPT
SALEM, OREGON

Proof of Appropriation of Water

MELVIN and LETTA MENDENHALL

of PO Box 158, Roseburg
has applied beneficially the waters of
Unnamed Spring

, State of Oregon 97470

a tributary of South Umpqua River for the purpose of
domestic use for one family including the irrigation of lawn and garden not
to exceed one-half acre in area
under Permit No. 41349 and that the use of said waters has been completed under the
terms of said permit; that the priority of the right dates from
January 31, 1977
that the amount of water for the purposes aforesaid, has been actually beneficially used in the
amount of
0.01 cubic foot per second

or its equivalent in case of rotation, measured at the point of diversion from the stream.
The point of diversion is located in the NE 1/4 SW 1/4, Section 30, T27S, R5W,
WM; 290 feet South and 580 feet West from NE Corner, NE 1/4 SW 1/4 Section 30.

The amount of water used for irrigation, together with the amount secured under any other
right existing for the same lands, shall be limited to ----- of one cubic foot per second
per acre,

and shall conform to such reasonable rotation system as may be ordered by the proper state officer.

A description of the place of use under the right, and to which such right is appurtenant, is
as follows:

NE 1/4 SW 1/4
Section 30
Township 27 South, Range 5 West, WM

I have read the above and foregoing proof of appropriation of water; I know the contents
thereof, and that the facts therein stated are true.

IN WITNESS WHEREOF, I have hereunto set my hand this 15th day of July

1984

Tom:

changing POV based on Final
Proof. No certificate needed until
F.P. is done on T-5525.

Sam

Melvin Mendenhall
Letta Mendenhall

T.27S.,R.5W.,W.M.

Section 30

NE 1/4 SW 1/4

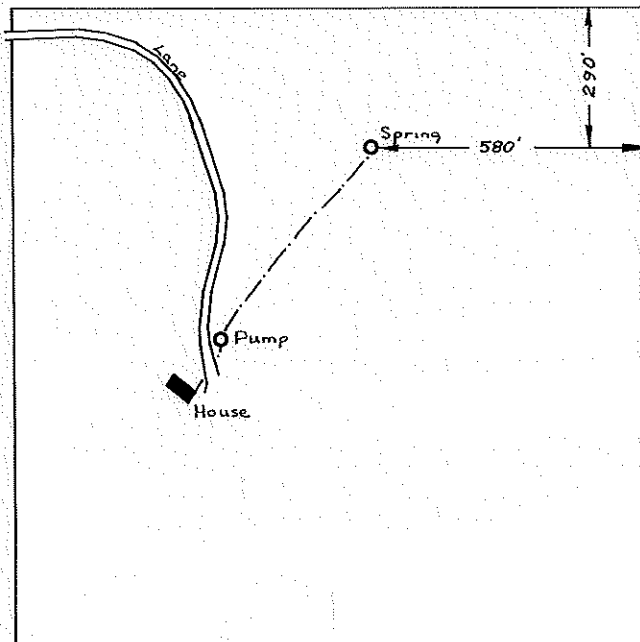

SCALE: 1" = 400'

FINAL PROOF SURVEY
UNDER

Application No. 55170... Permit No. 41349.....
IN NAME OF

MELVIN & LETTA MENDENHALL

Surveyed March 12, 1980., by J.S. DONALDSON.

T-5525 + S-55170

GEORGE LUOMA
DONALD S. KELLEY
WILLIAM C. WOLKE
KAREN G. MAYS

LAW OFFICES
LUOMA, KELLEY, WOLKE & MAYS
SUITE 206 PROFESSIONAL CENTER
POST OFFICE BOX 1608
ROSEBURG, OREGON 97470

TELEPHONE 672-5544
AREA CODE 503

RECEIVED

AUG 29 1984

**WATER RESOURCES DEPT
SALEM, OREGON**

August 28, 1984

Water Resources Department
Mill Creek Office Park
555 13th Street, N.E.
Salem, OR 97310

*COPY
(originals in T-5525
file)*

Re: Application for Transfer of Water Right

Gentlemen:

Enclosed is Application for Transfer of Water Right to Steven H. Converse.

The history of this water permit is that the permit was made by Melvin and Letta Mendenhall. The property to which the water right is appurtenant has been repossessed by the Douglas National Bank and they are now the owners of the property and hence, they are the ones **who** have signed the no objection document attached to the Application.

Would you please examine the Application for content, and if it is in order, advise; if not, suggest what corrections should be made.

Enclosed herewith is transfer of water right examination fee of \$50.00, together with recording fee for use or place of use of \$100.00, making a total of \$150.00.

Please acknowledge receipt of the fee and the application and let us know what the next thing my client needs to do to go forward with securing the water right certificate.

Very truly yours,

LUOMA, KELLEY, WOLKE & MAYS

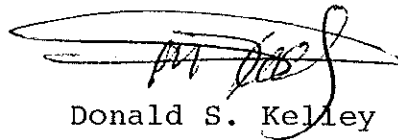
Donald S. Kelley

DSK:11

Enclosures

cc: Steven H. Converse, P.O. Box 1591, Roseburg, OR 97470

J-5525

TRANSFER OF EASEMENT AND RELEASE
OF ANY INTEREST IN WATER RIGHT

The Douglas National Bank hereby releases unto Steven H. Converse any interest it may have in and to right to water under Permit No. 41349 and requests that Application for Transfer of Water Right of Steven H. Converse be approved by the Oregon State Water Resources Department in Salem, Oregon.

Douglas National Bank further transfers and assigns to Steven H. Converse, his heirs and assigns all interest Douglas National Bank has in and to the water pipeline easement extending from said spring set forth under Permit No. 41349 referred to herein to the real property to which said water right is now appurtenant. That said pipeline easement is further referred to in that Stipulated Order in the case of Cegavske, et al vs. Mendenhall, et al; Case No. L80-2222 in the Circuit Court of the State of Oregon for Douglas County, under subparagraph (e) of that Order. Said water pipeline easement is so transferred and conveyed to Steven H. Converse so that said easement shall now be appurtenant to said real property belonging to Steven H. Converse under that real estate contract wherein Steven H. Converse is buyer, recorded June 3, 1981, in Book 798, Page 306, Book of Records, Douglas County, Oregon.

DATED this 23rd day of August, 1984.

DOUGLAS NATIONAL BANK

By Frank M. Lamberton

By Ray McCormack

STATE OF OREGON)
) ss.
County of Douglas)

August 23, 1984

Personally appeared Frank M. Lamberton and Ray McCormack who being duly sworn each for themselves and not for the other did say that the former is the Vice Pres. and the latter is the Property Management Officer of Douglas National Bank and said instrument was signed on behalf of said corporation by authority of its Board of Directors, each of them acknowledged said instrument to be its voluntary act and deed.

Before me:

Mary K. Robbins
Notary Public for Oregon
My Commission Expires: May 22, 1988

PARCEL NO. 3

A parcel of land lying in Section 30, Township 27 South, Range 5 West, Willamette Meridian, said parcel being more particularly described as follows: Beginning at a 5/8 inch iron rod set in the Southerly line of a road right-of-way and from which point the Southwest corner of the above said Section 30 bears South 2502.32 feet and West 1360.67 feet; thence along said Southerly line as follows: North 51° 45' 25" East 99.79 feet to a 5/8 inch iron rod; along the arc of a 208.73 foot radius curve to the right (the long chord of which bears North 64° 47' 25" East) 94.96 feet to a 5/8 inch iron rod, South 76° 38' 56" East 44.63 feet to a 5/8 inch iron rod and along the arc of a 193.73 foot radius curve to the right (the long chord of which bears South 78° 52' 14" East) 76.45 feet to a 5/8 inch iron rod; thence leaving said Southerly line and running South 24° 16' 00" East 841.59 feet to a 5/8 inch iron rod; thence North 65° 50' 00" East 243.91 feet to a 5/8 inch iron rod set in the Westerly line of a road right-of-way; thence along said Westerly line South 2° 59' 28" West 117.83 feet to a 5/8 inch iron rod; thence South 3° 44' 20" West 171.94 feet to a 5/8 inch iron rod; thence South 39° 08' 04" West 390.00 feet to a 5/8 inch iron rod; thence North 26° 23' 00" West 399.69 feet to the place of beginning. (Tract 18)

Application No. 55170 (continued)
Permit No.

RECEIVED

JAN 31 1977

WATER RESOURCES DEPT'
SALEM, OREGON

F-5525



FINAL PROOF CHECK LIST
(WRD SURVEYS - prior to 7/9/87)



APPLICATION NO.: S-55170 (modified by
PERMIT NO: 41349 T-5525)

FILES

- WRIS PRINTOUT
- CONFLICT CHECKED
- COMPARED TO EXISTING RIGHTS

DRAFTING

- GLO'S (LAYOUT, LOTS, DLC'S)
- QUADRANGLE MAPS
- LEGAL DESCRIPTION
- SECTION BREAKDOWN
- DIVERSION POINT DIMENSIONS
- ACREAGE
- TOWNSHIP, RANGE, SECTION
- PHYSICAL FEATURES
- SURVEY ID INFO

FIELD FORM

- NAME, ADDRESS, COUNTY
- SOURCE
- TRIBUTARY
- PRIORITY DATE
- POINT OF DIVERSION
- TIME LIMITS, SURVEY REGARDLESS

- PLACE OF USE
- CALCULATIONS
- RATE/DUTY
- PERMIT CONDITIONS

ASSOCIATED RIGHTS

- TOTAL QUANTITY FROM POD
- PRIMARY SOURCE USED

PROPOSED CERTIFICATE

- PROOFED, CORRECTED, INITIALED & DATED

DIRECTORY s:\group\wr\certs\proposed\surface water #1349

OWNERSHIP

- OTHER OWNERS (Has the permittee/department identified any property owner for lands not included in the final proof?)

REMARKS:

Prop. Certificate due to be issued upon final proof of T-5525, which changes P.O.U. T-5525 awaiting survey.

REVIEWER Sarahy Pederson

DATE: 10/24/01

Original Final Proof completed, but now awaiting Final Proof survey for T-5525, which changes P.O.U.

STATE OF OREGON

COUNTY OF DOUGLAS

PROPOSED CERTIFICATE OF WATER RIGHT

THIS CERTIFICATE ISSUED TO

CRAIG AND LAVEE HUMMEL
2006 BOOTH ST.
ROSEBURG, OR 97470

confirms the right to use the waters of AN UNNAMED SPRING, a tributary of SOUTH UMPQUA RIVER, for DOMESTIC USE FOR ONE FAMILY INCLUDING THE IRRIGATION OF LAWN AND GARDEN NOT TO EXCEED ONE-HALF ACRE IN AREA.

This right was perfected under Permit 41349. The date of priority is JANUARY 31, 1977. The amount of water to which this right is entitled is limited to an amount actually beneficially used and shall not exceed 0.01 CUBIC FOOT PER SECOND, or its equivalent in case of rotation, measured at the point of diversion from the source.

The point of diversion is located as follows:

NE 1/4 SW 1/4, SECTION 30, TOWNSHIP 27 SOUTH, RANGE 5 WEST, W.M.; 290 FEET SOUTH AND 580 FEET WEST FROM THE CENTER 1/4 CORNER OF SECTION 30.

The use shall conform to such reasonable rotation system as may be ordered by the proper state officer.

A description of the place of use to which this right is appurtenant is as follows:

NE 1/4 SW 1/4
SECTION 30
TOWNSHIP 27 SOUTH, RANGE 5 WEST, W.M.

The right to the use of the water for the above purpose is restricted to beneficial use without waste on the lands or place of use described. The water user is advised that new regulations may require the use of best practical technologies or conservation practices to achieve this end.

The use confirmed herein may be made only at times when sufficient water is available to satisfy all prior rights, including rights for maintaining instream flows.

*This will need
to be edited to
include transfer
macro due to T-5525.*

Plat Card Report for: Township: 27S, Range: 5W Section: 30

Application	Permit	Certificate	Status lot/dlc	NE				NW				SW				SE				Gov't Lot	
				NE	NW	SW	SE	NE	NW	SW	SE	NE	NW	SW	SE	NE	NW	SW	SE		
G 12630	G 11649		Cncl													0.350 IR Cncl	1.400 IR Cncl				
8/7/1991																					
S 24798	S 19329	<u>24412</u>	Cncl																		
6/2/1950		-						MU Cncl	MU Cncl	MU Cncl	MU Cncl										
S 24798	S 19329	<u>45930</u>																			
6/2/1950	*	-						MU	MU	MU	MU										
S 31576	S 24914																				
5/21/1957								MU	MU	MU	MU										
S 50927	S 38449	<u>45902</u>																			
7/23/1973		-																			
S 55170	S 41349																				
1/31/1977																					
S 55170	S 41349																				
1/31/1977	*																				
S 58356	S 44018																				
2/22/1979				MU	MU	MU	MU	MU	MU	MU	MU	MU	MU	MU	MU	MU	MU	MU	MU	MU	MU
S 69330	S 50708		Cncl																		
6/6/1989																					
P 75183																					
9/29/1994																					

MC

Go to 27S, 5W, 30 page: 1 2 Next >>

[Return to Plat Card Search](#)

NOTE: Please read the [disclaimer](#) before using this information. Frequently asked questions are discussed in our Plat Card [FAQ](#).

Plat Card Report for: *Township: 27S, Range: 5W Section: 30*

Application	Permit	Certificate	Status lot/dlc	NE				NW				SW				SE				Gov't Lot
				NE	NW	SW	SE	NE	NW	SW	SE	NE	NW	SW	SE	NE	NW	SW	SE	
P 79605																				
1/3/1995																				
P 81391																				
7/29/1996																				
P 81391																				
7/29/1996	*																			
P 82902																				
12/31/1996																				

Go to 27S, 5W, 30 page: [<<Previous](#) [1](#) [2](#)

[Return to Plat Card Search](#)

NOTE: Please read the disclaimer before using this information. Frequently asked questions are discussed in our Plat Card [FAQ](#).

RECEIVED

APR 12 1988

WATER RESOURCES DEPT.
SALEM, OREGON

COPY

ASSIGNMENT

I, STEVEN H. CONVERSE of
521 Maple Rslby Oregon 97470
(Mailing Address) (City) (State) (Zip)

do hereby assign all my interest in and to water right Application
No. 55170, Permit No. 41349, as filed in the office
of the Water Resources Director, to:

CRAIG & LAVEE HUMMEL
(Name)
2006 BOOTH ST ROSEBURG OR 97470
(Mailing Address) (City) (State) (Zip)

TELEPHONE NUMBER _____

WITNESS my hand this 7th day of APRIL 1988.

Craig A Hummel, Lavée A Hummel
(Signature of Permittee)

Steven H Converse 4-7-88

The completed assignment must be submitted to the Water Resources Director, 3850 Portland Road N.E., Salem, Or. 97310 together with a recording fee of \$10.

2080' N.

House
D 5A

Spring

NET SW 1/4



T. 27 S., R. 5 W., Sec. 30

1" = 400'

gmf

Application No. 55170
Permit No. 41349

RECEIVED

JAN 31 1977

WATER RESOURCES DEPT.
SALEM, OREGON

3160' W.

30 29
31 32

378-3066

55170

22 Febraury 1977

Melvin & Letta Mendenhall
P.O. Box 158
Roseburg, Oregon 97470

Dear Mr. and Mrs. Mendenhall:

We have received your map, legal land description, spring description sheet, fees of \$35.00 and application for a permit to use 0.01 cubic foot per second of water from a spring for domestic use for one family including irrigation of up to $\frac{1}{2}$ acre lawn and garden. For reference, this application is No. 55170.

Permits will be issued for use of water from South Umpqua River and its tributaries. However, water may not be available during dry periods. The water may be needed to satisfy existing rights or minimum flow standards.

Your application is satisfactory and a permit will be issued in 30 to 60 days.

Sincerely,

Vestal R. Garner
Water Rights Engineer

VRG:clj
encl: Receipt No. 57837

SE ROSS J
77-14-33 ✓
NCR

Abstract of Permit No. 41349

Application No. 55170

Certificate No.

Name Melvin & Letta Mendenhall
Address P. O. Box 158
Roseburg, Oregon 97470

Source of water supply An unnamed spring, trib., South Umpqua River

Use Domestic use for one family, including the irrigation of lawn and garden not to exceed one-half acre in area.

Point of diversion 2080 ft N & 3160 ft W from SE cor., sec. 30, being within NE 1/4 SW 1/4 sec. 30, T. 27S., R. 5W., W.M.; Douglas County

Number of acres 290 ft S and 580 ft W from NE cor NE 1/4 SW 1/4 Sec 30

DESCRIPTION OF LAND TO BE IRRIGATED OR PLACE OF USE

Twp.	Range	Sec.	NE 1/4				NW 1/4				SW 1/4				SE 1/4			
			NE 1/4	NW 1/4	SW 1/4	SE 1/4	NE 1/4	NW 1/4	SW 1/4	SE 1/4	NE 1/4	NW 1/4	SW 1/4	SE 1/4	NE 1/4	NW 1/4	SW 1/4	SE 1/4
27 S	5 W	30									DOM							

Priority date January 31, 1977

Amount of water 0.01 c.f.s.

Time limit to begin construction 3-21-78

Time limit to complete construction 10-1-78 extended to extended to

Time limit to completely apply water 10-1-79 extended to extended to

Remarks: Limitations:

3-12-80 JSD
 Rechecked 7/20/82 JMT
 cgm
 South Umpqua River
 Basin 16, Volume 3

3510C
50927
LITTLE

50927

Info: Mrs. Mendenhall Water from Spring has been used in house and for watering yard, she also have a well for house water. Water is gravity flow from spring to storage tank, and is pumped from tank to house.

Div.: 3' x 3' x 3' hole dug in side of hill where spring is located. Water flows from spring down a 2' wide x 1' deep x 35' long to a 3' dia. buried concrete tile surrounded with drain rock. Water flows in to concrete tile and is piped from tile to storage tank and pump then to house.

Pump & Motor: Emerson 1/3 hp @ 3450 rpm
Wards CDD 1" x 3/4"

Pipe: 3/4" plastic

Lift: - 30' from spring to tank
+ 15' from tank to house

use: Domestic @ family including lawn & garden

tie: Dong Co 77-14-33

Steve Donaldson
3-12-80 FE

Recheck Located W 1/4 Cor (Fence Corner 1/2 BT)

Kathy J. P.
WRS
7/20/82

Application No. _____

DESCRIPTION OF SPRING

1. Is spring on property of applicant? No
2. If not, give name and address of legal owner. Robert
Jenkins Myrtle Creek
3. Have you secured consent of owner to appropriate water from this spring and for construction of pipeline or other works? yes
4. If you do not have such consent, do you expect to secure right of way through condemnation? _____
5. What is the maximum flow from spring? 30
(Gallons per minute or
~~_____~~
cubic feet per second)
- What is the minimum flow? 15
- Is flow measured or estimated? estimated
6. Does the stream flowing from spring form a well defined natural channel? no
7. Does the water flow off the lands on which it first arises? yes
8. Give the name of the stream or other body of water into which water from the spring flows. South Umpqua
9. If the water from the spring sinks or evaporates before reaching other water, give distance water flows from spring before vanishing.
300 ft
10. Remarks _____

RECEIVED

JAN 31 1977

WATER RESOURCES DEPT
SALEM, OREGON

Melvin Mendenhall
Signature of Applicant

Application No. 55170
Permit No.