

Name *Oregon State Game Commission*
By *616 Oregon Bldg*
Address *Portland 4, Oregon*

Application No. *20886*
Permit No. *18674*
Certificate No. *20470*

Stream Index, Page No. *8-37*

FEES PAID

Date	Amount	Receipt No.
<i>6/1/45</i>	<i>27.00</i>	<i>31753</i>
<i>3/12/49</i>	<i>22.00</i>	<i>6588</i>
	B. P. Fee	
<i>4/28/54</i>	\$1 Cert. Fee	<i>1512</i>

Date filed *May 31, 1945*
Priority *May 31, 1945*
Action suspended until

FEES REFUNDED

Date	Amount	Check No.
------	--------	-----------

Returned to applicant
Date of approval *September 15, 1949*

ASSIGNMENTS

Date	To Whom	Address	Volume	Page
------	---------	---------	--------	------

CONSTRUCTION

Date for beginning *September 15, 1950*
Date for completion *October 1, 1951*
Extended to
Date for application of water *October 1, 1952*
Extended to

REMARKS

18.0 cfs from Clear Creek (Wallowa R.) for State trout hatchery.
OCT 23 1952 CARD FOR C

PROSECUTION OF WORK

Form "A" filed
Form "B" filed
Form "C" filed *October 29, 1952*

FINAL PROOF

Blank mailed *APR 2 1953*
Proof received *MAY 31 1954*
Date certificate issued

Form C

IMPORTANT—This form is a notice to the State Engineer that permittee is ready to make **final proof** to the extent to which the water has actually been applied to the intended use under the terms of the permit. Permittee is cautioned that Certificate of Water Right will be issued based on the extent of the quantity and use as determined by the **final proof** inspection and survey which will be made in response to the filing of this Form C.

NOTE: In the case of an irrigation permit, this Form C should not be mailed to the State Engineer until all of the land described in the permit, which it is intended to irrigate under this permit at any time, has actually been irrigated.
Fill out, detach, and mail to the State Engineer, Salem, Oregon, when all of the water has been applied.

Application No. 20886

NOTICE OF COMPLETE APPLICATION OF WATER TO A BENEFICIAL USE

I, OREGON STATE GAME COMMISSION, the holder of Permit No. 18674

to appropriate the public waters of the state of Oregon, completely applied the waters to a beneficial use in accordance with the terms of said permit, on the 1st day of October, 1952

Remarks:

IN WITNESS WHEREOF, I have hereunto set my hand this 28th day of October, 1952.

W. M. Schneider
(Signature of Applicant)

P. O. Box 4136, Portland 8, Oregon
(Address)

RECEIVED
OCT 29 1952
STATE ENGINEER
SALEM, OREGON

Water Complaint: 3-27-78

Ken Spidell, Manager
Wallowa Fish Hatchery

426-3279
426-4271 home

Claims to be short of water. Believes people taking water illegally upstream.

Lost several 1000 2yr old steelhead. (?)

Watermaster has not responded to complaint. (?)

Called Bob DeBow

He had responded to complaint by first checking quantity of water at hatchery - 12 cfs. Looked for illegal users upstream that requested additional release from Wallowa Lake!

Bob said that he was present when 2500 fish were being buried. He asked if cause of death had been determined by resident biologist. The answer was, no, there was time for that or a need for it.

Bob reports that the fish are being raised in two new ponds constructed to use water from a well. The well did not turn out to provide adequate water. New ponds and well are not covered by a water right.

Bob believes that they have had to many fish in the ponds for their size and that overcrowding is a problem. He questions why he did not receive notice of short water supply sooner if this were the problem.

Clear Creek is actually a branch of the Wallowa River and release from the lake can supply water. Lake has been shut down more than usual.

T.2S.R.44E.WM

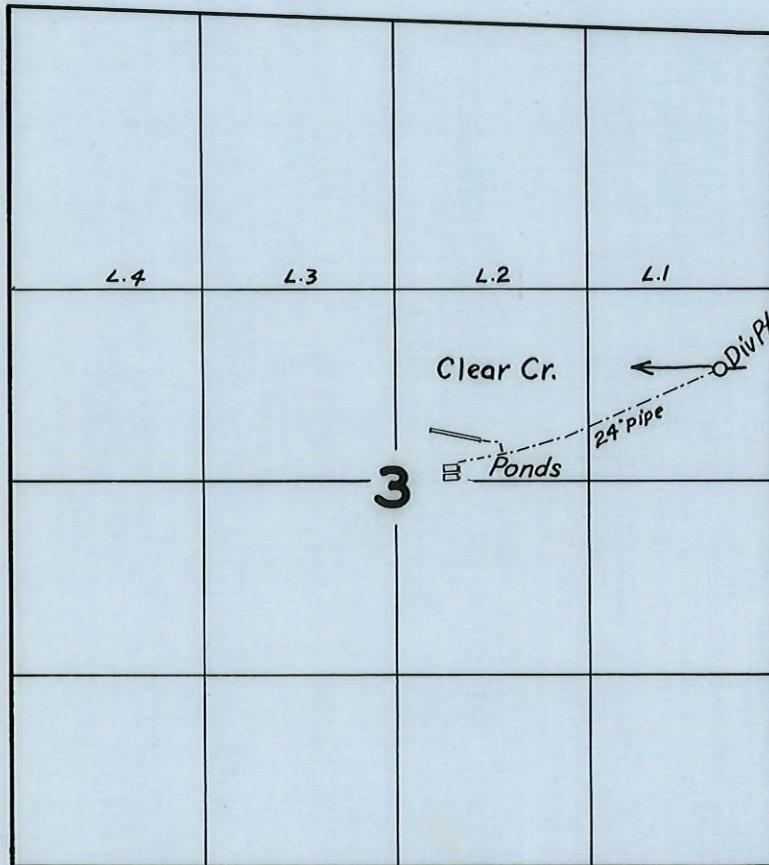

FINAL PROOF SURVEY UNDER

Application No. ~~20866~~..... Permit No. 18674.....
IN NAME OF

Oregon State Game Commission

Surveyed Oct 15 19 53, by T. Jones

Permit No.18674.....20470

Application No. 20886..... CountyWALLOWA.....

Proof of Appropriation of Water

1. Name Oregon State Game Commission 2. Address 1634 S.W. Alder St.
616 Oregon Building, Portland ⁸
Oregon
3. Source of supply Clear Creek
 Tributary of Wallowa River
4. Amount of water 18.0 c.f.s. 5. Priority date May 31, 1945
6. Use State Trout Hatchery
7. Location of point of diversion SE¹/₄ NE¹/₄ Sec. 3 Tp. 2 S Rg. 44 E, W. M.
 (Legal Subdivision)

8. The description of land given below corresponds to that shown in the permit covering land to be irrigated, or, if for other purposes, the place of use.

Township	Range Willamette Meridian	Section	Legal Subdivision	No. Acres Actually Irrigated
2 S	44 E	3	SW ¹ / ₄ NE ¹ / ₄	Ponds
			NW ¹ / ₄ SE ¹ / ₄	Ponds

Land on which water is to be used is part of the property described by appropriator as follows:

DESCRIPTION OF WORKS

9. (a) If a dam has been constructed, give description: Height, ft.; length on top, ft.; length on bottom, ft.; material used and character of construction,

(b) Give description of headgate: Width,20..... ft.; depth,8..... ft.; material used and character of construction,Concrete.....

(c) Size of canal: Width on top (at waterline), ft.; width on bottom, ft.; depth of water, ft.; grade, ft. fall per 1,000 ft. Actual capacity, sec.-ft. Give general description:

(d) Pipe line: Description of intake, Length of pipe, ..2,000.. ft.; size at intake,24... in.; size at ft. from intake, in.; size at place of use,24..... in. Difference in elevation between intake and place of use,16..... ft. Is grade uniform?Yes..... Actual capacity of pipe line,18..... sec.-ft. Give general description: (Material: Steel, wrought, cast iron, wood stave, etc.)

(e) Pumping plant: Give size and type of pump, Suction lift, ft.; discharge lift, ft. Type of motor used Horsepower rating, H. P. Actual capacity of pump, sec.-ft.

10. During what months is water beneficially used?

11. State character of soil Kind of crops raised

12. Does the accompanying map, filed with your application, show correctly the point of diversion, area of land irrigated, or place of use?

13. If not, wherein is such map in error?

14. Domestic use: Give number of families actually using water at this time *2000*

15. If for power, mining, municipal, manufacturing, storage or any other purpose than irrigation, give extent and method of such use *2000*

AFFIDAVIT OF APPROPRIATOR

STATE OF OREGON,
County of } ss.

I,, being first duly sworn, depose and say that I have read the above and foregoing proof of appropriation of water; that I know the contents thereof, and that the facts therein stated are true.

IN WITNESS WHEREOF, I have hereunto set my hand this day of, 19.....

Subscribed and sworn to before me this 21st day of April, 1954
P. W. Schneider
Susanne Davis

Notary Public for Oregon
My Commission Expires Feb. 20, 1956

[Notarial Seal]

My commission expires

AFFIDAVIT OF WITNESSES

STATE OF OREGON,
County of } ss.

We,, and
of, being first duly sworn, depose and say that

we are well acquainted with the facts and conditions set forth in the foregoing statement relative to proof of appropriation of water under Permit No., that we and each of us have been over and upon each tract described in said proof, and from such personal inspection have knowledge that all necessary ditches, dams and other diversion and distributing works have been constructed, and water used as stated therein; that we have carefully read such proof of appropriation, and that each and every statement contained therein is true to the best of our knowledge and belief.

and I recommend the issuance of water right certificate for this amount
be accurate. In my opinion the appropriation has been completed to the extent of
of

Subscribed and sworn to before me this day of, 19.....

[Notarial Seal]

My commission expires

REPORT OF PERSON MAKING INSPECTION

(For use by Representative of State Engineer)

I,Trevor Jones....., do hereby certify that I have made an inspection of the works described herein and in Permit No.18674....., on the15th..... day ofOctober....., 19.53., and found the foregoing statements and descriptions of works to be accurate. In my opinion the appropriation has been completed to the extent of
(Quantity of water in second-feet or acre-feet)
and I recommend the issuance of water right certificate for this amount.

NOTICE TO INSPECTORS

If conditions do not justify the above report by you, please return the proof without your signature, with a full report by letter.

.....(Sgd) Trevor Jones.....
(Name)
.....Field Engr.....
(Title)

Permit No. 18674

Application No. 20886

County Wallowa

Preliminary Data for Proof of Appropriation of Water

1. Name Oregon State Game Commission 2. Address 1634 S.W. Alder St 616 Oregon Building, Portland Oregon
3. Source of supply Clear Creek
Tributary of Wallowa River
4. Amount of water 18.0 c.f.s 5. Priority date May 31, 1945
6. Use State Trout Hatchery
7. Location of point of diversion SE 1/4 NE 1/4 Sec. 3 Tp. 2 S. Rg. 44 E, W. M.
(Legal Subdivision)
8. The description of land given below corresponds to that shown in the permit covering land to be irrigated, or, if for other purposes, the place of use.

Surveyed 10-15-53 T.J.

Township	Range Willamette Meridian	Section	Forty-acre Tract	No. Acres Described in Permit	No. Acres Actually Irrigated
2 S	44 E	3	SW 1/4 NE 1/4		Ponds
			SE 1/4 NW 1/4		no use
			NW 1/4 SE 1/4		Ponds

Land on which water is to be used is part of the property described by appropriator as follows:

~~S 1/4 cor Sec 3~~

REPORT OF PERSON MAKING INSPECTION

Description of works:

Div pt plank 10' long 1" high to confine water to narrower channel, conc dam 2 1/2' high 10' x 6" wings spillway 4' w 6' long planked 1" head box 6' x 12' x 3 1/2" deep 2 1/2" wood pipe to head of S ponds 12" across head of 2^d pond 12" to N ponds, 1 pond 2 sections of 20' x 100' x 6" deep 2^d pond 3 secs 20' x 100' x 3 1/2" deep. 2 N ponds 50' x 8' x 4' 3 - 3" pipes to each sec of S ponds.

I, Henry Jones, do hereby certify that I have made an inspection of the works described herein and in Permit No. 18674, on the 15 day of Oct, 1953, and found the foregoing statements and descriptions of works to be accurate. In my opinion the appropriation has been completed to the extent of _____ and I recommend the issuance of water right certificate for this amount. (Quantity of water in second-feet or acre-feet)

NOTICE TO INSPECTORS

If conditions do not justify the above report by you, please return this form without your signature, with a full report by letter.

Henry Jones
(Name)
Field Eng
(Title)

J. H. VAN WINKLE, CHAIRMAN, OREGON CITY
DON M. MITCHELL, TAFT
DELBERT GILDERSLEEVE, BAKER
ELMER H. BALSIGER, KLAMATH FALLS
KENNETH G. DENMAN, MEDFORD

Re: Portland Office
5.20.00.00

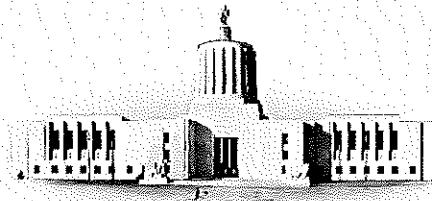

STATE OF OREGON
OREGON STATE GAME COMMISSION
1634 S. W. ALDER STREET
P. O. BOX 4136
PORTLAND 8

April 26, 1954

Mr. Charles E. Stricklin
State Engineer
Salem, Oregon

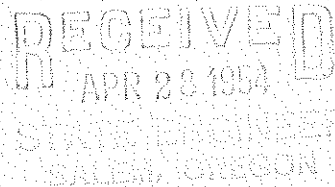

Dear Sir:

Enclosed please find check for one dollar for permit
no. 18674--refer to file no. 20886.

Please sign and return in duplicate.

Yours truly,

P. W. SCHNEIDER
DIRECTOR

By *George J. Kernan*

George J. Kernan
Chief Engineer

GJK:rrl

Enc.

April 22, 1954

Oregon State Game Commission
1634 S.W. Alder Street
Portland 8, Oregon.

Attn: P. W. Schneider, Director

Gentlemen:

Receipt is acknowledged of Proof of Appropriation of water under Permit No. 18674 bearing the signature of P. W. Schneider under the Affidavit of Appropriator, and appears satisfactory.

If you will now remit the statutory certificate recording fee of \$1.00, as stated in our letter of April 1, 1954, the matter of the issuance of a certificate confirming the rights thereunder may be given further attention.

Very truly yours,

CHAS E. STRICKLEIN, State Engineer

By: Geo V. Mademan, Assistant

20886

April 1, 1954

Oregon State Game Commission
616 Oregon Building
Portland 4, Oregon.

Gentlemen:

We are enclosing herewith for completion, final proof in connection with the incomplete water right represented by your Permit No. 18674 granting a right to the use of 18.0 cfs of the waters of Clear Creek, tributary of Wallawa River, for the operation of a trout hatchery.

The data contained in the proof, which is based on an inspection and survey of your project made by a representative of this department, defines the extent to which your water right has been completed within the terms of your Permit. The proof should be dated and signed by you on the second sheet under the Affidavit of Appropriator and returned to this office.

Upon receipt of the proof, properly executed and accompanied by the statutory fee of \$1.00, a Certificate of Water Right will be issued confirming the rights thereunder and, after being recorded in the records of Wallawa County, will be forwarded to you.

In the interest of economy and due to the fact that your completed project was examined by a representative of this department, it is not necessary that your signature be made before a Notary Public, nor that the signatures of witnesses be affixed to the proof.

Yours very truly,

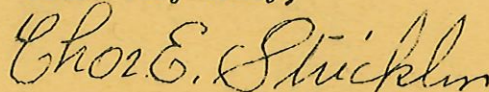

CHAS. E. STRICKLIN
State Engineer

Enclosure
Form 117

November 17, 1952

Oregon State Game Commission
616 Oregon Bldg.
Portland 4, Oregon

Gentlemen:

This will acknowledge receipt of your notice to the effect that complete application of water has been made under Permit No. 18674.

Pursuant to your report and in line with the general practice of this office, a survey will be made at a later date for the purpose of checking the amount of water used as described in the permit. After this survey, proof may be made and certificate issued covering the actual use of water as found by the engineer.

In the meantime, the permit which you hold will be valid evidence of the water right.

Very truly yours,

Chas. E. Stricklin

CHAS. E. STRICKLIN
State Engineer

October 27, 1949

Oregon State Game Commission
1634 S. W. Alder Street
Portland, Oregon

Attention: Mr. George Kernan, Engineer

Gentlemen:

This will acknowledge receipt of your Permit No. 18674 together with a description of the property on which water is used under this permit.

We have filed the description with other matter pertaining to the water right in question and the permit which you should hold is returned to you herewith.

Very truly yours,

CHAS. E. STRICKLIN
State Engineer

By
Ed K. Humphrey, Assistant

EKH:RN
ENCL.

March 23, 1949

Oregon State Game Commission
1634 S. W. Alder Street
P. O. Box 4136
Portland 8, Oregon

Attention: Mr. L. M. Sweet, Engineer

Dear Mr. Sweet:

This will acknowledge receipt of your letter of March 15, transmitting a tracing to accompany application No. 20886 and the balance of fees in the amount of \$22.00 for which our receipt No. 6588 is enclosed. I am also enclosing your official receipt form in duplicate signed according to your instructions.

Your application is now complete providing the property on which water is to be used is properly described by 40 acre tract; that is, on the SW $\frac{1}{4}$ NE $\frac{1}{4}$ of Section 3, etc. If the property involved is not so described in the records, you should send us the true legal description which we will add to your application to complete it.

Very truly yours,

CHAS. E. STRICKLIN
State Engineer

By
Ed K. Humphrey, Assistant

EKH:lh
Enc.

OREGON STATE GAME COMMISSION



E. E. WILSON, CHAIRMAN, CORVALLIS
R. D. MCCLALLEN, ENTERPRISE
THEODORE R. CONN, LAKEVIEW
~~DR. GEO. CATHEY, PORTLAND~~
KENNETH S. MARTIN, GRANTS PASS
LARRY HILAIRE, PORTLAND

1634 S. W. ALDER STREET
P. O. BOX 4136
PORTLAND 8, OREGON

TELEPHONE BROADWAY 6581
ADDRESS ALL COMMUNICATIONS TO
STATE GAME COMMISSION

~~F. W. WIRE, SUPERVISOR~~
C. A. LOCKWOOD, SUPERVISOR

March 15, 1949

State of Oregon
Office of the State Engineer
504 State Office Building
Salem, Oregon

RECEIVED
MAR 17 1949
STATE ENGINEER
SALEM, OREGON

Attention: Mr. Ed. K. Humphrey

Dear Mr. Humphrey:

With regard to our application given No. 20886 for the appropriation of water from Clear Creek, a tributary of the Wallowa River in Section 3, T2S, R44E, WM in Wallowa County, Oregon.

As directed by your letter of 3 August 1948, find herewith a paper tracing delineating the distance and direction of the point of diversion from a recognized government survey corner.

Also, herewith find our check in the amount of \$22.00 which you indicate is the balance due in recording fees.

I trust that this will furnish you with everything necessary to permit issuance of a permit.

Very truly yours,

OREGON STATE GAME COMMISSION

Charles A. Lockwood,
Supervisor

by

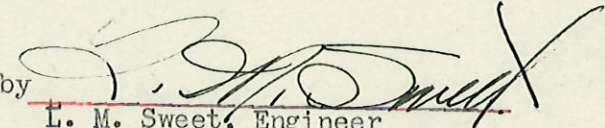
L. M. Sweet, Engineer

LMS/blh

Enclosure-3

August 3, 1948

Oregon State Game Commission
1634 S. W. Alder Street
P. O. Box 4136
Portland 8, Oregon

Attention: Mr. H. R. Mangold
Director of Supplies

Dear Mr. Mangold:

This will acknowledge receipt of your letter of July 30, transmitting an application form carrying information relative to your Application No. 20886, together with accompanying sketch.

Upon receipt of a map prepared by your Engineering Department on tracing cloth or tracing paper, showing all of the important items of your proposed appropriation to a suitable scale, including the location of the required reference monument by a distance and bearing tie to a recognized government survey corner, as explained on pages 6 and 8 of the enclosed copy of the Rules and Regulations of the State Engineer, accompanied by the balance due in recording fees in the amount of \$22.00, as provided by Chapter 88, Oregon Laws of 1947, the matter of approval of your application by issuance of a permit will be given consideration.

Yours very truly,

CHAS. E. STRICKLIN
State Engineer

By
Ed K. Humphrey, Assistant

EKH:vc
Enc.

July 7, 1948

Oregon State Game Commission
616 Oregon Building
Portland 4, Oregon

Attention: Mr. Charles A. Lockwood, State Game Supervisor

Dear Mr. Lockwood:

Will you please let us know when you will submit a map and data required to complete your Application No. 20886 for a permit to appropriate 18.0 cubic feet of water per second from Clear Creek, a tributary of Wallowa River for use in the State trout hatchery. This application was filed May 31, 1945.

Very truly yours,

CHAS. E. STRICKLIN
State Engineer

By
Ed K. Humphrey, Assistant

EKH:dh

June 2, 1945

Oregon State Game Commission
616 Oregon Building
Portland 4, Oregon

Attention: Mr. F. B. Wire, State Game Supervisor

Dear Mr. Wire:

This will acknowledge receipt of your incomplete application for a permit to appropriate 18.0 cubic feet per second from Clear Creek, a tributary of Wallows River, for state trout hatchery, together with fees in the amount of \$27.00 for which our Receipt No. 21753 and your receipts in duplicate, signed as requested, are enclosed herewith.

The application has been filed and given No. 20886.

It will be placed in line for approval and issuance of a permit upon receipt of the required data and tracing, as explained in the enclosed copy of the Rules and Regulations of the State Engineer.

Yours very truly,

CHAS. E. STRICKLIN
State Engineer

By
Ed K. Humphrey, Assistant

EKH:
Enc.

OREGON STATE GAME COMMISSION



CHAIRMAN, CORVALLIS
PORTLAND
ALLEN, ENTERPRISE
CONN, LAKEVIEW
DENMAN, MEDFORD
CATHEY, PORTLAND

616 OREGON BUILDING
PORTLAND 4, OREGON

TELEPHONE ATWATER 8388
ADDRESS ALL COMMUNICATIONS TO
STATE GAME COMMISSION
F. B. WIRE, SUPERVISOR

May 29, 1945

State Engineer
Capitol Building
Salem, Oregon

RECEIVED
MAY 31 1945
STATE ENGINEER
SALEM, OREGON

Dear Sir:

I am enclosing an application for water permit and check in the amount of \$27.00 to cover the filing fees on 18 cubic feet per second of water.

I am also enclosing receipt in duplicate with the request that you sign and return both copies to this office for our files.

Very truly yours,

OREGON STATE GAME COMMISSION

F.B. Wire, State Game Supervisor

H. E. Bowers, Engineer

HEB:rs
Enclosure

OREGON STATE GAME COMMISSION



E. E. WILSON, CHAIRMAN, CORVALLIS
R. D. MCCLALLEN, ENTERPRISE
THEODORE R. CONN, LAKEVIEW
~~FR. G. GATHEY, PORTLAND~~
KENNETH S. MARTIN, GRANTS PASS
LARRY HILAIRE, PORTLAND

1634 S. W. ALDER STREET
P. O. BOX 4136
PORTLAND 8, OREGON

TELEPHONE BROADWAY 6581
ADDRESS ALL COMMUNICATIONS TO
STATE GAME COMMISSION
~~WIRE SUPERVISOR~~
C. A. LOCKWOOD, SUPERVISOR

July 30, 1948

Mr. Charles E. Stricklin
State Engineer
Salem, Oregon

Attn: Mr. Ed K. Humphrey, Asst.

Gentlemen:

In reply to your letter under date of July 7, will advise that we contacted our Engineering Division and they prepared the attached form for your further information.

Very truly yours,

OREGON STATE GAME COMMISSION

H. R. Mangold,
Director of Supplies

HRM: vb

RECEIVED
AUG 2 1948
STATE ENGINEER
SALEM, OREGON

Copy

*** APPLICATION FOR PERMIT**

To appropriate the Public Waters of the State of Oregon

I, OREGON STATE GAME COMMISSION
(Name of applicant)
of 616 Oregon Building, Portland 4, Oregon, County of Multnomah,
(Mailing address)
State of Oregon, do hereby make application for a permit to appropriate the

following described public waters of the State of Oregon, **SUBJECT TO EXISTING RIGHTS:**

If the applicant is a corporation, give date and place of incorporation

1. The source of the proposed appropriation is Clear Creek
(Name of stream)
....., a tributary of Wallowa River

2. The amount of water which the applicant intends to apply to beneficial use is 18.0
cubic feet per second.
(If water is to be used from more than one source, give quantity from each)

**3. The use to which the water is to be applied is

(Irrigation, power, mining, manufacturing, domestic supplies, etc.)

4. The point of diversion is located 980 ft. N and 1766 ft. E from the SW
(N. or S.) (E. or W.)
corner of NE 1/4 of Section 3, T. 2 South Range 44 EMM
(Section or subdivision)
Wallowa County

(If preferable, give distance and bearing to section corner)

(If there is more than one point of diversion, each must be described. Use separate sheet if necessary)

being within the SE 1/4 NE 1/4 of Sec. 3, Tp. 2 S
(Give smallest legal subdivision) (N. or S.)

R. 44E, W. M., in the county of Wallowa
(E. or W.)

5. The Pipe Line to be 1655' Approx.
(Main ditch, canal or pipe line) (Miles or feet)
in length, terminating in the SW 1/4, NE 1/4 of Sec. 3, Tp. 2S.
(Smallest legal subdivision) (N. or S.)

R., W. M., the proposed location being shown throughout on the accompanying map.
(E. or W.)

DESCRIPTION OF WORKS

Diversion Works—

6. (a) Height of dam None feet, length on top feet, length at bottom
..... feet; material to be used and character of construction

(Loose rock, concrete, masonry,
rock and brush, timber crib, etc., wasteway over or around dam)

(b) Description of headgate Concrete box 8' x 20' Water flow gravity
(Timber, concrete, etc., number and size of openings)

(c) If water is to be pumped give general description

(Size and type of pump)
(Size and type of engine or motor to be used, total head water is to be lifted, etc.)

*A different form of application is provided where storage works are contemplated.

**Application for permits to appropriate water for the generation of electricity, with the exception of municipalities, must be made to the Hydroelectric Commission. Either of the above forms may be secured, without cost, together with instructions by addressing the State Engineer, Salem, Oregon.

Municipal or Domestic Supply—

10. (a) To supply the city of

(Name of) County, having a present population of

and an estimated population of in 19.....

(b) If for domestic use state number of families to be supplied

(Answer questions 11, 12, 13, and 14 in all cases)

- 11. Estimated cost of proposed works, \$ 7,000.00
- 12. Construction work will begin on or before Completed
- 13. Construction work will be completed on or before Feb. 11, 1947
- 14. The water will be completely applied to the proposed use on or before Feb. 11, 1947

OREGON STATE GAME COMMISSION

(Signature of applicant)

By /s/ F. B. Wire
State Game Supervisor

Remarks: All engineering data regarding Dam, pipeline and all locations to be furnished as soon as prepared.

STATE OF OREGON, }
County of Marion, } ss

This is to certify that I have examined the foregoing application, together with the accompanying maps and data, and return the same for

In order to retain its priority, this application must be returned to the State Engineer, with corrections on or before, 194.....

WITNESS my hand this day of, 194.....

PERMIT

STATE OF OREGON, }
County of Marion, } ss

This is to certify that I have examined the foregoing application and do hereby grant the same, SUBJECT TO EXISTING RIGHTS and the following limitations and conditions:

The right herein granted is limited to the amount of water which can be applied to beneficial use and shall not exceed cubic feet per second measured at the point of diversion from the stream, or its equivalent in case of rotation with other water users, from

The use to which this water is to be applied is

If for irrigation, this appropriation shall be limited to of one cubic foot per second

and shall be subject to such reasonable rotation system as may be ordered by the proper state officer.

The priority date of this permit is

Actual construction work shall begin on or before and shall thereafter be prosecuted with reasonable diligence and be completed on or before

Complete application of the water to the proposed use shall be made on or before

WITNESS my hand this day of, 194.....

STATE ENGINEER

Permits for power development are subject to the payment of annual fees as provided in sections 1 and 2, chapter 74, Oregon Laws 1933.

Application No.
 Permit No.

PERMIT
 TO APPROPRIATE THE PUBLIC
 WATERS OF THE STATE
 OF OREGON

Division No. District No.

This instrument was first received in the
 office of the State Engineer at Salem, Oregon,
 on the day of,
 194....., at o'clock M.

Returned to applicant:

Corrected application received:

Approved:

Recorded in book No. of

Permits on page

STATE ENGINEER

Drainage Basin No. Page

Fees Paid

SECTION

3

TOWNSHIP 2 S, RANGE 44 E, W. M.

North

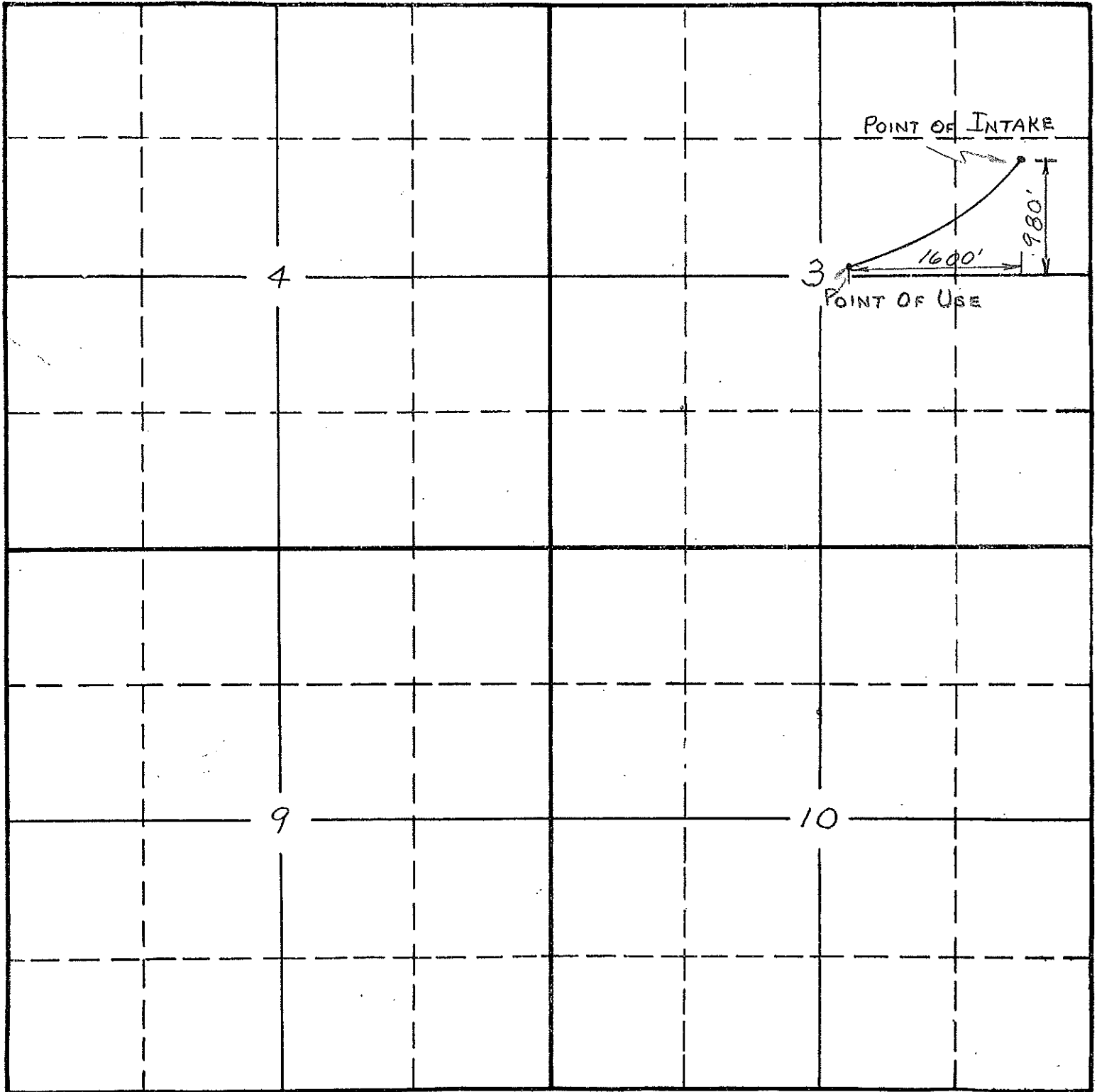

East

South

APPLICATION No.

PERMIT No.

OREGON STATE GAME COMMISSION



C. C. HILL, CHAIRMAN, DAYS CREEK
J. H. VAN WINKLE, OREGON CITY
D. GILDERSLEEVE, BAKER
DONALD MITCHELL, TAFT
LOYDE S. BLAKLEY, BEND

TELEPHONE BROADWAY 6581
ADDRESS ALL COMMUNICATIONS TO
STATE GAME COMMISSION
C. A. LOCKWOOD, DIRECTOR

1634 S. W. ALDER STREET
P. O. BOX 4136

PORTLAND 8, OREGON

October 3, 1949

Charles E. Stricklin
State Engineer
Salem, Oregon

RECEIVED
OCT 10 1949
STATE ENGINEER
SALEM, OREGON

Dear Sir:

In answer to your letter of March 23, we are enclosing the legal description of our property at the Wallowa Trout Hatchery, Enterprise, Oregon, to-wit:

All that portion of a certain tract heretofore deeded to grantors herein by Louisa Morrison and recorded in deed Book L, Wallowa County Records at page 295 thereof, lying between the subdivision line between $NW\frac{1}{4}$ and the $SW\frac{1}{4}$ of Section 3, Township 2 South, Range 44 East, W. M., and the O. W. R. & N. Company's right of way and being situated in the $SE\frac{1}{4}$ of the $NW\frac{1}{4}$ of said Section 3, and containing 10 acres, more or less.

(NOTE: The description in Deed L-295 above referred to, is as follows: Beginning at the SW corner of the $SE\frac{1}{4}$ of the $NW\frac{1}{4}$ of Section 3, Township 2 South, Range 44 East, W. M., and running thence N. 2° W. Va. $19\frac{1}{2}^{\circ}$ E. along subdivision line 22 chains to the middle of said Wallowa river, thence up along the middle of said Wallowa River in a southeasterly direction, 16.79 chains to the mouth of a certain small creek; thence S. $37\frac{1}{2}^{\circ}$ E. 1.80 chains along west bank of creek; thence S. 62° E. 2.34 chains along west bank of creek; thence S. $47\frac{1}{2}^{\circ}$ E. 0.62 chains to a stone 11x7x5 inches set in the ground marked on the top with a cross; thence south 10.86 chains to the subdivision line between the $NW\frac{1}{4}$ and the $SW\frac{1}{4}$ of Section 3; thence S. $87\frac{1}{2}^{\circ}$ W. 11.71 chains, to the place of beginning, containing 21 $\frac{3}{4}$ acres.)

All that portion beginning at a point seventeen hundred and forty-two (1742.0) feet west of the southeast corner of the southwest quarter of the northeast quarter of Section 3, Township 2 South, Range 44 East, Willamette Meridian, Wallowa County, Oregon, said point being seven hundred seventy-two and $\frac{86}{100}$ (772.86) feet east of the southwest corner of the southeast quarter of the northwest quarter of said Section 3, and running thence east along subdivision line four hundred eighty-four and $\frac{57}{100}$ (484.57) feet to the northwest

Page Two
October 3, 1949
Charles E. Stricklin

corner of the northwest fourth of the southeast fourth of said Section 3; thence east along subdivision line six hundred and sixty-five (665.0) feet thence South thirty (30) feet to a point in the center of the county road; thence north 85 degrees 40' East one hundred and sixteen (116.0) feet; thence north 61 degrees 50' East along brow of hill above a spring branch two hundred and five (205) feet; thence north 6 degrees 15' west one hundred and seventeen (117.0) feet; thence southeasterly ten (10) feet from and parallel with the south line of the Oregon, Washington Railroad and Navigation Company's railroad right of way to the center line of Hurricane creek; thence north ten (10) feet to a point on the said right of way line; thence northwesterly along said right of way to a point due north of the point of beginning; thence south four hundred and seventy-eight (478.0) feet to the point of beginning and containing 9.88 acres, more or less.

All that portion of the west half of the northwest quarter of the southeast quarter of Section 3, Township 2 South, Range 44 East, Willamette Meridian, in Wallowa County, Oregon, described as follows: Beginning at the northwest corner of the northwest quarter of the southeast quarter of said Section 3, and running thence south on the subdivision line two hundred and forty-one (241.0) feet to a point in the center of the county road; thence north 86 degrees 40' east along said center line of said county road two hundred and seventeen (217.0) feet; thence north 59 degrees 45' east along said center of said county road two hundred and seventeen (217.0) feet; thence north 70 degrees 50' east along said center line of said county road two hundred and sixty-eight (268.0) feet; thence north thirty (30) feet to a point on the subdivision line between the southwest quarter of the northeast quarter of said Section 3; thence west along said subdivision line, six hundred and sixty-five (665.0) feet to the point of beginning. All in the $W\frac{1}{2}$ of the $NW\frac{1}{4}$ of the $SE\frac{1}{4}$ of Section 3, Township 2 South, Range 44 East, Willamette Meridian, Wallowa County, Oregon, and containing 2.40 acres, more or less.

All that portion beginning at the northeast corner of the northeast $\frac{1}{4}$ of the $SW\frac{1}{4}$ of Section 3, Township 2 South, Range 44 East, Willamette Meridian, Wallowa County, Oregon, and running thence south along the subdivision line 241 feet to a point in the center of the county road; thence northwesterly along the said center of the said county road to a point on the north line of the said $NE\frac{1}{4}$ of the $SW\frac{1}{4}$ of Section 3; thence east along the said north line to the point of beginning, all in the northeast $\frac{1}{4}$ of the southwest $\frac{1}{4}$ of Section 3, said township and range, containing 1.3 acres more or less.

All that portion beginning at a point 2460 feet north and 326 feet east of the southwest corner of the southeast quarter of Section 3, Township 2 South, Range 44 East, Willamette Meridian,

Page Three
October 3, 1949
Charles E. Stricklin

said point being on the center line of the Enterprise-Alder Slope Market Road 12 feet northeasterly from the center of the concrete bridge which spans Spring Creek on said market road, running thence south 11 degrees 53' east along the east bank of Spring Creek 200 feet; thence south 78 degrees 7' west 127 feet; thence north 10 degrees 0' west 149 feet to the center line of the Enterprise-Alder Slope Market Road; thence north 55 degrees 11' east along the center line of said Market Road 132 feet to the place of beginning.

All that portion beginning at a point on the east and west center line of Section 3, Township 2 South, Range 44 East, Willamette Meridian, being 315 feet east of the north and south center line of said Section; thence along said east and west center line in a westerly direction 1100 feet more or less to a point where said line intersects the county road; thence southeasterly, easterly and northeasterly along said county road to a point due south of the point of beginning; thence north to the point of beginning, all situate in Section 3, Township 2 South, Range 44 East, Willamette Meridian, in said county and state.

except that portion covered by deed made out to Susie J. Thornburg and Charlest T. Thornburg, described as follows:

Beginning at a point 536 feet east and 110 feet north of the southwest corner of the southwest quarter of the north-east quarter of Section 3, Township 2 South, Range 44 East, Willamette Meridian, said point being on the east line of a tract of land heretofore deeded to the State of Oregon by Susie J. Thornburg and Charles T. Thornburg, husband and wife, which said deed is of record at page 111 of Book 36 of the deed records of Wallowa County, Oregon, running thence north 60 degrees 15' west along said east line 78 feet, more or less to a point on said line which is 64 feet south of the center line of the O. W. R. R. & N. Co. railroad track; thence south 82 degrees 22' west 217 feet; thence south 5 degrees 16' east 153 feet; thence north 67 degrees 38' east 61 feet; thence north 30 degrees 34' east 60 feet; thence north 76 degrees 25' east 126 feet to the place of beginning.

Also:

Starting at the northeast corner of the northwest quarter of the southeast quarter of Section 3, Township 2 South, Range 44 East, W. M., thence south 1214 3/4' East a distance of 105.38 feet to the center line of the Enterprise-Alder Slope County Road; thence South 89° 59' West, along the center line of the said County Road, a distance of 311.25 feet; which is the

Page Four
October 3, 1949
Charles E. Stricklin

southeast corner of the property of the Oregon State Game Commission; thence North $2^{\circ}26\frac{1}{2}'$ West, a distance of 130.90 feet along the East boundary of said property to the point of beginning of the property to be described. Thence South $76^{\circ}45\frac{1}{2}'$ West, a distance of 121.28 feet; thence South $30^{\circ}51\frac{1}{2}'$ West, a distance of 60.00 feet; thence South $67^{\circ}55\frac{1}{2}'$ West, a distance of 61.00 feet; thence North $4^{\circ}58\frac{1}{2}'$ West, a distance of 153.00 feet; thence North $82^{\circ}39\frac{1}{2}'$ East, a distance of 217.00 feet; thence South $2^{\circ}26\frac{1}{2}'$ East, a distance of 78.00 feet to the point of beginning.

Also:

Commencing at the point 116 feet East of the point where the South line of the O. W. R. & N. Company's railroad right-of-way intersects the West line of the Southeast quarter of the NE $\frac{1}{4}$ of Sec. 3, in Township 2 South, Range 44, East Willamette Meridian, in Wallowa County, Oregon, said point of beginning being the Northeast corner of that certain tract of real property heretofore conveyed by W. A. Murray and Josie Murray, husband and wife, to the State of Oregon by that certain deed dated July 7, 1943 and recorded in Book 55, at page 261 of the Deed Records in the office of the County Clerk of Wallowa County, Oregon; thence South on a line parallel to the West line of the Southeast quarter of the Northeast quarter of said Section 3 above described, a distance of 20 feet; thence East running parallel to the South line of the said O. W. R. & N. Company's railroad right-of-way line a distance of 1144 feet; thence North a distance of 20 feet to a point intersecting the South railroad right-of-way line of the said O. W. R. & N. Company's railroad right-of-way line; thence West along the South right-of-way line of said O. W. R. & N. Company's railroad right-of-way a distance of 1144 feet to the place of beginning.

Also:

The Northwest Quarter of the Southeast Quarter of Section 3, in Township 2 South of Range 44 E. W. M. in Wallowa County, Oregon; excepting therefrom, a right of way for a public road; excepting also the following described tract: Beginning at a point 2460 feet North and 326 feet East of the Southwest Corner of the Southeast quarter of Section 3 in Township 2 South of Range 44, E. W. M., said point being on the center line of the Enterprise-Alder Slope Market Road 12 feet northeasterly from the center of the concrete bridge which spans Spring Creek on said market road, running thence South 11 degrees 53' East along the East Bank of Spring Creek 200 feet; thence South 78 degrees 7' West 127 feet; thence North 10 degrees 01' West 149 feet to the center line of the Enterprise-Alder Slope Market Road; thence North 55 degrees 11' East along the center line of said Market Road 132 feet to the place of beginning.

Page Five
October 3, 1949
Charles E. Stricklin

Conveying also the following described tract: that part of the Southwest Quarter of the Northeast Quarter, and of the Southeast Quarter of the Northwest Quarter of said Section 3, described as follows: Beginning at the Southeast Corner of the Southwest Quarter of the Northeast Quarter of said Section 3; thence West on and along the subdivisional line 1742 feet; thence North 478 feet to the Oregon Railroad & Navigation Company's right of way; thence in a Southeasterly direction on and along the South side of said right of way to the line between the Southwest Quarter of the Northeast Quarter, and the Southeast Quarter of the Northeast Quarter of said Section 3; thence South on and along said line to the place of beginning, excepting therefrom those tracts of land containing 12.28 acres, more or less, heretofore deeded by the sellers to the State of Oregon, by warranty deed, dated March 30th, 1922, and recorded March 30th, 1922, in the Deed Records of Wallowa County, Oregon, in Book 36 at Page 112 thereof.

Also the following described tract: Beginning at a point 536 feet East and 110 feet North of the Southwest corner of the Southwest Quarter of the Northeast Quarter of Section 3, Township 2 South of Range 44 E. W. M., said point being on the East line of a tract of land heretofore deeded to the State of Oregon by Susie J. Thornburg and Charles T. Thornburg, husband and wife, which said deed is of record at Page 111 of Book 36 of the deed records of Wallowa County, Oregon, running thence North 60 degrees 15' West along said East line 78 feet, more or less, to a point on said line which is 64 feet South of the center line of the O. W. R. R. & N. Co. Railroad track; thence South 82 degrees 22' West 217 feet; thence South 5 degrees 16' East 153 feet; thence North 67 degrees 38' East 61 feet; thence North 30 degrees 34' East 60 feet; thence North 76 degrees 25' East 126 feet to the place of beginning.

It is the intention of the grantors to convey to the grantee, all of the real property which they at this time own in Section 3, Township 2 South, Range 44 E. W. M., and they hereby so convey the same regardless of the fact as to whether the foregoing particular descriptions and exceptions cover all of said real property or otherwise.

Very truly yours,

OREGON STATE GAME COMMISSION



George Kernan, Engineer

GK/blh

T. 2 S. R 44 E. W.M.

34 35
3 2

REVISIONS

NOTE: ALL DIVERTED WATER FOR USE IN HATCHERY BLDG.
AND POND RETURNED TO RIVER

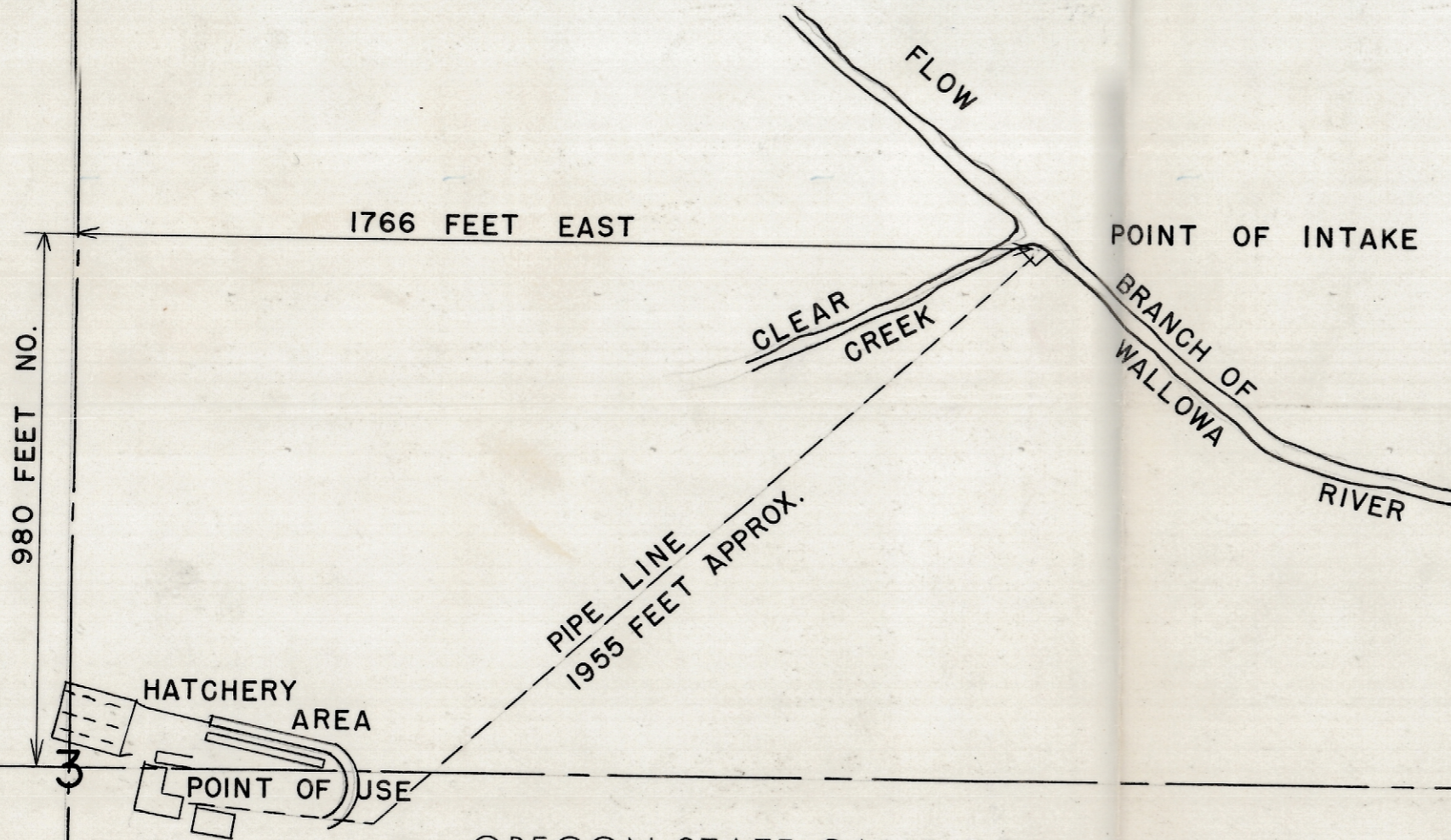
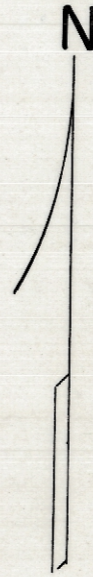

RECEIVED
MAR 17 1949
STATE ENGINEER
SALEM, OREGON

Application No. 20886
Permit No. 18674

WATER PERMIT FOR
WALLOWA HATCHERY

SCALE 1" = 300'	PLATE ONE OF ONE PLATES
DRAWN BY G.H.C.	
ENGINEER <i>[Signature]</i>	
CHECKED	
APPROVED <i>[Signature]</i>	B 580

1/4 COR. OREGON STATE GAME COMMISSION - PORTLAND, OREGON

T. 2 S. R 44 E. W.M.

34 35
3 2

REVISIONS

NOTE: ALL DIVERTED WATER FOR USE IN HATCHERY BLDG.
AND POND RETURNED TO RIVER

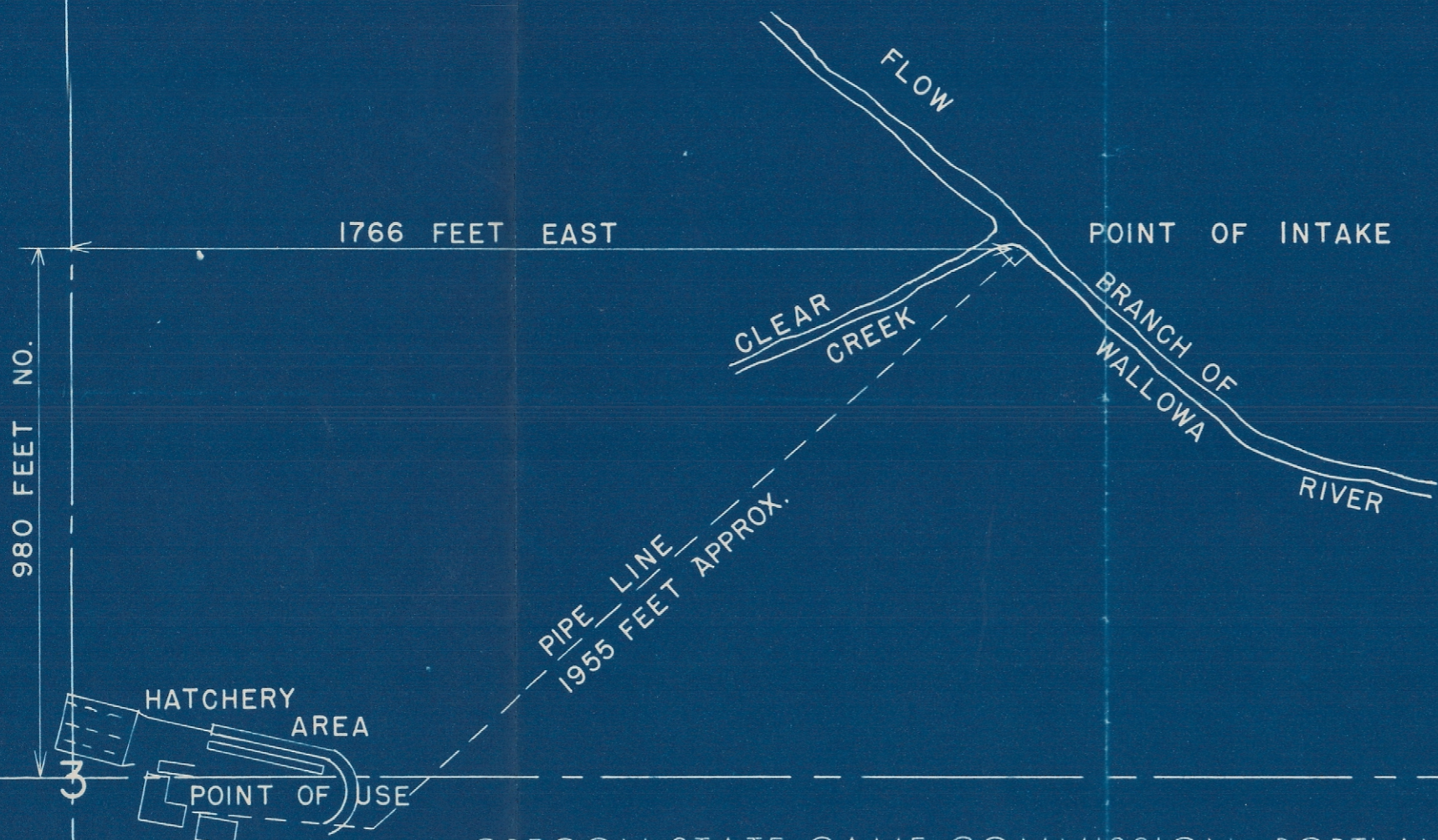

Application No. 20886
Permit No. 15071

WATER PERMIT FOR WALLOWA HATCHERY		PLATE ONE OF ONE PLATES
SCALE 1" = 300'	DRAWN BY G.H.C	B 580
ENGINEER <i>[Signature]</i>	CHECKED <i>[Signature]</i>	
APPROVED <i>[Signature]</i>		
1/4 COR.		

OREGON STATE GAME COMMISSION - PORTLAND, OREGON