

Application No. 14959

Permit No. 10895

Certificate No. ~~1158~~ 49927
Part Canceled Sp. Cr. Rec. Vol. 34 p. 323

Stream Index, Page No. 15 - ~~3994~~ 55

SEE FILE PC 80-16

FEES PAID

Date	Amount	Receipt No.
5/26/33	9.50	16173
Total		
4/27/35	\$1 Cert. Fee	18642

FEES REFUNDED

Date	Amount	Check No.

Name Ed Woodcock
 By _____
 Address Takilma, Oregon
 Date filed May 26, 1933
 Priority May 26, 1933
 Action suspended until _____

ASSIGNMENTS

Date	To Whom	Address	Volume	Page

Returned to applicant _____
 Date of approval July 20, 1933

CONSTRUCTION

Date for beginning 7-20-34
 Date for completion 10-1-35
 Extended to _____
 Date for application of water 10-1-36
 Extended to _____

REMARKS

0.31 sec. fh. from Elder Creek (.25 s.f.) & Spring (.06)
for irrigation 25 acres.
7-20-34 - Card for a
4-1-35 - Form 101
OK for Postponed

PROSECUTION OF WORK

Form "A" filed Aug. 16, 1934
 Form "B" filed Aug. 16, 1934
 Form "C" filed Aug. 16, 1934

FINAL PROOF

Blank mailed Aug. 20, 1934 Hm.
 Proof received April 27, 1935
 Date certificate issued May 31, 1935

APR 23 1981

Form C
NOTICE OF COMPLETE APPLICATION OF WATER TO A BENEFICIAL USE

I, Edward Woodcock, the holder of Application No. 14959, being Enlargement Permit No. 10895, issued by the State Engineer of the State of Oregon for the appropriation of 0.25 second-feet of the waters of Big Elder - Little Elder Springs in accordance with the tenor of such permit and the limitations endorsed thereon by the State Engineer, completely applied the water to a beneficial use, on the April day of 1933, being the time limitation as fixed in said permit or as extended by the State Engineer for the complete application of water to a beneficial use.

Remarks: fully used.
If all of the water granted in the permit had not been fully applied to beneficial use, you should so state, so that delinquent appropriators may have notice.

IN WITNESS WHEREOF, I have hereunto set my hand this 9 day of August, 1934.
Takilma, Ore. Ed Woodcock
(Present Address) (Signature of Applicant)

Fill out, detach, and mail to the State Engineer, Salem, Oregon.

Form B
NOTICE OF COMPLETION OF CONSTRUCTION

I, Edward Woodcock, the holder of Application No. 14959, being Enlargement Permit No. 10895, issued by the State Engineer of the State of Oregon for the appropriation of 0.25 second-feet of the waters of Big Elder Creek in accordance with the tenor of such permit and the limitations endorsed thereon by the State Engineer, have completed the construction of the works described therein the April day of 1934, being within the time limitation as fixed in said permit or as extended by the State Engineer for the completion of construction work.

Remarks: Less Capacity
If the works have a less capacity than as described in the permit, or you have definitely abandoned your plan of irrigating any of the lands described in your permit, you should so state in order that our records may not be unnecessarily encumbered.

IN WITNESS WHEREOF, I have hereunto set my hand this 9 day of August, 1934.
Takilma, Ore. Ed Woodcock
(Present Address) (Signature of Applicant)

Fill out, detach, and mail to the State Engineer, Salem, Oregon.

Form A
NOTICE OF BEGINNING OF CONSTRUCTION

I, Edward Woodcock, the holder of Application No. 14959, being Enlargement Permit No. 10895, issued by the State Engineer of the State of Oregon for the appropriation of 0.25 second-feet of the waters of Big Elder Creek in accordance with the tenor of such permit and the limitations endorsed thereon by the State Engineer, began the actual construction of the works described therein on the July day of 1933, being within the time limitation as fixed in said permit for the beginning of construction work.

Two men employed
The appropriator should state the manner of beginning construction work, number of men and teams employed, the amount of work completed up to the date of this statement, and any additional information which may tend to show the beginning of work in good faith.

IN WITNESS WHEREOF, I have hereunto set my hand this 9 day of August, 1934.
Takilma, Ore. Ed Woodcock
(Present Address) (Signature of Applicant)

Fill out, detach, and mail to the State Engineer, Salem, Oregon.

and papers over

STATE OF OREGON

COUNTY OF

JOSEPHINE

CERTIFICATE OF WATER RIGHT

This Is to Certify, That ED WOODCOCK

of Takilma, State of Oregon, has made proof to the satisfaction of the Water Resources Director, of a right to the use of the waters of springs

a tributary of Illinois River for the purpose of irrigation of 5.0 acres

under Permit No. 10895 and that said right to the use of said waters has been perfected in accordance with the laws of Oregon; that the priority of the right hereby confirmed dates from May 26, 1933 that the amount of water to which such right is entitled and hereby confirmed, for the purposes aforesaid, is limited to an amount actually beneficially used for said purposes, and shall not exceed 0.06 cubic foot per second

or its equivalent in case of rotation, measured at the point of diversion from the stream. The point of diversion is located in the NW 1/4 SE 1/4, Section 23 and NE 1/4 NE 1/4, Section 26, T40S, R8W, WM.

The amount of water used for irrigation, together with the amount secured under any other right existing for the same lands, shall be limited to one-fiftieth of one cubic foot per second per acre, throughout the irrigation season from April 1 to November 1 of each year,

and shall conform to such reasonable rotation system as may be ordered by the proper state officer.

A description of the place of use under the right hereby confirmed, and to which such right is appurtenant, is as follows:

5.0 acres NW 1/4 SE 1/4
Section 23
Township 40 South, Range 8 West, WM

This certificate describes that portion of the water right confirmed by the prior certificate recorded at page 11158, Volume 10, State Record of Water Right Certificates, NOT canceled by the provisions of an order of the Water Resources Director entered on February 20, 1981.

The issuance of this superseding certificate does not confirm the status of the water right in reference to ORS 540.610.

The right to the use of the water for the purposes aforesaid is restricted to the lands or place of use herein described and is subject to the existing minimum flow policies established by the Water Policy Review Board.

WITNESS the signature of the Water Resources Director, affixed

this date. April 23, 1981

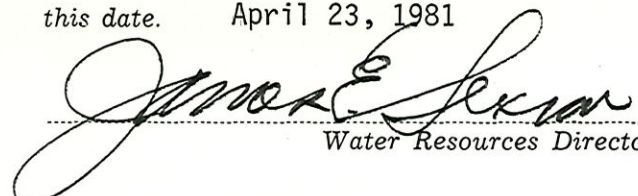
Water Resources Director

Recorded in State Record of Water Right Certificates, Volume 43, page 49927

4034A

**CERTIFICATE OF
WATER RIGHT**

STATE OF OREGON

to

STATE OF OREGON,

County of } ss.

I CERTIFY, that the within was received
and duly recorded by me in Volume
of Record of Water Right Certificates, at
page on the day
of, 19.....

County Clerk

SECTION

23

24

25

26

TOWNSHIP 40 S, RANGE 8 W., W. M.

North

STATE ENGINEER
RECEIVED

MAY 26 1933

SALEM, OREGON

STATE ENGINEER
RECEIVED

JUN 7 1933

SALEM, OREGON

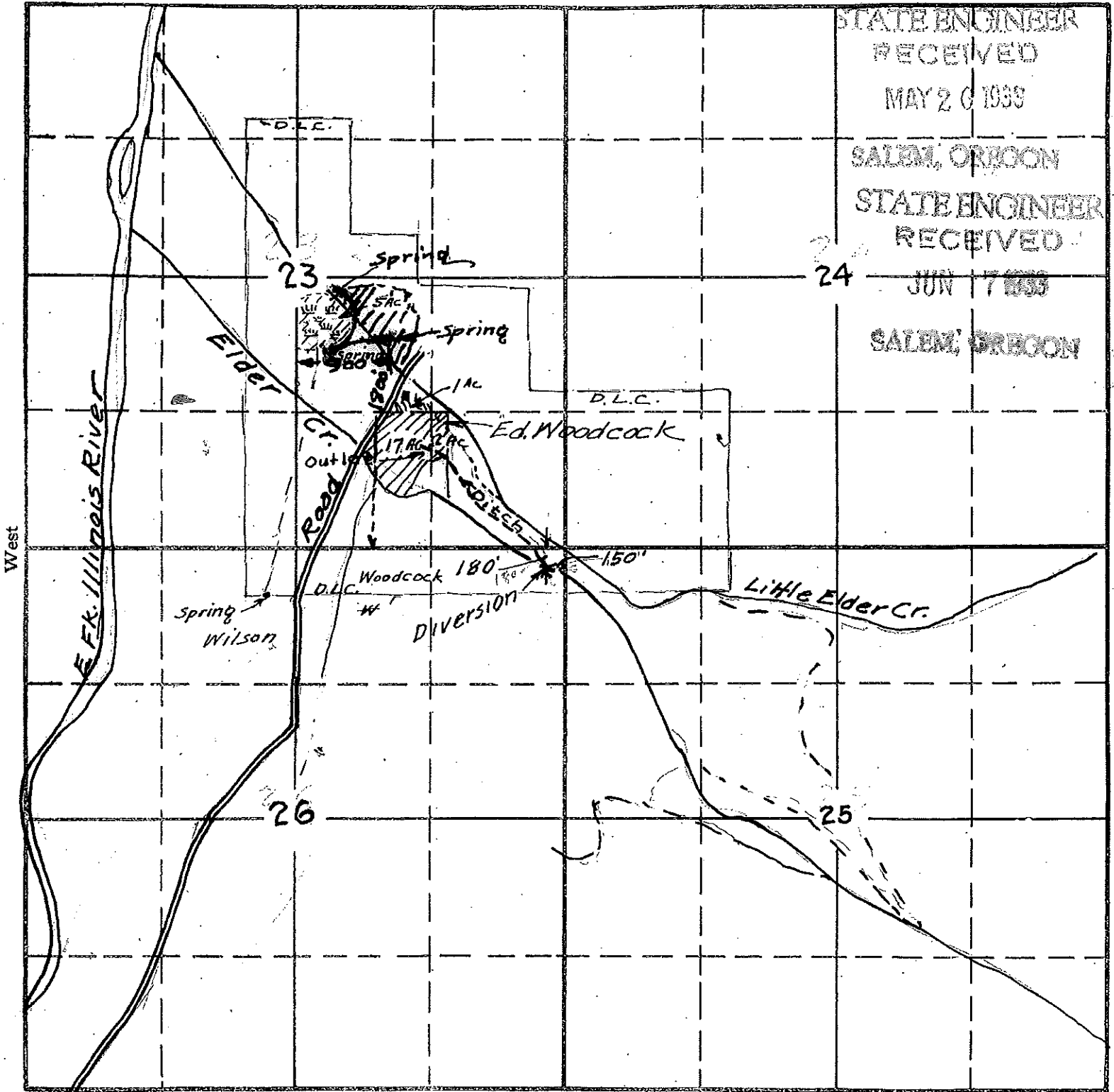

West

South

APPLICATION No. 14959
PERMIT No. 10895

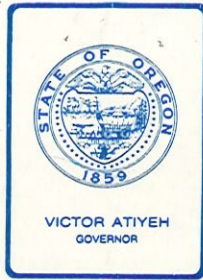

Water Resources Department

MILL CREEK OFFICE PARK

555 13th STREET N.E., SALEM, OREGON 97310

RECEIVED

MAY 14 1981

WATER RESOURCES DEPT
SALEM, OREGON

This certificated water right is appurtenant to the specific plan of use where it was established and belongs to the legal owner of the land.

The right exists only for the amount of water needed for the specific use and place of use described in the water right documents.

To change the place of use, point of diversion, or type of use of the water, an application must be filed with the Water Resources Director for approval of the proposed change.

Any portion of this water right is forfeited if allowed to go unused for five or more consecutive years. Also, the right may be lost at any time by an intentional act by the owner that would make the right unusable.

4034A

STATE OF OREGON
COUNTY OF JOSEPHINE
CERTIFICATE OF WATER RIGHT

This Is to Certify, That ED WOODCOCK, of the County of Josephine, State of Oregon, has made proof to the satisfaction of the STATE ENGINEER of Oregon, of a right to the use of the waters of a tributary of the Illinois River, Elder Creek and springs, for the purpose of Irrigation of 5.0 acres under Permit No. 10895 of the State Engineer, and that said right to the use of said waters has been perfected in accordance with the laws of Oregon; that the priority of the right hereby confirmed dates from May 26, 1933;

that the amount of water to which such right is entitled and hereby confirmed, for the purposes aforesaid, is limited to an amount actually beneficially used for said purposes, and shall not exceed 0.31 cubic foot per second measured at the point of diversion from the stream, being 0.25 cubic foot per second from Elder Creek and 0.06 cubic foot per second from springs, or its equivalent in case of rotation. The point of diversion is located in the NW 1/4 SE 1/4, Section 23, and NE 1/4 NE 1/4, Section 26, Township 40 South, Range 8 West, W. M.

The amount of water used for irrigation, together with the amount secured under any other right existing for the same lands, shall be limited to one-fiftieth of one cubic foot per second per acre, throughout the irrigation season from April 1st to November 1st of each year,

and shall conform to such reasonable rotation system as may be ordered by the proper state officer. A description of the place of use under the right hereby confirmed, and to which such right is appurtenant, is as follows:

- 5.0 acres in the NW 1/4 SE 1/4,
- 17 acres in the SW 1/4 SE 1/4,
- 2 acres in the SE 1/4 SE 1/4,
- Section 23, Township 40 South, Range 8 West, W. M.

The right to the use of the water for the purposes aforesaid is restricted to the lands or

This certificate describes that portion of the water right confirmed by the prior certificate recorded at page 11158, Volume 10, State Record of Water Right Certificates, NOT canceled by the provisions of an order of the Water Resources Director entered on Feb 20, 1981.

The issuance of this superseding certificate does not confirm the status of the water right in reference to ORS 540.610.

WITNESS the signature of the State Engineer, affixed this 31st day of May, 1935.

CHAS. E. STRICKLIN, State Engineer

Recorded in State Record of Water Right Certificates, Volume 10, page 11158

C-49927

BEFORE THE WATER RESOURCES DIRECTOR OF OREGON

JOSEPHINE COUNTY

IN THE MATTER OF CANCELLATION OF)
A WATER RIGHT IN THE NAME OF ED)
WOODCOCK FOR USE OF WATERS OF)
ELDER CREEK)

PC 80-16

ORDER CANCELING
WATER RIGHT

On December 9, 1980, pursuant to ORS 540.631, notice was given to Ray and Constance Reynolds, Spiers E. Wilson, Murrl L. and Ida Marvin, and to Wayne C. Filloon and owners of record, contract purchasers and/or occupants of certain real property located within the SE $\frac{1}{4}$ of Section 23, Township 40 South, Range 8 West, WM, Josephine County, Oregon, of the proposed cancellation of a certain water right appurtenant to said property.

The water right in question is for the appropriation of not to exceed 0.25 cubic foot per second of water from Elder Creek, under a priority date of May 26, 1933, for irrigation of a certain 1.0 acre in NW $\frac{1}{4}$ SE $\frac{1}{4}$, 17.0 acres in SW $\frac{1}{4}$ SE $\frac{1}{4}$, and 2.0 acres in SE $\frac{1}{4}$ SE $\frac{1}{4}$ of Section 23, Township 40 South, Range 8 West, WM, being a portion of the water right described by the certificate issued to Ed Woodcock and recorded at page 11158, Volume 10, State Record of Water Right Certificates. (The land involved lies between Elder Creek and Little Elder Creek, to the east of the county road.)

ORS 540.641(1) provides: "If the legal owner or the occupant receiving notice as provided in ORS 540.631 fails to protest the proposed cancellation of the water right within the 60-day period prescribed in the notice, the Water Resources Director may enter an order canceling the water right."

No protest has been filed against the proposed cancellation of the water right in question.

NOW, THEREFORE, it hereby is ORDERED that the said water right, being a portion of the right described by the certificate, recorded at page 11158, Volume 10, State Record of Water Right Certificates, is canceled.

It is FURTHER ORDERED that the said certificate of water right is canceled, and in lieu thereof a new certificate be issued to describe the balance of the water right NOT involved in this proceeding.

Dated at Salem, Oregon this 20th day of February, 1981.

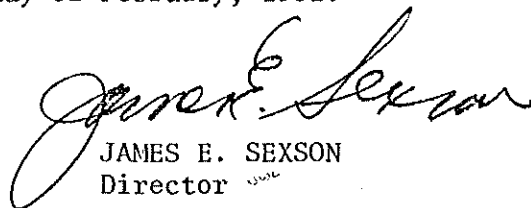
JAMES E. SEXSON
Director

STATE OF OREGON
COUNTY OF JOSEPHINE
CERTIFICATE OF WATER RIGHT

This Is to Certify, That ED WOODCOCK of the County of Josephine and State of Oregon, has made proof to the satisfaction of the STATE ENGINEER of Oregon, of a right to the use of the waters of a tributary of the Illinois River, Elder Creek and springs for the purpose of Irrigation under Permit No. 10895 of the State Engineer, and that said right to the use of said waters has been perfected in accordance with the laws of Oregon; that the priority of the right hereby confirmed dates from May 26, 1935;

that the amount of water to which such right is entitled and hereby confirmed, for the purposes aforesaid, is limited to an amount actually beneficially used for said purposes, and shall not exceed 0.51 cubic foot per second measured at the point of diversion from the stream, being 0.25 cubic foot per second from Elder Creek and 0.06 cubic foot per second from springs,

or its equivalent in case of rotation. The point of diversion is located in the NW 1/4 SE 1/4, Section 23, and NE 1/4 NE 1/4, Section 26, Township 40 South, Range 8 West, W. M.

The amount of water used for irrigation, together with the amount secured under any other right existing for the same lands, shall be limited to one-fiftieth of one cubic foot per second per acre, throughout the irrigation season from April 1st to November 1st of each year,

and shall conform to such reasonable rotation system as may be ordered by the proper state officer.

A description of the place of use under the right hereby confirmed, and to which such right is appurtenant, is as follows:

Not involved
5 ac from Springs
6 acres in the NW 1/4 SE 1/4, 1 ac } from Elder Cr.
17 acres in the SW 1/4 SE 1/4, 17 ac }
2 acres in the SE 1/4 SE 1/4, 2 ac }
Section 23,
Township 40 South, Range 8 West, W. M.

PC 80-16

The right to the use of the water for the purposes aforesaid is restricted to the lands or place of use herein described.

After the expiration of fifty years from the date of this certificate or on the expiration of any federal power license issued in connection with this right, and after not less than two years' notice in writing to the holder hereof, the State of Oregon, or any municipality thereof, shall have the right to take over the dams, plants and other structures and all appurtenances thereto which have been constructed for the purpose of devoting to beneficial use the water rights specified herein, upon condition that before taking possession the State or municipality shall pay not to exceed the fair value of the property so taken, plus such reasonable damages, if any, to valuable, serviceable and dependable property of the holder of this certificate, not taken over, as may be caused by the severance therefrom of the property taken in accordance with the provisions of section 47-508, Oregon Code 1930.

WITNESS the signature of the State Engineer, affixed

this 31st day of May, 1935.

CHAS. E. STRICKLIN
State Engineer

Recorded in State Record of Water Right Certificates, Volume 10, page 11158

APPLICATION No. 14959

COUNTY Josephine

PROOF OF APPROPRIATION OF WATER

1. Name Ed Woodcock 2. Address Takilma, Oregon.

3. Source of supply Elder Creek and springs

Tributary of Illinois River

4. Amount of water 0.31 c.f.s. measured at the point of diversion from the stream
0.25 c.f.s. from Elder Crk. & 0.06 c.f.s. from springs. Priority date May 26, 1933

6. Use Irrigation

7. Location of point of diversion, NW 1/4 SE 1/4 Sec. 26, Twp. 40 S., Range 8 W., W. M.
(Legal Subdivision)

8. The description of land given below corresponds to that found in your permit covering land to be irrigated, or, if for other purposes, the place of use. In the blank column on the right, headed "No. acres actually irrigated," fill in the number of acres you have irrigated in each of the tracts described:

Township	Range	Section	Forty-acre Tract	No. Acres Described in Permit	No. Acres Actually Irrigated
40 S.	8 W.	23	SE 1/4 SE 1/4	2	2
			SW 1/4 SE 1/4	17	17
			NW 1/4 SE 1/4	6	6
<p>If for irrigation, this appropriation shall be limited to 1/50th of one cubic foot per second, or its equivalent, for each acre irrigated throughout the irrigation season from April 1st to November 1st of each year and shall be subject to such reasonable rotation system as may be ordered by the proper state officer.</p>					

This column must be filled in if water is used for irrigation

DESCRIPTION OF WORKS

9. (a) If a dam has been constructed, give description: Height, 4 ft.; length on top, 6 ft.; length on bottom 6 ft.; material used and character of construction, Boards with earth fill
- (b) Give description of headgate: Width, 1 ft.; depth, 1 ft.; material used and character of construction, Timber. (Side of flume.)
- (c) Size of canal: Width on top (at waterline) 3 ft.; width on bottom, 2 ft.; depth of water, 0.8 ft.; grade, 6 ft. fall per 1,000 ft. Actual capacity, 3 sec.-ft. Give general description: Earth ditches
- (d) Pipe line: Description of intake, _____

 Length of pipe, _____ ft.; size at intake, _____ in.; size at _____ ft. from intake, _____ in.; size at place of use, _____ in. Difference in elevation between intake and place of use, _____ ft. Is grade uniform? _____ Actual capacity of pipe line, _____ sec.-ft. Give general description: _____
(Material: Steel, wrought, cast iron, wood stave, etc.)
- (e) Pumping plant: Give size and type of pump, _____
 Suction lift, _____ ft.; discharge lift, _____ ft. Type of motor used _____
 Horse power rating, _____ H. P. Actual capacity of pump, _____ sec.-ft.
10. During what months is water beneficially used April 1 to Nov. 1
11. State character of soil Gravelly black loam.
 Kind of crops raised Garden, grain, hay.
12. Does the accompanying map, filed with your application, show correctly the point of diversion, area of land irrigated, or place of use? Yes
13. If not, wherein is such map in error? _____

14. Domestic use: Give number of families actually using water at this time _____
15. If for power, mining, municipal, manufacturing, storage or any other purpose than irrigation, give extent and method of such use _____

AFFIDAVIT OF APPROPRIATOR

STATE OF OREGON,

County of Josephine } ss.

Ed Woodcock

I, Ed Woodcock, being first duly sworn, depose and say that I have read the above and foregoing proof of appropriation of water; that I know the contents thereof, and that the facts therein stated are true.

IN WITNESS WHEREOF, I have hereunto set my hand this 25 day of April, 1935.

Ed Woodcock

Subscribed and sworn to before me this 25 day of April, 1935.

J L Coon Clerk
Notary Public for Oregon

[NOTARIAL SEAL]

My commission expires

AFFIDAVIT OF WITNESSES

STATE OF OREGON,

County of } ss.

We,, and

of, being first duly sworn, depose and say that we are well acquainted with the facts and conditions set forth in the foregoing statement relative to proof of appropriation of water under Permit No.....; that we and each of us have been over and upon each tract described in said proof, and from such personal inspection have knowledge that all necessary ditches, dams and other diversion and distributing works have been constructed, and water used as stated therein; that we have carefully read such proof of appropriation, and that each and every statement contained therein is true to the best of our knowledge and belief.

Subscribed and sworn to before me this day of, 193.....

Notary Public for Oregon

[NOTARIAL SEAL]

My commission expires

REPORT OF PERSON MAKING INSPECTION

[REVERSE SIDE]

(For use by representative of State Engineer)

I, Tom R. Pearce, do hereby certify that I have made an inspection of the works described herein and in Permit No. 10895, on the 25th day of April, 1935, and found the foregoing statements and descriptions of works to be accurate. In my opinion the appropriation has been completed to the extent of 0.31 sec.ft. 0.25 sec.ft. from Elder Cr. and 0.06 sec.ft from springs quantity of water in second-feet or acre-feet and I recommend the issuance of a water right certificate for this amount.

Tom R. Pearce
(Name)

NOTE TO INSPECTORS

If conditions do not justify the above report by you, please return the proof without your signature, with a full report by letter.

Watermaster District No. 16.
(Title)

being that duly sworn, depose and say that we are well acquainted with the facts and conditions set forth in the foregoing statement relative to of _____

We, _____
County of _____
STATE OF OREGON

RECEIVED
APR 27 1935
STATE ENGINEER
SALEM, OREGON

PROOF OF APPROPRIATION
Permit No. _____
Recording fee paid _____
Receipt No. _____

[REVERSE SIDE]

Subscribed and sworn to before me this _____ day of _____, 1935

IN WITNESS WHEREOF, I have hereunto set my hand this _____ day of _____, 1935

I, _____
County of _____
STATE OF OREGON

VALIDITY OF APPROPRIATION

SECTION

23

24

25

26

TOWNSHIP 40 S, RANGE 8 W., W. M.

North

STATE ENGINEER
RECEIVED

MAY 20 1933

SALEM, OREGON

STATE ENGINEER
RECEIVED

JUN 7 1933

SALEM, OREGON

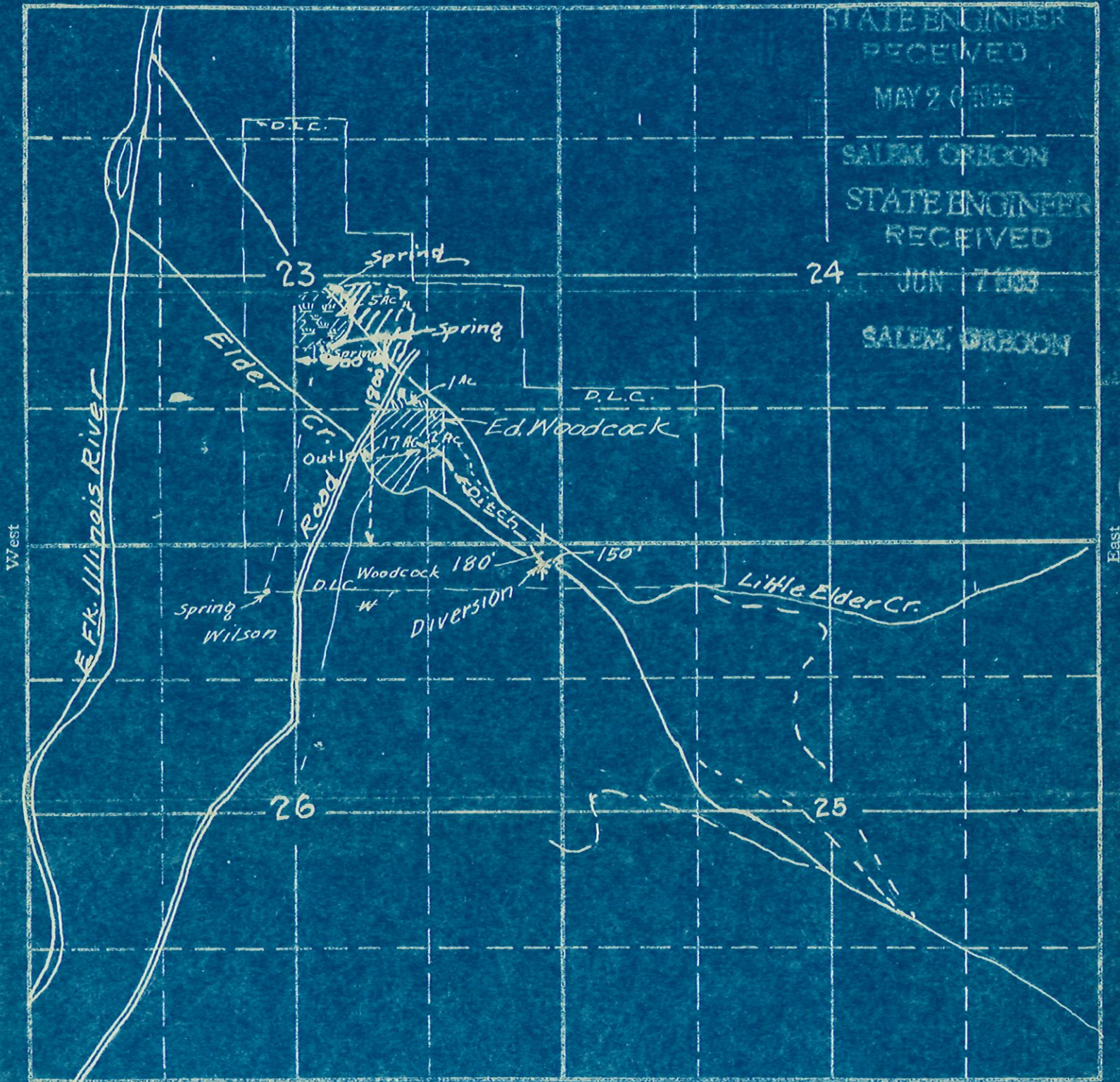

South

APPLICATION No. 14959
PERMIT No. 10895

CHAS. E. STRICKLIN, STATE ENGINEER
SECRETARY
STATE RECLAMATION COMMISSION
HYDROELECTRIC COMMISSION OF OREGON

STATE OF OREGON
OFFICE OF THE
STATE ENGINEER
WATER RESOURCES DEPARTMENT
SALEM

ADDRESS ALL COMMUNICATIONS
CHAS. E. STRICKLIN, STATE ENGINEER
SALEM, OREGON

AND REFER TO
FILE NO. 14959

April 1, 1935

Mr. Tom R. Pearce
Watermaster
Grants Pass, Oregon

Dear Sir:

Our files indicate that on August 20, 1934, a blank for making final proof under Permit No. 10895 in the name of Ed Woodcock, was mailed to you with a request that you make an inspection and assist the permittee in the execution of the proof.

In order to keep the files up to date and the water right under this permit in active status, I will appreciate having you make the necessary inspection and submit the proof at your early convenience. If there is any reason why proof cannot be submitted in the near future, kindly advise.

RECEIVED
APR 6 1935
STATE ENGINEER
SALEM, OREGON

Very truly yours,

Chas. E. Stricklin

CHAS. E. STRICKLIN,
State Engineer.

Grants Pass, Ore., Apr. 5, 1935

Expect to make inspection within the next month or so. Prefer to wait until there is more work in the same vicinity. I could make this inspection at any time, if urgent. Am aware that their work is completed.

~~Yours~~ Yours truly,

Tom R. Pearce
Watermaster Dist. No. 16.

File & report to Dept

August 20, 1954.

Mr. Tom R. Pearce,
Watermaster Dist. #16,
Grants Pass, Oregon.

Dear Sir:

I am enclosing blank for making final proof under
Permit No. 10895, in the name of Ed Woodcock.

You are requested to make your usual inspection and
report at your convenience.

Very truly yours,

CHAS. E. STRICKLIN,
State Engineer.

By
V. S. Bovelie, Assistant.

LN
enc.

Takilma, Oregon
August 9, 1934.

Charles Stricklin
Salem, Ore.

RECEIVED
AUG 16 1934
STATE ENGINEER
SALEM, OREGON

Dear Sir:

The ditch on Big Elder has been completed and the water has been used for irrigation purposes.

The water from the springs of little Elder runs through timber land. I have not cleared this sufficiently for cultivation but turn the water down through the timber to irrigate pasture land.

Yours truly,

If I have not fully advised you accordingly please let me know at once and I will make necessary reparations.

July 20, 1933

Mr. Ed. Woodcock

Takilma, Oregon

Dear Sir:

Herewith you will find Application No. 14959, Permit
No. 10895, together with blue print.

This application has been approved and recorded in
this office.

June 9, 1933,

Mr. Tom R. Pearce,
Watermaster Dist. #16,
Grants Pass, Oregon.

Dear Sir:

This will acknowledge receipt of your letter of June 6th with which you enclosed a letter from Mr. Ed. Woodcock authorizing the elimination of the spring in Section 28, Township 40 South, Range 8 West, W. M. from his Application No. 14959.

The application is now considered to be in satisfactory form and is being placed in line for approval and issuance of a permit.

Very truly yours,

CHAS. E. STRICKLIN,
State Engineer.

By
V. S. Bovellet, Assistant.

LN
c.c. Mr. Ed. Woodcock.

WATERMASTER
G. NO. 838

WATER RESOURCES DEPARTMENT
STATE OF OREGON
OFFICE OF
WATER DISTRICT NO. 16
GRANTS PASS, OREGON

WATER DISTRIBUTION
HYDROGRAPHIC SURVEYS
SNOW SURVEYS

June 6th, 1933

STATE ENGINEER
RECEIVED

JUN 7 1933

SALEM, OREGON

Mr. Chas. E. Stricklin,
State Engineer,
Salem, Oregon.

Dear Sir:

Enclosed is a letter from Mr. Ed. Woodcock,
authorizing a correction in his application for a permit
for water.

The elimination of the spring in section 26
has relieved any probable dispute as to ownership. The
other springs which are possibly outgrowth of swampy
pasture land being on the Woodcock lands. I think
this swamp is supplied with water from Little Elder
Creek and therefore give the point of diversion as
indicated on the Application.

Yours very truly

Tom R. Pearce

Watermaster District No. 16.

OR

Grants Pas, Oregon June 6, 1933

STATE ENGINEER
RECEIVED
JUN 7 1933
SALEM, OREGON

Mr. Tom R. Pearce
Watermaster District No. 16.
Grants Pass, Oregon.

Dear Sir:

You are hereby authorized to correct application
No. 14959 as follows:

The spring located in the NE $\frac{1}{4}$ NW $\frac{1}{4}$ of section 26,
T.40 S., R.8 W., W.M., may be eliminated.

The springs located in section 23, of said township
and range should be located on the north side of
little Elder Creek and at points as indicated on the
enclosed map. Also I wish to indicate that these springs
are fed by Little Elder Creek.

Yours very truly,

Ed. Woodcock

May 29, 1933.

Mr. Tom R. Pearce,
Watermaster Dist. #16,
Grants Pass, Oregon.

Dear Sir:

The application in the name of Mr. Ed Woodcock which you submitted with your letter of May 25th has been received. As suggested by you, I am requesting that he give us additional information concerning the spring in question and also that he indicate in the application the proposed means of conveying water from said spring to the place of use. A copy of my letter to him is enclosed for your information.

Very truly yours,

CHAS. E. STRICKLIN,
State Engineer.

By

V. S. Bovelle, Assistant.

VSB:LN
encl.

May 29, 1955.

Mr. Ed Woodcock,
Takilma,
Oregon.

Dear Sir:

This will acknowledge receipt of your application submitted by Mr. Tom R. Pearce for permit to appropriate 0.31 second-foot of water from Elder Creek and springs for irrigation purposes, together with his remittance in the sum of \$9.50 as fees. Receipt No. 16175 is enclosed.

The application has been filed, given No. 14959 and is being returned for some additional information. The application does not indicate clearly how water will be conveyed from the spring located in the NE $\frac{1}{4}$ NW $\frac{1}{4}$ of Section 26 to the place of use. If the water is to be appropriated directly from the spring, its location should be shown under Item 4 as the point of diversion, as well as the description of the point of diversion from Elder Creek. It will also be necessary to limit the appropriation from this spring to a certain specified amount and for this reason you should indicate the quantity of water which you desire to appropriate therefrom. It is necessary that we have a more complete description of the springs from which you desire to make the appropriation, and I am enclosing a form which you may use in giving this information.

The application has been endorsed so that in order to retain its priority it must be returned within thirty days or on or before June 29th.

Very truly yours,

CHAS. E. STRICKLIN,
State Engineer.

By
V. S. Bovelle, Assistant.

VSB:LN
encls.

c.c. Tom R. Pearce.

TOM R. PEARCE, WATERMASTER
REG. PROF. ENG. NO. 636

WATER RESOURCES DEPARTMENT

STATE OF OREGON

OFFICE OF
WATER DISTRICT NO. 16

GRANTS PASS, OREGON

May 25, 1933

WATER DISTRIBUTION
HYDROGRAPHIC SURVEYS
SNOW SURVEYS

STATE ENGINEER
RECEIVED

MAY 26 1933

SALEM, OREGON

Mr. Chas. E. Stricklin,
State Engineer,
Salem, Oregon.

Dear Sir:

Enclosed is application for Permit from Mr.
Ed. Woodcock.

After the parties left my office, a note was
sent by Edward Woodcock and Elnora E. Woodcock, stating
that spring on line between Woodcock and Wilson was left
off and to put it on the filing.

There will probably be some dispute over this
spring and I suggest that you send them the form for
getting permission from owner. If they claim owner-
ship, I think there should be some affidavit of proof.

Yours very truly,

Tom R. Pearce

Watermaster District No. 16.

STATE OF OREGON

COUNTY OF JOSEPHINE

ABSTRACT OF CERTIFICATE OF WATER RIGHT NO. 11158



Ed Woodcock of Takilma, State of Oregon, has made proof to the satisfaction of the State Engineer of Oregon, of a right to the use of the waters of Elder Creek and springs a tributary of Illinois River for the purpose of Irrigation under Permit No. 10895 of the State Engineer, and that said right to the use of said waters has been perfected in accordance with the laws of Oregon; that the priority of the right hereby confirmed dates from May 26, 1933;

that the amount of water to which such right is entitled and hereby confirmed, for the purposes aforesaid, is limited to an amount actually beneficially used for said purposes, and shall not exceed 0.31 cubic foot per second measured at the point of diversion from the stream, being 0.25 cubic foot per second from Elder Creek and 0.06 cubic foot per second from springs, or its equivalent in case of rotation. The point of diversion is located in the NW $\frac{1}{4}$ SE $\frac{1}{4}$, Section 23, and NE $\frac{1}{4}$ NE $\frac{1}{4}$, Section 26, Township 40 South, Range 8 West, W. M.

The amount of water used for irrigation, together with the amount secured under any other right existing for the same lands shall be limited to one-fiftieth of one cubic foot per second per acre, throughout the irrigation season from April 1st to November 1st of each year,

and shall conform to such reasonable rotation system as may be ordered by the proper state officer.

A description of the place of use under the right hereby confirmed, and to which such right is appurtenant, is as follows:

6 acres in the NW $\frac{1}{4}$ SE $\frac{1}{4}$,
17 acres in the SW $\frac{1}{4}$ SE $\frac{1}{4}$,
2 acres in the SE $\frac{1}{4}$ SE $\frac{1}{4}$,
Section 23,
Township 40 South, Range 8 West, W. M.

The right to the use of water for the purposes aforesaid is restricted to the lands or place of use herein described.

REMARKS:

OK.

Tom R. Pearce
Watermaster.